

## Canon CR-180

### Daily (weekly) cleaning and maintenance cycle:

There is no exact science to prescribe an optimal cleaning frequency.

The higher your daily check volume, the more paper dust, residue and ink build-up (if you are using the endorser), might occur.

- For volumes greater than 500 items a day, we would recommend you perform the following cleaning procedure on a **daily** basis to ensure optimal quality and performance.
- For volumes less than 500 items a day, the following schedule could be performed on a **weekly** basis, unless quality conditions as detailed below might otherwise dictate.

Certain tell-tale quality or performance symptoms might dictate specific cleaning, more often, or as needed, in the following circumstances.

- If stripes appear on scanned images or if dirt appears on scanned documents, clean the scanning glass (see steps 4-5 in directions) or rollers (step 3).
- If the magnetic heads are dirty, then MICR characters might not scan accurately. (see item 6)
- Ink that collects around the ink jet nozzle may stain your documents or cause text to appear blurred or scratched. If this symptom appears on your images, then clean the area around the ink heads and absorber (item 6 and 8).

If you detect any condition about which you are not certain, or if after performing the prescribed cleaning routines, any unsatisfactory quality or performance issue persists, you should contact your local Canon servicing Dealer for service.

## Cleaning the Scanning Glass and Rollers

- 1 Remove the top cover.

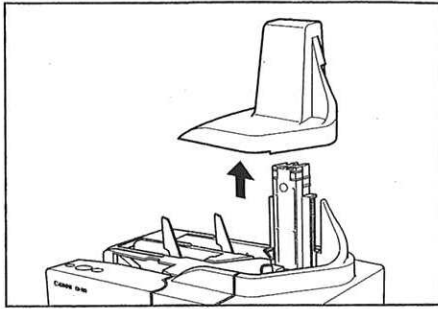

- 2 Press the open button, and pull the maintenance cover open to the right and left.

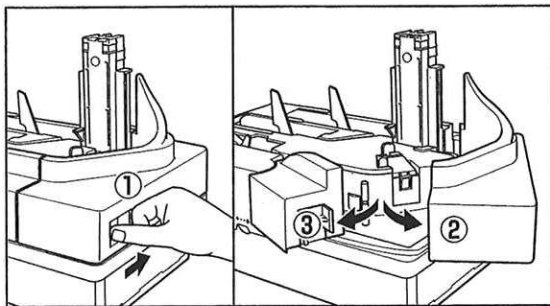

If you notice paper dust in the feed path when you open the maintenance cover, clean it out with a cotton swab.

- 3 Spin the rollers while wiping them clean with a firmly wrung cloth dampened with water or a mild detergent.

There are 13 roller positions, as shown in the diagram below.

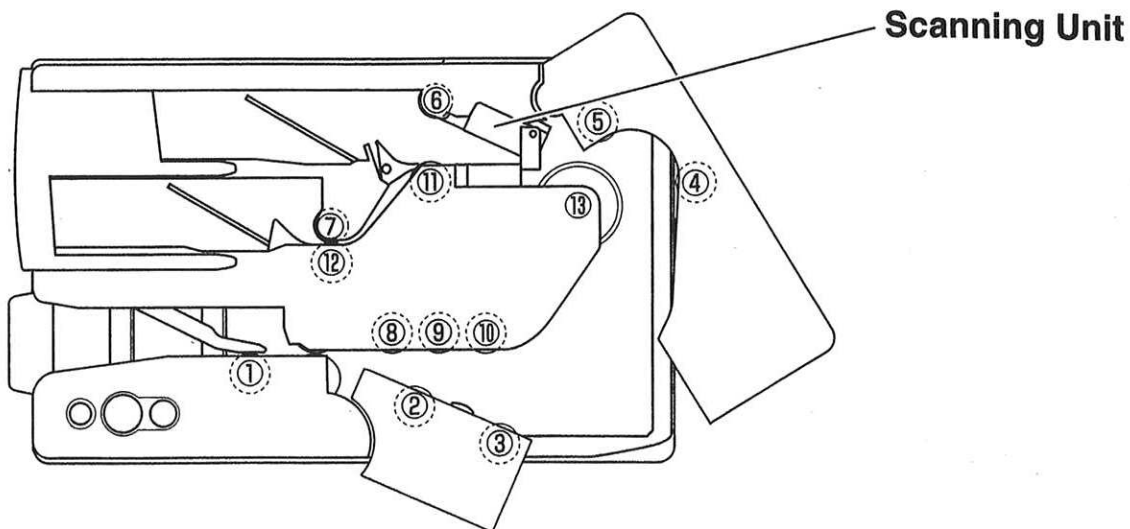

- Use cotton swabs to clean the rollers in locations that are too narrow for your fingers.
- Rollers in positions ⑧ to ⑫ are turned by the roller in position ⑬. Turn the roller in position ⑬ to wipe the rollers.
- Open the scanning unit to clean the rollers in positions ⑥ to ⑪.

- 4** Push down the lock lever to release the lock on the scanning unit (①), and then open the scanning unit (②).

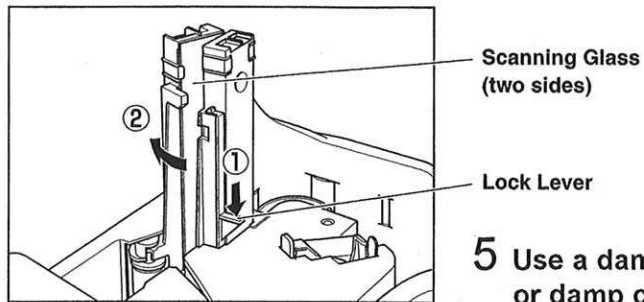

- 5** Use a damp or chemical free or non-residue soft cloth or damp cotton swab to clean both scanning glass surfaces. (when finished snap the 2 scanning elements back together – see step 11).

## Cleaning the Magnetic Heads

- 6** Use a commercially available audio head cleaner to clean the magnetic heads.

The magnetic heads are located in the positions shown in the diagram below.

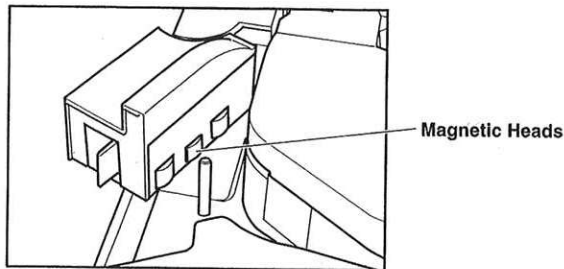

## Cleaning the Ink Heads and Ink Absorber

- 7** Clean the ink heads and absorber with a firmly wrung cloth dampened with water or a mild detergent, then dry them with a clean, dry cloth.

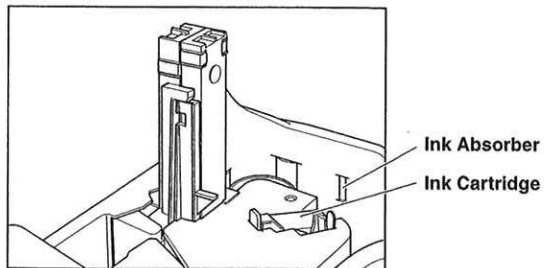

- 8** Remove the ink cartridge.  
For more information, see "Replacing the Ink Cartridge," on p.63.

- 9** Use a cotton swab to remove the ink from around the ink jet nozzle.

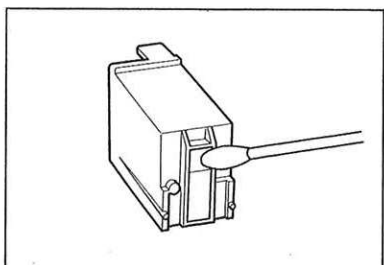

- 10** Insert the ink cartridge.

# 11 Carefully close the scanning unit.

When closing the scanning unit, you will hear a click when it is completely closed.

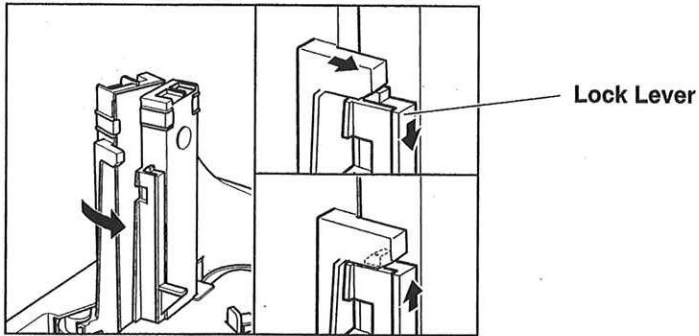

# 12 Close the maintenance covers in the order shown in the diagram below.

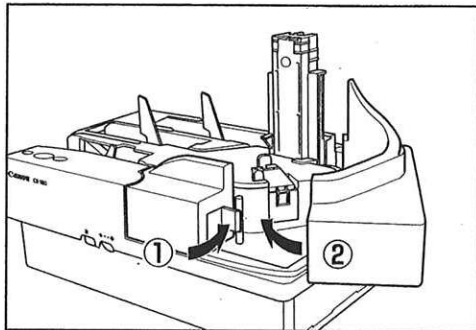

# 13 Carefully replace the top cover.

