



A730/A830

Quick Start Guide

For more information, please refer to the user manual or visit: <http://www.ge.com/digitalcameras>
© 2007 General Imaging Co.

Step 1. Unpacking

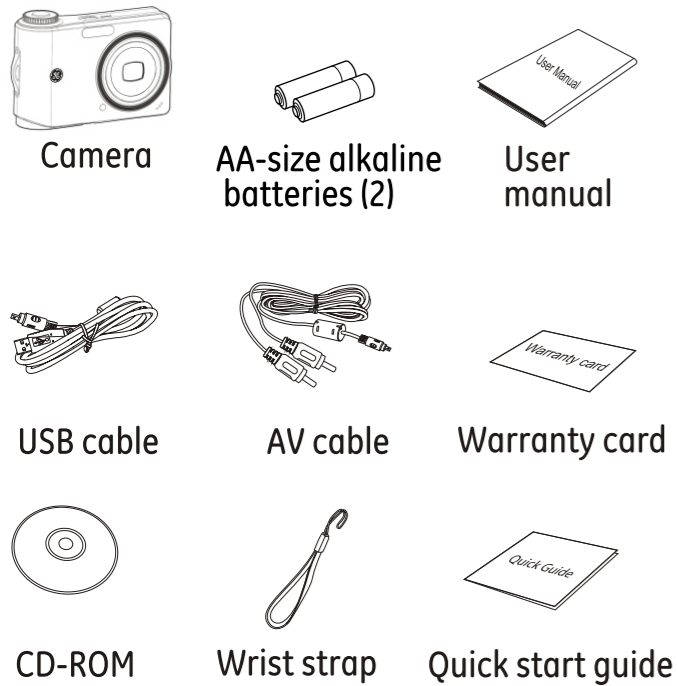

Step 2. Inserting the battery

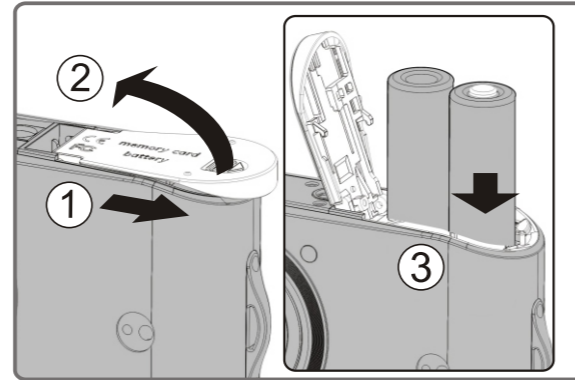

Slide open the battery cover in the direction shown by ① and then lift the cover in direction ② as shown.

Insert the battery as shown by ③.

Step 3. Setting the language



Press **Power** to turn on the camera, and the language menu will appear.

Use **Up/Down/Left/Right** to select a language, then press **func/ok** to confirm the language.

Step 4. Setting the time and date

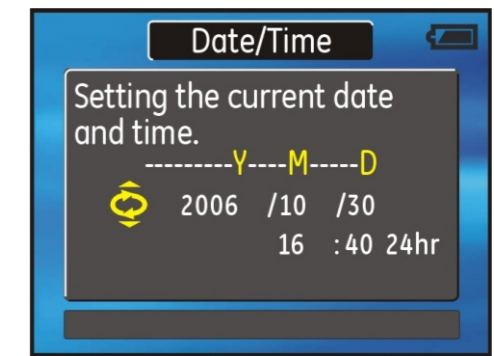

Use **Up/Down/Left/Right** again to set the date and time, and press **func/ok** to confirm.

Step 5. Using the mode dial

Switch the mode dial to shooting mode.

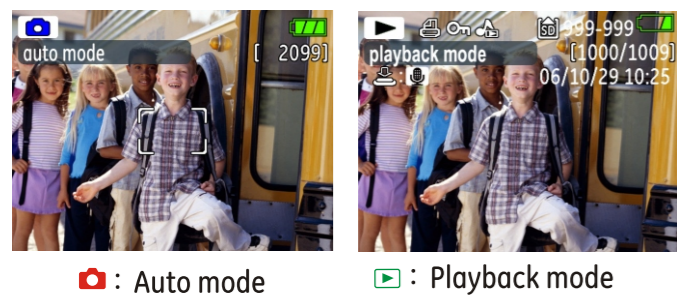
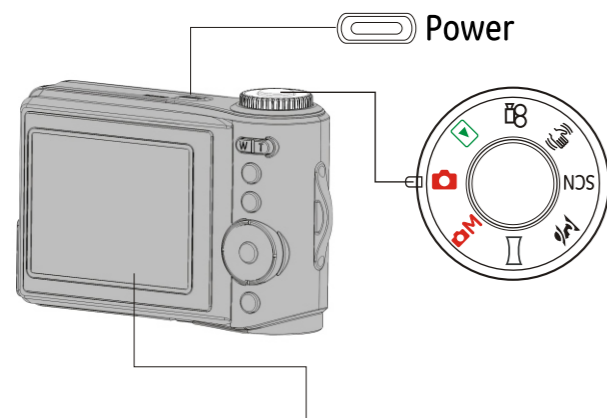

Step 6. Taking a picture

Hold the camera securely.

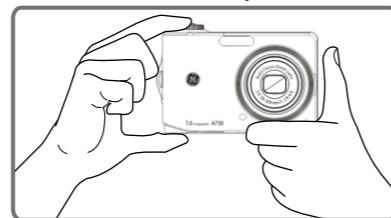

Compose your picture on the LCD screen. (Use the zoom scroll wheel to enlarge or shrink the subject.)

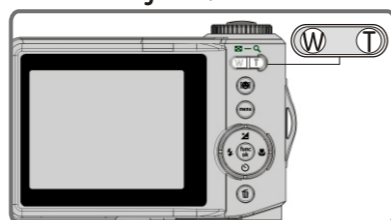

Lightly press the shutter button halfway to focus on the subject in the center, then press the shutter button fully to take a picture.

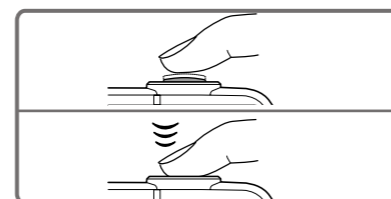

Step 7. Viewing your picture

Switch the mode dial to playback mode.

Use **Up/Down/Left/Right** to browse through your photos.

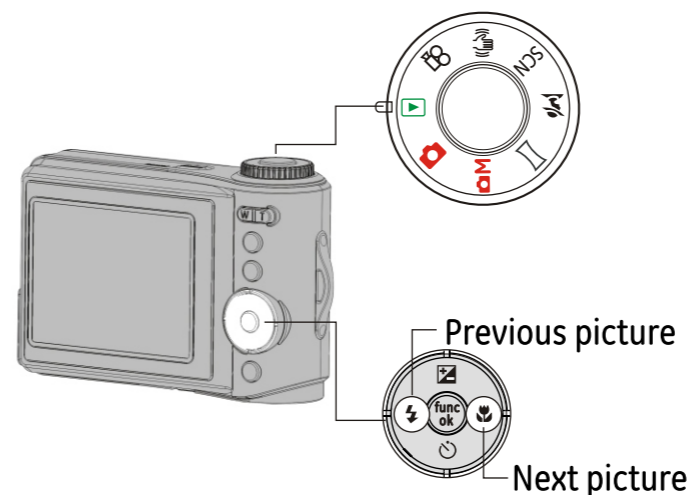

Step 8. Deleting a picture

Press **Delete** to delete the picture currently on screen.

Press the **Up** button to select "Yes", then press **func/ok** button to confirm deletion.

