

Dryer Quick Start Guide

We know you're excited about owning an ASKO dryer and you're anxious to get started, so here is a brief summary of the operating procedures. To get the most of the features of your machine, we recommend that you read your *Use and Care Guide*.

THE CONTROL PANEL

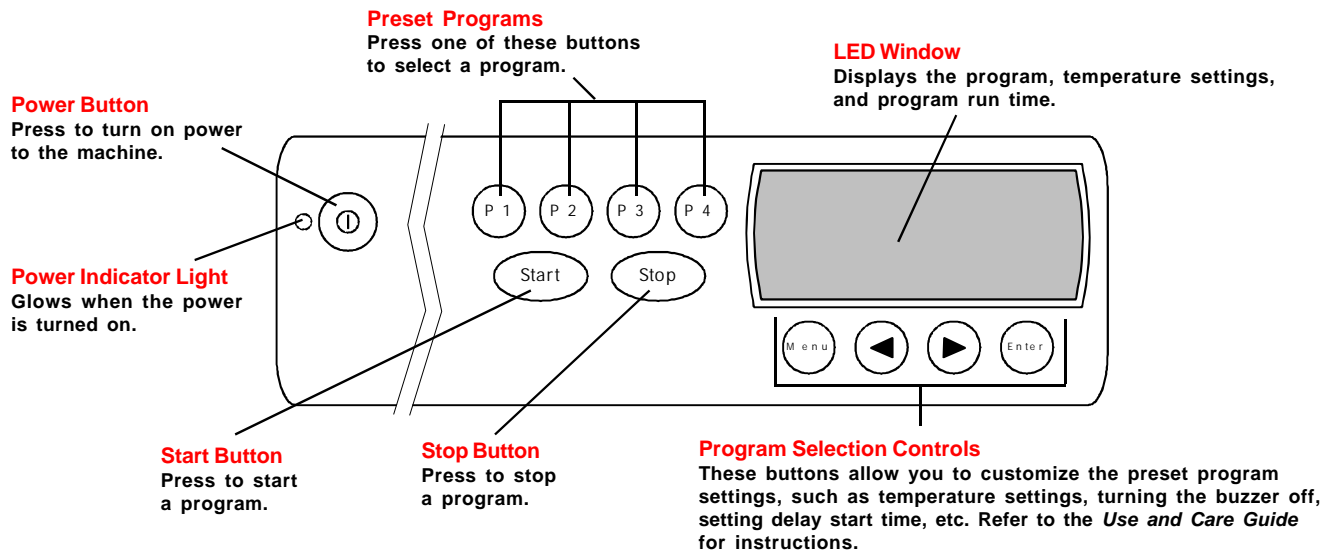

Models T760 and T780 have ASKO's state-of-the-art EasyControl™ panel, as illustrated below. To select a program, simply press one of the preset program buttons then press Start. Refer to "Preset Programs" below for a definition of these programs.



Power Button

-  The Power button turns the power to the machine on and off. When the power is on, the power indicator light glows red. The power must be on before you can set the programs or start the machine.

Start and Stop Buttons

-  These buttons start or stop a program. If you open the door during a program, the dryer will stop tumbling automatically. If you interrupt a program by opening the door, the dryer will remember where in the program it stopped. To continue the program, close the door and press Start.
-  You can also interrupt a program by pressing Stop for three seconds. If you stop the dryer this way, however, it cancels the program in progress. You will have to select a new program to restart.

Preset Programs

There are four preset programs, as defined in the table below. To select a program, simply press one of the program buttons and press Start. For additional programming options, refer to the *Use and Care Guide*.

With ASKO's Sensidry™ system, you need never worry about overdrying your laundry. Just select the proper program for the type of fabric you're drying and Sensidry does the rest. Once you select a program, Sensidry monitors the temperature and measures the humidity level. When it detects the appropriate measurements, it automatically shuts off the machine.

Preset Program	Program	Types of Laundry	Dry Temp	Anti-Crease	Buzzer
P1	Extra Dry	Heavy fabrics, such as denim jeans	Normal	1 hour	On
P2	Dry	Towels, cotton, linen, etc.	Normal	1 hour	On
P3	Normal Dry	Permanent press, synthetics, etc.	Normal	1 hour	On
P4	Iron Dry	Washable silk, acrylics, etc.	Low *	1 hour	On

* The dry temperature for Program P4 on Model T780 is Normal.

ASKO's EasyControl™ panel makes it simple to customize the preset programs to perfectly fit your laundry needs. For example, you can reprogram the dry temperature, change the cool-down time, set a delayed start, etc. For instructions, refer to "Customizing the Preset Programs" in your *Use and Care Guide*.

QUICK START PROCEDURES

T760/T780

1. Press the Power button to turn on the machine.
2. Load the dryer.
3. Check the lint filter. Clean it, if needed.
4. Check that the door is clear of laundry then close it firmly. (The door won't shut if it's slammed.)
5. Press the button for the desired program (P1–P4).
6. Press Start. The machine will start.

UNDERSTANDING THE LED WINDOW

The LED window is easy to read and understand. The illustration below explains what each item on the LED window is.

Program

When you press the Power button, the display toggles between the program numbers and the wash program names, (e.g., Extra Dry, Dry, etc.)

Preset Programs

Displays the program that is selected/running.

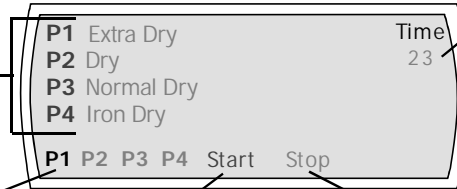

Start

Indicates that you pressed Start and the program is running.

Program Time

When you start a program, the total time the program runs is displayed. As the program progresses, the time remaining displays. The program time toggles between minutes (e.g., 23) and hours (e.g., 1h).

Stop

Indicates that the program has ended or that you pressed Stop.

The LED window also displays the menus and options available when you customize the preset programs. Refer to your *Use and Care Guide* for more details.

CLEANING THE LINT FILTER

Although the lint in your ASKO dryer will be minimal, the lint filter should be cleaned after each load to ensure maximum air flow and prevent possible overheating. To clean the filter, follow the steps below:

1. Grasp the handle and pull it toward you.
2. Remove the filter from the holder by pulling it up.
3. Open the filter and gently brush away any lint.
4. Fold the filter together and return it to the holder on the door.
5. Push the holder in until it snaps into place.

NOTE: We recommend that you clean the lint filter after every load.

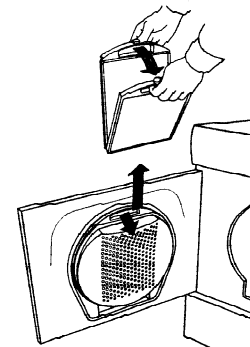

EMPTYING THE CONDENSATION WATER CONTAINER (T780 only)

If Model T780 is not installed to pump out the condensed water into a drain or a sink, you should empty the water container every three to five dryer loads, depending on the spin speed you use when you wash the clothes. For example, clothes spun at 800 rpm will have more moisture when you take them out of the washer than clothes spun at 1400 rpm. Therefore, the dryer will have to remove more water.

To empty the container, simply pull it out and pour out the water. This water is clean and can be used to water plants.

If the container becomes too full, the machine will shut down. To restart the program, empty the container and press Start. It may be a few minutes before the machine starts because it drains the excess water from the sump before it restarts.

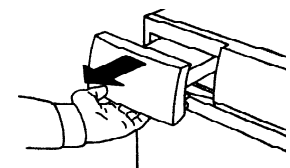

Simply pull out the container and pour out the water.

NOTE: Do not remove the water container while the machine is running.

OVERHEATING PROTECTION

The dryer has a protection device that shuts the machine off if the temperature becomes too high. Overheating could occur if the lint filter is clogged or if the fan or condenser unit (Model T780) needs to be cleaned. If the dryer shuts off during a program on Model T780, first, make sure the condensation water container is empty. If that isn't the problem, check the lint filter. Lastly, it could be the fan or condenser unit needs to be cleaned. See your *Use and Care Guide* for instructions on how to clean these items.