

## MQ

Installation and operating instructions

(US) (F) (E)



## **LIMITED WARRANTY**

Products manufactured by GRUNDFOS PUMPS CORPORATION (Grundfos) are warranted to the original user only to be free of defects in material and workmanship for a period of 24 months from date of installation, but not more than 30 months from date of manufacture. Grundfos' liability under this warranty shall be limited to repairing or replacing at Grundfos' option, without charge, F.O.B. Grundfos' factory or authorized service station, any product of Grundfos' manufacture. Grundfos will not be liable for any costs of removal, installation, transportation, or any other charges which may arise in connection with a warranty claim. Products which are sold but not manufactured by Grundfos are subject to the warranty provided by the manufacturer of said products and not by Grundfos' warranty. Grundfos will not be liable for damage or wear to products caused by abnormal operating conditions, accident, abuse, misuse, unauthorized alteration or repair, or if the product was not installed in accordance with Grundfos' printed installation and operating instructions.

To obtain service under this warranty, the defective product must be returned to the distributor or dealer of Grundfos' products from which it was purchased together with proof of purchase and installation date, failure date, and supporting installation data. Unless otherwise provided, the distributor or dealer will contact Grundfos or an authorized service station for instructions. Any defective product to be returned to Grundfos or a service station must be sent freight prepaid; documentation supporting the warranty claim and/or a Return Material Authorization must be included if so instructed.

GRUNDFOS WILL NOT BE LIABLE FOR ANY INCIDENTAL OR CONSEQUENTIAL DAMAGES, LOSSES, OR EXPENSES ARISING FROM INSTALLATION, USE, OR ANY OTHER CAUSES. THERE ARE NO EXPRESS OR IMPLIED WARRANTIES, INCLUDING MERCHANTABILITY OR FITNESS FOR A PARTICULAR PURPOSE, WHICH EXTEND BEYOND THOSE WARRANTIES DESCRIBED OR REFERRED TO ABOVE.

Some jurisdictions do not allow the exclusion or limitation of incidental or consequential damages and some jurisdictions do not allow limit actions on how long implied warranties may last. Therefore, the above limitations or exclusions may not apply to you. This warranty gives you specific legal rights and you may also have other rights which vary from jurisdiction to jurisdiction.

# MQ

**Installation and operating instructions**

4

**US**

**Notice d'installation et d'entretien**

14

**F**

**Instrucciones de instalación y funcionamiento**

25

**E**

# CONTENTS

US

<b>1. General description</b>	<b>4</b>
1.1 Applications	4
1.2 Type key	4
1.3 MQ pump	5
<b>2. Pumped liquids</b>	<b>5</b>
<b>3. Technical data</b>	<b>5</b>
3.1 Operating conditions	5
3.2 Electrical data	6
3.3 Dimensions	6
3.4 Approvals	6
<b>4. Functions</b>	<b>6</b>
4.1 Control panel	6
4.2 Pump stop	8
<b>5. Mounting and connection</b>	<b>8</b>
5.1 Mounting the pump	8
<b>6. Electrical connection</b>	<b>8</b>
6.1 Generator or inverter	9
6.2 Wiring diagram	10
6.3 Winding resistance measurement	10
6.4 Start-up	11
<b>7. Maintenance</b>	<b>11</b>
7.1 Service kits	11
7.2 Start-up after a long time of inactivity	11
<b>8. Service</b>	<b>11</b>
<b>9. Disposal</b>	<b>11</b>
<b>10. Fault finding chart</b>	<b>12</b>
<b>11. MQ frequently asked questions</b>	<b>13</b>

## WARNING!



Prior to installation, read these installation and operating instructions. Installation and operation must comply with local regulations and accepted codes of good practice.

## 1. General description

The MQ is a compact water supply system consisting of a pump, motor, pressure tank and controller combined in an integral unit.

The pump starts automatically when water is consumed in the installation and stops when the consumption ceases. The MQ is a low-noise pump which can be installed both indoors and outdoors.

**Note:** When installed outdoors the MQ should not be exposed to direct sunlight or rain.

The pump is self-priming and has a check valve incorporated in the discharge port, see fig. 1. The pump features a user-friendly control panel.

The pressure tank incorporated in the pump reduces the number of starts and stops in case of leakage in the installation.

The MQ pump has built-in overtemperature and dry-running protection.

### 1.1 Applications

Typical applications:

- Water pressure boosting (maximum inlet pressure: 45 psi) and
- water supply from wells (maximum suction lift: 25 ft), e.g.
  - in private homes,
  - in summer houses and weekend cottages,
  - on farms,
  - in market gardens and other large gardens.

The pump can be used for rain water and has been approved for drinking water.

The maximum suction lift of the pump can be determined from the diagram on page 37.

#### Example:

If the suction lift is 10 ft, the length of the suction pipe must not exceed 72 ft.

### 1.2 Type key

Example	MQ	3	-35	A	-O	-A	BVBP
Pump type							
Nominal flow rate [m³/h]							
Head [m]							
Code for pump version A: Standard							
Code for pipework connection							
Code for materials A: Standard							
Code for shaft seal							

1.3 MQ pump

US

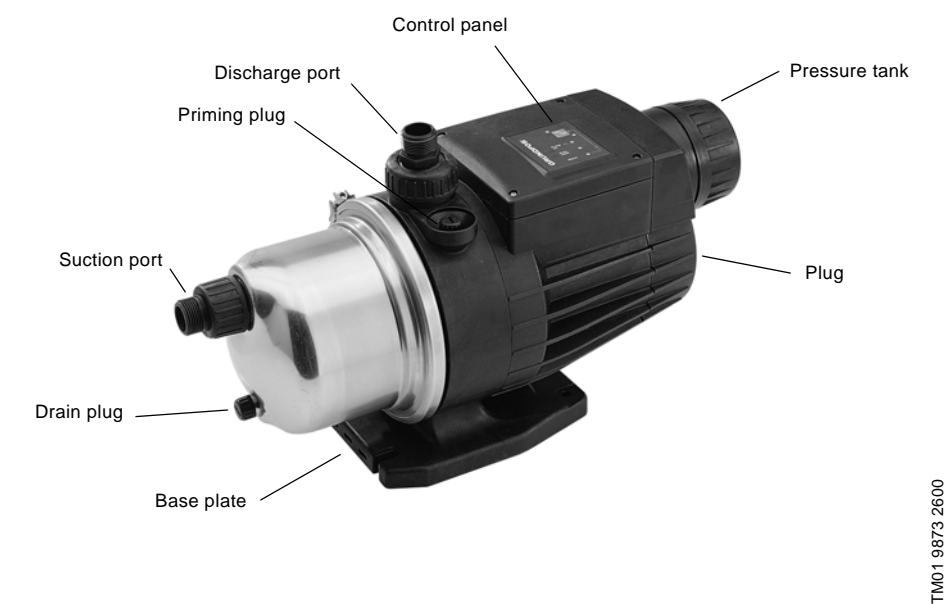

Fig. 1

2. Pumped liquids

Thin, clean, non-aggressive liquids, not containing solid particles or fibres.

3. Technical data

3.1 Operating conditions

	MQ 3-35	MQ 3-45
Maximum flow rate [gpm]	22	
Maximum pressure [psi]	51	65
Maximum system pressure [psi]	108	
Maximum suction lift [ft], see page 37	25	
Minimum ambient temperature [°F]	32	
Maximum ambient temperature [°F]	113	
Minimum liquid temperature [°F]	32	
Maximum liquid temperature [°F]	95	
Net weight [lbs]	29	
Sound pressure level [dB(A)]	< 70	
Tank volume [oz]	5	
Air pressure in tank [psi]	22 to 25	
Connections	1" NPT	

### 3.2 Electrical data

US

		MQ 3-35	MQ 3-45
Enclosure type		3	
Enclosure class		IP 54	
Insulation class		B	
Supply cable		6.56 ft H07RN-F with/without plug	
Voltage, power consumption, P <sub>1</sub> [W]	1 x 110-120 V –10/+6%, 60 Hz	800/7.2 A	1000/9.2 A
	1 x 220-240 V –10/+6%, 60 Hz	850/3.7 A	1050/4.5 A

### 3.3 Dimensions

See dimensions at the end of these instructions.

### 3.4 Approvals

See pump nameplate.

## 4. Functions

### 4.1 Control panel

The MQ pump is operated entirely by means of the control panel, see fig. 2. The control panel offers the possibility of starting/stopping the pump. The pump settings and operating condition are indicated by indicator lights.

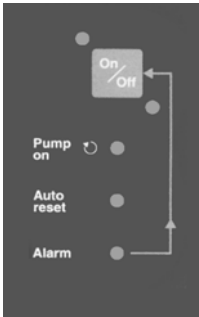

TM01 9684 2600

Fig. 2

The functions of the control panel are described in the following table:

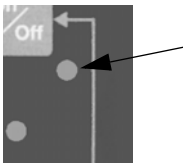
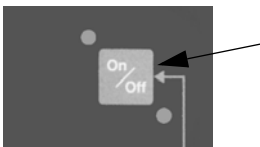
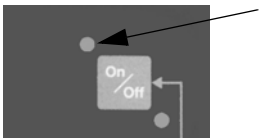
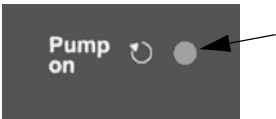
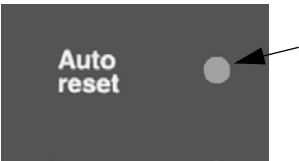
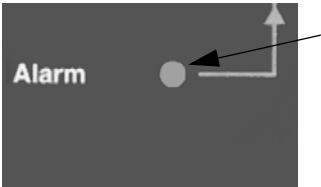
Illustration	Description
1 	<b>Indicator light (red):</b> When the indicator light is on, the pump is on standby.
2 	<b>On/off button:</b> The pump is started/stopped by means of the on/off button. The on/off button can also be used for manual resetting in case of an alarm condition: <ul style="list-style-type: none"> <li>• press once for resetting and</li> <li>• press once more for starting.</li> </ul>
3 	<b>Indicator light (green):</b> Indicates that the pump is ready for operation. When the indicator light is on, the pump will start automatically when water is consumed. The pump will stop a few seconds after the water consumption has ceased.
4 	<b>Pump on (green):</b> The indicator light is on when the pump is running.
5 	<b>Auto-reset (green):</b> As standard, this function is activated on delivery (does not apply to pump versions for Australia). When the indicator light is <ul style="list-style-type: none"> <li>• on, the Auto-reset function is activated. The pump will automatically attempt to restart every 30 minutes after an alarm/fault over a period of 24 hours. After this period, the pump will remain in the alarm condition.</li> <li>• off, the Auto-reset function is deactivated. The pump will not restart after an alarm/fault.</li> </ul> The Auto-reset function can be activated/deactivated by pressing the on/off button for 5 seconds. <b>Note:</b> When water is consumed, the pump will start and stop automatically, whether the Auto-reset light is on or off.
6 	<b>Alarm (red):</b> The indicator light is on when the pump is in alarm condition. The alarm condition may have been caused by: <ul style="list-style-type: none"> <li>• dry running,</li> <li>• overtemperature,</li> <li>• overloaded motor or</li> <li>• seized-up motor/pump.</li> </ul> See section 4.2 <i>Pump stop</i> .

**Note:** The pump settings are stored. After supply failure, the pump will automatically revert to its previous operating condition when the electricity supply is connected again.

US

## 4.2 Pump stop

The pump incorporates an electronic protective function which will stop the pump in case of

- dry running,
- overtemperature,
- overloaded motor or
- seized-up motor/pump.

The pump will restart automatically after 30 minutes (for 24 hours) in case of any type of fault if the Auto-reset function is activated (the green indicator light on the control panel is on, see point 5 in the table in section 4.1 *Control panel*).

## 5. Mounting and connection

### 5.1 Mounting the pump

The pump is resistant to sunlight and can be installed both indoors and outdoors. When installed outdoors, it is recommended to protect the pump by means of a suitable cover.

Always mount the pump on the base plate with horizontal suction port and vertical discharge port.

The pump must be mounted horizontally.

Maximum permissible inclination angle:  $\pm 18^\circ$ , see fig. 3.

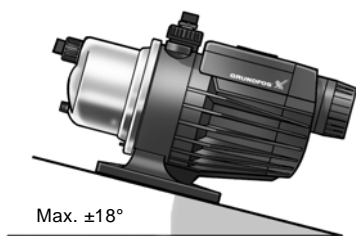

Fig. 3

The pump discharge is flexible,  $\pm 5^\circ$ , to facilitate the connection. Never apply unnecessary force when connecting the pipes.

The pump is supplied with 1" NPT screwed connections to be fitted in the suction and discharge ports, see fig. 4.

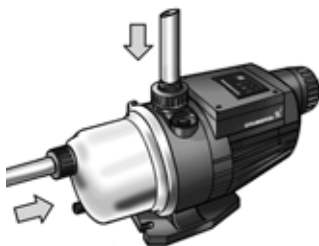

Fig. 4

The pump incorporates a check valve which prevents backflow during priming and operation.

**Installations with long suction pipes:** A check valve is supplied with the pump. It is recommended to fit this check valve in the pump suction port.

If the pump is installed in long pipes, the pipes must be adequately supported on either side of the pump in order not to strain the pump connections. If the pump draws water from a well, it is recommended also to fit a foot valve to the end of the suction pipe, see fig. 5.

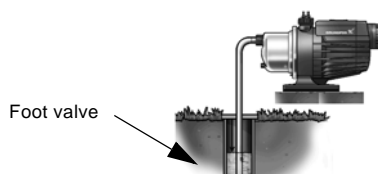

Fig. 5

If a hose is used for suction pipe, it must be of a non-collapsible type.

As the pump is self-cooling, no space is required around the pump and no ventilation is required.

## 6. Electrical connection

The electrical connections and additional protection should be carried out by qualified persons in accordance with local regulations.

### WARNING!

Non-submersible pump.

Never make any connections in the pump terminal box unless the electricity supply has been switched off for at least 5 minutes.

Risk of electric shock:

This pump is supplied with a grounding conductor and grounding type attachment plug. To reduce the risk of electric shock, install only on circuit protected by a Ground-Fault-Circuit-Interrupter (GFCI).

This pump is not intended, nor has it been investigated for use in swimming pool or marine areas.

This pump has been evaluated for use with water only.

Do not start the pump until it has been filled with water (primed, see fig. 8).

Acceptable for indoor and outdoor use.

Enclosure type 3.

The operating voltage and frequency are marked on the nameplate. Make sure that the motor is suitable for the electricity supply on which it will be used.



The pump must be connected to the mains via a rubber-sheathed cable with a protective ground lead. It is possible to replace the mains supply cable, see fig. 6.

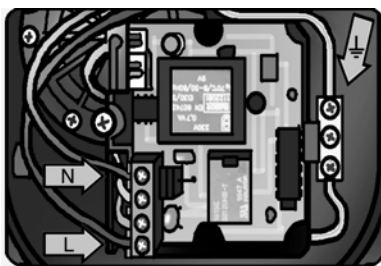

TM01 9694 2600

**Fig. 6**

Connect the mains supply cable of the pump to the electricity supply. When the cable is connected, a red and a green indicator light on the control panel will be on, see fig. 7.

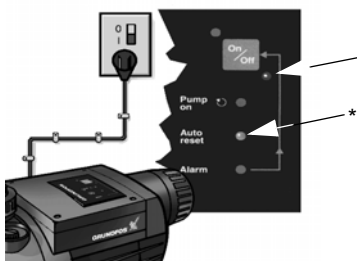

TM01 9695 2600

**Fig. 7**

\* Does not apply to pump versions for Australia.

### 6.1 Generator or inverter

**Note:** The MQ can be powered by a generator or an inverter. However, the pump will only operate satisfactorily if the generator or inverter generates a true sinusoidal wave with the necessary power and voltage input.

6.2 Wiring diagram

US

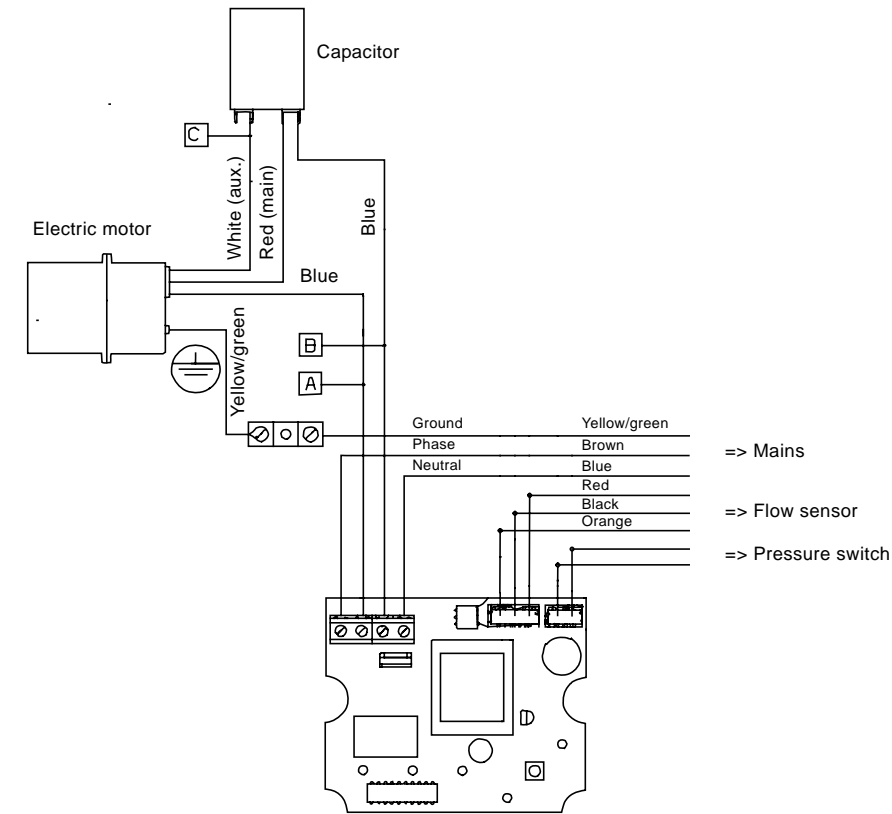

Fig. 8

6.3 Winding resistance measurement

Motor [V/Hz]	Measuring point	Winding	Resistance [ $\Omega \pm 10\%$ ]	Ambient temperature	
				[°C]	[°F]
230/50	A-B	Main	6.4	21	70
230/60	A-C	Aux	16.7		
120/60	A-B	Main	1.5		
	A-C	Aux	6.1		

The measurement can be done with or without cables connected to the PCB and the capacitor.

TM02 2424 4303

## 6.4 Start-up

Before start-up, the pump must be filled with 1.2 to 1.5 gallons of water to enable it to self-prime, see fig. 9. The pump is self-priming with a maximum suction lift of 25 ft.

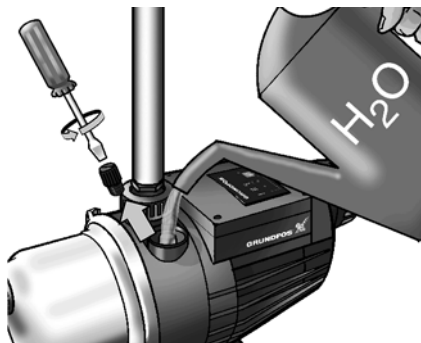

TM01 9696 2600

Fig. 9

When the pump is started, it will begin to self-prime. When the pump has been primed, it will automatically change over to normal operation. If the priming has not been completed within 5 minutes, the pump will stop automatically and attempt to restart after 30 minutes. It is possible to reset the pump manually, see point 2 in the table in section 4.1 Control panel.

## 7. Maintenance

Under normal operating conditions, the pump is maintenance-free. However, it is recommended to keep the pump clean.



### WARNING!

Do not remove the pressure tank from the pump unless it has been vented through the air escape valve.

Never touch the electronics unless the pump has been switched off for at least 5 minutes.

If there is any risk of frost damage, drain the pump through the drain hole and slacken the union nut on the discharge pipe, see fig. 10. The pump must be filled with liquid before it is started up again, see fig. 9.

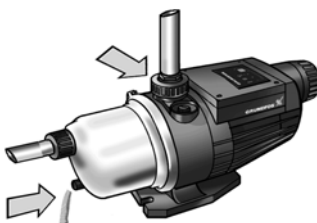

TM01 9697 4403

Fig. 10

## 7.1 Service kits

Service kits are available for the MQ pump. The service kits consist of the following replaceable parts:

- shaft seal,
- motor,
- electronic units,
- hydraulic components.

US

## 7.2 Start-up after a long time of inactivity

The end cover incorporates a plug which can be removed by means of a suitable tool. It is then possible to free the pump rotor if it has seized up as a result of inactivity. If the pump has been drained, it must be filled with liquid before start-up, see fig. 9.

## 8. Service

**Note:** If a pump has been used for a liquid which is injurious to health or toxic, the pump will be classified as contaminated.

If Grundfos is requested to service the pump, Grundfos must be contacted with details about the pumped liquid, etc. *before* the pump is returned for service. Otherwise Grundfos can refuse to accept the pump for service.

Possible costs of returning the pump are paid by the customer.

However, any application for service (no matter to whom it may be made) must include details about the pumped liquid if the pump has been used for liquids which are injurious to health or toxic.

## 9. Disposal

This product or parts of it must be disposed of in an environmentally sound way:

1. Use the public or private waste collection service.
2. If this is not possible, contact the nearest Grundfos company or service workshop.

## 10. Fault finding chart

US

Fault	Cause	Remedy
1. The pump does not start.	a) Insufficient water.	Check the water supply/suction pipe.
	b) Overheating due to excessive liquid temperature (above +95°F).	Supply cold liquid to the pump.
	c) Overheating due to seized-up/choked-up pump.	Contact your pump supplier.
	d) Too low or too high supply voltage.	Check the supply voltage and correct the fault, if possible.
	e) No electricity supply.	Connect the electricity supply.
	f) No water consumption.	Open a tap. Check that the height between the top point of the discharge pipe and the pump does not exceed 50 ft.
	g) The pump is in alarm condition.	Reset the pump by means of the on/off button. See point 2 in the table in section 4.1 <i>Control panel</i> .
2. The pump does not stop.	a) The existing pipework is leaking or defective.	Repair the pipework.
	b) The check valve is blocked or missing.	Clean the valve or fit a new check valve.
3. The pump cuts out during operation.	a) Dry running.	Check the water supply/suction pipe.
	b) Overheating due to excessive liquid temperature (above +95°F).	Supply cold liquid to the pump.
	c) Overheating caused by: - high ambient temperature (> 113°F), - overloaded motor or - seized-up motor/pump.	Contact your pump supplier.
	d) Too low supply voltage.	Check the supply voltage and correct the fault, if possible.
4. The pump starts and stops too frequently.	a) Leakage in suction pipe or air in the water.	Check the water supply/suction pipe.
	b) Too low or too high pressure in pressure tank.	Check pressure in pressure tank, see section 3.1 <i>Operating conditions</i> .
5. The pump gives electric shocks.	a) Defective ground connection.	Connect the ground connection to the pump in accordance with local regulations.
6. The pump starts when no water is consumed.	a) Defective check valve or the existing pipework is leaking or defective.	Clean the valve or fit a new check valve.

If the pump does not start when the fault has been corrected, contact your pump supplier or Grundfos for further information.

## 11. MQ frequently asked questions

### 1. What causes the MQ to start?

**Answer:** The MQ is equipped with both an internal flow switch and pressure switch. Each of these can turn the MQ on depending on water consumption. The pump will start when:

The flow rate is greater than 0.3 gpm  
OR  
the pressure is below 29 psi.

### 2. What causes the MQ to stop?

**Answer:** Other than the manual on/off button, only the flow switch is authorized to automatically stop the MQ during normal operation when flow drops below 0.3 gpm. The pump will shut off in 12-15 seconds after flow stops. Additionally, the MQ will be turned off in the event of a dry-run or over temperature alarm.

### 3. What is the maximum height of a tap above the MQ?

**Answer:** If a tap or faucet is installed at heights greater than 50 ft above the MQ, there is the potential risk that the MQ will never start. In cases where the MQ starts due to low pressure (low flow rates), the pressure has to fall below the pressure switch activation point (28-30 psi factory setting). To allow for the pressure of 50 ft of water, tolerances and a safety margin, we recommend a maximum height of 50 ft between the MQ and any tap.

### 4. What is the purpose of the built-in pressure tank?

**Answer:** The built-in pressure tank comes from the factory pressurized at approximately 23 psi (with the pump pressure at zero), and holds a volume of 5 ounces of water. It is designed to minimize motor startup due to small leaks.

### 5. How is the dry-run condition determined?

**Answer:** The dry-run alarm is declared when the motor is running AND the flow rate is less than 0.3 gpm AND when pressure is less than the pressure switch setting. When this condition lasts for 1 minute, the alarm is declared and the motor is stopped. The MQ attempts to automatically restart every 30 minutes for a maximum of 24 hours. If more than 24 hours pass without water, the pump must be restarted manually.

### 6. What is the maximum inlet pressure allowed in the MQ?

**Answer:** For both MQ 3-35 and MQ 3-45 the maximum internal pressure allowed is 109 psi. The maximum inlet pressure when added to the MQ pressure must not exceed 109 psi. Remember that inlet pressure adds to the MQ pressure, so with a 40 psi inlet pressure supplied to the MQ 3-45, internal pressures can reach approximately 105 psi (65 + 40 psi). Additionally, if inlet pressures exceed the built-in pressure switch activation point, (28-30 psi factory setting) the pressure switch will be unable to activate, and the ability to turn the MQ on at low flow rates will be lost. In this situation, only the flow switch will be able to turn the MQ on at flow rates above its activation point of 0.3 gpm.

### 7. Where can a pressure gauge be easily installed?

**Answer:** In the ½" straight thread opening used to add priming water to the pump.

US

Subject to alterations.



Dimensions

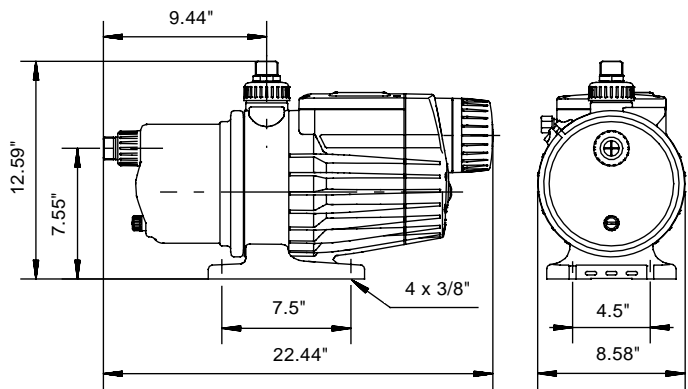

TM01 9799 3300

Suction lift/suction pipe

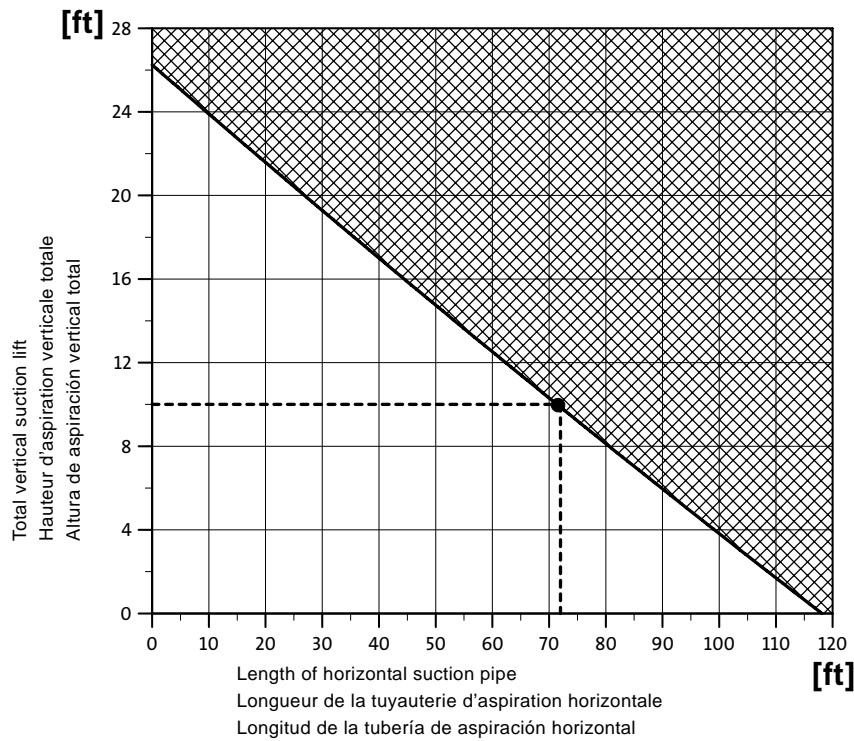

TM02 8327 4903

Exploded view

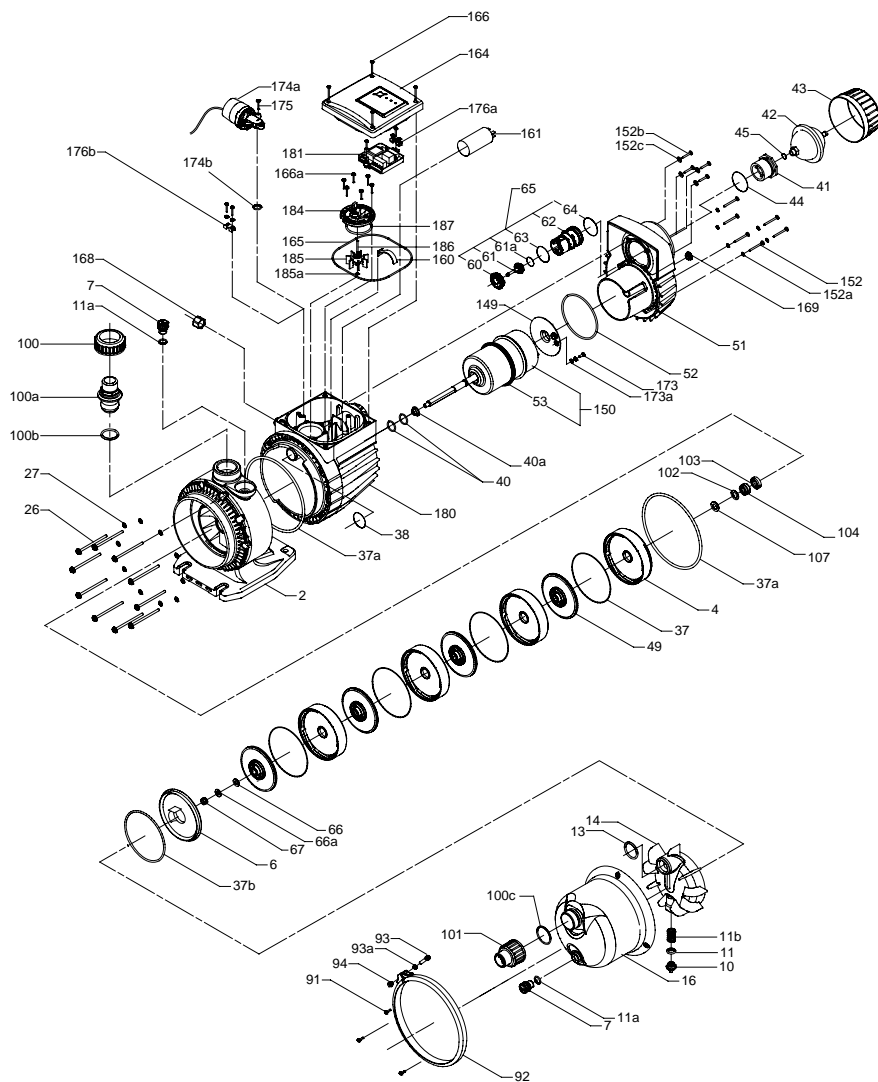

TM02 8410 5103



Pos.	Description	Description	Description
	(US)	(F)	(E)
2	Motor stool with base plate	Lanterne moteur avec socle	Soporte del motor con base
7	Priming plug	Bouchon d'amorçage	Tapón de cebado
14	Self-priming part	Pièce d'auto-amorçage	Pieza de autocebado
16	Pump sleeve	Chemise de pompe	Camisa de la bomba
42	Pressure tank	Réservoir sous pression	Tanque de presión
43	Cover	Couvercle	Tapa
51	End cover	Extrémité de la carcasse	Tapa final
53	O-ring	Joint torique	Junta tórica
65	Check valve	Clapet anti-retour	Válvula de retención
100a	Discharge connection	Raccord de refoulement	Conexión de descarga
101	Inlet connection	Raccord d'aspiration	Conexión de aspiración
161	Capacitor	Condensateur	Condensador
174a	Pressure switch	Contacteur manométrique	Presostato
181	Circuit board	Carte de circuit imprimé	Carta de circuito impreso
184	Flow switch cover	Couvercle de l'interrupteur de débit	Tapa del interruptor de caudal
185	Flow switch wheel	Roue de l'interrupteur de débit	Rueda del interruptor de caudal







**U.S.A.**

GRUNDFOS Pumps Corporation  
17100 West 118th Terrace  
Olathe, Kansas 66061  
Phone: +1-913-227-3400  
Telefax: +1-913-227-3500

**Canada**

GRUNDFOS Canada Inc.  
2941 Brighton Road  
Oakville, Ontario  
L6H 6C9  
Phone: +1-905 829 9533  
Telefax: +1-905 829 9512

**México**

Bombas GRUNDFOS de México  
S.A. de C.V.  
Boulevard TLC No. 15  
Parque Industrial Stiva  
Aeropuerto  
Apodaca, N.L.C.P. 66600  
Phone: +52-81-8144 4000  
Telefax: +52-81-8144 4010

P1720439	
V7173255 1207	172
Repl. V7173255 0307	