



Hardware Setup

HP ExpressCard Analog TV Tuner

Document Part Number: 398690-001

December 2005

This guide provides information to help you set up your HP ExpressCard Analog TV Tuner to use with your computer and the Microsoft® Windows® XP Media Center 2005 operating system.

© Copyright 2005 Hewlett-Packard Development Company, L.P.

Microsoft and Windows are U.S. registered trademarks of Microsoft Corporation.

The information contained herein is subject to change without notice. The only warranties for HP products and services are set forth in the express warranty statements accompanying such products and services. Nothing herein should be construed as constituting an additional warranty. HP shall not be liable for technical or editorial errors or omissions contained herein.

Hardware Setup
HP ExpressCard Analog TV Tuner
First Edition December 2005
Document Part Number: 398690-001

Contents

1 Introduction

Before you begin	1-2
Getting help	1-3

2 Identifying the hardware

Setup components	2-1
----------------------------	-----

3 TV tuner setup

Step 1: Set up your computer	3-1
Step 2: Set up your audio/video connection.	3-1
Connections	3-2
Step 3: Connect the infrared (IR) emitter cable (set-top box connections only)	3-8
Step 4: Complete the setup.	3-11

4 Advanced connections

TV tuner cable components	4-2
Using composite video or S-Video (set-top box connections only)	4-3
Composite video	4-4
S-Video	4-5
Adding a TV to your connection	4-7
Adding an audio receiver to your connection	4-10

5 Remote control

Remote control buttons	5-2
Using the remote control	5-7
Replacing the remote control batteries.	5-9

A Troubleshooting

B Glossary

Index

Introduction

This guide provides the necessary steps to connect the HP ExpressCard Analog TV Tuner to your computer using your existing cable/satellite service.

When connected, the TV tuner lets you use your computer like a standard TV and video recorder, allowing you to watch and record TV programs, and schedule TV recordings. This guide describes the most common connections.



The TV tuner is designed to be used with the Microsoft® Windows® XP Media Center 2005 operating system. Other third-party software applications may work with the TV tuner, but are not supported by HP.

Before you begin

Review this guide carefully to determine the most appropriate connection you want to make. Refer to Chapter 3, “[TV tuner setup](#),” for information on the most common connections.

Additional connections, such as adding a TV to your setup, are provided in Chapter 4, “[Advanced connections](#).”

Factors to consider in selecting a connection include

- How often you plan to use the TV tuner.
- The proximity to a cable/satellite signal source to your computer.
- Existing home entertainment equipment you want to include in your setup.
- How you want to view your TV content (on your computer or on your TV).

To fully utilize TV tuner features, your computer should have Internet access so you can download and view TV guide listings for your broadcast area or cable/satellite service provider.

Without Internet access, you will only be able to view live TV and will not be able to schedule recordings. For more information on required and optional equipment, refer to Chapter 2, “[Identifying the hardware](#).”

Getting help

If you have any difficulty with the setup process, refer to Appendix A, “[Troubleshooting](#),” for help.

If you are still having trouble, refer to the Media Center Help menu:

1. Open Media Center:

- ❑ Press the **START** button on your remote.

– or –

- ❑ From your Windows desktop, select **Start > Media Center**.

2. Select the question mark icon on the menu bar at the top of the screen or select **Settings > Help**.



The Media Center menu bars are only visible during or shortly after mouse or TouchPad activity. If you do not see the Media Center menu bars, briefly activate your mouse or TouchPad.

3. Select one of the following options:

- ❑ Select **Help** to access the Media Center Help files stored on your hard drive.
- ❑ Select **Community** to access online forums on the Microsoft Web site.
- ❑ Select **Tips** to browse Media Center articles on the Microsoft Web site.

For general computer help from your Windows desktop, select **Start > Help and Support**.

Identifying the hardware



Setup components

To set up Media Center, unpack your TV tuner and obtain additional items, including the following components (not provided):

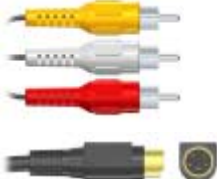

- Computer with a Microsoft Windows XP Media Center 2005 operating system and computer equipment (such as an AC adapter) required to use the computer.
- A working Internet connection (required for Media Center features such as scheduling recordings and accessing the Program Guide).
- A working TV signal source (required for viewing TV). Your TV source may also require a cable or satellite set-top box.
- A television (optional).
- S-Video and audio-out Y cables or optional media cable (compatible with select models only) if connecting a television.
- Additional cables (RF coaxial, composite video, or S-Video) for some advanced connections or to facilitate your cable length requirements.

The following components are included with your TV tuner. Depending on your connection, not all components are required to set up Media Center.



Component	Description
1 HP ExpressCard Analog TV Tuner	Provides input and output jacks for the Media Center.
2 Composite audio/video and S-Video cable	Connects a cable or satellite set-top box to the TV tuner for higher audio/video quality over RF coaxial (optional). The S-Video cable can also connect video from the computer to a TV (optional).
	 For information comparing RF coaxial, S-Video, and composite video, refer to Chapter 4, " Advanced connections ."

(Continued)

Component	Description
<p>③ Infrared (IR) emitter cable</p> 	<p>Connects the TV tuner to your cable or satellite set-top box. When connected, you can change channels on the set-top box using the Media Center remote control.</p>
<p>④ RF coaxial cable attachment</p> 	<p>Connects an RF coaxial cable to the TV tuner.</p>
<p>⑤ Remote sensor</p>	<p>Connects to the USB port on the computer. When connected, you can change channels using the Media Center Remote Control.</p>
<p>⑥ HP Media Center Remote Control</p>	<p>Used to change channels and navigate Media Center.</p>
	<p>For more information on composite video, RF coaxial, S-Video, and other terms, refer to Appendix B, “Glossary.”</p>

TV tuner setup

Step 1: Set up your computer

If you have not already set up your computer, refer to the printed *Getting Started* guide, included with your computer, for instructions.

Step 2: Set up your audio/video connection

Two common connections are detailed in the following sections. The connection you use will depend on what you want to do with your audio/video setup and the type of TV input you use.

Factors to consider in selecting and setting up your connection include

- How often you plan to use the TV tuner.
- The proximity to a cable or satellite signal source.
- Existing home entertainment equipment you want to include in your setup.
- How you want to view TV content (on your computer or on your TV).

Connections

Connecting the TV tuner is a simple setup that allows you to

- Watch and/or record a live TV program on your computer.
- or –
- Record one live TV program while watching a previously recorded TV program.

Some advanced setup instructions are also provided. Refer to Chapter 4, “[Advanced connections](#),” for instructions on

- Using composite video or S-Video with your cable or satellite set-top box.
- Adding a TV or stereo to your configuration.



Depending on how you set up your TV tuner, you may not use all of the cables.

The type of connection you use will depend on your existing TV source. Refer to the following table.

Your TV Source	Refer to Section
Regular TV without set-top box	“Connection 1: Connecting with regular TV or cable TV without a set-top box”
Cable TV without set-top box	“Connection 1: Connecting with regular TV or cable TV without a set-top box”
Cable TV with set-top box	“Connection 2: Connecting with satellite TV or cable TV with a set-top box”
Satellite TV with set-top box	“Connection 2: Connecting with satellite TV or cable TV with a set-top box”

Connection 1: Connecting with regular TV or cable TV without a set-top box



Computer features may vary. Cable lengths are not shown to scale.

To connect the TV tuner to your existing regular TV or cable TV source (without a set-top box):

1. Insert the TV tuner **1** into the ExpressCard slot on the computer.
2. Connect the RF coaxial cable attachment **2** to the TV tuner.
3. Connect an RF coaxial cable from the RF coaxial cable attachment on the TV tuner **3** to your regular TV or cable TV wall jack **4**.

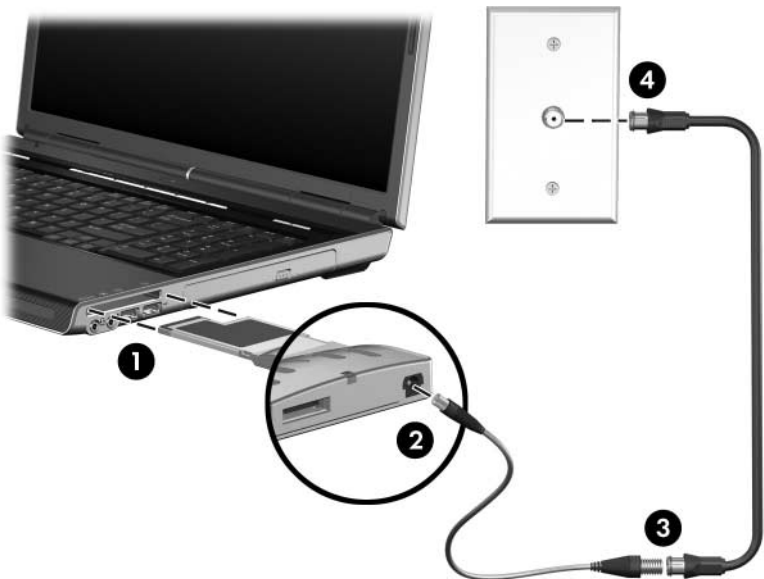

4. Connect the remote sensor to a USB port on the computer.

 You can connect the remote sensor to any USB port on your computer.



5. Complete the setup of your TV tuner. Refer to “[Step 4: Complete the setup](#),” later in this chapter.

 For additional connection steps, such as adding a television, refer to Chapter 4, “[Advanced connections](#).”

Connection 2: Connecting with satellite TV or cable TV with a set-top box



Refer to your cable or satellite set-top box user guide for the exact location and labeling of components.



Computer features may vary. Cable lengths are not shown to scale.

To connect the TV tuner to your existing satellite TV or cable TV source (with a set-top box):

1. Connect an RF coaxial cable from your cable or satellite TV wall jack **1** to the TV-In jack on your cable or satellite set-top box **2**.
2. Connect an RF coaxial cable from the TV-Out jack **3** on your cable or satellite set-top box to the RF coaxial cable attachment **4** on the TV tuner.



For improved video quality you can connect your set-top box to the TV tuner using a composite video or S-Video cable instead of an RF coaxial cable. Refer to Chapter 4, “[Advanced connections](#),” for instructions.

3. Connect the RF coaxial cable attachment **5** to the TV tuner.
4. Insert the TV tuner **6** into the ExpressCard slot on the computer.

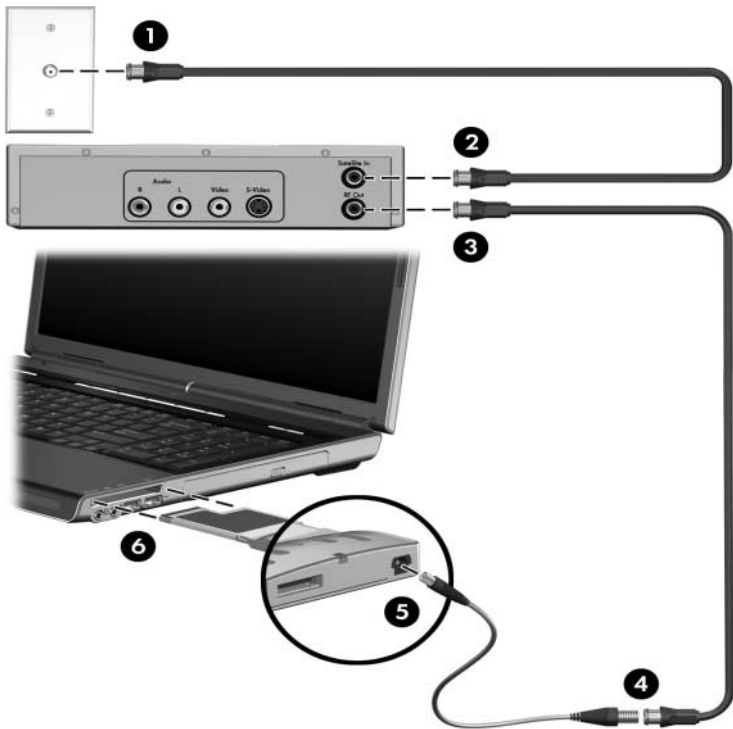

5. Connect the remote sensor to a USB port on the computer.

 You can connect the remote sensor to any USB port on your computer.



6. Connect the infrared (IR) emitter cable from the IR receiver to the set-top box. Refer to “[Step 3: Connect the infrared \(IR\) emitter cable \(set-top box connections only\)](#),” for details.
7. Complete the setup of your Media Center. Refer to “[Step 4: Complete the setup](#),” later in this chapter.

 For additional connection steps, such as adding a television, refer to Chapter 4, “[Advanced connections](#).”

Step 3: Connect the infrared (IR) emitter cable (set-top box connections only)

In order to change channels using the HP Media Center Remote Control, you must connect the IR emitter cable from the remote sensor to your cable or satellite set-top box.

To connect the IR emitter cable:

1. Connect the IR emitter cable plug to the connector on the remote sensor ❶.



Be sure that you connect the IR emitter cable plug to the connector marked with a “1” on the remote sensor.

2. Remove the backing paper from the IR emitter to expose the adhesive tape ❷.

3. Press the adhesive side of the IR emitter onto the infrared (IR) lens on the front of the set-top box ③.

 To help locate the IR lens, shine a flashlight on the front of the set-top box. The IR lens is usually a small, dark red window.

 If you cannot place the emitter directly over the IR lens, place it as close to the IR lens as possible.

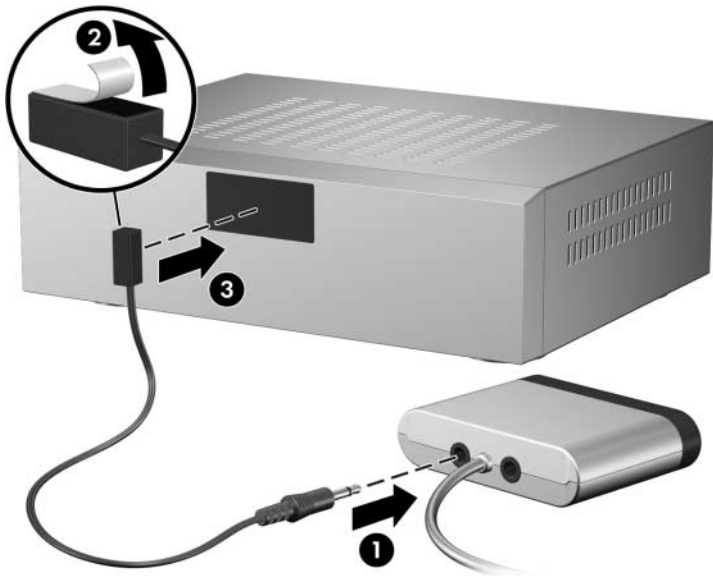

After the IR emitter is connected to the set-top box, you can use the HP Media Center Remote Control to change the channels.



Step 4: Complete the setup

To complete the setup:

1. Point the remote control at the remote sensor, and then press the **START** button on your remote control to open Media Center. Refer to Chapter 5, “[Remote control](#),” for information on using the remote control.



2. The Media Center Setup Wizard opens. (Follow the on-screen instructions to set up the Media Center software.)

If the Setup Wizard does not open, or if you have already run the Setup Wizard and would like to run it again:

- a. Select **Settings > General > Media Center Setup > Run Media Center Setup Again**.
- b. Follow the on-screen instructions.

 If this is not the first time you have run the Setup Wizard, you will lose any existing Media Center settings and preferences.

Advanced connections

The following sections provide additional setup instructions on

- Using composite video or S-Video instead of RF coaxial (for connections with cable or satellite set-top boxes only).
- Adding a television to your connection.
- Adding a stereo to your connection.



You must complete the steps in Chapter 3, “[TV tuner setup](#),” for these advanced connections to work.

TV tuner cable components

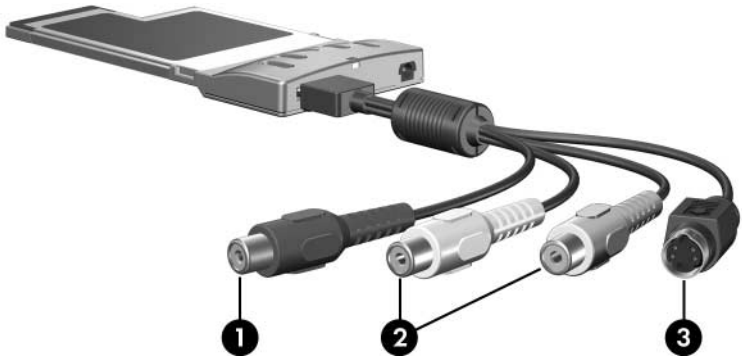

Component	Description
① Composite video cable	Connects to video equipment for composite video input.
② Composite audio cables (2)	Connects to video equipment for composite audio input.
③ S-Video cable*	Connects to video equipment that supports S-Video input. Provides improved video performance over composite video.

*S-Video may not be supported by your audio/video equipment. Refer to your audio/video equipment user guide for more information.

Using composite video or S-Video (set-top box connections only)

If you are using a cable or satellite set-top box in your setup, you have the option of improving video quality by connecting a composite video or S-Video cable (instead of an RF coaxial cable) from your set-top box to the TV tuner.

The following table compares the video types and associated video quality supported by Media Center.

Supported Video Type	Video Quality
RF coaxial	Good
Composite	Better
S-Video	Best

Refer to the following sections for instructions on connecting composite video or S-Video.

Composite video

To connect composite video:

1. To avoid video transmission problems, unplug the RF coaxial cable before connecting a composite video cable.
2. Connect the composite audio/video cable ❶ to the red, white, and yellow composite audio and video jacks on your cable or satellite set-top box.

 Refer to your cable or satellite set-top box user guide for the exact location and labeling of jacks.

3. Connect the other end of the composite audio/video cable ❷ to the composite audio and video jacks on the TV tuner.

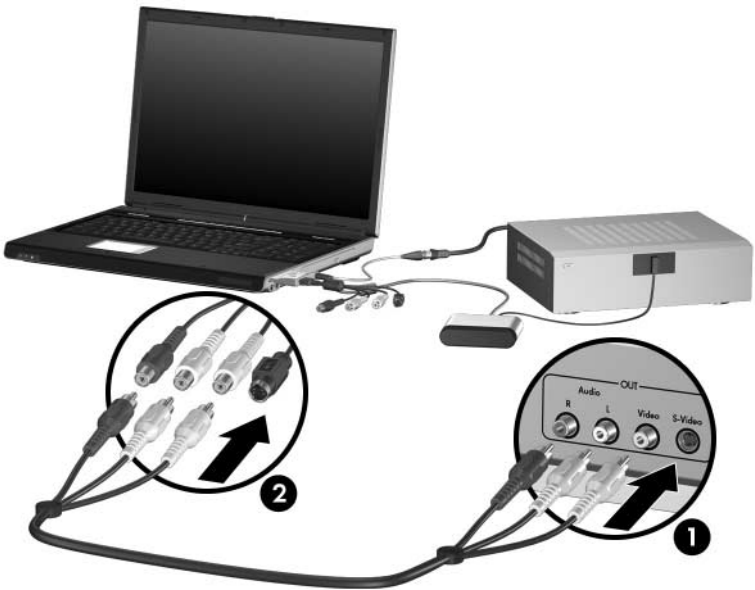

S-Video

To connect S-Video:

1. To avoid video transmission problems, unplug the RF coaxial cable before connecting an S-Video cable.
2. Connect the S-Video cable ❶ to the S-Video-out jack on your cable or satellite set-top box.



Refer to your cable or satellite set-top box user guide for the exact location and labeling of jacks.

3. Connect the red and white plugs on the composite audio/video cable ❷ to the red and white audio jacks on your cable or satellite set-top box.



Do not connect the yellow composite video plug.

4. Connect the S-Video cable and the red and white audio plugs on the composite audio and video cable **3** on the TV tuner.

△ Do not connect the yellow composite video plug.

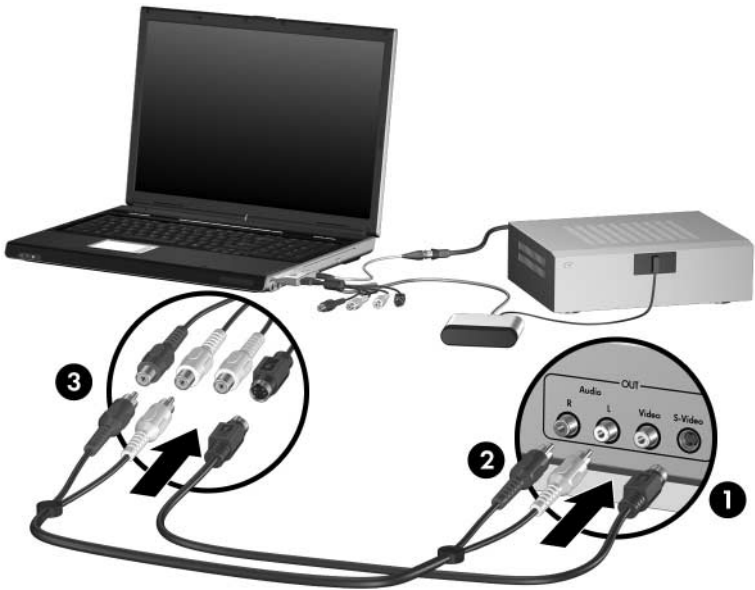

Adding a TV to your connection

Adding a TV to your connection allows you to watch and listen to TV programs on the television as well as on your computer.



TV and computer features may vary. Refer to your TV and computer user guides for the exact location and labeling of jacks.

To add a TV to your connection:

1. Connect an S-Video cable from the S-Video-in jack on your TV **1** to the S-Video-out jack on your computer **2**.

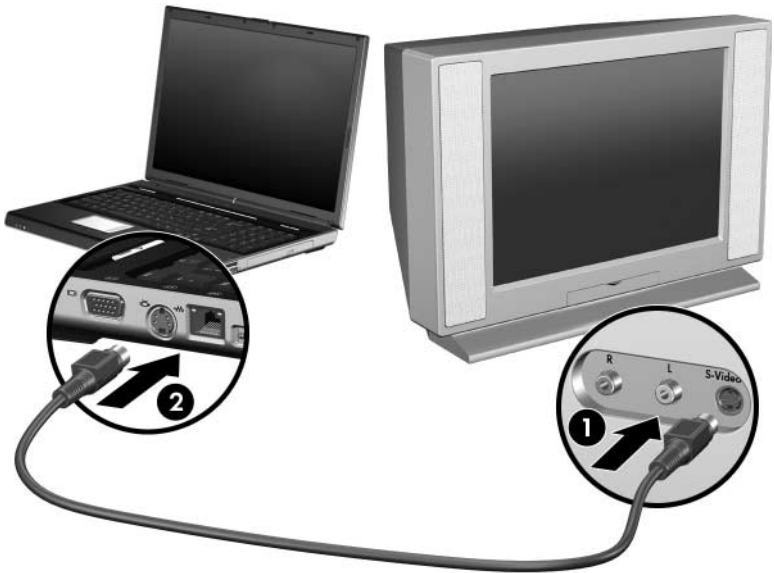

2. If you want to hear sound from your TV:
 - a. Connect the red and white (right and left) plugs of an audio Y-cable (not included) to the red and white (right and left) audio-in jacks on your TV **1**.
 - b. Connect the other end of the audio cable to the headphone (audio-out) jack on the computer **2**.



If your TV has only one audio jack, connect the white audio plug and leave the red audio plug disconnected.

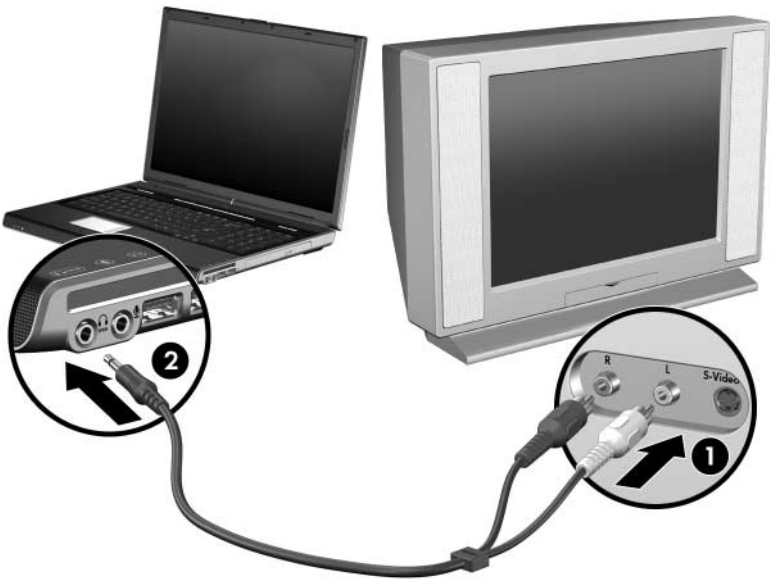

3. Turn on your TV.
4. Be sure your TV is set to view the correct video source (video 1, video 2, etc.).
5. Press **fn+f4** on your computer keyboard one or more times to display your computer screen on your TV.

If you connected your TV after running the Media Center Setup Wizard for the first time, you may need to reconfigure settings in Media Center.



If you have not run the Media Center Setup Wizard yet, you do not need to perform the following procedure. The Media Center Setup Wizard will walk you through all the configuration steps required for your connection.

To configure the way Media Center is displayed on your television, after the television is connected:

1. Open Media Center:
 - Press the **START** button on your remote.
 - or –
 - From your Windows desktop, select **Start > Media Center**.
2. Select **Settings > TV > Configure Your TV or Monitor**.
3. Follow the on-screen instructions.

Adding an audio receiver to your connection

Adding a stereo or surround sound audio receiver to your connection allows you to play music on your computer and listen to it on the audio receiver.

To add an audio receiver to your connection:



Audio receiver and computer features may vary. Refer to your audio receiver and computer user guide for the exact location and labeling of jacks.

1. Connect the red and white (right and left) plugs of an audio cable (not included) to the red and white (right and left) audio-in jacks on your audio receiver **1**.
2. Connect the other end of the audio cable to the headphone (audio-out) jack on the computer **2**.



If you connected your audio receiver after running the Media Center Setup Wizard for the first time, you may need to reconfigure settings in Media Center.



If you have not run the Media Center Setup Wizard yet, you do not need to perform the following procedure. The Media Center Setup Wizard will walk you through all the configuration steps required for your connection.

To configure external speakers (either directly connected to your computer or to an audio receiver that is connected to your computer) in Media Center:

1. Open Media Center:
 - Press the **START** button on your remote.
 - or –
 - From your Windows desktop, select **Start > Media Center**.
2. Select **Settings > General > Media Center Setup > Set Up Your Speakers**.
3. Follow the on-screen instructions.

Remote control

The HP Media Center Remote Control is designed to work with the Windows XP Media Center 2005 operating system.

Use the remote control to open the Media Center application, change channels, view and record television programs, play previously recorded TV programs, and play music, movies, or video. The remote control helps you navigate the Media Center windows on your computer just as a cable TV remote control navigates cable TV options or controls the playback of a movie in a VCR or DVD player.



The remote control cannot

- Navigate the Windows desktop or control computer applications outside of Media Center.
 - Be used as a remote control for a VCR, DVD player, or stereo through Media Center.
 - Turn the computer on or off.
 - Turn on or turn off a TV connected to your computer.
-

Remote control buttons

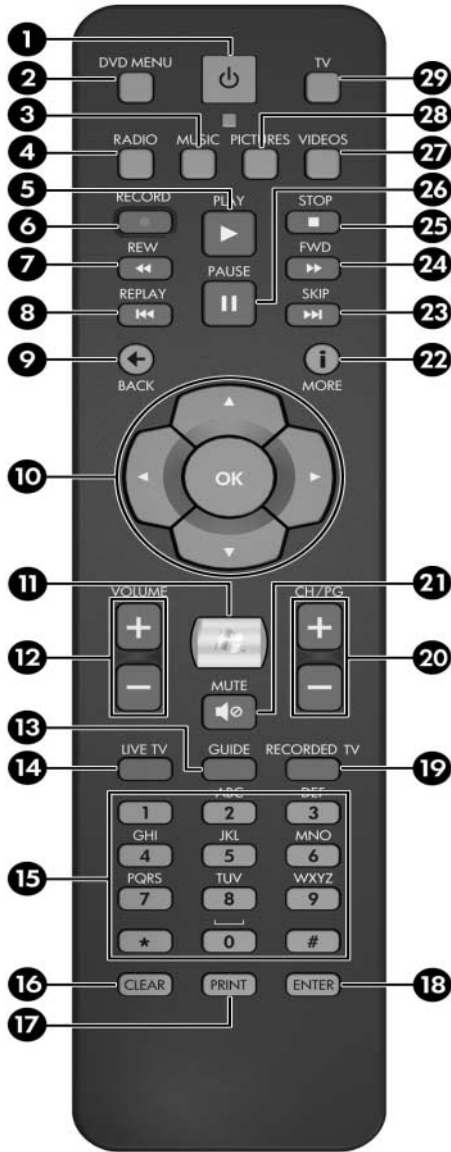



Button	Description
① POWER	Puts the computer into and brings it out of a power-reduced state.
② DVD MENU	Opens the main menu on a DVD movie, if available.
③ MUSIC	Selects My Music, where you can access, manage, record, and play music files.
④ RADIO	Selects FM Radio as your media source (optional).
⑤ PLAY	Plays selected media.
⑥ RECORD	<ul style="list-style-type: none"> ■ Records TV programs. The RECORD button works only when My TV is used to play a TV show. It is inactive when other media are playing. ■ To record a TV show while watching live TV or viewing the Program Guide, press RECORD once. ■ To record a TV series while viewing the Program Guide, press RECORD twice. ■ To cancel a recording, press RECORD repeatedly while viewing the Program Guide until the record icon disappears.
⑦ REW	<ul style="list-style-type: none"> ■ Rewinds selected media. To increase the rewinding speed, press the REW button again. <p> The REW button does not work with MP3 files and may not work with some video files.</p> <ul style="list-style-type: none"> ■ Moves video backward. ■ Moves a live TV program to the beginning of the 30-minute pause buffer. ■ Moves the television Program Guide back 3 hours. ■ Deactivates instant replay when you press it and then the PLAY button.
⑧ REPLAY	<ul style="list-style-type: none"> ■ Moves backward 7 seconds in live TV. ■ Moves backward 12 hours in the Program Guide.
⑨ BACK	Returns to the previous window within Media Center.

(Continued)

Button	Description
10 ARROWS, OK	<p>ARROWS move between menus, windows, or activities. Arrows move the cursor to select actions within the Media Center windows.</p> <p>OK selects a desired action and works as the ENTER button. If you are watching live TV, press the OK button to go to the previous channel. Press the OK button again to toggle back to the original channel you were watching.</p>
11 START	Opens the Media Center main menu.
12 VOL	Increases and decreases computer volume.
13 GUIDE	Opens the electronic television Program Guide.
14 LIVE TV	<ul style="list-style-type: none"> ■ Moves a TV program forward to the end of the pause buffer and resumes playing live TV. When you pause a TV program, you can use the LIVE TV button to move forward to live TV. ■ Opens Media Center and then begins playing live TV in full-screen mode.
15 KEYPAD	<p>Numeric keypad buttons change channels or enter text into a text box.</p> <p> Each time you press a number button, a different character (letter) is displayed. Press the Enter button to select a character.</p>
16 CLEAR	Clears or deletes the last character entered.
17 PRINT	Prints pictures that you select in the My Pictures window. This button does not print files from Windows Explorer.
18 ENTER	Enters or selects the desired action, menu, or window option.
19 RECORDED TV	Opens the Recorded TV window where all your recorded TV programs are stored. From this window, you can search for and play back a recorded show.
20 CH/PG	Changes TV channels or moves pages up (+) and down (-), depending on the available options. Moves to the next DVD chapter.

(Continued)

Button	Description
21 MUTE	Turns off computer sound. The word "Mute" is displayed on the screen when Mute is turned on.
22 MORE	<p>Displays available information about a selected media file, such as a TV program summary or music artist information. It also displays options to rotate or print your pictures.</p> <p> You may need to be connected to the Internet to receive some media information.</p> <p> Some media may not include this information.</p>
23 SKIP	<ul style="list-style-type: none"> ■ Advances 30 seconds in live TV or in a recorded program. ■ Advances one music track in a CD. ■ Advances 12 hours in the television Program Guide.
24 FWD	<ul style="list-style-type: none"> ■ Moves selected video media forward. To increase the fast forwarding speed, press the FWD button up to 3 times. <p> The FWD button may not work with some video files.</p> <ul style="list-style-type: none"> ■ Moves MP3 music files forward. ■ Moves a video forward. ■ Moves the television Program Guide forward 3 hours.
25 STOP	Stops selected media. When the STOP button is pressed while you are watching TV, the Media Center pause buffer continues to record in the background.
26 PAUSE	Pauses selected media. To play media frame by frame in slow motion, press the PAUSE button and then the FWD button repeatedly. To continue slow motion, press the FWD button more than once.

(Continued)

Button	Description
27 VIDEOS	Selects My Videos, where you can access, manage, and play previously recorded video files.
28 PICTURES	Selects My Pictures, where you can access, manage and share pictures, plus create slideshows.
29 TV	Selects My TV, which allows you to manage your TV viewing experience. Stop, pause, rewind, or fast forward live TV and recorded TV.

Using the remote control

To use the remote control:

1. Be sure the remote control batteries are installed. Refer to [“Replacing the remote control batteries”](#) for details.
2. Be sure the remote sensor is connected to the computer. Refer to Chapter 3, [“TV tuner setup,”](#) for details.
3. Point the remote control at the remote sensor.

 The remote sensor should be located in a convenient place. Be sure that nothing blocks the path between your remote control and the remote sensor.

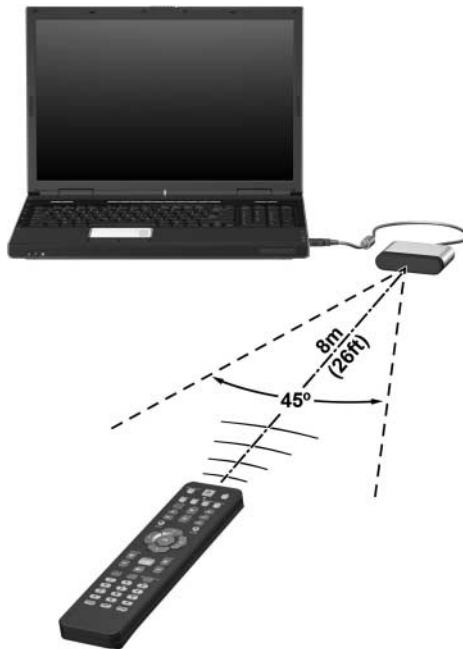

Use the remote control at a maximum distance of 8 m (26 ft) from the remote sensor and at a maximum of 22.5 degrees (45 degrees total) off center of the remote sensor.

When you press a button on the remote control, the remote sensor light on the remote control will blink briefly, indicating that the remote control is sending a signal to the TV tuner. You must point the remote control at the remote sensor for the signal to be received.



Replacing the remote control batteries

To replace the remote control batteries:

1. Turn the remote control over with the back facing up.
2. Remove the battery cover ❶.
3. Remove the old batteries and insert new batteries ❷.
4. Replace the battery cover ❸.

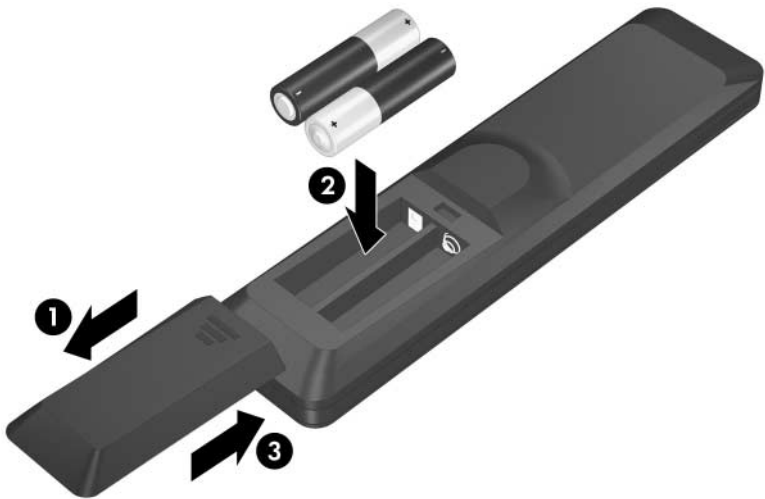

A

Troubleshooting

For help in troubleshooting problems with your Media Center hardware, refer to the following pages.

If your problem is not addressed in this guide, refer to the Media Center Help files by selecting the question mark icon on the Media Center menu bar at the top of the screen.



The Media Center menu bars are only visible during or shortly after mouse or TouchPad activity. If you do not see the Media Center menu bars, briefly activate your mouse or TouchPad.

For more information on getting help, refer to “[Getting help](#)” in Chapter 1, “[Introduction](#).”

Problem	Solution
My remote control does not work.	<ul style="list-style-type: none">■ Be sure you are using the HP Media Center Remote Control and not an unsupported remote control.■ Be sure the remote sensor is connected to the computer. Refer to Chapter 3, “TV tuner setup.”■ If you are using TV, be sure the remote control has a clear line-of-sight with the remote sensor. Refer to “Using the remote control” in Chapter 5.■ If the remote control has worked without any problems until recently, try replacing the batteries. Refer to “Replacing the remote control batteries” in Chapter 5.■ If the remote control works in Media Center but not when changing channels, you must reconfigure the Media Center software settings for the cable or satellite set-top box. Run setup again by selecting Settings > General > Media Center Setup > Run Media Center Setup Again.■ Check all cable connections going to and from the TV tuner.■ If using a set-top box:<ul style="list-style-type: none"><input type="checkbox"/> Be sure the IR emitter cable is securely and properly connected from the remote sensor to the set-top box.<input type="checkbox"/> Be sure the set-top box is on and receiving power.■ Close Media Center, restart the computer, and then open Media Center again.
I am using a TV in my setup, but I cannot see anything on the TV screen.	Confirm that the TV is properly connected to the computer. Refer to “ Adding a TV to your connection ” in Chapter 4.

(Continued)

Problem	Solution
My TV tuner is connected to a TV antenna but I do not get a broadcast signal.	Media Center does not automatically detect TV antenna signals during the setup process. In order to properly get a TV antenna configuration setup, select the manual configuration option rather than the automatic configuration option during the TV signal setup.
Picture quality is poor when I watch live TV.	<ul style="list-style-type: none"> ■ Be sure all cables are properly connected. ■ If you have basic cable, try a signal booster. A weak signal will cause picture quality to be degraded. ■ Confirm that you subscribe to the channel you are watching.
I cannot record a movie that is playing on a premium channel.	Some premium channels use copy protection technology to prohibit or degrade recorded movies.
I want to use an external hard drive, secondary hard drive, or optional expansion base hard drive to store my TV programs.	<p>Perform the following procedure:</p> <ol style="list-style-type: none"> 1. Be sure your external hard drive is connected to your computer or optional expansion base. 2. If using an optional expansion base, be sure it is connected to the computer. 3. Press the START button on the remote control to open Media Center. 4. Select Settings > TV > Recorder > Recorder Storage. 5. Under Record on drive, select the hard drive you want to store your recordings. 6. Select Save. <p>All future TV recordings will now be saved to the external hard drive.</p>

(Continued)

Problem	Solution
I hear no sound, or the volume is too low in Media Center.	<p>The Windows Media Player and Windows XP Media Center share certain audio device control settings. If volume settings in Media Center do not meet your expectations, check the following:</p> <ul style="list-style-type: none">■ Open Windows Media Player application and verify that the volume settings are not muted or turned down too low.■ Verify that the Windows system volume control settings are not muted or turned down too low:<ul style="list-style-type: none">□ Double-click the volume control icon in the Windows notification area, at the right of the taskbar.– or –□ Select Start > Control Panel > Sounds, Speech, and Audio Devices > Sounds and Audio Devices.

B

Glossary

composite audio/video—An audio/video transmission type that provides improved video quality over RF coaxial. Can be used instead of RF coaxial in setups that use a cable or satellite set-top box. A composite audio/video cable is provided.

Digital Video Recorder—*See TV tuner.*

ExpressCard—An ExpressCard is a next-generation, high-performance PC Card that must be inserted in the ExpressCard slot. An ExpressCard can add TV tuner functionality to the computer.

infrared (IR) lens—A device on your set-top box that receives infrared signals from your remote.

Media Center—A version of the Microsoft Windows XP operating system that is enhanced for home entertainment. Used with the TV tuner to enable you to watch and record television on your computer.

remote sensor—Connects to the USB port on the computer. When connected, you can change channels using the Media Center Remote Control.

RF coaxial—An audio/video transmission type that provides standard video quality. RF coaxial cables are used to connect your TV source to the TV tuner.

set-top box—A device that enables your television to receive cable or satellite broadcasts. In your Media Center setup, the set-top box is connected to the TV tuner to enable your computer to receive cable or satellite broadcasts. Set-top boxes are provided by your cable or satellite service.

S-Video—A video transmission type that provides improved video quality over RF coaxial and composite video types.

TV tuner—The TV tuner allows you to watch and record TV programming on your computer.

Index

A

audio

- connecting a stereo 4-10
- connecting a television 4-8
- connecting composite 4-4
- connecting S-Video 4-6
- troubleshooting A-4

audio problems A-4

audio receiver, connecting 4-10

B

battery, remote control 5-9

buttons, remote control 5-2

C

cables

- additional, not included
2-1

- IR emitter 2-3

composite audio/video cable 2-2

composite video

- connecting to set-top box
4-3

- defined D-1

- video quality 4-3

computer, setting up 3-1

connections 3-1, 3-2

D

Digital Video Recorder. *See* TV tuner

E

ExpressCard 2-2

F

features 1-1, 1-2

H

hard drive, external A-3

help 1-3, A-1

I

infrared lens D-1

Internet connection 1-2, 2-1

IR emitter cable

- connecting 3-8
- identifying 2-3

IR receiver

- using remote control 3-11,
5-7, 5-8

M

Media Center Help 1-3

Media Center menu bars 1-3, A-1

Media Center Setup Wizard
3–12

Media Center, configure
settings 4–9, 4–11

O

operating system 1–1

P

planning 1–2, 3–1

R

remote control

 buttons 5–2

 distance for use 5–7

 features 5–1

 identifying 2–3

 overview 5–1

 remote sensor light 5–8

 replacing battery 5–9

 troubleshooting A–2

 using 5–7

remote sensor 2–3

remote sensor light, remote
control 5–8

RF coaxial

 defined D–1

 video quality 4–3

S

set-top box

 connecting composite
 video 4–3

 connecting S-Video 4–3

 defined D–1

speaker settings 4–11

stereo, connecting 4–10

S-Video

 defined D–2

 video quality 4–3

S-Video cable 2–2

 connecting television 4–7

 connecting to set-top box
 4–3

T

television

 connecting 4–7

 display settings 4–9

 troubleshooting A–2

third-party software 1–1

troubleshooting A–1

TV antenna A–3

TV source 2–1

TV tuner

 defined D–2

 identified 2–2

V

video

 connecting composite 4–4

 connecting S-Video 4–5

 troubleshooting A–3

video quality 4–3, A–3

video types supported 4–3

volume, problems with A–4

W

Windows Media Player A–4