



# **Hardware Setup**

## HP ExpressCard Digital/Analog TV Tuner

Document Part Number: 438624-001

December 2006

This guide provides information to help you set up your HP ExpressCard Hybrid Digital/Analog TV Tuner to use with your computer and the Windows Vista™ operating system.

© Copyright 2006 Hewlett-Packard Development Company, L.P.

Windows Vista is either a trademark or registered trademark of Microsoft Corporation in the United States and/or other countries.

The information contained herein is subject to change without notice. The only warranties for HP products and services are set forth in the express warranty statements accompanying such products and services. Nothing herein should be construed as constituting an additional warranty. HP shall not be liable for technical or editorial errors or omissions contained herein.

Hardware Setup  
HP ExpressCard Digital/Analog TV Tuner  
First Edition: December 2006  
Document Part Number: 438624-001

---

# Contents

## 1 Introduction

Before you begin . . . . .	1-2
Getting help . . . . .	1-3
Getting help for Windows Media Center . . . . .	1-3
Getting help for QuickPlay . . . . .	1-3

## 2 Identifying the hardware

Setup components . . . . .	2-1
----------------------------	-----

## 3 TV tuner setup

Step 1: Set up your computer . . . . .	3-1
Step 2: Set up your audio/video connection . . . . .	3-1
Step 3: Connect the remote sensor . . . . .	3-8
Step 4: Complete the setup . . . . .	3-11
Running the Setup Wizard . . . . .	3-12

## 4 Advanced connections

TV tuner cable components . . . . .	4-2
Using composite video or S-Video (set-top box connections only) . . . . .	4-3
Composite video . . . . .	4-4
S-Video . . . . .	4-5
Adding a TV to your connection . . . . .	4-6
Configuring the TV display . . . . .	4-9
Adding an audio receiver to your connection . . . . .	4-10

## **5 Remote control**

Remote control buttons . . . . .	5-2
Using the remote control . . . . .	5-6
Replacing the remote control batteries. . . . .	5-9

## **A Troubleshooting**

## **B Glossary**

## **Index**

---

## Introduction

This guide provides instructions for connecting the HP ExpressCard Digital/Analog TV Tuner to your computer using your existing cable/satellite setup or the antenna included.

When connected, the TV tuner lets you use your computer like a standard TV and video recorder, allowing you to watch and record TV programs, and schedule TV recordings. This guide describes the most common connections.



The TV tuner is designed to be used with the Windows Vista™ operating system and Windows Media Center or QuickPlay. Other third-party software applications may work with the TV tuner, but are not supported by HP.



**CAUTION:** In certain areas, digitally broadcast ATSC signals may not be available. Under these circumstances, you will not be able to set up the TV tuner with the antenna. Instead, set up the TV using your regular TV or cable TV wall jack.

---

## Before you begin

Review this guide carefully to determine the most appropriate connection for your equipment. Refer to Chapter 3, “[TV tuner setup](#),” for information on the most common connections.

Additional connections, such as adding a TV to your setup, are described in Chapter 4, “[Advanced connections](#).”

Consider the following factors when setting up your connection:

- How often you plan to use the TV tuner
- Whether you plan to use a cable/satellite signal source or a digitally broadcast ATSC signal
- The proximity of a cable/satellite signal source to your computer
- Existing home entertainment equipment you want to include in your setup
- Whether you want to view TV content on your computer or on your TV
- Which media software you want to use—QuickPlay or Windows Media Center



QuickPlay is preinstalled on your computer and may be used with any version of the Windows Vista operating system. Windows Media Center is included in only the Premium and Ultimate editions of Windows Vista. If you have the Basic or Business edition of Windows Vista, you must use QuickPlay. Refer to the next section, “[Getting help](#),” for more information.

---

To fully utilize TV tuner features, your computer should have Internet access so you can download and view TV guide listings for your broadcast area or cable/satellite service provider.

Without Internet access, you will only be able to view live TV and will not be able to schedule recordings. For more information on required and optional equipment, refer to Chapter 2, “[Identifying the hardware](#).”

## Getting help

If you have any difficulty with the setup process, refer to Appendix A, “[Troubleshooting](#),” for help. For help with your software, refer to one of the following sections.

### Getting help for Windows Media Center

If you are having trouble with Windows Media Center, refer to Windows Help and Support:

From your Windows desktop, select **Start > Help and Support**.

### Getting help for QuickPlay

If you are having trouble with QuickPlay, refer to the QuickPlay Help menu:

1. Open QuickPlay:

Press the **QuickPlay** button on your remote.

– or –

From your Windows desktop, select **Start > All Programs > QuickPlay**.

2. Select the **TV** icon on the menu bar at the bottom of the screen.

3. Select the question mark icon on the menu bar on the left side of the screen.



You can also access QuickPlay Help by selecting the home, music, or camera icons.

---

## Identifying the hardware

### Setup components

Unpack your TV tuner. In addition to the items provided with the TV Tuner, you will also need the following items (purchased separately):

- Computer with a Windows Vista operating system and required computer equipment (such as an AC adapter).
- A working Internet connection (required for features such as scheduling recordings and accessing the Program Guide).
- A working TV signal source (either a digitally broadcast ATSC signal or a cable/satellite signal). Your TV source may also require a cable or satellite set-top box.
- An RF coaxial cable (purchased separately) for a wall connection.
- A television (optional).
- S-Video and audio-out Y cables or optional media cable (compatible with select models only) if connecting a television.
- Additional cables (composite video or S-Video) for some advanced connections or to facilitate your cable length requirements.





The following components are included with your TV tuner. Depending on your connection, not all components are required.



Component	Description
<b>1</b> HP ExpressCard Digital/Analog TV Tuner	Provides input and output jacks for the antenna or media cables.
<b>2</b> TV tuner antenna	Receives standard and high definition digital broadcast signals.
<b>3</b> Composite audio/video and S-Video cable	Connects a cable or satellite set-top box to the TV tuner for higher audio/video quality over RF coaxial (optional).
	For information comparing RF coaxial, S-Video, and composite video, refer to Chapter 4, “ <a href="#">Advanced connections</a> .”

(Continued)

Component	Description
<p>④ Infrared (IR) emitter cable</p> 	Connects the TV tuner to your cable or satellite set-top box. When connected, you can change channels on the set-top box using the HP MediaBuddy Remote Control.
<p>⑤ Remote sensor</p>	Connects to the USB port on the computer. When it is connected, you can change channels using the HP MediaBuddy Remote Control.
<p>⑥ RF coaxial cable adapter</p> 	Connects an RF coaxial cable to the TV tuner.
<p>⑦ HP MediaBuddy Remote Control</p>	Used to change channels and navigate.
<p> For more information on composite video, RF coaxial, S-Video, and other terms, refer to Appendix B, “<a href="#">Glossary</a>.”</p>	

---

## TV tuner setup

### Step 1: Set up your computer

If you have not already set up your computer, refer to the printed *Setup Instructions poster*, included with your computer, for details.

### Step 2: Set up your audio/video connection

Three common connections are detailed in the following sections. The connection you use depends on what you want to do with your audio/video setup and on the type of TV input you use.

Consider the following factors when setting up your connection

- How often you plan to use the TV tuner
- Whether you plan to use a cable/satellite signal source or a digitally broadcast ATSC signal
- The proximity of a cable/satellite signal source to your computer
- Existing home entertainment equipment you want to include in your setup
- Whether you want to view TV content on your computer or on your TV
- Which media software you want to use—QuickPlay or Windows Media Center



QuickPlay is preinstalled on your computer and may be used with any version of the Windows Vista operating system. Windows Media Center is included in only the Premium and Ultimate editions of Windows Vista. If you have the Basic or Business edition of Windows Vista, you must use QuickPlay.

---

Connecting the TV tuner allows you to perform the following actions:

- Watch and/or record a live TV program on your computer.

– or –

- Record one live TV program while watching a previously recorded TV program.

Some advanced setup instructions are also provided. Refer to Chapter 4, “[Advanced connections](#),” for instructions on the following tasks:

- Using composite video or S-Video with your cable or satellite set-top box.
  - Adding a TV or stereo to your configuration.
- 



Depending on how you set up your TV tuner, you may not use all of the cables.

---

The type of connection you use will depend on your existing TV source and the availability of a digital broadcast. Refer to the following table for more information.

<b>Your TV Source</b>	<b>Refer to Section</b>
Digitally broadcast ATSC TV signal	<a href="#">“Connection 1: Connecting with an antenna”</a>
Regular TV without set-top box	<a href="#">“Connection 2: Connecting with regular TV or cable TV without a set-top box”</a>
Cable TV without set-top box	<a href="#">“Connection 2: Connecting with regular TV or cable TV without a set-top box”</a>
Cable TV with set-top box	<a href="#">“Connection 3: Connecting with satellite TV or cable TV with a set-top box”</a>
Satellite TV with set-top box	<a href="#">“Connection 3: Connecting with satellite TV or cable TV with a set-top box”</a>



ATSC digital TV may be broadcast in either standard definition, approximately 640x480 (480i), or high definition, approximately 1920x1080 (1080i).

## Connection 1: Connecting with an antenna

---



The antenna cable length is not shown to scale.

---

To install the TV tuner and connect it to the TV tuner antenna:

1. Insert the TV tuner **1** into the ExpressCard slot on the computer.



The location of the ExpressCard slot varies by computer model. Refer to the user guide for your computer.

2. Connect the TV tuner antenna cable **2** to the TV tuner.

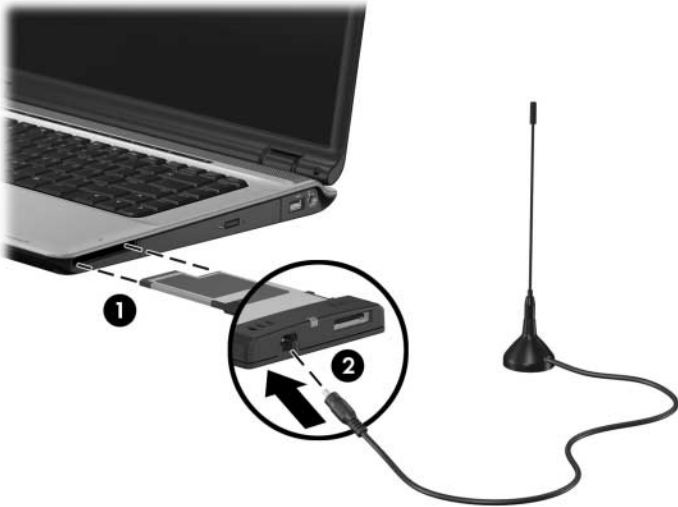

3. Connect the remote sensor to a USB port on the computer. Refer to “[Step 3: Connect the remote sensor](#),” for details.
4. Complete the setup of your TV tuner. Refer to “[Step 4: Complete the setup](#),” later in this chapter.



For additional connection steps, such as adding a television, refer to Chapter 4, “[Advanced connections](#).”

---

---

## Connection 2: Connecting with regular TV or cable TV without a set-top box

---



Computer features may vary. Cable lengths are not shown to scale.

---

To connect the TV tuner to your regular TV or cable TV source without a set-top box:

1. Insert the TV tuner **1** into the ExpressCard slot on the computer.
2. Connect the RF coaxial cable adapter **2** to the TV tuner.
3. Connect an RF coaxial cable from the RF coaxial cable adapter on the TV tuner **3** to your regular TV or cable TV wall jack **4**.

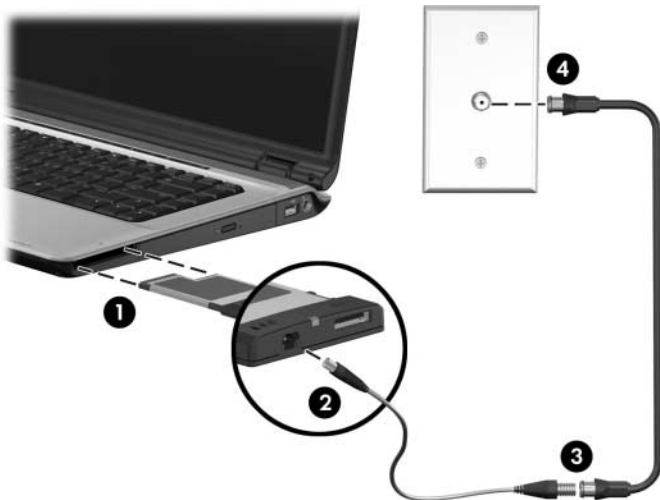

4. Connect the remote sensor to a USB port on the computer. Refer to “[Step 3: Connect the remote sensor,](#)” for details.
5. Complete the setup of your TV tuner. Refer to “[Step 4: Complete the setup,](#)” later in this chapter.



For additional connection steps, such as adding a television, refer to Chapter 4, “[Advanced connections.](#)”

---

## Connection 3: Connecting with satellite TV or cable TV with a set-top box

---



Refer to your cable or satellite set-top box user guide for the exact location and labeling of components.

---



Computer features may vary. Cable lengths are not shown to scale.

---

To connect the TV tuner to your existing satellite TV or cable TV source with a set-top box:

1. Connect an RF coaxial cable from your cable or satellite TV wall jack **1** to the TV-In jack on your cable or satellite set-top box **2**.
2. Connect an RF coaxial cable from the TV-Out jack **3** on your cable or satellite set-top box to the RF coaxial cable adapter **4**.



For improved video quality you can connect your set-top box to the TV tuner using a composite video or S-Video cable instead of an RF coaxial cable. Refer to Chapter 4, “[Advanced connections](#),” for instructions.

3. Connect the RF coaxial cable adapter **5** to the TV tuner.
4. Insert the TV tuner **6** into the ExpressCard slot on the computer.



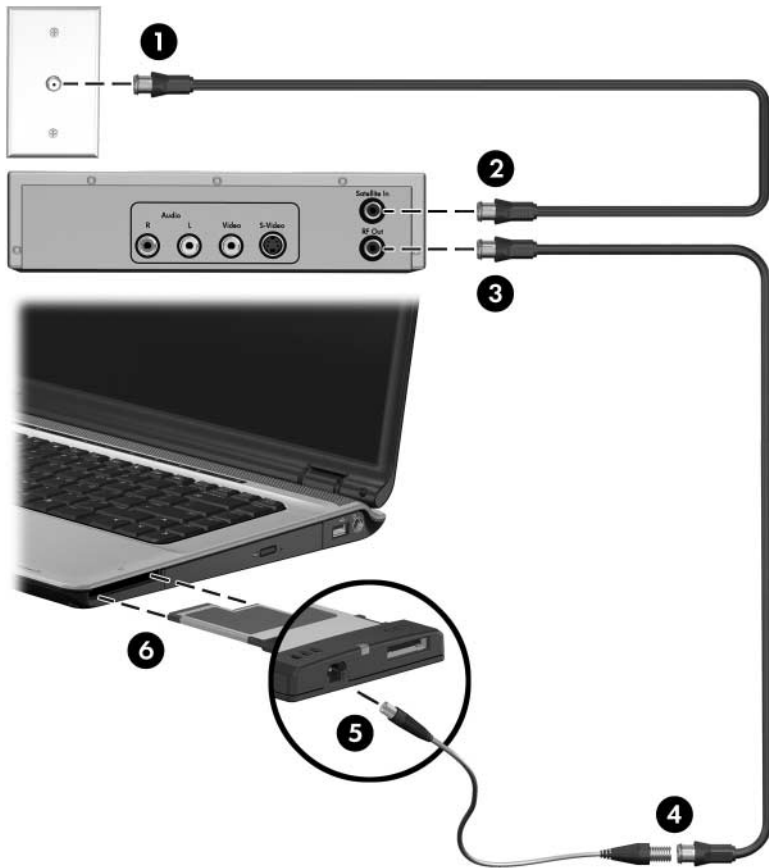

5. Connect the remote sensor to a USB port on the computer. Refer to “[Step 3: Connect the remote sensor](#),” for details.
6. Complete the setup of your TV tuner. Refer to “[Step 4: Complete the setup](#),” later in this chapter.



For additional connection steps, such as adding a television, refer to Chapter 4, “[Advanced connections](#).”

## Step 3: Connect the remote sensor

To change channels using the HP MediaBuddy Remote Control, the remote sensor must be connected to your computer:

1. Connect the remote sensor to a USB port on the computer.

 You can connect the remote sensor to any USB port on your computer.



2. Connect the infrared (IR) emitter cable from the IR receiver to the set-top box.

If you did not include a set-top box in your setup, proceed to “[Step 4: Complete the setup](#),” later in this chapter.

- a. Connect the IR emitter cable plug to the connector on the remote sensor ❶.

 Be sure that you connect the IR emitter cable plug to the connector marked with a “1” on the remote sensor.

- b. Remove the backing paper from the IR emitter to expose the adhesive tape ❷.
- c. Press the adhesive side of the IR emitter onto the infrared (IR) lens on the front of the set-top box ❸.

 To help locate the IR lens, shine a flashlight on the front of the set-top box. The IR lens is usually a small, dark red window.

 If you cannot place the emitter directly over the IR lens, place it as close to the IR lens as possible.



After the IR emitter is connected to the set-top box, you can use the HP MediaBuddy Remote Control to change the channels.



3. Complete the setup of your TV tuner. Refer to “[Step 4: Complete the setup](#),” later in this chapter.



For additional connection steps, such as adding a television, refer to Chapter 4, “[Advanced connections](#).”

---

## Step 4: Complete the setup

Complete the following steps to finish the setup procedure:

1. Turn on the computer.
2. Point the remote control at the remote sensor and then press the **Start 1** or **QuickPlay 2** button on your remote control to open your software. Refer to Chapter 5, “[Remote control](#),” for information on using the remote control.



3. When the Setup Wizard opens, follow the on-screen instructions to set up your software.

## Running the Setup Wizard

If the Setup Wizard fails to open after you perform the preceding steps, or if you have already run the Setup Wizard and would like to run it again, perform either of the following procedures:

1. Select **Tasks > Settings > General > Windows Media Center Setup > Run Setup Again**.
2. Follow the on-screen instructions.



If this is not the first time you have run the Setup Wizard, you will lose any existing Windows Media Center settings and preferences.

– or –

1. Select the **TV** icon on the menu bar.
2. Select the **i** icon on the menu bar at the left of the screen.
3. Select **Run Setup Wizard** from the menu.

---

## Advanced connections

The following sections provide additional setup instructions for these connections:

- Using composite video or S-Video instead of RF coaxial (for connections with cable or satellite set-top boxes only)
- Adding a television to your connection
- Adding a stereo to your connection



You must complete the steps in Chapter 3, “[TV tuner setup](#),” for these advanced connections to work.

---



The connection from the TV tuner to the antenna is not shown in the following illustrations.

---

## TV tuner cable components

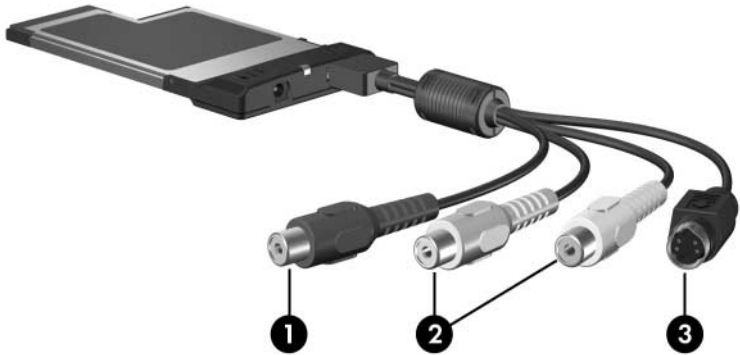

Component	Description
❶ Composite video cable	Connects to video equipment for composite video input.
❷ Composite audio cables (2)	Connects to video equipment for composite audio input.
❸ S-Video cable*	Connects to video equipment that supports S-Video input. Provides improved video performance over composite video.

\*S-Video may not be supported by your audio/video equipment. Refer to your audio/video equipment user guide for more information.



## Using composite video or S-Video (set-top box connections only)

If you are using a cable or satellite set-top box in your setup, you have the option of improving video quality by connecting a composite video or S-Video cable (instead of an RF coaxial cable) from your set-top box to the TV tuner.



Some advanced connections require additional cables purchased separately.

The following table compares the video types and associated video quality.

Supported Video Type	Video Quality
RF coaxial/antenna (standard definition)	Good
Composite	Better
S-Video	Best
Antenna (high definition)	Superior



If your computer and your TV support it, an HDMI connection provides superior video quality.



ATSC digital TV may be broadcast in either standard definition, approximately 640x480 (480i), or high definition, approximately 1920x1080 (1080i).

Refer to the following sections for instructions on connecting composite video or S-Video.

## Composite video

To connect composite video, complete the following steps:

1. Connect the composite audio/video cable **1** to the red, white, and yellow composite audio and video jacks on your cable or satellite set-top box.

 Refer to your cable or satellite set-top box user guide for the exact location and labeling of jacks.

2. Connect the other end of the composite audio/video cable **2** to the composite audio and video jacks on the TV tuner.

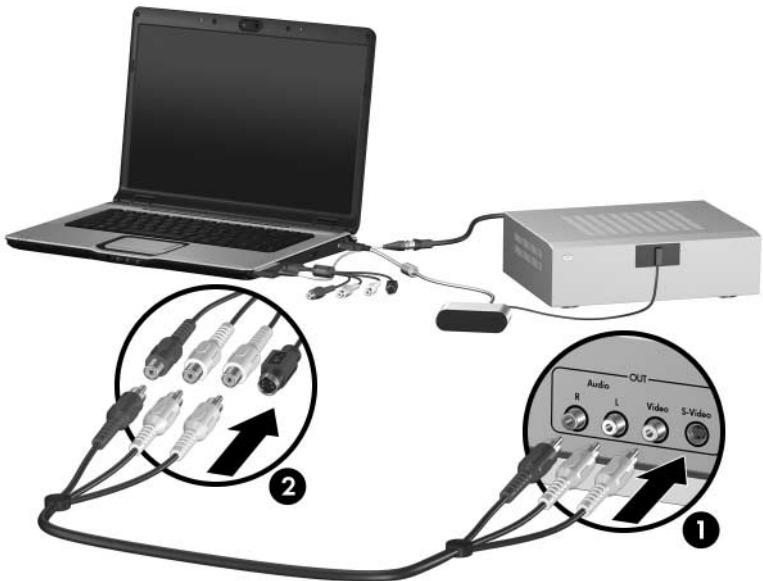

## S-Video

To connect S-Video, complete the following steps:

1. Connect the S-Video cable **1** to the S-Video-out jack on your cable or satellite set-top box.

 Refer to your cable or satellite set-top box user guide for the exact location and labeling of jacks.

2. Connect the red and white plugs on the composite audio/video cable **2** to the red and white audio jacks on your cable or satellite set-top box.

 Do not connect the yellow composite video plug.

3. Connect the S-Video cable and the red and white audio plugs on the composite audio and video cable **3** on the TV tuner.

 Do not connect the yellow composite video plug.

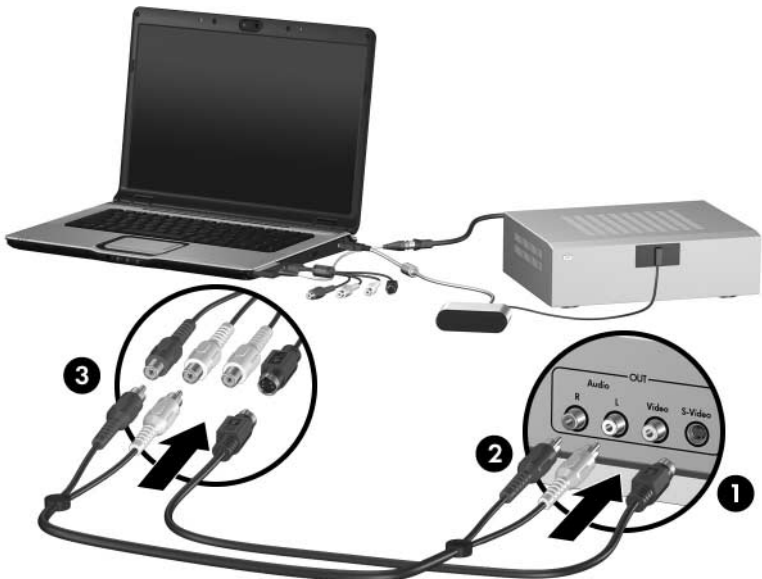

## Adding a TV to your connection

Adding a TV to your connection allows you to watch and listen to TV programs on the television as well as on your computer.



TV and computer features vary. Refer to your TV and computer user guides for the exact location and labeling of jacks.

---

To add a TV to your connection, complete the following steps:

1. Connect an S-Video cable (purchased separately) from the S-Video-in jack on your TV **1** to the S-Video-out jack on your computer **2**.

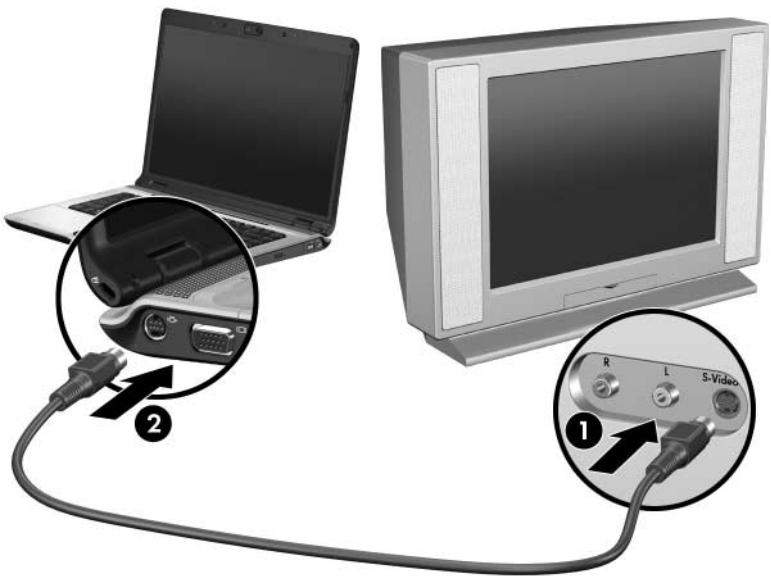

2. If you want to hear sound from your TV rather than from your computer, complete these steps:
  - a. Connect the red and white (right and left) plugs of an audio Y-cable (not included) to the red and white (right and left) audio-in jacks on your TV **1**.
  - b. Connect the other end of the audio cable to the headphone (audio-out) jack on the computer **2**.



If your TV has only one audio jack, connect the white audio plug and leave the red audio plug disconnected.

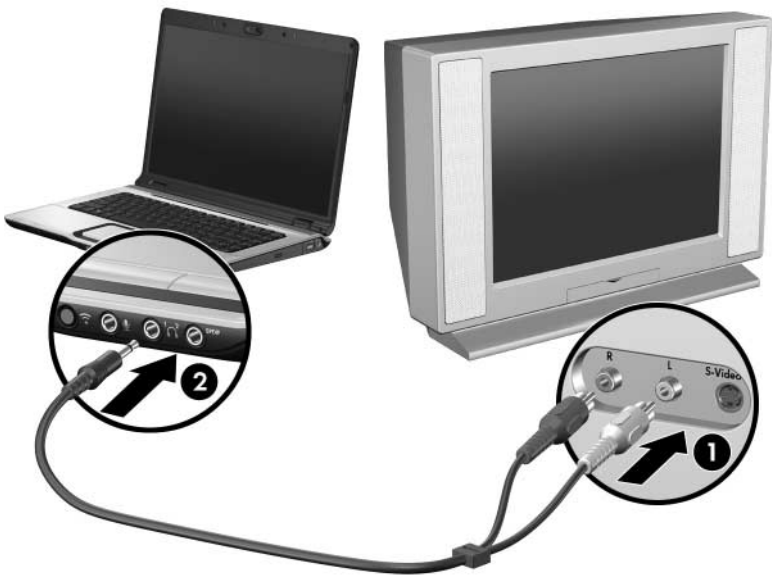

3. Turn on your TV.
4. Be sure your TV is set to view the correct video source (video 1, video 2, etc.).
5. Press **fn+f4** on your computer keyboard one or more times to display your computer screen on your TV.

If you connected your TV after running the Setup Wizard for the first time, you may need to reconfigure settings.

---



If you have not yet run the Setup Wizard, you do not need to perform the following procedure. The Setup Wizard will guide you through all the configuration steps required for your connection.

---

## Configuring the TV display

You can use either Windows Media Center or QuickPlay to configure the display on your TV.

To configure the TV display using Windows Media Center, follow these steps:

1. Open Windows Media Center:
  - ❑ Press the **Start** button on your remote.
  - or –
  - ❑ From your Windows desktop, select **Start > Windows Media Center**.
2. Select **Tasks > Settings > TV > Configure Your TV or Monitor**.
3. Follow the on-screen instructions.

– or –

To configure the TV display using QuickPlay, follow these steps:

1. Open QuickPlay:
  - ❑ Press the **QuickPlay** button on your remote.
  - or –
  - ❑ From your Windows desktop, select **Start > All Programs > QuickPlay**.
2. Select the **TV** icon on the menu bar.
3. Select the **i** icon on the menu bar at the left of the screen.
4. Select **Screen Ratio** from the menu.
5. Follow the on-screen instructions.

## Adding an audio receiver to your connection

Adding a stereo or surround sound audio receiver to your connection allows you to play music on your computer and listen to it on the audio receiver.

To add an audio receiver to your connection:



Audio receiver and computer features may vary. Refer to your audio receiver and computer user guide for the exact location and labeling of jacks.

---

1. Connect the red and white (right and left) plugs of an audio cable (not included) to the red and white (right and left) audio-in jacks on your audio receiver **1**.
2. Connect the other end of the audio cable to the headphone (audio-out) jack on the computer **2**.





## Configuring external speakers

If you connected your audio receiver after running the Setup Wizard for the first time, you may need to reconfigure settings.



If you have not yet run the Setup Wizard, you do not need to perform the following procedure. The Setup Wizard will guide you through all the configuration steps required for your connection.

You can use either Windows Media Center or QuickPlay to configure external speakers (either directly connected to your computer or to an audio receiver that is connected to your computer).

To configure the external speakers using Windows Media Center, follow these steps:

1. Open Windows Media Center:
  - Press the **Start** button on your remote.
  - or –
  - From your Windows desktop, select **Start > Windows Media Center**.
2. Select **Tasks > Settings > General > Windows Media Center Setup > Set Up Your Speakers**.
3. Follow the on-screen instructions.

– or –

To configure the external speakers using QuickPlay, follow these steps:

1. Open QuickPlay:
  - Press the **QuickPlay** button on your remote.
  - or –
  - From your Windows desktop, select **Start > All Programs > QuickPlay**.

---

## Remote control

The HP MediaBuddy Remote Control is designed to work with the Windows Vista operating system.

Use the remote control to open media applications, change channels, view and record television programs, play previously recorded TV programs, and play music, movies, or video. The remote control helps you navigate the windows on your computer just as a cable TV remote control helps you navigate cable TV options or control the playback of a movie on a VCR or DVD player.



The remote control cannot perform the following functions:

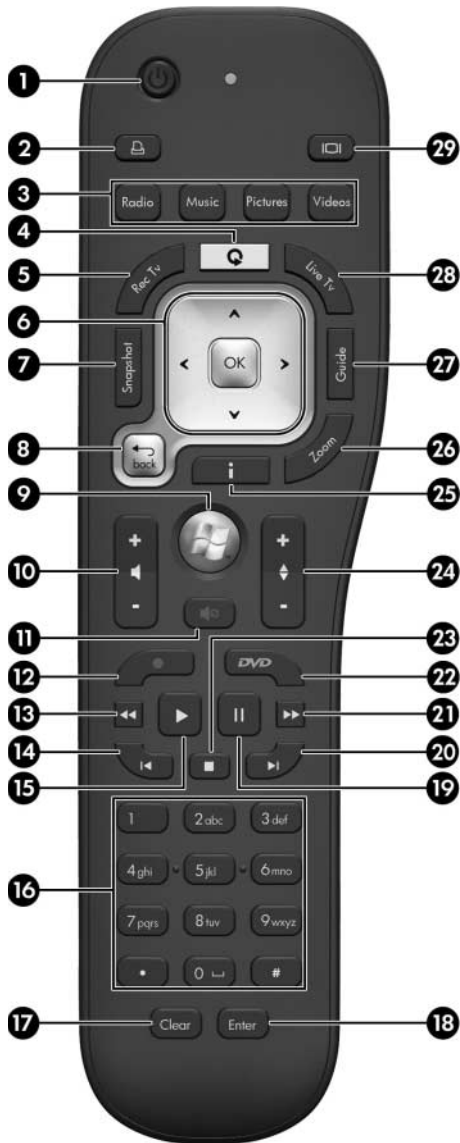

- Act as a remote control for a VCR, DVD player, or stereo
  - Turn the computer on or off
  - Turn on or turn off a TV connected to your computer
-

# Remote control buttons





Button	Description
① Power	Puts the computer into and brings it out of a power-reduced state.
② Print	Prints pictures that you select in the My Pictures window. This button does not print files from Windows Explorer.
③ Media	Radio selects FM Radio as your media source. Music selects My Music, where you can access, manage, record, and play music files. Pictures selects My Pictures where you can access, manage, and share pictures, as well as create slideshows. Videos selects My Videos where you can access, manage, and play previously recorded video files.
④ QuickPlay	Opens QuickPlay.
⑤ Recorded TV	Opens the Recorded TV window where all your recorded TV programs are stored. From this window, you can search for and play back a recorded show.
⑥ Arrows, OK	Arrows move between menus, windows, or activities. Arrows also move the pointer to select actions within the Windows Media Center windows. OK selects a desired action and works as the Enter button. If you are watching live TV, press the <b>OK</b> button to go to the previous channel. Press the <b>OK</b> button again to toggle back to the original channel you were watching.
⑦ Snapshot	Captures a picture of the computer screen and saves it to the clipboard.
⑧ Back	Returns to the previous window within media software.
⑨ Start	Opens the Windows Media Center main menu
⑩ Volume	Increases and decreases computer sound.
⑪ Mute	Turns off computer sound. The word "Mute" is displayed on the screen when Mute is turned on.

*(Continued)*

Button	Description
12 Record	<ul style="list-style-type: none"> <li>■ Records TV programs. The Record button works only when My TV is used to play a TV show. It is inactive when other media are playing.</li> <li>■ To record a TV show while watching live TV or viewing the Program Guide, press <b>Record</b> once.</li> <li>■ To record a TV series while viewing the Program Guide, press <b>Record</b> twice.</li> <li>■ To cancel a recording, press <b>Record</b> repeatedly while viewing the Program Guide, until the record icon disappears.</li> </ul>
13 Rewind	<ul style="list-style-type: none"> <li>■ Rewinds selected media. To increase the rewinding speed, press the <b>Rewind</b> button again.</li> </ul> <p data-bbox="394 626 928 675"> The Rewind button does not work with MP3 files and may not work with some video files.</p> <ul style="list-style-type: none"> <li>■ Moves video backward.</li> <li>■ Moves a live TV program to the beginning of the 30-minute pause buffer.</li> <li>■ Moves the television Program Guide back 3 hours.</li> <li>■ Deactivates instant replay when you press it and then the Play button.</li> </ul>
14 Replay	<ul style="list-style-type: none"> <li>■ Moves backward 7 seconds in live TV.</li> <li>■ Moves backward 12 hours in the Program Guide.</li> </ul>
15 Play	Plays selected media.
16 Keypad	<p data-bbox="394 1026 950 1075">Numeric keypad buttons change channels or enter text into a text box.</p> <p data-bbox="394 1107 928 1187"> Each time you press a number button, a different character (letter) is displayed. Press the <b>Enter</b> button to select a character.</p>
17 Clear	Clears or deletes the last character entered.
18 Enter	Enters or selects the desired action, menu, or window option.

(Continued)

Button	Description
19 Pause	Pauses selected media. To play media frame by frame in slow motion, press the <b>Pause</b> button and then press the <b>Forward</b> button repeatedly. To continue slow motion, press the <b>Forward</b> button more than once.
20 Skip	<ul style="list-style-type: none"> <li>■ Advances 30 seconds in live TV or in a recorded program.</li> <li>■ Advances one music track in a CD.</li> <li>■ Advances 12 hours in the television Program Guide.</li> </ul>
21 Forward	<ul style="list-style-type: none"> <li>■ Moves selected video media forward. To increase the fast forwarding speed, press the <b>Forward</b> button up to 3 times.</li> </ul> <p> The Forward button may not work with some video files.</p> <ul style="list-style-type: none"> <li>■ Moves MP3 music files forward.</li> <li>■ Moves a video forward.</li> <li>■ Moves the television Program Guide forward 3 hours.</li> </ul>
22 DVD menu	Opens the main menu on a DVD movie, if available.
23 Stop	Stops selected media. When the Stop button is pressed while you are watching TV, the Windows Media Center pause buffer continues to record in the background.
24 Change/Page	Changes TV channels or moves pages up (+) and down (-), depending on the available options. Moves to the next DVD chapter.
25 Information	<p>Displays available information about a selected media file, such as a TV program summary or music artist information. It also displays options to rotate or print your pictures.</p> <p> You may need to be connected to the Internet to receive some media information.</p> <p> Some media may not include this information.</p>

*(Continued)*

Button	Description
26 Zoom	Alternates between various aspect modes in TV.
27 Guide	Opens the electronic television Program Guide. Internet access may be required.
28 Live TV	<ul style="list-style-type: none"><li>■ Moves a TV program forward to the end of the pause buffer and resumes playing live TV. When you pause a TV program, you can use the <b>LIVE TV</b> button to move forward to live TV.</li><li>■ Opens the media software and then begins playing live TV in full-screen mode.</li></ul>
29 Switch screens	Switches the computer image between the computer display and an external display.

## Using the remote control

To use the remote control, complete the following steps:

1. Be sure the remote control batteries are installed. Refer to [“Replacing the remote control batteries”](#) for details.
2. Be sure the remote sensor is connected to the computer. Refer to Chapter 3, [“TV tuner setup,”](#) for details.
3. Point the remote control at the remote sensor.



The remote sensor should be located in a convenient place. Be sure that nothing blocks the path between your remote control and the remote sensor.

4. Press the **Start ①** or **QuickPlay ②** button on your remote control to open your software.





The remote control must be pointed at the remote sensor when any button is pushed for the TV tuner to receive the signal. The remote sensor light ❶ on the remote control then blinks briefly to indicate that a signal has been sent successfully.



## Replacing the remote control batteries

To replace the remote control batteries:

1. Turn the remote control over with the back facing up.
2. Remove the battery cover ❶.
3. Remove the old batteries and insert new batteries ❷.
4. Replace the battery cover ❸.

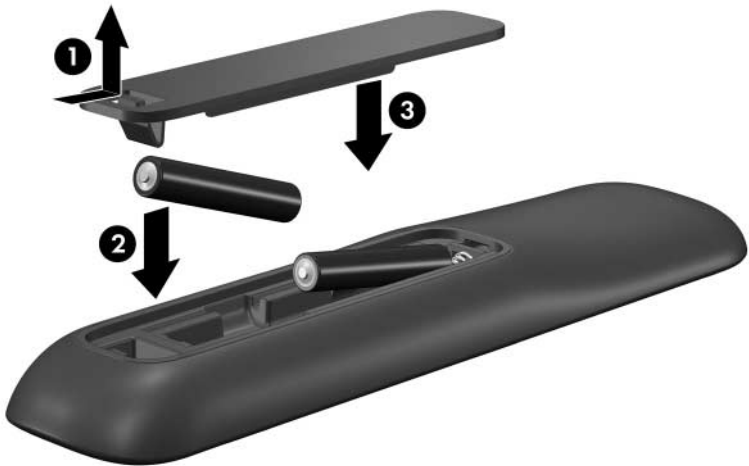

# A

---

## Troubleshooting

For help in troubleshooting problems with your hardware, refer to the following pages.

Problem	Solution
My remote control does not work.	<ul style="list-style-type: none"><li>■ Be sure you are using the HP MediaBuddy Remote Control and not an unsupported remote control.</li><li>■ Be sure that the remote control has a clear line-of-sight with the remote sensor. Refer to <a href="#">“Using the remote control”</a> in Chapter 5.</li><li>■ If the remote control has worked without any problems until recently, try replacing the batteries. Refer to <a href="#">“Replacing the remote control batteries”</a> in Chapter 5.</li><li>■ If the remote control works as expected, except for changing channels, you must reconfigure the software settings for the cable or satellite set-top box. Refer to <a href="#">“Running the Setup Wizard”</a> in Chapter 3.</li><li>■ Check all cable connections going to and from the TV tuner.</li><li>■ If using a set-top box, check the following:<ul style="list-style-type: none"><li>□ Be sure the remote sensor is connected to the computer. Refer to <a href="#">“Connection 3: Connecting with satellite TV or cable TV with a set-top box”</a> in Chapter 3.</li><li>□ Be sure the IR emitter cable is securely and properly connected from the remote sensor to the set-top box.</li><li>□ Be sure the set-top box is on and receiving power.</li></ul></li><li>■ Close Windows Media Center, restart the computer, and then open Windows Media Center again.</li></ul>

*(Continued)*

Problem	Solution
I am using a TV in my setup, but I cannot see anything on the TV screen.	Confirm that the TV is properly connected to the computer. Refer to <a href="#">“Adding a TV to your connection”</a> in Chapter 4.
My TV tuner is connected to a TV antenna but I do not get a broadcast signal.	Windows Media Center does not automatically detect TV antenna signals during the setup process. In order to properly get a TV antenna configuration setup, select the manual configuration option rather than the automatic configuration option during the TV signal setup. For QuickPlay run Setup again. Refer to <a href="#">“Running the Setup Wizard”</a> in Chapter 3.
Picture quality is poor when I watch live TV.	<ul style="list-style-type: none"> <li>■ Be sure all cables are properly connected.</li> <li>■ If you have basic cable, try a signal booster. A weak signal will cause picture quality to be degraded.</li> <li>■ Confirm that you subscribe to the channel you are watching.</li> </ul>
I cannot record a movie that is playing on a premium channel.	Some premium channels use copy protection technology to prohibit or degrade recorded movies.

*(Continued)*

Problem	Solution
I want to use an external hard drive, secondary hard drive, or optional expansion base hard drive to store my TV programs.	<p data-bbox="407 233 753 258">Perform the following procedure:</p> <ol data-bbox="426 269 948 483" style="list-style-type: none"><li data-bbox="426 269 948 321">1. Be sure your external hard drive is connected to your computer or optional expansion base.</li><li data-bbox="426 332 948 384">2. If using an optional expansion base, be sure it is connected to the computer.</li><li data-bbox="426 396 948 448">3. Press the <b>Start</b> button on the remote control to open Windows Media Center.</li><li data-bbox="426 459 657 483">4. Select <b>Hard Drive</b>.</li></ol> <p data-bbox="407 500 919 524">Then perform either of the following procedures:</p> <ol data-bbox="426 535 948 750" style="list-style-type: none"><li data-bbox="426 535 948 587">1. Press the <b>Start</b> button on the remote control to open Windows Media Center.</li><li data-bbox="426 599 948 651">2. Select <b>Tasks &gt; Settings &gt; TV &gt; Recorder &gt; Recorder Storage</b>.</li><li data-bbox="426 662 948 714">3. Under <b>Record on drive</b>, select the hard drive where you want to store your recordings.</li><li data-bbox="426 725 591 750">4. Select <b>Save</b>.</li></ol> <p data-bbox="407 771 469 795">– or –</p> <ol data-bbox="426 807 948 1023" style="list-style-type: none"><li data-bbox="426 807 948 859">1. Press the <b>QuickPlay</b> button on the remote control to open QuickPlay.</li><li data-bbox="426 870 820 894">2. Select the <b>TV</b> icon from the menu.</li><li data-bbox="426 906 908 930">3. Select the <b>i</b> icon from the menu on the left.</li><li data-bbox="426 941 948 1023">4. Under <b>Recording Destination</b>, select the hard drive where you want to store your recordings.</li></ol> <p data-bbox="407 1044 921 1096">All future TV recordings will now be saved to the external hard drive.</p>

---

*(Continued)*

Problem	Solution
<p>I hear no sound, or the volume is too low.</p>	<p>The Windows Media Player and Windows Vista may share certain audio device control settings. If volume performance does not meet your expectations, check the following settings:</p> <ul style="list-style-type: none"> <li>■ Open Windows Media Player and verify that the volume settings are not muted or turned down too low.</li> <li>■ Verify that the Windows system volume control settings are not muted or turned down too low:               <ul style="list-style-type: none"> <li>□ Double-click the volume control icon in the Windows notification area, at the right of the taskbar.</li> <li>– or –</li> <li>□ Select <b>Start &gt; Control Panel &gt; Sound</b>.</li> </ul> </li> </ul>

# B

---

## Glossary

**ATSC**—Digital television broadcast over the air and received via antenna. The acronym originates from the Advanced Television Systems Committee, a government-appointed body in charge of defining the standards for the new digital television system.

**composite audio/video**—An audio/video transmission type that provides improved video quality over RF coaxial. Can be used instead of RF coaxial in setups that use a cable or satellite set-top box. A composite audio/video cable is provided.

**Digital video recorder**—*See TV tuner.*

**ExpressCard**—A next-generation, high-performance PC Card that must be inserted in the ExpressCard slot. An ExpressCard can add TV tuner functionality to the computer.

**HDTV**—High-definition television, the highest of the digital television standards. HDTV displays pictures in either 720p or 1080i format.

**infrared (IR) lens**—A device on your set-top box that receives infrared signals from your remote.

**NTSC**—Analog TV. The acronym originates from the government-appointed body in charge of defining the technical standards (the National Television Standards Committee). NTSC is used in the USA, Canada, Mexico, Japan, South Korea, and Taiwan.

**QuickPlay**—Home entertainment software preinstalled on your computer. When it is used with the TV tuner, you can watch and record television on your computer.



**remote sensor**—Connects to the USB port on the computer so that you can change channels using the HP MediaBuddy Remote Control.

**RF coaxial**—An audio/video transmission type that provides standard video quality. RF coaxial cables are used to connect your TV source to the TV tuner.

**set-top box**—A device that enables your television to receive cable or satellite broadcasts. In your setup, the set-top box is connected to the TV tuner to enable your computer to receive cable or satellite broadcasts. Set-top boxes are provided by your cable or satellite service.

**S-Video**—A video transmission type that provides better video quality than RF coaxial and composite video types.

**TV tuner**—Allows you to watch and record TV programming on your computer.

**Windows Media Center**—A home entertainment feature of the Windows Vista operating system. When used with the TV tuner, you can watch and record television on your computer.

---

# Index

## A

- antenna, TV tuner 2–2
- ATSC 3–3, 4–3
  - defined B–1
- audio
  - connecting a stereo 4–10
  - connecting a television 4–7
  - connecting composite 4–4
  - connecting S-Video 4–5
  - troubleshooting A–5
- audio problems A–5
- audio receiver, connecting 4–10

## B

- battery, remote control 5–9
- buttons
  - QuickPlay 3–11, 5–7
  - remote control 5–2
  - START 3–11, 5–7

## C

- cables
  - additional, not included 2–1
  - coaxial 2–1
  - IR emitter 2–3
- composite audio/video cable 2–2

- composite video
  - connecting to set-top box 4–3
  - defined B–1
  - video quality 4–3
- computer, setting up 3–1
- connections 3–1, 3–2

## D

- Digital video recorder. *See* TV tuner
- Digital/Analog TV Tuner. *See* TV tuner

## E

- ExpressCard 2–2
- ExpressCard slot 3–4

## F

- features 1–1, 1–2

## H

- hard drive, external A–4
- HDTV, defined B–1
- help 1–3, A–1
- high definition 3–3, 4–3
- HP MediaBuddy Remote Control. *See* remote control

**I**

- infrared lens B-1
- Internet connection 1-2, 2-1
- IR emitter cable, identifying 2-3
- IR receiver, using remote control 3-11, 5-6, 5-8

**N**

- NTSC, defined B-1

**O**

- operating system 1-1

**P**

- planning 1-2, 3-1

**Q**

- QuickPlay 1-2, 1-3, 3-1, 3-2, 4-11
- QuickPlay, defined B-1

**R**

- remote control
  - buttons 5-2
  - features 5-1
  - identifying 2-3
  - overview 5-1
  - remote sensor light 5-8
  - replacing battery 5-9
  - troubleshooting A-2
  - using 5-6
- remote sensor 2-3
- remote sensor light, remote control 5-8
- RF coaxial
  - defined B-2
  - video quality 4-3

**S**

- set-top box
  - connecting composite video 4-3
  - connecting S-Video 4-3
  - defined B-2
- Setup Wizard 3-11, 4-11
- speaker settings 4-11
- standard definition 3-3, 4-3
- stereo, connecting 4-10
- S-Video
  - defined B-2
  - video quality 4-3
- S-Video cable 2-2
  - connecting television 4-6
  - connecting to set-top box 4-3

**T**

- television
  - connecting 4-6
  - troubleshooting A-3
- troubleshooting A-1
- TV antenna A-3
- TV signal 2-1
- TV source 2-1
- TV tuner
  - defined B-2
  - identified 2-2
  - installing 3-4

**V**

- video
  - connecting composite 4-4
  - connecting S-Video 4-5
  - troubleshooting A-3
- video quality 4-3, A-3

video types supported 4-3  
volume, problems with A-5

## **W**

Windows Media Center 1-2,  
1-3, 3-1, 4-11

Windows Media Center,  
defined B-1

Windows Media Player A-5

Windows Vista operating  
system 1-2

    Basic edition 3-2

    Business edition 3-2

    Premium edition 3-2

    Ultimate edition 3-2