

INSTRUCTION MANUAL
with Catalog of Replacement Parts

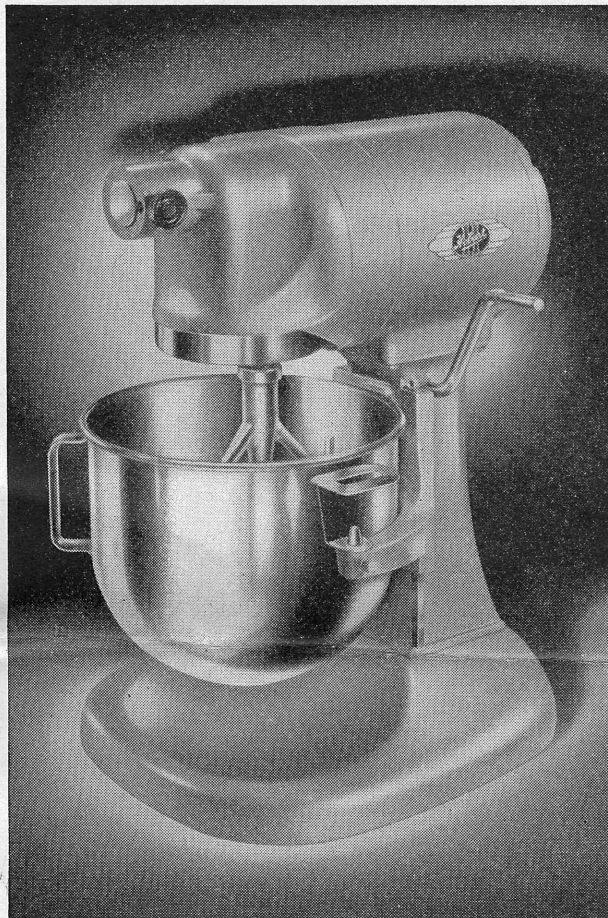

HOBART MODEL N-50
MIXER



THE HOBART MANUFACTURING CO.
TROY, OHIO, U. S. A.

HOBART REPLACEMENT PARTS

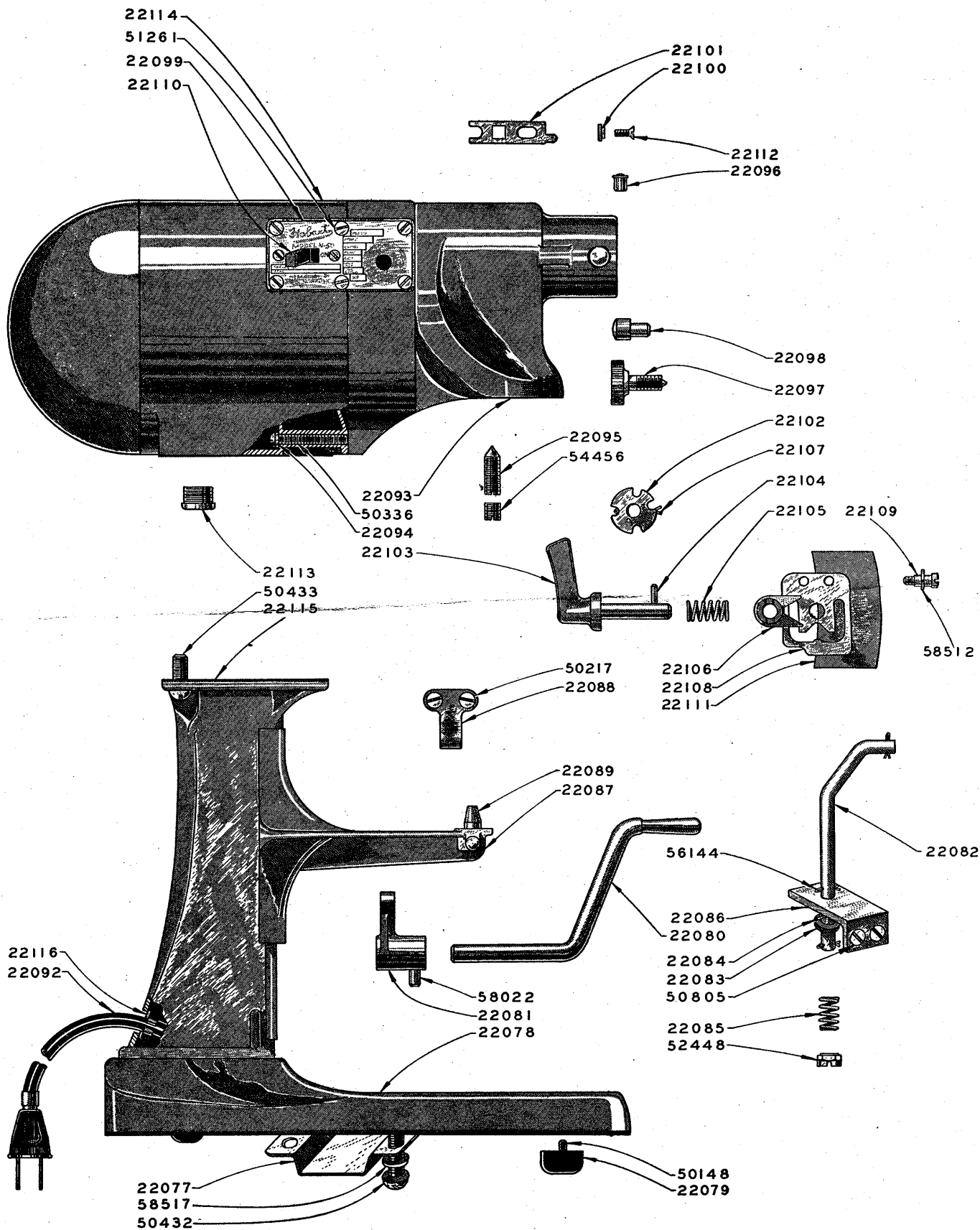

PL-825

HOBART REPLACEMENT PARTS

COLUMN AND BASE UNIT

Cat. No.	Part Name	Quantity	Factory No.	Code Word
22 077	Shield for Base -----	1	M-16742	Ebyix
22 078	Base -----	1	S-9067-1	Ebyjy
22 079	Foot for Base -----	4	V-13983-1	Ebykz
22 080	Bowl Lift Handle -----	1	M-9079-1	Ebyla
22 081	Bowl Lift Arm -----	1	M-9086	Ebymb
22 082	Bowl Lift Rod -----	1	M-9085	Ebync
22 083	Washer -----	1	M-17000-3-7	Ebyod
22 084	"V" Washer -----	1	V-9236	Ebype
22 085	Spring -----	1	V-9237	Ebyrg
22 086	Bowl Lift Bracket -----	1	M-9080-1	Ebysh
22 087	Bowl Support -----	1	S-9066-1	Ebyti
22 088	Spring Latch for Bowl -----	1	V-9083-1	Ebyuj
22 089	Bowl Retaining Pin -----	2	V-4821	Ebyvk
22 092	Cord and Plug -----	1	M-17556-2	Ebyyn
22 093	Transmission Case with Pin (22 098) -----	1	S-9063-1	Ebyzo
22 094	Fibre Washer 13/32" OD x 7/32" ID x 1/32" -----	7	M-17000-2-30	Ebzac
22 095	Adjusting Screw for Tumbler Stop -----	1	V-9094	Ezbdb
22 096	Gits Oiler Style "GB" #522 -----	1		Ebzce
22 097	Thumb Screw -----	1	M-16740	Ebzeg
22 098	Attachment Hub Support Pin -----	1	V-5479	Ebzgi
22 099	Name Plate & Control Box Cover -----	1	M-21594	Ebzjh
22 100	Guide Disc -----	2	V-9056	Ebzik
22 101	Interlock Plunger -----	1	V-9057	Ebzkm
22 102	Interlock Disc -----	1	V-9059	Ebzmo
22 103	Shifter Handle & Shaft -----	1	P-10684-1	Ebzop
22 104	Shifter Pin -----	1	P-11800-19	Ebzpr
22 105	Spring for Shifter Handle -----	1	V-7433	Ebzsu
22 106	Shifter Fork for Shifter Handle -----	1	V-10335	Ebztv
22 107	Cotter Pin 7/64" Dia. x 1" Lg. -----	1		Ebzuz
22 108	Cam Plate -----	1	M-9062	Ebzwy
22 109	Cam Plate Retaining Screw -----	2	V-9091	Ebzya
22 110	Toggle Switch, Single Pole, #7228 M. Handle -----	1		Ecaac
22 111	Insulating Strip -----	1	V-11019	Ecabd
22 112	#4-40 x 5/16" French Hd. Mach. Screw -----	2	Plated	Ecace
22 113	3/8" Hard Rubber Socket Bushing -----	1	V-19077	Ecadf
22 114	Magnet Ring * -----	1	S-10717	Ecaeg
22 115	Column -----	1	S-21862-1	Ecafh
22 116	Strain Relief "Gripmaster" #209-1 -----	1		Ecagi
50 148	Round Hd. Mach. Screw, #8-32 x 1/2" -----	4	Steel	Iygyg
50 217	Round Hd. Mach. Screw, #10-24 x 1/2" -----	2	Plated	Iylya
50 336	Round Hd. Mach. Screw, #12-24 x 2-3/4" -----	7	Steel	Iytdj
50 432	Round Hd. Mach. Screw, 5/16"-18 x 3/4" -----	4	Steel	Izabk
50 433	Round Hd. Mach. Screw, 5/16"-18 x 3/4" -----	4	Plated	Izacl
50 805	Flat Hd. Mach. Screw, #10-24 x 1/2" -----	2	Plated	Izxnu
51 261	French Hd. Mach. Screw, #6-32 x 3/8" -----	6	Plated	Jaykf
52 448	Standard Hexagon Castle Nut, 1/4"-28 -----	1	Steel	Josqt
54 456	Hdless Set Screw, 5/16"-18 x 3/8" -----	1	Steel	Kiapr
56 144	3/32" Dia. Cotter Pin 1/2" Lg. -----	3	Steel	Ktoyw
58 022	#2 Taper Pin 3/4" Lg. -----	1	Steel	Leocq
58 512	#12 Lockwasher .062" x .047" -----	2	Steel	Lihbu
58 517	5/16" Lockwasher .117" x .056" -----	4	Steel	Lihgz

* Motor parts are listed on separate sheets. If none is inserted in this book, ask for one when needed, giving us the serial number of your machine and the electrical specifications.

HOBART REPLACEMENT PARTS

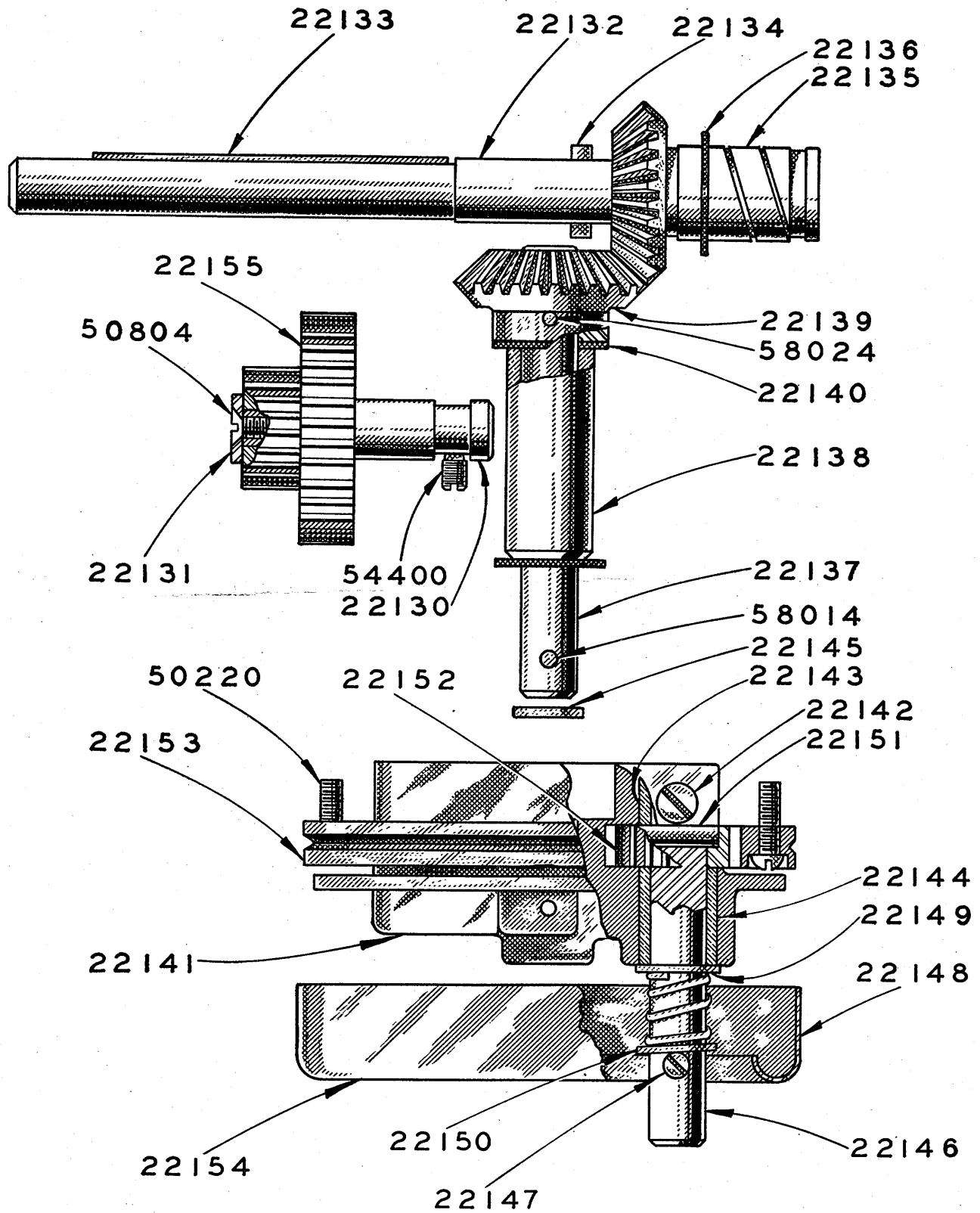

PL-786

HOBART REPLACEMENT PARTS

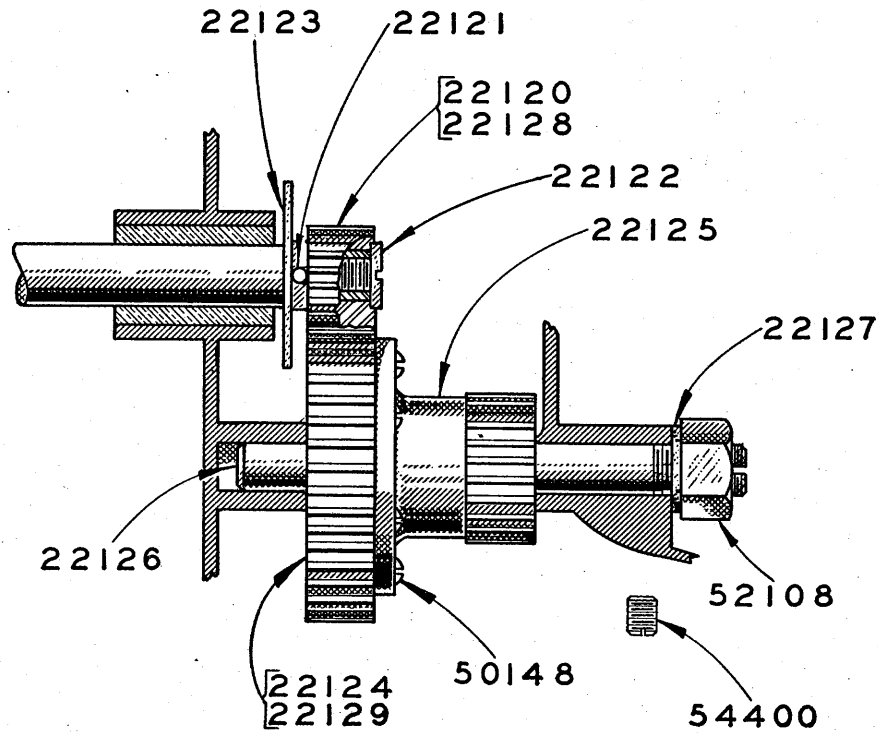

Gearing Unit

Cat. No.	PART NAME	Quantity	Factory No.	Code Word
22120	Motor Pinion 15T - 22P	1	M-9421	Ecakm
22121	Pin	1	V-16777	Ecaln
22122	Pinion Retaining Screw	1	V-5247-2	Ecamo
22123	Baffle Plate for Motor Pinion	1	M-16747	Ecanp
22124	Main Drive Gear 49T - 22P	1	M-9392	Ecaog
22125	Assy. of Flange Ring & Hub for Reduction Gear 15T - 16P	1	M-17864	Ecaqr
22126	Eccentric Shaft	1	M-9088	Ecaqs
22127	Washer	1	V-6021	Ecart
22128	Motor Pinion 17T - 22P, 25 & 50 cycle only	1	M-16759	Ecasu
22129	Main Drive Gear 47T - 22P, 25 & 50 cycle only	1	M-16758	Ecatv
22130	Lower Transmission Shaft	1	V-9043	Ecauw
22131	Retaining Washer	1	V-9042	Ecavx
22132	Upper Transmission Shaft	1	M-9075	Ecawy
22133	Key for Upper Transmission Shaft	1	R-12430-23	Ecaxz
22134	Pin for Upper Transmission Shaft	1	P-11800-187	Ecaya
22135	Zerol Bevel Gear	1	M-20662	Ecazb
22136	Fibre Thrust Washer, 1 1/2" OD x 13/16" ID x 1/32"	As Req'd.	M-17000-12-14	Ecbap
22137	Planetary Shaft	1	M-9040	Ecbcr
22138	Planetary Shaft Bearing	1	V-9039	Ecbds
22139	Zerol Bevel Gear	1	M-20661	Ecbef
22140	Fibre Thrust Washer, 1" OD 1/2" ID x 1/64"	As Req'd.	M-17000-7-25	Ecbfu
22141	Planetary	1	P-9028-1	Ecbix
22142	Bearing Retaining Screw	1	V-7602	Ecbjy
22143	Upper Planetary Bearing for Beater Shaft	1	V-7595	Ecbia
22144	Lower Planetary Bearing for Beater Shaft	1	V-9038	Ecbod
22145	Cupped Oil Stop Washer	1	V-4378	Ecbpe
22146	Beater Shaft	1	M-9037	Ecbsh
22147	Stud for Beater Shaft	1	V-3837	Ecbtl
22148	Spring for Beater Shaft	1	V-5894	Ecbuj
22149	Washer for Beater Shaft, 1/32" x 3/4" OD x 33/64" ID	1	M-17000-8-2	Ecbyn
22150	Washer	1	M-17000-7-21	Ecbzo
22151	Beater Shaft Pin	1	V-5988	Eccad
22152	Beater Shaft Pinion 18T - 18P	1	V-5987	Eccbe
22153	Internal Gear 59T - 18P	1	M-5428	Eccch
22154	Drip Cup	1	P-21625	Eccfi
22155	Assy. of Transmission Gears	1	M-9047	Eccil
50148	Round Hd. Mach. Screw, #8-32 x 1/2"	1	Steel	Iygm
50220	Round Hd. Mach. Screw, #10-24 x 3/8"	6	Steel	Iymcs
50804	Flat Hd. Mach. Screw, #10-24 x 1/2"	4	Steel	Izkr
52108	Hexagon Nut, 3/8" - 16	1	Steel	Jiwyk
54400	Headless C. P. Set Screw, 1/4"-20 x 1/4"	1	Steel	Khuiv
58014	#1 Taper Pin 1" Lg.	2	Steel	Lemoc
58024	#2 Taper Pin 1" Lg.	1	Steel	Leoes

HOBART REPLACEMENT PARTS

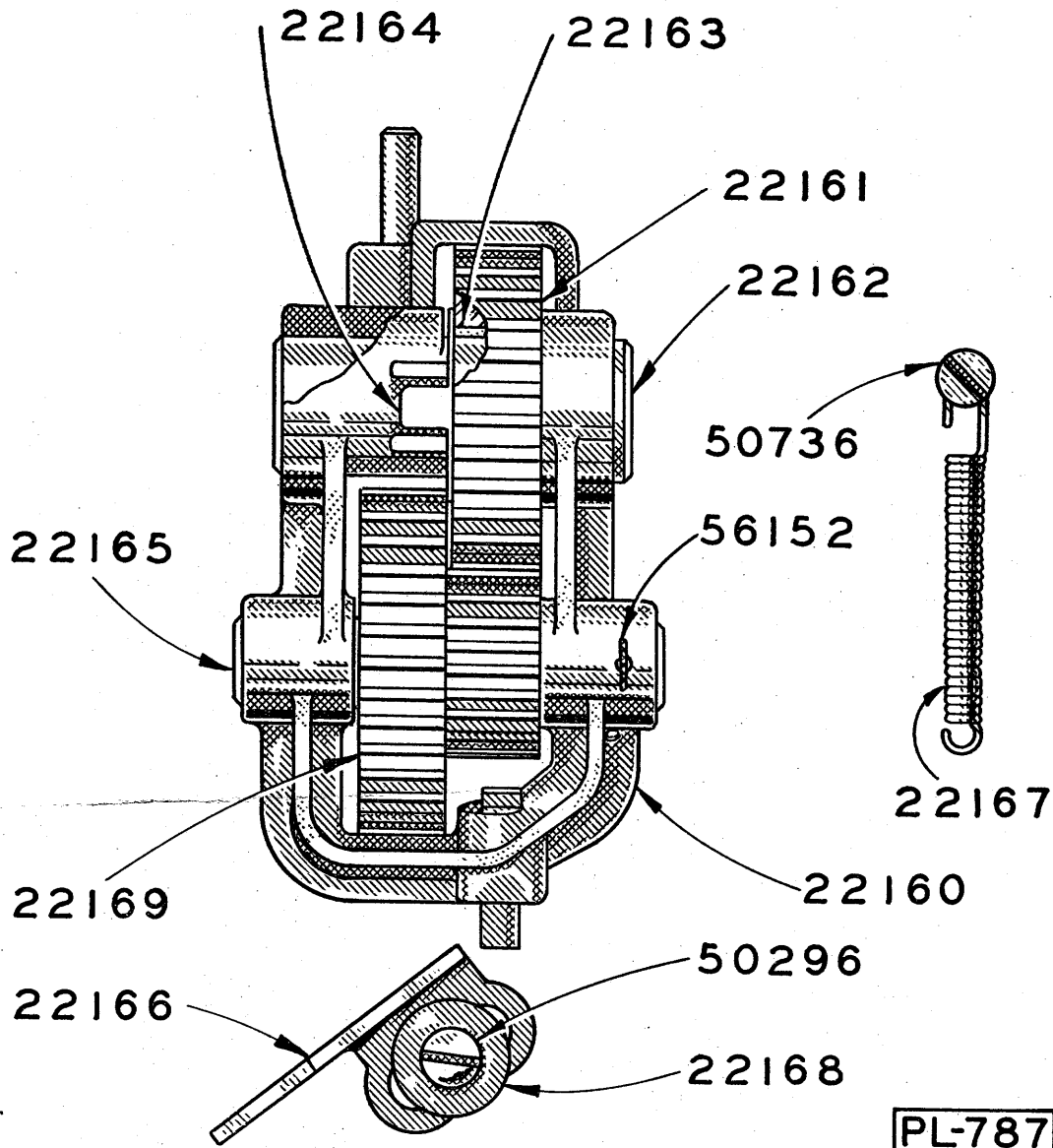

Tumbler Unit

Cat. No.	PART NAME	Quantity	Factory No.	Code Word
22 160	Tumbler Yoke	1	R-9027	Eccru
22 161	Transmission Gear 31T - 16P	1	M-9048	Eccsv
22 162	Shifter Sleeve	1	M-9050	Ectw
22 163	Key, used with No. 22161	1	R-12430-22	Eccux
22 164	Shifter Sleeve Retainer	1	V-9051	Eccvy
22 165	Tumbler Shaft	1	V-9052	Eccxa
22 166	Stop for Tumbler Yoke	1	M-9090	Eccyb
22 167	Spring for Tumbler Yoke	1	M-10973	Ecdag
22 168	Washer	1	M-17000-3-7	Ecdbr
22 169	Transmission Gear Assy. on Tumbler Shaft	1	M-9047	Ecdcs
50 296	Round Hd. Mach. Screw, #12-24 x 3/4"	1	Steel	Iyqsk
50 736	Flat Hd. Mach. Screw, #8-32 x 3/8"	1	Steel	Iztch
56 152	3/32" Dia. Cotter Pin 1" Lg.	1	Steel	Ktugh

HOBART REPLACEMENT PARTS

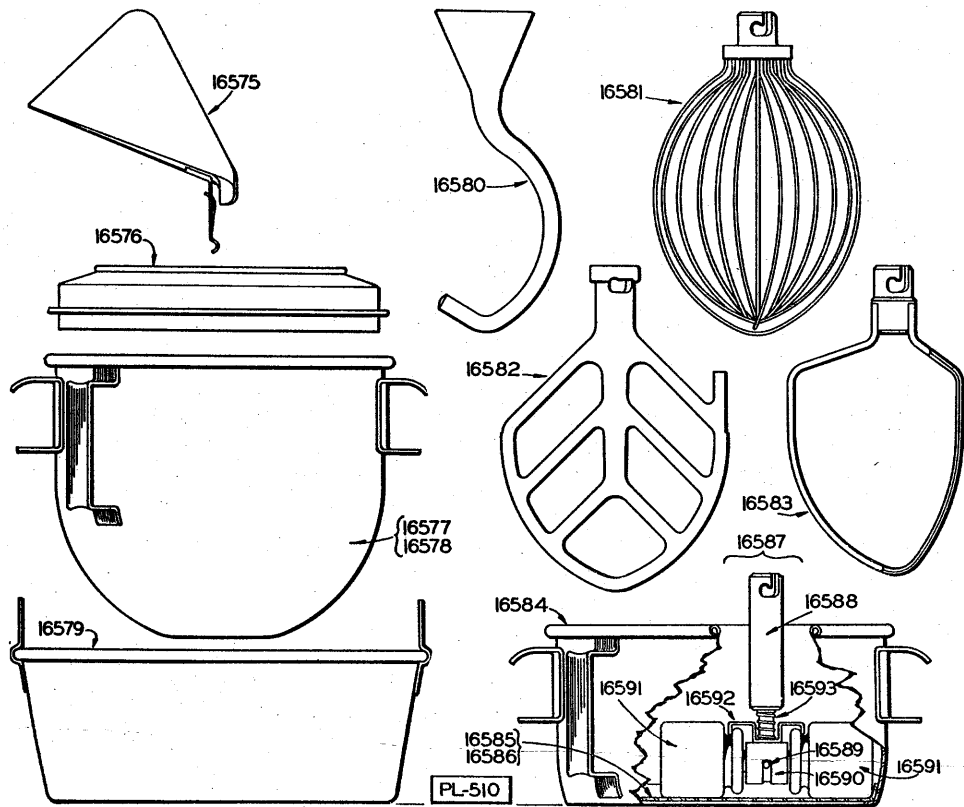

BOWLS AND BEATERS UNIT

Cat. No.	PART NAME	Quantity	Factory No.	Code Word
16 575	Bowl Chute	1	R-16769	Cureh
16 576	Splash Ring	1	P-9506	Curfi
16 577	5-Quart Bowl (Tinned)	1	R-16800-1	Curil
16 578	5-Quart Bowl (Stainless Steel)	1	R-16800-2	Curkn
16 579	Ice and Hot Water Jacket	1	R-16746	Curlo
16 580	Dough Hook (N-5-EA)	1	P-9202	Curor
16 581	Wire Whip (N-5-D)	1	P-9034	Curps
16 582	Flat Beater (N-5-B)	1	P-9033	Curru
16 583	Pastry Knife (N-5-PK)	1	P-9205	Cursv
16 584	Colander Jacket	1	R-9240	Curtw
16 585	Colander Disc, small holes	1	P-9447	Curux
16 586	Colander Disc, larger holes	1	P-9444	Curvy
16 587	Colander Roller Completely Assembled	1	M-9621	Curxa
16 588	Roller Holder Shank	1	M-9238	Curyb
16 589	Pin, roller holder to shank	1	P-11800-29	Cusar
16 590	Roller Holder	1	M-9239	Cusbs
16 591	Colander Rollers	2	V-8808	Cuset
16 592	Clip for Colander Rollers	1	M-10250	Cusdu
16 593	Spring for Clip	1	V-5490	Cusev

Instructions For Model N-50 HOBART LABORATORY MIXER

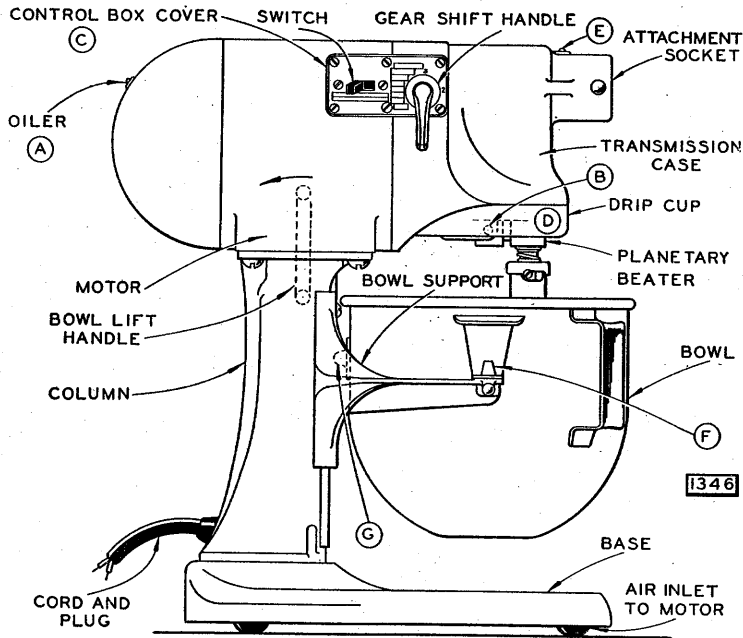

Fig. 1

CONNECTIONS Before plugging into a socket the first time, make sure that the electrical specifications of the line are the same as called for on the name plate C.

LUBRICATION Very little lubrication is required. Once a month put three drops of oil in the oiler A at the back of the motor, and a like amount in oiler E on the attachment hub.

The transmission gearing is lubricated by a special grease that will last for several years of normal use. Consult a Hobart Service man before adding grease.

After using the machine for a year or two, have the service man lower the planetary and grease the teeth of the internal gear. The planetary is held to its shaft by a taper pin B.

SPEED CHANGING There are three speeds. To change from one speed to another, switch off the motor and move the Gear-shift Handle to the required number. As shown in the illustration, the handle is set for No. 1 or slow speed. The Gear-shift Handle is interlocked with the switch so that it can be moved only when the switch handle is at "OFF".

BOWL To put on the bowl, first locate the back lug G in its proper place, then snap down the side ears over the locating pins F.

BEATERS Beaters are available in various designs to suit the class of work to be performed. See fig. 2.

FLAT BEATER - B - For mixing heavier batters, mashing potatoes, and general purposes.

WIRE LOOP WHIP - D - For beating eggs, whipping cream, and all light, fast work.

DOUGH HOOK - E - For kneading coffee cake, roll dough, and the heavier work. Use on No. 1 speed.

PASTRY KNIFE - PK - For biscuits, pie crust, short cake, and pastry of various kinds.

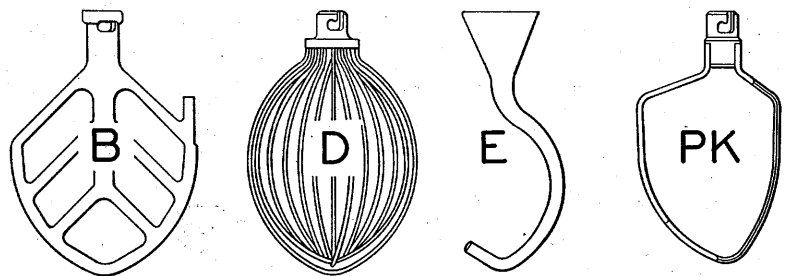

Fig. 2

BOWL LIFT Move the bowl-lift handle back as shown by the arrow in fig. 1 to lower the bowl for changing beaters. Lowering also makes the bowl more accessible for filling.

To mash potatoes, or to cream butter, start with the bowl down and raise it slowly into working position as the materials break up.

ATTACHMENTS Among the attachments available for this machine are:

Meat Chopper
Vegetable Slicer
Shredder
Ice Chipper

Splash Cover
Salad Oil Dropper
Colander Outfit
Pouring Chute

Ice Jacket

THE HOBART MANUFACTURING CO.
TROY, OHIO, U.S.A.