

DIRECTIONAL AND PLAYBACK CONTROL BUTTONS

Operation Modes: Live Mode, Live Freeze Mode, Search Mode, Search-Pause Mode, Navigation Mode, and PTZ Mode.



- Live** Go to PTZ mode.
- PTZ** Adjust zoom, focus, and iris on a PTZ channel.
- Search** Start reverse playback of recordings. Press successively to change the fast reverse speed.



- Live** Start playback of the latest recordings. (By default, the system searches recordings in the past 30 secs. If no recording is archived, the system will play back the latest one.)
- PTZ** Adjust zoom, focus, and iris on a PTZ channel.
- Search** Start playback of recordings. Press successively to change the fast forward speed.



- Navigation** Move up.
- PTZ** Move the camera view point up.



- Navigation** Move to the right.
- PTZ** Move the camera view point to the right.
- Search** Play recorded videos. When pressed successively, the search jumps forward in time by 30 minute increments.

Search-Pause Step forward one frame.



- Navigation** Move down.
- PTZ** Move the camera view point down.



- Navigation** Move to the left.
- PTZ** Move camera's view point to the left.
- Search** Play recorded videos in reverse. When pressed successively, the search jumps back in time by 30 minute increments.

Search-Pause Step backwards.



Live Press once to enter channel selection mode, press again to open the camera popup menu.

Search Pause playback channels.

Search Pause Resume playback.

FUNCTION BUTTONS



SEARCH Open the search menu.

FOCUS In PTZ mode, press to use the Focus function.
Use the < > buttons to adjust.



BACKUP In live mode, press to open the backup menu.
In the search mode,

- Press once, to set the start time for Backup.
- Press twice, to set the end time and complete Backup.

ZOOM In PTZ mode, press to use PTZ Zoom function.
Use the < > buttons to adjust.



ROTATE Rotate through to the remaining channels in the current display mode or rotate the display configuration.

PRESET In PTZ mode, press to use the Preset function.



KEY Log out the current user. Use to prevent accidental or unauthorized system-wide changes.

IRIS In PTZ mode, press to use the IRIS function.
Use the < > buttons to adjust.



LIVE Change the display mode. Display switches in the following order when the LIVE key is pressed successively: (Single > 4 > 9 > 16 > PiP > Single > 4 > 9 ...split screen mode)



SETUP Open the setup menu.

POWER Press and hold to shutdown or startup the DVR.

[4, 8, 16] HRDP H.264 Digital Video Recorder

QUICK START GUIDE

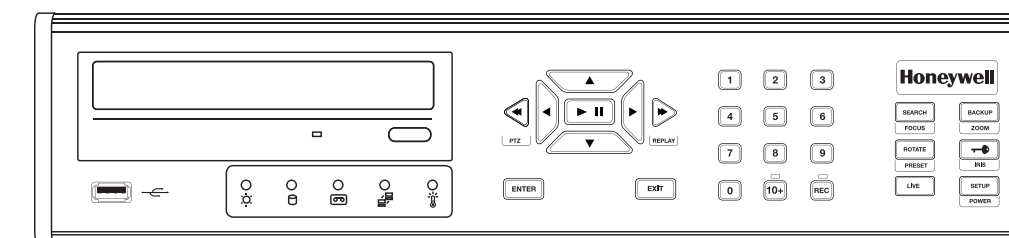

LOGGING IN FOR THE FIRST TIME

DVR User ID: admin
Password: <none>

Remote Software User ID: admin
Password: <none>

LED STATUS INDICATOR

- Power** Illuminates when power is supplied to the DVR.
- HDD** Flashes when the hard drive is being accessed.
- Record** Flashes when live video is recording.
- Network** Illuminates when the DVR is connected to a network.
- HDD Temp.** Illuminates when HDD temperature increases beyond the acceptable range.

ENTER / EXIT BUTTONS

Enter Input data, make selections, and open pop-up menus.

Exit Return to the previous mode or menu, without saving.

NUMERIC BUTTONS AND REC

Numeric In live and search modes, press to watch that channel full screen.

Record In live mode, press to start instant recording of all channels.

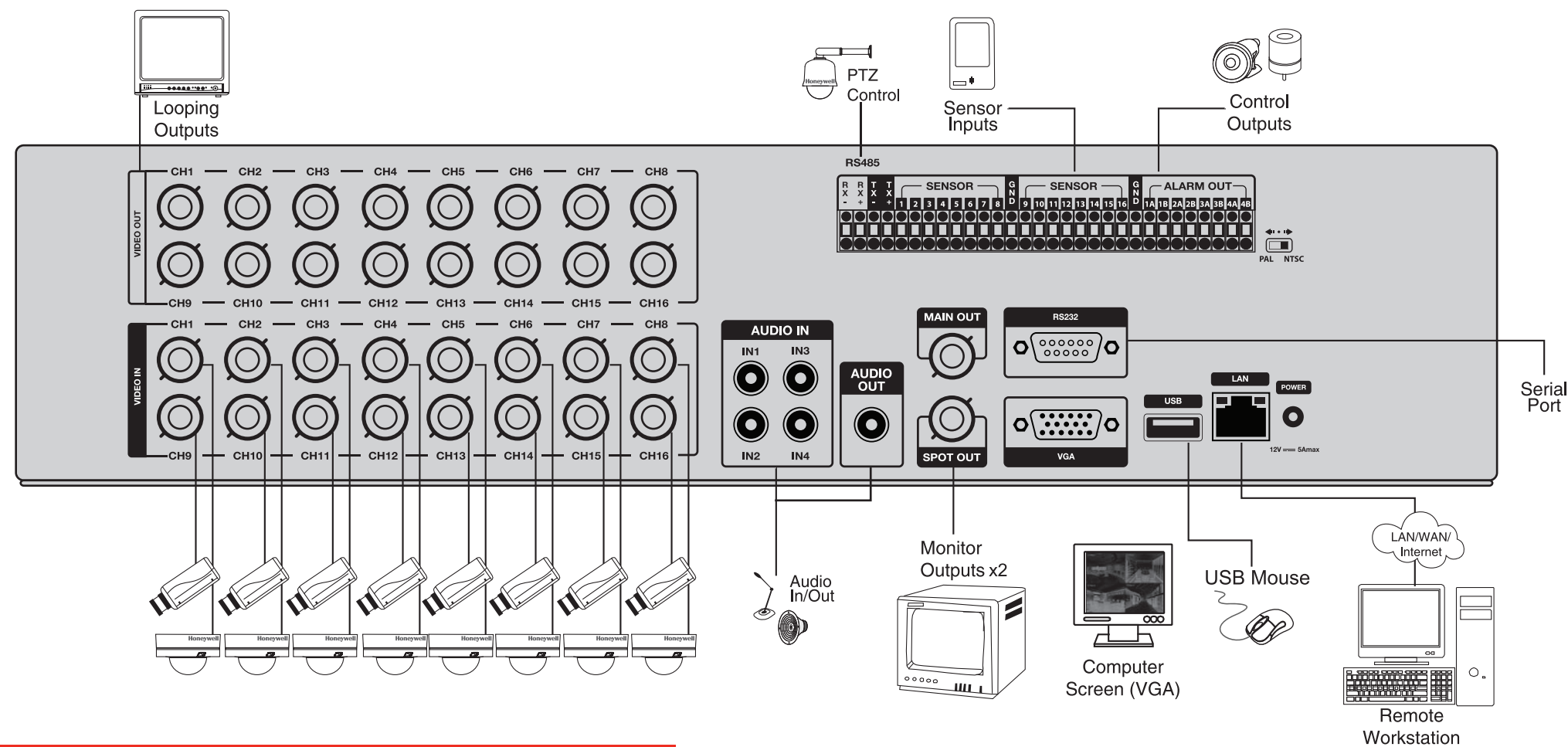

QUICK INSTALLATION

1. Connect cameras to video inputs, and if using, connect PTZ camera control lines to RS485 connector.
2. Connect the main monitor to the VGA monitor output or MAIN OUT.
3. If using, connect analog monitors to looping video outputs.
4. If using, connect a monitor to SPOT video output.
5. If using, connect sensors to alarm signal inputs.
6. If using, connect alarm devices such as buzzers to alarm signal outputs.
7. If using, connect external controllers to RS232 connector.

8. If using, connect a speaker and microphone to the audio input and output.
9. Connect a network cable to the network port.
10. Power on all the connected equipment.
11. Connect the power cord to the DVR.

© 2011 Honeywell International Inc. All rights reserved. No part of this publication may be reproduced by any means without written permission from Honeywell Video Systems. The information in this publication is believed to be accurate in all respects. However, Honeywell Video Systems cannot assume responsibility for any consequences resulting from the use thereof. The information contained herein is subject to change without notice. Revisions or new editions to this publication may be issued to incorporate such changes.

STARTING FOR THE FIRST TIME

When the HRDP DVR starts for the first time, it will take about 90 seconds to boot up. Once boot is complete, the Install Setup window will appear. Use this setup window to configure the basic settings of the system and also format the HDDs. If any settings are changed, you are encouraged to reboot the system.

VIDEO FORMAT: NTSC/PAL

DATE FORMAT: ASIA (YYYY/MM/DD), US (MM/DD/YYYY) and EURO (DD/MM/YYYY).

DATE: Specify the current date.

TIME: Specify the current time.

TIME ZONE: Set the local time zone.

USE DST: Select to use DST(Daylight Saving Time), turn on this toggle option.

HOW TO USE IR REMOTE CONTROLLER

When more than one HRDP DVR is installed in the same location, use one remote controller to control multiple DVRs. To control multiple DVRs, you must change the remote controller ID to match the DVR ID of the DVR.

Follow the instructions below to change the remote controller ID.

On the DVR

1. Go to SYSTEM > SYSTEM CONFIGURATION.
2. Enter the desired DVR ID number.

On the Remote Controller

3. Press and hold the ID button on the remote controller and enter the desired DVR ID number to operate the corresponding DVR.

Note The DVR ID must be input as two numbers on the remote controller. Therefore you should input 00 for the DVR ID 0 and input 01 for 1.

Honeywell

www.honeywellvideo.com
 #1.800.796.CCTV (North America only)
 HVSsupport@honeywell.com

Document 800-06867 — Rev D — 02/11
 29930AD

© 2011 Honeywell International Inc. All rights reserved.