



---

# *Getz*

---

## QUICK REFERENCE GUIDE



[www.hyundai.co.in](http://www.hyundai.co.in)

Customer Relation: 1-800-11-4645  
098-7356-4645  
[cr@hml.net](mailto:cr@hml.net)





## PREFACE

Welcome to the Hyundai family! Thank you for choosing a Hyundai Getz and we assure you years of driving pleasure.

Start enjoying your new Hyundai Getz the minute you start reading this manual. In this manual, you will learn how to operate your car – right from the driving controls to all other instruments and convenience items.

Maintaining your car according to the directions given in this manual will help keep your car trouble-free while it preserves your investment.

When in need of maintenance or any other kind of assistance, please feel free to contact your Hyundai dealer. We will be pleased to answer all your questions and concerns.

**Wishing you all the best!**



## INSTRUMENT PANEL & OTHER CONTROLS

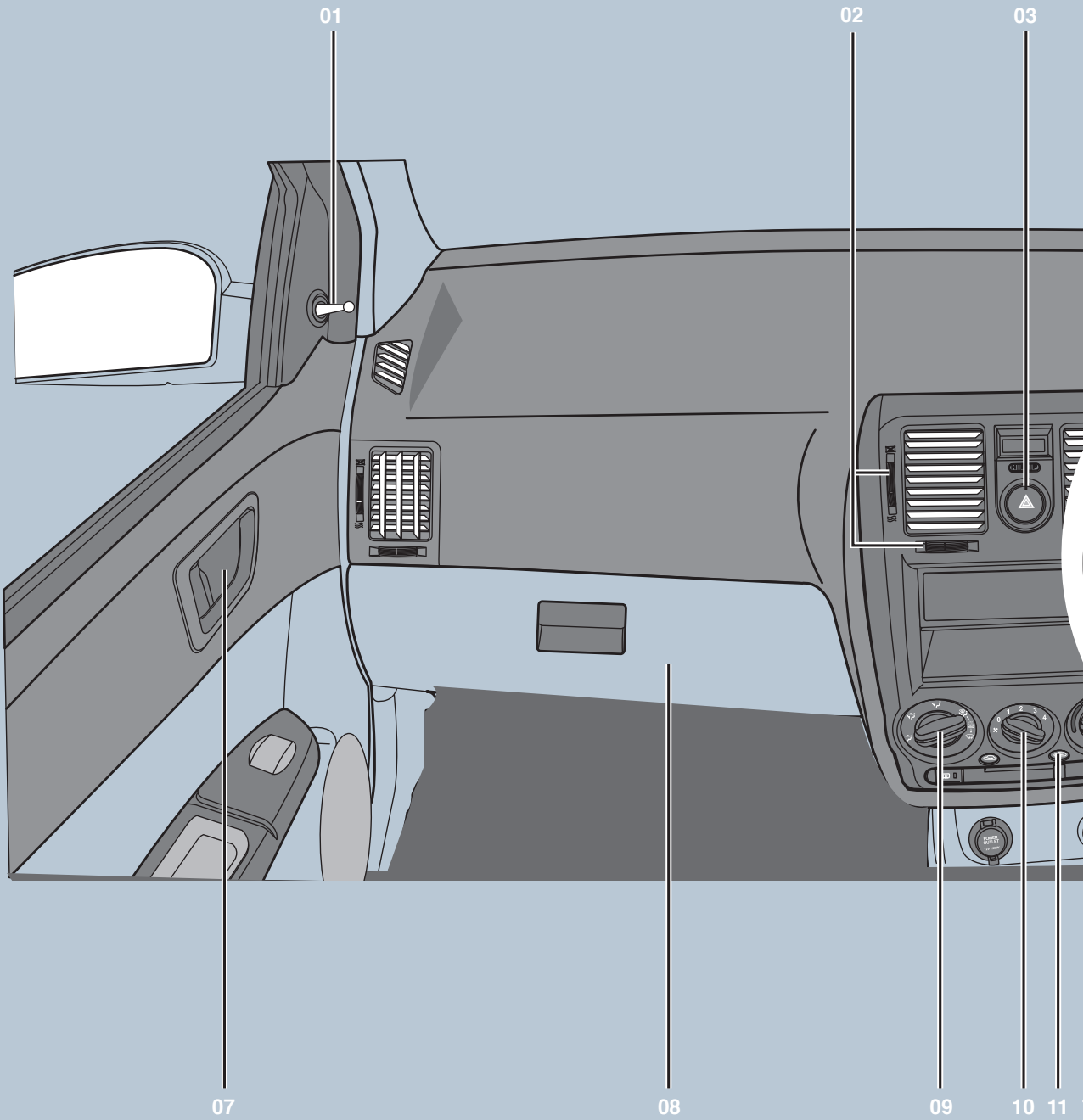

- 01 Outside Rear View Mirror Control
- 02 Air Vent Control
- 03 Hazard Warning Flasher
- 04 Tachometer

- 05 Fuel Gauge
- 06 Speedometer
- 07 Inside Door Handle
- 08 Glove Box

- 09 Ignition Switch
- 10 Radio
- 11 Cigarette Lighter



S

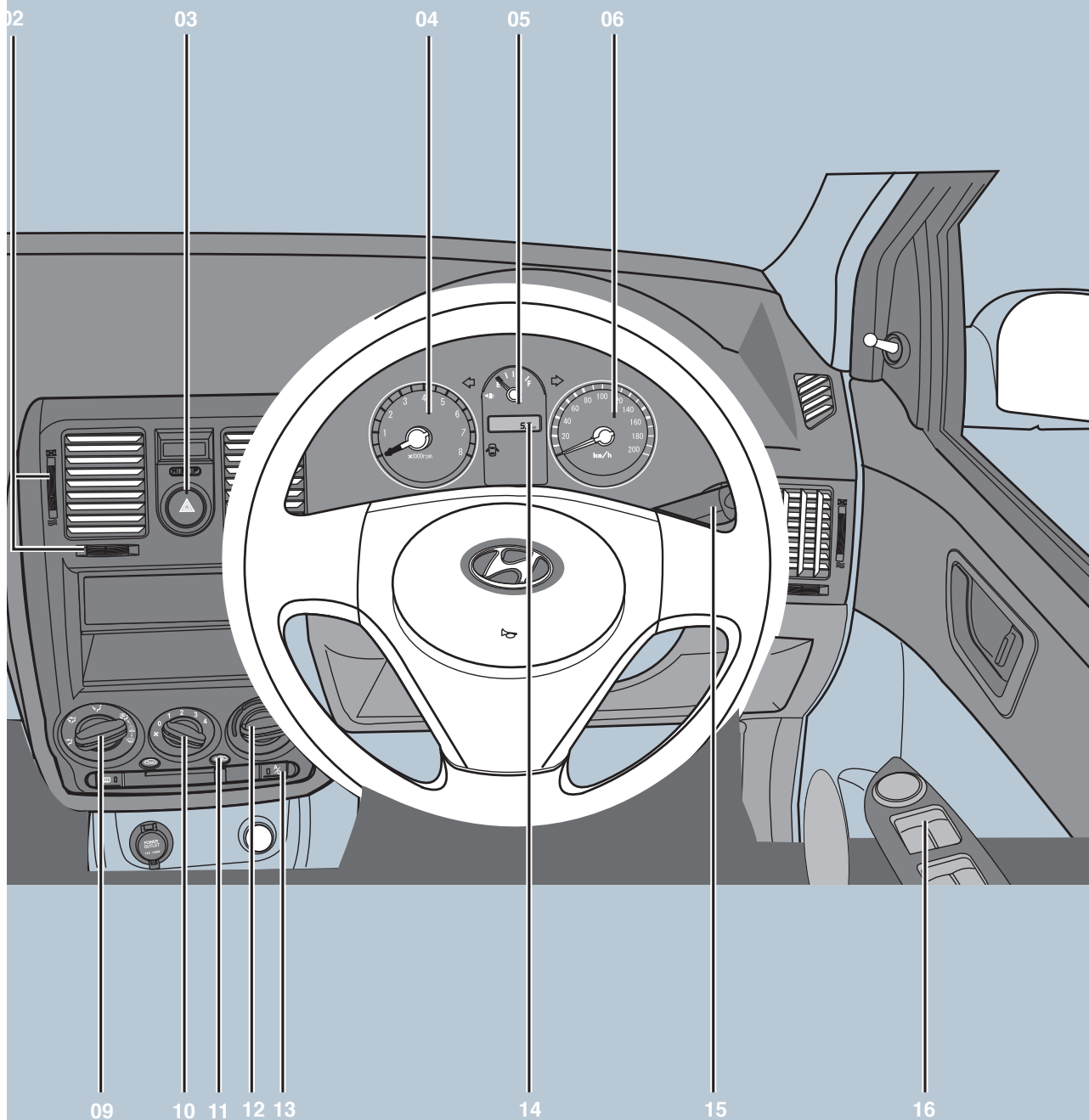

- 09 Airflow Control
- 10 Fan Speed Control
- 11 Air Intake Control
- 12 Temperature Control

- 13 A/C "ON/OFF" Switch
- 14 Trip/Odometer
- 15 Headlight/Directional Signal Light Switch
- 16 Power Windows Switch



## HOW TO REMOVE WINDSHIELD/WINDOW FOGGING

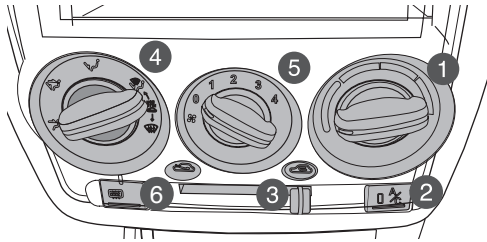



1. **Temperature Control**  
This is used to turn the heating system on and off and to select the degree of heating desired.
2. **AC "ON/OFF" Switch**  
The air conditioning is turned on by pushing the AC button.

3. **Air Intake Control**  
This allows you to select fresh outside air or to recirculate inside air.
4. **Air Flow Control**  
This is used to direct the flow of air. Air can be directed to the floor, dashboard outlets or windshield.
5. **Fan Speed Control**  
This is used to turn the blower fan on and off and to select the fan speed.
6. **Rear Window Defroster Switch\***



\* if equipped

## DEFOGGING WINDSHIELD

### a) To remove internal fog on windshield

- Set air intake to fresh air mode 
- Set air flow to defrost 
- Turn "ON" the A/C.
- Set temperature control to desired position.
- Set fan speed as required.

### b) To remove external fog on windshield

- Set intake air to fresh air mode 
- Set air flow control to defrost 

- Set temperature control to warm.
- Set fan speed to higher position.

### c) Use Rear Defogger Switch to clear Rear Windshield fog (If installed)

- The rear windshield defroster is turned ON by pushing the switch.
- After switching ON, defogger turns OFF automatically within 20 minutes
- Use same switch to switch 'ON' and 'OFF'



### Note:

- Blower without AC should only be used with Fresh Air mode to avoid any fogging.
- Operate AC at first blower speed after initial cooling at high speed.
- Do not turn the air louvers towards window side to prevent formation of fog on windows.

## DOES YOUR A/C GET COLD ENOUGH?

- If the interior of the car is hot when you first get in, open the window for a few minutes to expel the hot air.
- When you are using the air conditioning system, keep all windows closed to keep hot air out.
- When moving slowly, as in heavy traffic, shift to a lower gear. This increases engine speed, which in turn increases the speed of the air conditioning compressor.
- On steep grades, turn the air conditioning off to avoid the possibility of the engine overheating.



- During winter months or in periods when the air conditioning is not used regularly, run the air conditioning once every month for a few minutes. This will help circulate the lubricants and keep your system in peak operating condition.
- To prevent dust or unpleasant fumes from entering the car through the ventilation system, temporarily set the air intake control at the recirculation mode . Be sure to return the control to the fresh air mode .

#### DAY/NIGHT REAR VIEW MIRROR (IF EQUIPPED)

- Your Hyundai Getz is equipped with a day/night Inside rear view mirror.
- The “night” position is selected by flipping the tab at the bottom of the mirror toward you. In the “night” position, the glare of headlights of cars behind you is reduced.

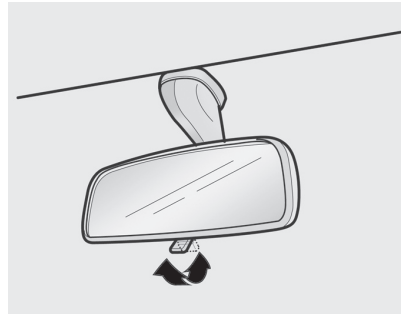

#### ADJUSTING THE OUTSIDE REAR VIEW MIRROR

##### MANUAL CONTROL (IF EQUIPPED)

The outside rear view mirrors are equipped with a control lever inside the cabin for your convenience.

To adjust an outside mirror, move the control lever located at the forward inside area of the window frame.

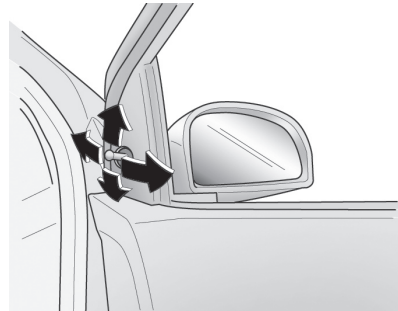

#### TILT STEERING (IF EQUIPPED)

##### TO ADJUST THE STEERING WHEEL:

1. Push the lever downward to unlock.
2. Raise or lower the steering wheel to the desired position.
3. After adjustment, securely tighten the lever by pulling it upward.

**NOTE:** Do not adjust while driving.

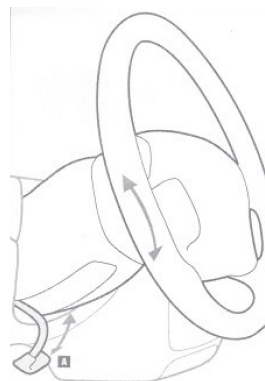



### FOR SMOOTH GEARSHIFTING

- Hyundai Getz has five forward and one reverse gear.
- The shift pattern is imprinted on the shift knob.
- Getz is equipped with conventional shift pattern.

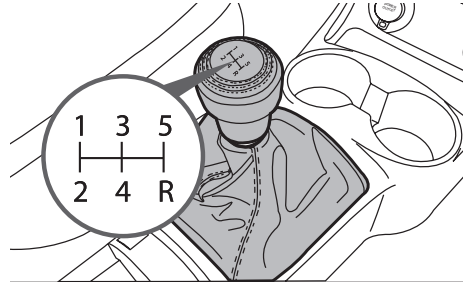

#### Note:

- The clutch should be pressed all the way to the floor before gear shifting then released slowly for smooth acceleration.
- To shift into reverse, rest the lever in neutral for at least 3 seconds after your car is completely stopped. Then move the lever into the reverse position.
- Getz is equipped with clutch lock. Vehicles equipped with clutch lock will only start when clutch is fully pressed.

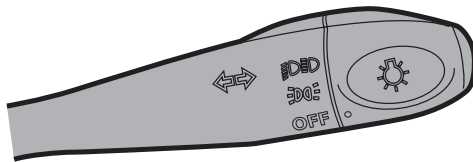

### HEADLIGHTS

To operate the headlights, turn the switch on the end of the lever:

**OFF** – Headlights are off

 – Parking lights

 – Headlights

**NOTE:** The ignition must be in the ON position to turn on the headlights.

**High Beam Activation:** Push the lever forward (away from you).

**Flash-To-Pass Feature:** Pull the lever toward you and release.

### USING HEADLAMP LEVELING DEVICE

Headlight beam should be adjusted according to the number of passengers and the loading weight in the luggage area. The higher the number of the switch position, the lower the headlight beam level.

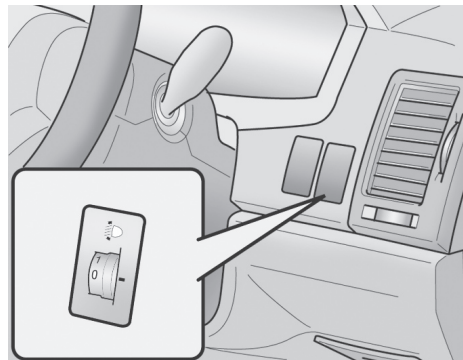





Listed below are the examples of proper switch settings.

Loading condition	Switch Position
Driver only	0
Driver + front passenger	0
Full passengers (including Driver)	1
Full passengers (including Driver) + full trunk Loading	2
Driver + Maximum permissible loading	3

#### HOW TO REMOVE HEADLIGHT CONDENSATION / MOISTURE

- After heavy rain or washing, mist/moisture can be formed inside headlight and taillamps due to temperature difference between lamp inside & outside.
- To remove the moisture formed inside the headlamp. Switch ON the headlamps for 30 minutes and the moisture will automatically disappear within 30 minutes.

#### FRONT FOG LIGHT SWITCH (IF EQUIPPED)

Fog lights are used to provide improved visibility in fog, rain or snow, etc. The fog lights will turn on when fog light switch is pressed after the ignition switch is in the ON position and the parking light is turned on. To turn off the fog lights, press the switch again.

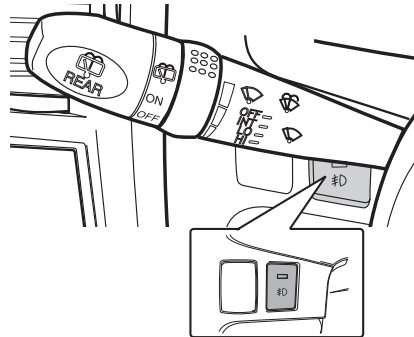

#### FOR CLEAR VISIBILITY DURING DRIVING

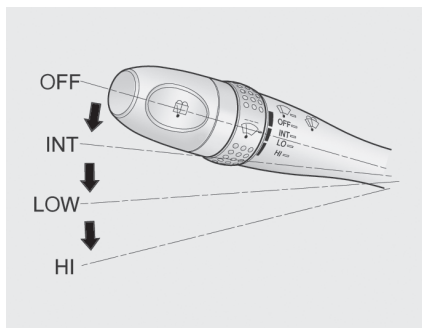

#### WIPER SPEED

The windshield wiper switch has three positions: intermittent, low speed and high speed. For mist (single wipe), move the lever up one position.



### ADJUSTABLE INTERMITTENT OPERATION (IF EQUIPPED)

To use the intermittent wiper feature, place the wiper switch in the "INT" position.

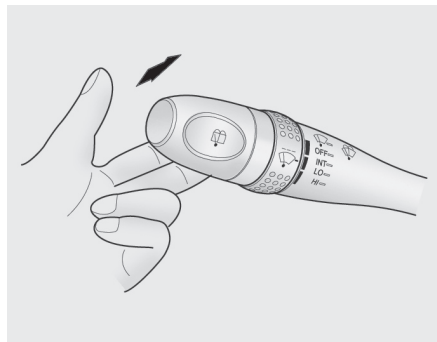
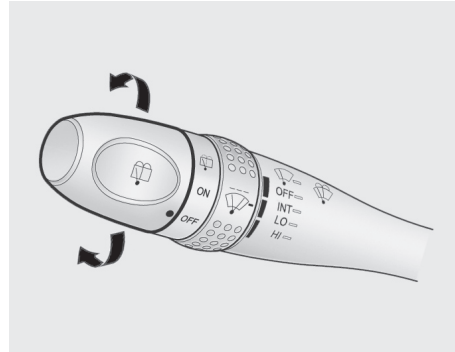

### WIPE / WASH OPERATION

To use the windshield washer, pull the wiper/washer lever toward you. When the washer lever is operated, the wipers automatically make three passes across the windshield. The washer continues to operate until the lever is released.

### REAR WIPER / WASHER (IF INSTALLED)

The rear wiper/washer has three positions:

1. OFF
2. ON: The rear window wiper starts to operate continuously.
3. The washer fluid will be sprayed onto the rear window and the wiper operates while the rear window wiper barrel is placed in this position.

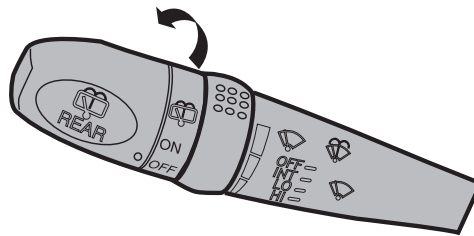

#### Note:

- Use water additive for better wiping
- Get the Wiper inspected for proper cleaning & replace before monsoons.
- Lift the wiper blade while long parking for proper usage and life of wiper head.



### DIGITAL CLOCK (IF EQUIPPED)

There is a digital clock control button built-in left side of the speedometer. Its functions are:

- **Reset:** Push the button for more than 1 second.
- **Min/Hour Adjustment:** Press "H" for 0.5 second to advance the hour indicated. Press "M" for 0.5 second to advance the minute indicated.

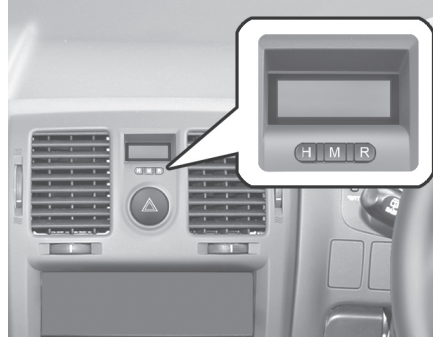

### INTERIOR LIGHT (IF EQUIPPED)

The interior courtesy light has a button of three positions. The three positions are:

- **DR**  
In the "DR" position, the interior courtesy light comes on when any door is opened regardless of the ignition key position. The light goes out when the door is closed.
- **ON**  
In the "ON" position, the light stays on at all times.
- **OFF**  
In the "OFF" position, the light stays off at all times even though a door is open.

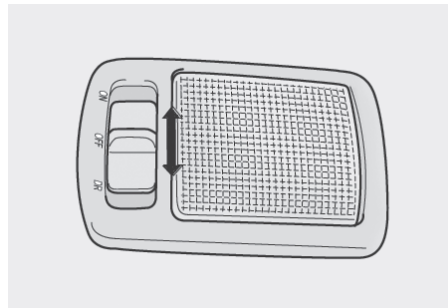

### POWER WINDOWS (IF EQUIPPED)

#### POWER WINDOWS

The ignition switch must be in the ON position for power windows to operate. Each door has power window switch that controls the door's window.

The windows may be opened by depressing the appropriate window switch and closed by pulling the switch up.

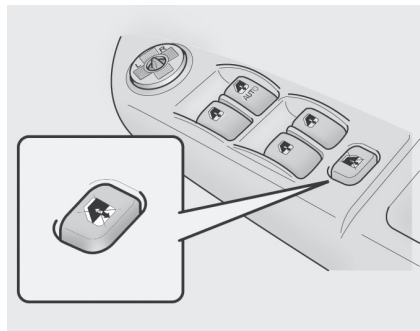

#### AUTO DOWN-DRIVER'S WINDOW (IF EQUIPPED)

To fully open the window automatically, press the switch fully down.

#### WINDOW LOCK SWITCH (IF EQUIPPED)

To disable all passenger power windows, press the window lock switch located on the driver's armrest.

To revert to normal operation, press the window lock switch a second time.



## TRIPMETER

The tripmeter indicates the distance of individual trips selected. Tripmeter can be selected by pressing the trip mode/reset switch for less than 1 second and then releasing.

Tripmeter can be reset to 0.0 by pressing the trip mode/reset switch for more than 1 second.

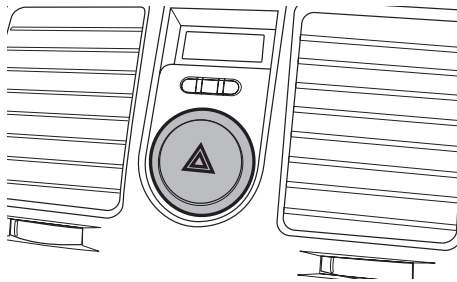
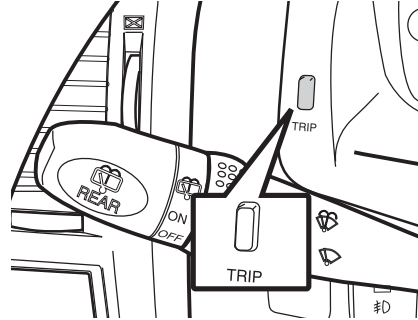

## HAZARD WARNING FLASHER

The hazard warning flasher should be used whenever you find it necessary to stop the vehicle in a hazardous location.

The hazard warning lights are turned on by pushing in the hazard switch. This causes all turn signal lights to blink. The hazard warning lights will operate even though the key is not in the ignition switch.

To turn OFF the hazard warning lights, push the hazard switch.

## POWER OUTLET (IF EQUIPPED)

When the ignition switch is in the ACC or ON position, the power outlet can be used. The power outlet is designed to provide power for mobile telephones or other devices designed to operate with vehicle electrical systems. The devices should draw less than 10 amps with the engine running.

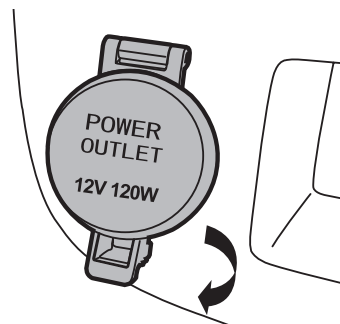



## INFORMATION ON VEHICLE PULLING

- Keep the recommended tire pressure (30 psi for petrol and 32 psi for diesel).
- Indian roads have slope towards the outer side ( $3^{\circ} \sim 6^{\circ}$ ), which may cause the vehicle to drift outwards.

RIM SIZE		TIRE SIZE		RECOMMENDED INFLATION PRESSURE-COLD			
				PRESSURE kPa (PSI)			
				UP TO 2 PERSONS		UP TO MAX LOAD	
				FRONT	REAR	FRONT	REAR
4.5 JX 14	155/70R14			210 (30)	210 (30)	230 (33)	230 (33)
5.0 JX 14	175/65R14			220 (30)	220 (30)	230 (33)	230 (33)
5.5 JX 15	175/55R15			220 (30)	220 (30)	230 (33)	230 (33)

THE TIRES FITTED TO THIS VEHICLE SHALL HAVE A MAX. LOAD RATING NOT LESS THAN 500Kg, OR A LOAD INDEX OF 84 AND A SPEED CATEGORY NOT LESS THAN T.

## INFORMATION ON VEHICLE PULLING

- While driving, always hold the steering wheel lightly as shown in the photo so that the vehicles move straight.

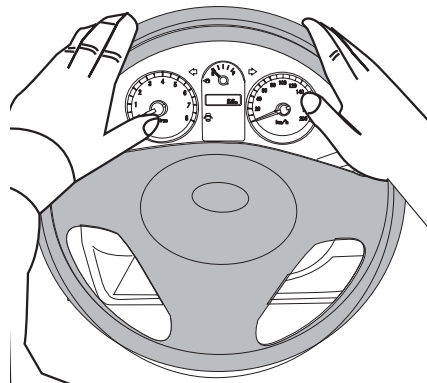

## CHILD-PROTECTOR REAR DOOR LOCK

- To engage the child-protector feature so that the door cannot be opened from the inside.
- Move the child-protector lever to the "LOCK" position and close the door.
- Move the lever to the "UNLOCK" position when normal door operation is desired.
- To open the door from the outside, pull the outside door handle.

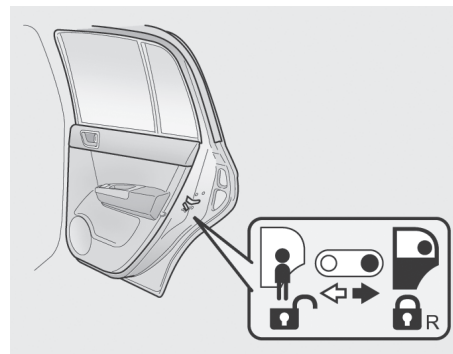



## PROTECT YOUR CAR WITH THEFT ALARM SYSTEM

**HYUNDAI GENUINE ACCESSORY**  
(if installed)

### SYSTEM OPERATES IN FOLLOWING STAGES

#### 1. Armed Stage/Door Locking

(System is "ON")

- Push "Lock/Unlock" button (A)
- All doors will lock & turn signal lamp will blink twice to indicate system is armed.
- If any Door, remains open, the system will not be armed.

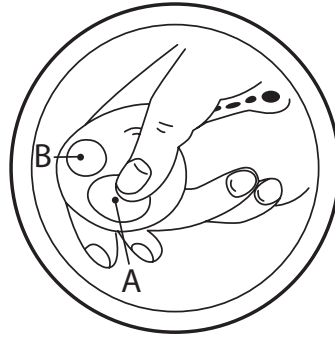

#### 2. Alarm Stage

- Alarm will be activated i.e. Siren will sound & turn signal continuously blink, if any of following is opened without using transmitter.
  - Front Door
  - Rear Door
- Press 'Lock/Unlock' button to turn off the system.

#### 3. Disarm Stage/Door unlocking

(System if "OFF")

- Press "Unlock" Button
  - All doors will unlock and turn signal lamp will blink once to indicate that the system is disarmed.

#### 4. Panic Stage (if installed)

- Push 'Panic' button, (B)
  - Siren will sound and turn signal lamp will blink continuously.
- To turn off system press Panic button again.

### REMOTE KEYLESS ENTRY (if installed)

#### LOCK

Press LOCK BUTTON to lock all doors.  
Press again to hear confirmation chirp.

#### UNLOCK

Press UNLOCK BUTTON to unlock the driver's door. Press again within four seconds to unlock all doors.

### CENTRAL DOOR LOCKING SYSTEM (if installed)

- Driver's door lock controls the central door locking system.
- When driver's door is locked the passenger doors also get locked automatically.

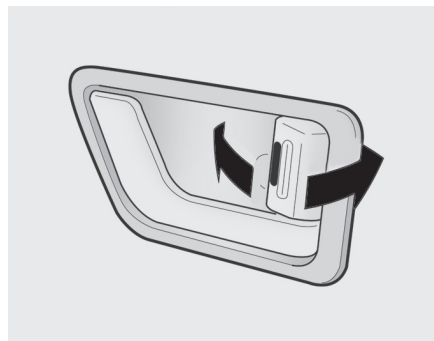



## TO MAKE YOURSELF SIT COMFORTABLY

### FRONT SEAT ADJUSTMENT

#### A. ADJUSTING SEAT FORWARD AND BACKWARD

To move the seat toward the front or rear, pull the lock release lever upward and adjust the seat.

When you find the position you want, "release the lever" and slide the seat forward or backward on its track until it locks into the desired position and cannot be moved.

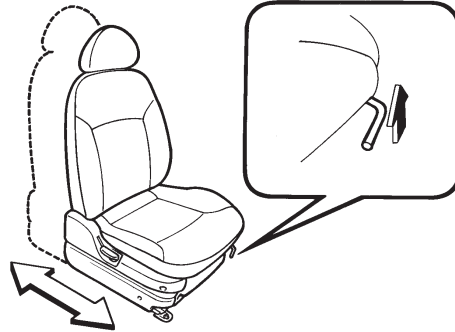

#### B. ADJUSTING SEAT BACK ANGLE

Lift the lever on the side of the seat to adjust your seat back angle. Release the lever when you have found a comfortable position.

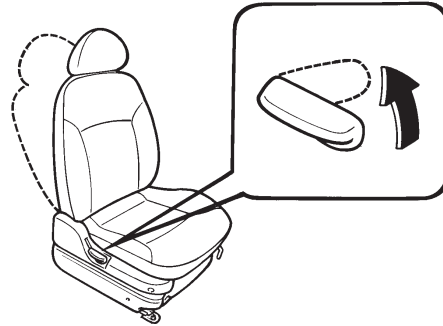

### REAR SEAT ADJUSTMENT

The rear seatbacks may be folded to facilitate carrying long items or to increase the luggage capacity of the vehicle as per the requirement.

Push and hold the seat back folding lever toward the headrest, then fold the seat toward the front of the vehicle. When you return the seatback to its upright position, always be sure it has locked into position by pushing on the top of the seatback.

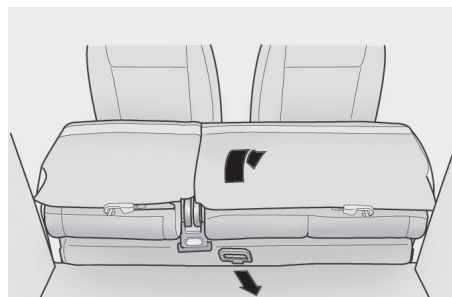
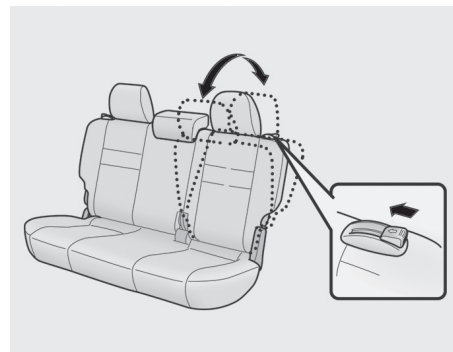

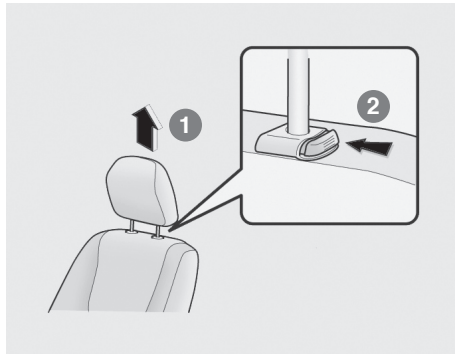

#### ADJUSTABLE HEADREST (IF EQUIPPED)

Headrests are designed to keep you neck comfortable while driving.

To raise the headrest, pull it up (1). To lower it, push downwards while pressing the lock knob (2).

For maximum effectiveness the headrest should be adjusted so the middle of the headrest is at the same height as the top of the occupant's eyes.

#### REMOTE FUEL-FILLER LID RELEASE (IF EQUIPPED)

The fuel-filler lid may be opened from inside the vehicle by pulling up the fuel-filler lid opener located on the bottom right driver's side of the car.

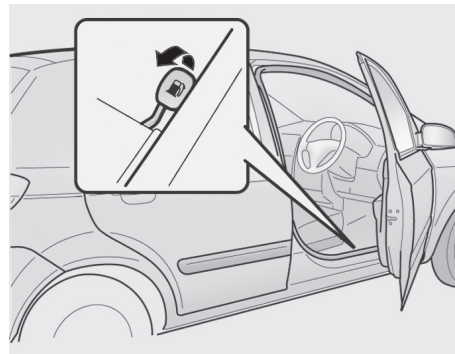





## TAIL GATE

The tail gate can be locked or unlocked with a key. The tail gate is opened by pulling the outside handle up, raising the tail gate manually.

To close, lower the tail gate, then press down on it until it is closed. To be sure the tail gate is securely fastened, always try to pull it up again without using the outside handle.



## CAR MATS/CARPETS

### Precaution for car mats / carpets

- \* Use car mats which are anti-slip and custom-fit for your vehicle.
- \* If mats are damaged, replace them with new one.
- \* Use only Hyundai genuine parts.

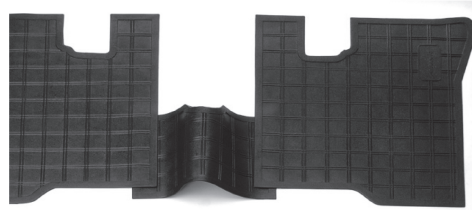

## TIPS FOR IMPROVING FUEL EFFICIENCY & PERFORMANCE

### Inflate tyres at correct pressure

- Maintain correct tyres pressure (30 psi for petrol & 32 psi for diesel). Under inflation can add up to 10% extra fuel bill.

### Maximise use of 5th gear & drive at cost conscious speed of 45-50 kmph.

- Maximise the use of 5th gear for better fuel economy. 5th over drive gear increases fuel efficiency by 20% to 25% as compared to 3rd gear driving.

### Are you driving in low gears to make your engine a fuel-holic?

- Drive your car in correct gear.

### Note:

It is wrong to assume the 5th overdrive gear is only for high speed highway driving. Use of 5th overdrive gear in city driving will greatly help to improve fuel economy.



**Avoid frequent gear changes, acceleration & braking.**

- Avoid frequent gear changes, acceleration & braking through planned driving by looking ahead and judging the speed of other vehicle & timing of traffic lights etc.

**Idling car is the devil's workshop.**

- Three minutes idling = 1 km lost. Do not keep the engine idling for more than 2 minutes while waiting for somebody, loading or unloading or while being stopped by congested traffic or signal.

**Use air conditioner only when it is essential.**

- Use air conditioner judiciously as it consumes around 20-25% of total fuel consumed.

**Do not ride the clutch pedal.**

- Do not ride the clutch pedal. This will cause its slippage resulting in more fuel consumption and damage to the clutch parts.

**Regular service saves fuel.**

- Get your car regularly serviced & tuned for improved performance.

**Releasing Parking Brake before take off.**

- Releasing Parking Brake fully before take off to avoid straining of Brakes & Engine.

**Use Hyundai Genuine oil to increase the mileage.**

- If you already know that good engine oil is vital to your engine's long life and smooth performance, it is rather easy to choose one. Use only Hyundai Genuine Oils for Engines, Transmission, Brakes and Radiator Coolant.

## SAFETY INFORMATION

### BASIC SAFETY PRECAUTIONS

1. Whenever operating the vehicle, make sure that you and your occupants are properly wearing seat belts.
2. Small children should always ride in the rear seat in the appropriate child restraint system (see Owner's Manual for child safety details).
3. Never place children under thirteen years old in the front seats to avoid injury that may result from air bag deployment (if installed).
4. Always refer to the Owner's Manual for complete safety precaution information.
5. Stopping distance increases with increasing vehicle speed. Apply brakes well ahead of the stopping points.





## MAINTENANCE

Scheduled Maintenance	Normal Usage		Severe Usage *	
	Inspect	Replace	Inspect	Replace
Air Cleaner Filter	10 K	20 K		10 K
Engine oil & filter	-	10 K	-	5 K / 6 Months
Vacuum Hose & Crankcase Ventilation Hose	10 K	-		
Air Conditioning Refrigerant	10 K	-		
Brake Hoses & Lines	10 K	-		
Brake Pads , Calipers & Rotors	10 K	-	More Frequently	
Drive Shaft & Boots	10 K	-		
Exhaust Pipe & Muffler	10 K	-		
Fuel Tank Air Filter	10 K	30 K		
Steering Gear Box , Linkage & Boots/Lower Arm Ball Joint	10 K	-	More Frequently	
Suspension	10 K	-		
Brake & Clutch Fluid	10 K	30 K		
Coolant	10 K	30 K		
Drive Belt (Alt, Water Pump, A/c)	10 K	-		
Fuel Lines , Fuel Hoses & Connections	10 K	-		
Manual Transaxle Oil	10 K	30 K		15 K
Power Steering Pump, Belt & Hoses	10 K	-		
Rear Brake Drums/Linings, Parking Brake	10 K	-	More Frequently	
Spark Plugs	10 K	30 K		More Frequently
Timing Belt	10 K	80 K		60 K
Fuel Filler Cap	10 K	-		
Fuel Filter	10 K	60 K		
*All Units Displayed in Kilometers				
For Additional Maintenance Schedule Information See Your Owner's Manual				

**Looking For More Detailed Information ?** This Quick Reference Guide does not replace your vehicle's Owner's Manual . If you require additional information or are unsure of a specific issue , you should always refer to the vehicle's Owner's Manual or contact our authorized Hyundai dealer.