

INSTRUCTIONS MANUAL VD7

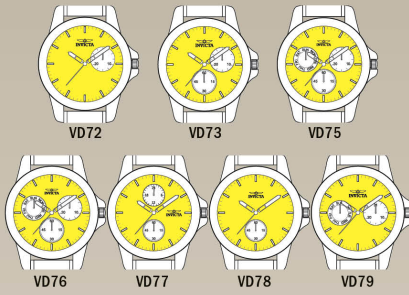

PRESENTATION



Display Elements

- 24 Hours Counter
- Hour Hand
- Minute Hand
- Day
- Date
- Small Second

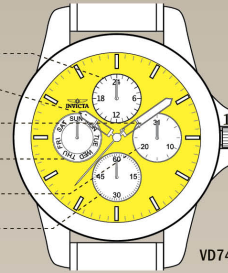

Control Buttons

- 1
- 2
- 3
- Crown

SETTINGS

Setting the Time (VD72, VD73, VD74, VD75, VD76 & VD79)

- 1.1 Pull out the crown to position 3 when the small second hand is at the 12 o'clock position
- 1.2 Advance the hour and minute hands by turning the crown
- 1.3 Push the crown back into position 1

Note:

Check that 24 hour hand is set correctly

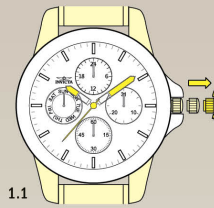

1.1



1.2

Setting the Day (VD72, VD73, VD74, VD75, VD76 & VD79)

- 2.1 Pull out the crown to position 3
- 2.2 Turn the crown clockwise to set the day
- 2.3 Push the crown back into position 1

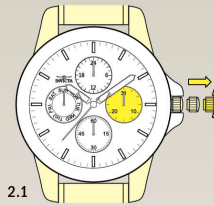

2.1



2.2

Setting the Date (VD72, VD73, VD74, VD75, VD76 & VD79)

- 3.1 Pull out the crown to position 2
- 3.2 Turn the crown counter-clockwise to set the date
- 3.3 Push the crown back into position 1

Note:

Do not set the date between 10:00PM and 1:00AM. Otherwise, the day may not change properly. If it is necessary to set the date during that time period, first change the time to any time outside it, set the date and then reset the correct time.



3.1



3.2

Setting the Time (VD77 & VD78)

- 4.1 Pull out the crown to position 2 when the small second hand is at the 12 o'clock position
- 4.2 Advance the hour and minute hands by turning the crown
- 4.3 Push the crown back into position 1

Note:

Check that 24 hour hand is set correctly



4.1



4.2

INFO