

# JVC KD-R200

## CD RECEIVER: INSTRUCTIONS/INSTALLATION

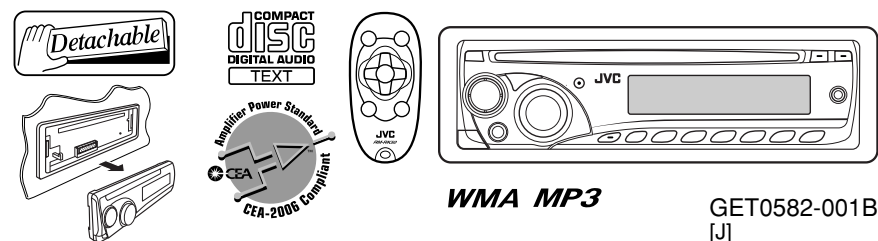

### ENGLISH

#### INFORMATION (For U.S.A.)

This equipment has been tested and found to comply with the limits for a Class B digital device, pursuant to Part 15 of the FCC Rules. These limits are designed to provide reasonable protection against harmful interference in a residential installation. This equipment generates, uses, and can radiate radio frequency energy and, if not installed and used in accordance with the instructions, may cause harmful interference to radio communications. However, there is no guarantee that interference will not occur in a particular installation. If this equipment does cause harmful interference to radio or television reception, which can be determined by turning the equipment off and on, the user is encouraged to try to correct the interference by one or more of the following measures:

- Reorient or relocate the receiving antenna.
- Increase the separation between the equipment and receiver.
- Connect the equipment into an outlet on a circuit different from that to which the receiver is connected.
- Consult the dealer or an experienced radio/TV technician for help.

#### Caution

Changes or modifications not approved by JVC could void the user's authority to operate the equipment.

#### IMPORTANT FOR LASER PRODUCTS

1. CLASS 1 LASER PRODUCT
2. **CAUTION:** Do not open the top cover. There are no user serviceable parts inside the unit; leave all servicing to qualified service personnel.
3. **CAUTION:** (For U.S.A.) Visible and/or invisible class II laser radiation when open. Do not stare into beam.  
(For Canada) Visible and/or invisible class 1M laser radiation when open. Do not view directly with optical instruments.
4. REPRODUCTION OF LABEL: CAUTION LABEL, PLACED OUTSIDE THE UNIT.

CAUTION	ATTENTION	AVISO	VARNING	注意	CAUTION
VISIBLE AND/OR INVISIBLE CLASS 1M LASER RADIATION WHEN OPEN. DO NOT VIEW DIRECTLY WITH OPTICAL INSTRUMENTS. DIRECTEMENT AVEC DES INSTRUMENTS OPTIQUES. (EN3)	RAYONNEMENT LASER VISIBLE ET/OU INVISIBLE DE CLASSE 1M L'UNE FOIS OUVERT. NE PAS REGARDER DIRECTEMENT AVEC DES INSTRUMENTS OPTIQUES. (FRA)	RADIACION LASER DE CLASE 1M VISIBLE Y/O INVISIBLE CUANDO ESTA ABIERTO. NO MIRAR DIRECTAMENTE CON INSTRUMENTAL OPTICA. (ESP)	SYNLIG OCH/ELLER OYNLIG LASERSTRÅLNING, KLAS 1M, NÄR DENNA ÖPPNAS. BÅDA ÖPPNAD. STRÅLEN MED OPTISKA INSTRUMENT. (SWE)	ここに警告と注意及び安全上の事項のクラス1Mレーザー放射が加ります。必ず保護メガネを必ず着用してください。 (JPN)	VISIBLE AND/OR INVISIBLE CLASS II LASER RADIATION WHEN OPEN. DO NOT STARE INTO BEAM. DO NOT STARE INTO BEAM. FDA 21 CFR 101.10. (ENG)



[European Union only]

## MORE ABOUT THIS UNIT

### Basic operations

- By pressing SRC on the unit, you can also turn on the power. If the source is ready, playback also starts.
- If you turn off the power while listening to a disc, disc play will start from where it had been stopped previously next time you turn on the power.
- When no disc is loaded in the unit, you cannot select "CD" as the playback source.

### Tuner operations

- During SSM search...
  - All previously stored stations are erased and the stations are stored anew.
  - Received stations are preset in No. 1 (lowest frequency) to No. 6 (highest frequency).
  - When SSM is over, the station stored in No. 1 will be automatically tuned in.

### Disc operations

#### Caution for DualDisc playback

- The Non-DVD side of a "DualDisc" does not comply with the "Compact Disc Digital Audio" standard. Therefore, the use of Non-DVD side of a DualDisc on this product may not be recommended.

#### General

- This unit has been designed to reproduce CDs/CD Texts, and CD-Rs (Recordable)/CD-RWs (Rewritable) in audio CD (CD-DA) and MP3/WMA formats.
- After ejecting a disc, "NO DISC" appears and you cannot operate some of the buttons. Insert another disc or press SRC to select another playback source.

#### Playing a CD-R or CD-RW

- Use only "finalized" CD-Rs or CD-RWs.
- This unit can play back multi-session discs; however, unclosed sessions will be skipped while playing.
- Some CD-Rs or CD-RWs may not be played back on this unit:
  - Discs are dirty or scratched.
  - Moisture condensation has occurred on the lens inside the unit.
  - The pickup lens inside the unit is dirty.
  - The files on the CD-R/CD-RW are written using the "Packet Write" method.

- There are improper recording conditions (missing data, etc.) or media conditions (stained, scratched, warped, etc.).
- CD-RWs may require a longer readout time since the reflectance of CD-RWs is lower than that of regular CDs.

#### Playing an MP3/WMA disc

- This unit can play back MP3/WMA files with the extension code <.mp3> or <.wma> (regardless of the letter case—upper/lower).
- This unit can show the names of albums, artists (performer), and tag (Version 1.0, 1.1, 2.2, 2.3, or 2.4) for MP3 files and for WMA files.
- This unit can display only one-byte characters. No other characters can be correctly displayed.
- This unit can play back MP3/WMA files meeting the conditions below:
  - Bit rate: 8 kbps — 320 kbps
  - Sampling frequency: 48 kHz, 44.1 kHz, 32 kHz (for MPEG-1) 24 kHz, 22.05 kHz, 16 kHz (for MPEG-2)
  - Disc format: ISO 9660 Level 1/ Level 2, Romeo, Joliet, Windows long file name
- The maximum number of characters for file/folder names vary depending on the disc format used (includes 4 extension characters—<.mp3> or <.wma>).
  - ISO 9660 Level 1: up to 12 characters; ISO 9660 Level 2: up to 31 characters; Romeo: up to 64 characters; Joliet: up to 32 characters; Windows long file name: up to 126 characters
- This unit can recognize a total of 512 files, 255 folders, and 8 hierarchical levels.
- This unit can play back files recorded in VBR (variable bit rate). Files recorded in VBR have a discrepancy in the elapsed time display, and do not show the actual elapsed time. In particular, this difference becomes noticeable after performing the search function.
- This unit cannot play back the following files:
  - MP3 files encoded in: MP3i and MP3 PRO format, in an inappropriate format, layer 1/2.
  - WMA files: encoded in lossless, professional, and voice format; not based upon Windows Media® Audio; copy-protected with DRM.
  - Files which have data such as WAVE, ATRAC3, etc.
- The search function works but search speed is not constant.

#### Thank you for purchasing a JVC product.

Please read all instructions carefully before operation, to ensure your complete understanding and to obtain the best possible performance from the unit.

Installation/connection are explained at the last section of this manual (reverse page, indicated with symbol).

#### For customer Use:

Enter below the Model No. and Serial No. which are located on the top or bottom of the cabinet. Retain this information for future reference.

Model No.

Serial No.

0409DTSMDTJEIN  
EN

© 2009 Victor Company of Japan, Limited

#### For safety...

- Do not raise the volume level too much, as this will block outside sounds, making driving dangerous.
- Stop the car before performing any complicated operations.

#### Temperature inside the car...

If you have parked the car for a long time in hot or cold weather, wait until the temperature in the car becomes normal before operating the unit.

#### Warning

If you need to operate the unit while driving, be sure to look around carefully or you may be involved in a traffic accident.

#### Caution on volume setting

Discs produce very little noise compared with other sources. Lower the volume before playing a disc to avoid damaging the speakers by the sudden increase of the output level.

## MAINTENANCE

#### How to clean the connectors

Wipe the connectors with a cotton swab or cloth moistened with alcohol.

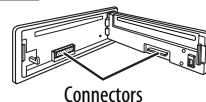

#### To keep discs clean

Wipe in a straight line from center of disc to edge. Do not use liquid cleaners, thinners, or benzene.



#### Moisture condensation

Moisture may condense on the lens inside the unit. Eject the disc and leave the unit turned on for a few hours until the moisture has evaporated.

#### To play new discs

Remove any rough areas from the inner and outer edges of the disc.



#### Do not use the following discs:

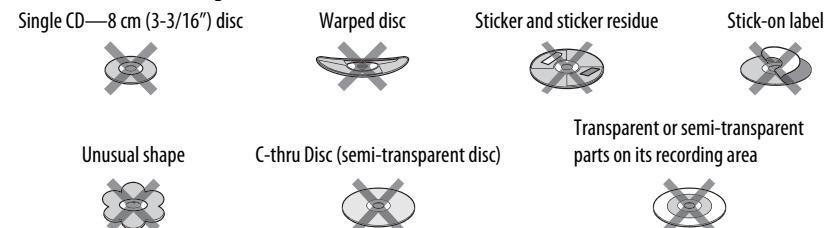

## PREPARATIONS

#### How to reset your unit

Reset the unit after installation is complete.

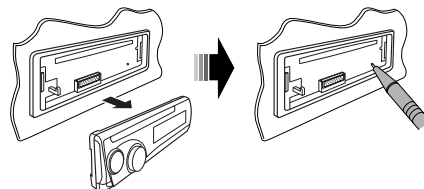

- Your preset adjustments will also be erased.

#### How to forcibly eject a disc



- Be careful not to drop the disc when it ejects.
- If this does not work, reset your unit.

#### Detaching the control panel

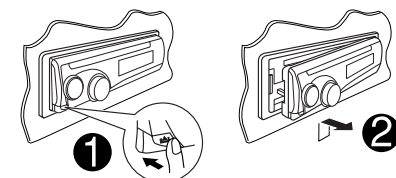

#### Attaching the control panel

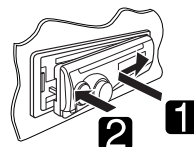

#### Basic settings

##### 1 Enter PSM menu.



##### 2 Select an item.



##### 3 Adjust.



##### 4 Finish



#### Cancel the display demonstration

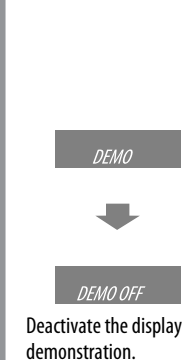

#### Set the clock

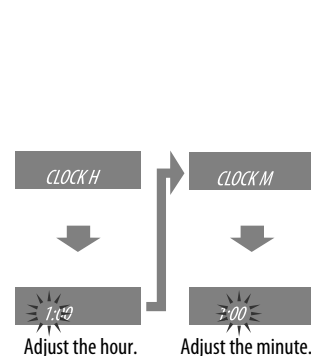

See reverse page ➡

General settings—PSM

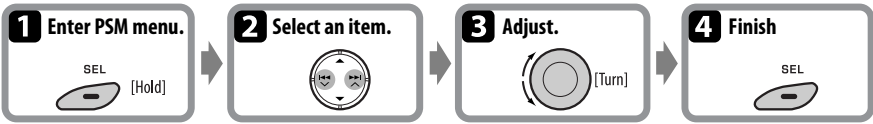

Indication	Item ( __ : Initial)	Setting
DEMO	<ul style="list-style-type: none"><li>DEMO ON</li><li>DEMO OFF</li></ul>	: Display demonstration will be activated automatically if no operation is done for about 20 seconds. : Cancels.
CLK DISP*1	<ul style="list-style-type: none"><li>ON</li><li>OFF</li></ul>	: Clock time is shown on the display at all times when the power is turned off. : Cancels; pressing DISP will show the clock time for about 5 seconds when the power is turned off.
CLOCK H (Hour)	1 – 12	: [Initial: 1 (1:00)]
CLOCK M (Minute)	00 – 59	: [Initial: 00 (1:00)]
DIMMER	<ul style="list-style-type: none"><li>ON</li><li>OFF</li></ul>	: Dims the display and button illumination. : Cancels.
SCROLL*2	<ul style="list-style-type: none"><li>ONCE</li><li>AUTO</li><li>OFF</li></ul>	: Scrolls the displayed information once. : Repeats scrolling (at 5-second intervals). : Cancels. • Pressing DISP for more than one second can scroll the display regardless of the setting.
L/O MODE	<ul style="list-style-type: none"><li>REAR</li><li>WOOFER</li></ul>	: Select if the REAR LINE OUT terminals are used for connecting the speakers (through an external amplifier). : Select if the REAR LINE OUT terminals are used for connecting a subwoofer.
WOOFER*3	<ul style="list-style-type: none"><li>LOW</li><li>MID</li><li>HIGH</li></ul>	: Frequencies lower than 90 Hz are sent to the subwoofer. : Frequencies lower than 135 Hz are sent to the subwoofer. : Frequencies lower than 180 Hz are sent to the subwoofer.
AUX ADJ	A.ADJ 00 – A.ADJ 05	: Adjust the auxiliary input level to avoid the sudden increase of the output level when changing the source from external component connected to the AUX input jack on the control panel.
TAG DISP	<ul style="list-style-type: none"><li>TAG ON</li><li>TAG OFF</li></ul>	: Shows the Tag while playing MP3/WMA tracks. : Cancels.
AMP GAIN*4	<ul style="list-style-type: none"><li>LOW PWR</li><li>HIGH PWR</li></ul>	: VOL 00 – VOL 30 (Select if the maximum power of each speaker is less than 50 W to prevent damaging the speaker.) : VOL 00 – VOL 50
AREA	<ul style="list-style-type: none"><li>AREA US</li><li>AREA EU</li><li>AREA SA</li></ul>	: When using in North/Central/South America. AM/FM intervals are set to 10 kHz/200 kHz. : When using in any other areas. AM/FM intervals are set to 9 kHz/50 kHz (100 kHz during auto search). : When using in South American countries where FM interval is 100kHz. AM interval is set to 10kHz.

\*1 If the power supply is not interrupted by turning off the ignition key of your car, it is recommended that you select “OFF” to save the car’s battery.  
\*2 Some characters or symbols will not be shown correctly (or will be blanked) on the display.  
\*3 Displayed only when “L/O MODE” is set to “WOOFER.”  
\*4 The volume level automatically changes to “VOL 30” if you change to “LOW PWR” while the volume level is set higher than “VOL 30.”

SPECIFICATIONS

Audio amplifier section

Power Output:  
20 W RMS × 4 Channels at 4 Ω and ≤ 1% THD+N  
Signal-to-Noise Ratio:  
80 dBA (reference: 1 W into 4 Ω)

Load Impedance: 4 Ω (4 Ω to 8 Ω allowance)  
Tone Control Range: Bass: ±12 dB at 60 Hz  
Mid-range: ±12 dB at 1 kHz  
Treble: ±12 dB at 7.5 kHz  
Frequency Response: 40 Hz to 20 000 Hz  
Line-Out Level/Impedance: 2.5 V/20 kΩ load (full scale)  
Output Impedance: 1 kΩ  
Subwoofer-Out Level/Impedance: 2.5 V/20 kΩ load (full scale)

If a kit is necessary for your car, consult your telephone directory for the nearest car audio speciality shop.

Tuner section

Frequency Range:  
FM: 87.5 MHz to 107.9 MHz  
(with channel interval set to 100 kHz or 200 kHz)  
87.5 MHz to 108.0 MHz  
(with channel interval set to 50 kHz)  
AM: 530 kHz to 1 710 kHz  
(with channel interval set to 10 kHz)  
531 kHz to 1 602 kHz  
(with channel interval set to 9 kHz)

**[FM Tuner]**  
Usable Sensitivity: 11.3 dBf (1.0 μV/75 Ω)  
50 dB Quieting Sensitivity: 16.3 dBf (1.8 μV/75 Ω)  
Alternate Channel Selectivity (400 kHz): 65 dB  
Frequency Response: 40 Hz to 15 000 Hz  
Stereo Separation: 35 dB

**[AM Tuner]**  
Sensitivity/Selectivity: 20 μV/35 dB

TROUBLESHOOTING

	Symptoms	Remedies/Causes
General	• Sound cannot be heard from the speakers.	• Adjust the volume to the optimum level. • Check the cords and connections.
	• The buttons on the unit do not work as you intended.	If you press M MODE, some buttons work differently from it original function. Wait for 5 seconds or press M MODE again.
	• This unit does not work at all.	Reset the unit.
FM/AM	• SSM automatic presetting does not work.	Store stations manually.
	• Static noise while listening to the radio.	Connect the antenna firmly.
Disc playback	• Disc ejects.	Insert the disc correctly.
	• CD-R/CD-RW cannot be played back. • Tracks on the CD-R/CD-RW cannot be skipped.	• Insert a finalized CD-R/CD-RW. • Finalize the CD-R/CD-RW with the component which you used for recording.
	• Disc can be neither played back nor ejected.	• Unlock the disc. • Eject the disc forcibly.
	• Disc sound is sometimes interrupted.	• Stop playback while driving on rough roads. • Change the disc. • Check the cords and connections.
	• “NO DISC” appears on the display. • “PLEASE” and “EJECT” appear alternately on the display.	Insert a playable disc into the loading slot.
MP3/WMA playback	• Disc cannot be played back.	• Use a disc with MP3/WMA tracks recorded in a format compliant with ISO 9660 Level 1, Level 2, Romeo, or Joliet. • Add the extension code <.mp3> or <.wma> to the file names.
	• Noise is generated.	Skip to another track or change the disc. (Do not add the extension code <.mp3> or <.wma> to non-MP3 or WMA tracks.)
	• A longer readout time is required (“READING” keeps flashing on the display).	Do not use too many hierarchical levels and folders.
	• Tracks are not played back in the order you have intended.	Playback order is determined when the files are recorded.
	• The elapsed playing time is not correct.	This sometimes occurs during playback. This is caused by how the tracks are recorded on the disc.
	• The correct characters are not displayed (e.g. album name).	This unit can only display alphabets (upper case), numbers, and a limited number of symbols.

• Microsoft and Windows Media are either registered trademarks or trademarks of Microsoft Corporation in the United States and/or other countries.

CD player section

Type: Compact disc player  
Signal Detection System: Non-contact optical pickup (semiconductor laser)  
Number of channels: 2 channels (stereo)  
Frequency Response: 5 Hz to 20 000 Hz  
Dynamic Range: 93 dB  
Signal-to-Noise Ratio: 98 dB  
Wow and Flutter: Less than measurable limit  
MP3 Decoding Format: MPEG1/2 Audio Layer 3  
Max. Bit Rate: 320 kbps

WMA (Windows Media® Audio) Decoding Format :  
Max. Bit Rate: 192 kbps

**Having TROUBLE with operation?**  
**Please reset your unit**  
**Still having trouble??**  
**Call 1-800-252-5722 (USA ONLY)**  
**http://www.jvc.com**

General

Power Requirement: Operating Voltage: DC 14.4 V (11 V to 16 V allowance)  
Grounding System: Negative ground  
Allowable Operating Temperature: 0°C to +40°C (32°F to 104°F)  
Dimensions (W × H × D):  
Installation Size (approx.): 182 mm × 52 mm × 160 mm (7-3/16" × 2-1/16" × 6-5/16")  
Panel Size (approx.): 188 mm × 58 mm × 5 mm (7-7/16" × 2-5/16" × 1/4")  
Mass (approx.): 1.3 kg (2.9 lbs) (excluding accessories)

*Design and specifications are subject to change without notice.*

PREPARATION

This unit is designed to operate on **12 V DC, NEGATIVE ground electrical systems**. If your vehicle does not have this system, a voltage inverter is required, which can be purchased at JVC car audio dealers.

Prepare this before installation

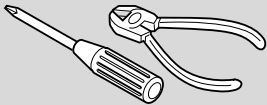

WARNINGS

To prevent short circuits, we recommend that you disconnect the battery’s negative terminal and make all electrical connections before installing the unit.

- **Be sure to ground this unit to the car’s chassis again after installation.**

Notes:

- Replace the fuse with one of the specified rating. If the fuse blows frequently, consult your JVC car audio dealer.
- It is recommended to connect to the speakers with maximum power of more than 50 W (both at the rear and at the front, with an impedance of **4 Ω to 8 Ω**). If the maximum power is less than 50 W, change “AMP GAIN” setting to prevent the speakers from being damaged (see “General settings—PSM”).
- To prevent short-circuit, cover the terminals of the UNUSED leads with insulating tape.
- The heat sink becomes very hot after use. Be careful not to touch it when removing this unit.

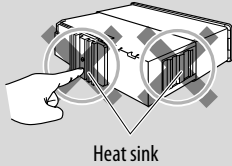

Heat sink



TROUBLESHOOTING

- **The fuse blows.**
  - \* Are the red and black leads connected correctly?
- **Power cannot be turned on.**
  - \* Is the yellow lead connected?
- **No sound from the speakers.**
  - \* Is the speaker output lead short-circuited?
- **Sound is distorted.**
  - \* Is the speaker output lead grounded?
  - \* Are the “—” terminals of L and R speakers grounded in common?
- **Noise interfere with sounds.**
  - \* Is the rear ground terminal connected to the car’s chassis using shorter and thicker cords?
- **This unit becomes hot.**
  - \* Is the speaker output lead grounded?
  - \* Are the “—” terminals of L and R speakers grounded in common?
- **This unit does not work at all.**
  - \* Have you reset your unit?





## Parts list for installation and connection

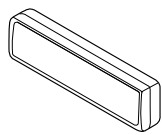

Ⓐ Control panel

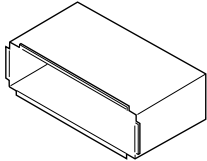

Ⓑ Sleeve

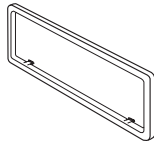

Ⓒ Trim plate

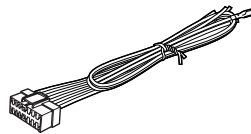

Ⓓ Power cord

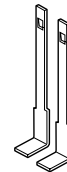

Ⓔ Handles



Ⓕ Remote controller



Ⓖ Battery

## INSTALLATION

The following illustration shows a typical installation. If you have any questions or require information regarding installation kits, consult your JVC car audio dealer or a company supplying kits.

- If you are not sure how to install this unit correctly, have it installed by a qualified technician.

### In dash-mounting

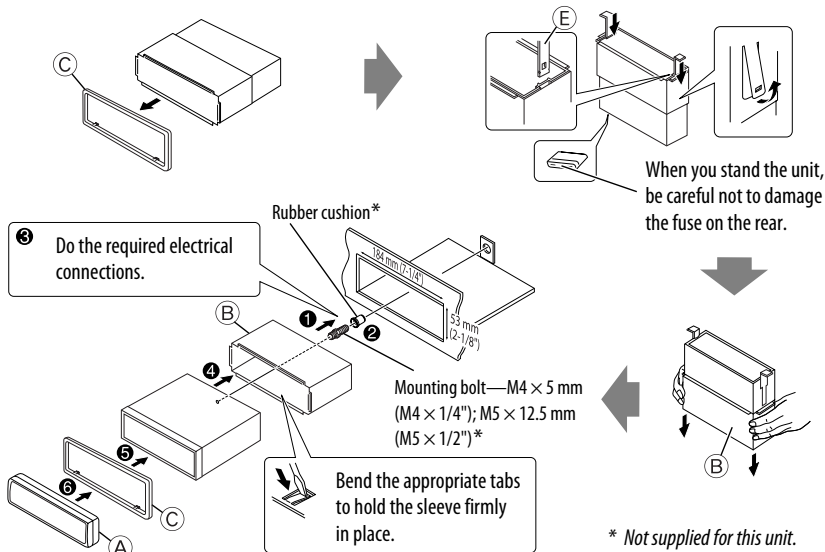

### Removing the unit

Before removing the unit, release the rear section.

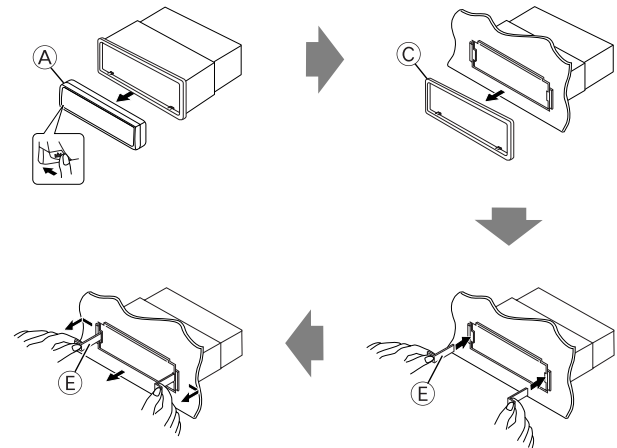

### When using the optional stay

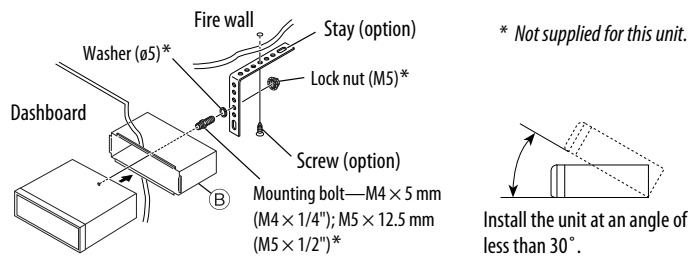

### When installing the unit without using the sleeve

In a Toyota car for example, first remove the car radio and install the unit in its place.

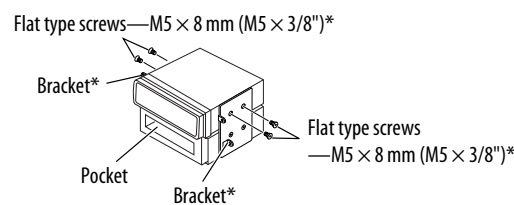

## ELECTRICAL CONNECTIONS

### Typical connections

**Before connecting:** Check the wiring in the vehicle carefully. Incorrect connection may cause serious damage to this unit. The leads of the power cord and those of the connector from the car body may be different in color.

- 1 Connect the colored leads of the power cord in the order specified in the illustration below.
- 2 Connect the antenna cord.
- 3 Finally connect the wiring harness to the unit.

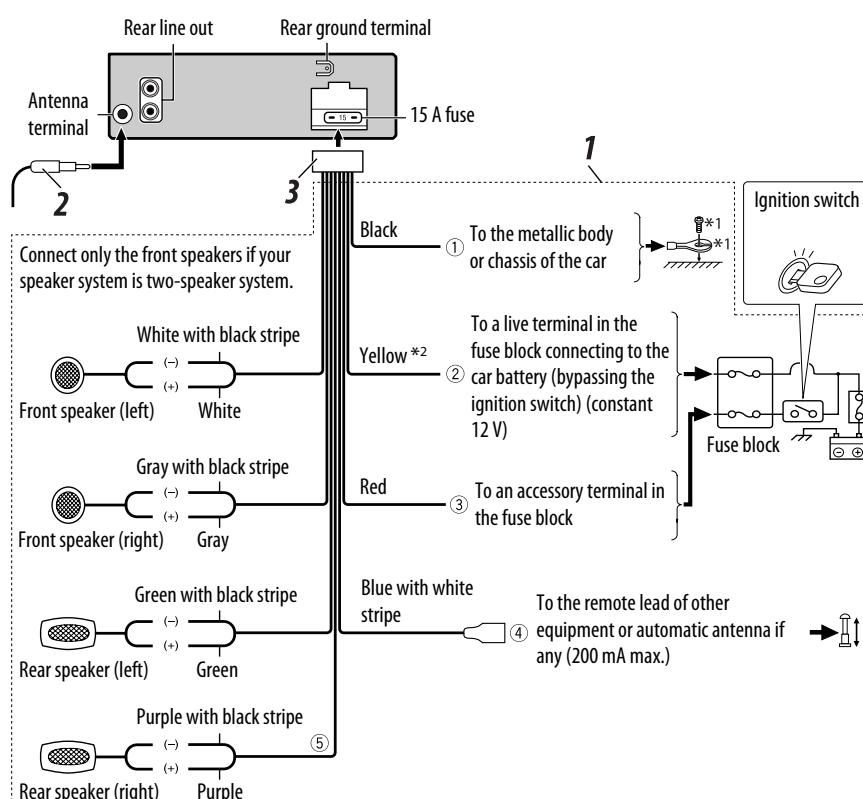

### Connecting the external amplifier or subwoofer

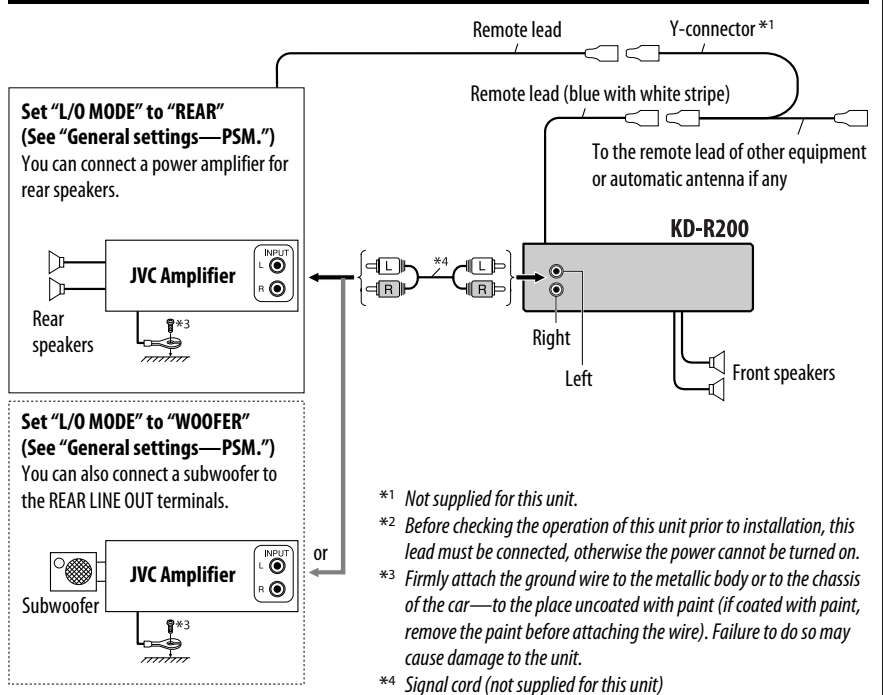

### PRECAUTIONS on power supply and speaker connections:

- DO NOT connect the speaker leads of the power cord to the car battery; otherwise, the unit will be seriously damaged.
- BEFORE connecting the speaker leads of the power cord to the speakers, check the speaker wiring in your car.

