



KEURIG®
Premium Coffee Systems



USE & CARE GUIDE

Gourmet Single Cup Home Brewing System

PLATINUM B70

Please read and save these instructions.
Pour des directives en français, veuillez vous reporter à la page 17

SAFE OPERATION & USE IMPORTANT SAFEGUARDS

When using electrical appliances, basic safety precautions should be followed, including the following:

1. Read all instructions before using.
2. Do not touch hot surfaces. Use handles and knobs when available.
3. This appliance must be properly installed and located in accordance with these instructions before it is used.
4. The use of an accessory not approved for use with this appliance may cause injuries.
5. Do not place on or near a hot gas or electric burner, or in a heated oven.
6. Do not use outdoors.
7. To protect against electric shock, do not immerse cords, plugs, or the appliance in water or any other liquid.
8. Do not overfill the Water Reservoir with water.
9. Use **only water** in this appliance! Do not put any other liquids or foods in the Water Reservoir except as instructed in the Cleaning Instructions in this guide.
10. Unplug the coffee brewer before cleaning. Allow to cool before putting on or taking off parts and before cleaning the appliance.
11. For best operation, plug the appliance into its own electrical outlet on a dedicated circuit to prevent flickering of lights, blowing of fuses or tripping a circuit breaker.
12. Do not operate any appliance with a damaged cord or plug or after the appliance malfunctions or is damaged in any manner. Contact Keurig Customer Service for assistance.
13. Do not let the cord hang over the edge of the table or counter, or touch hot surfaces.
14. To disconnect, press and release the Power Button on the back of the Brewer to 'OFF' status and then remove the plug from the wall outlet.
15. Close supervision is necessary when any appliance is used by or near children.
16. Do not lift the Handle to open the Lid of the Brewer while brewing is in progress.
17. Always keep the Water Reservoir Cover on the Water Reservoir unless you are refilling it.
18. This appliance is equipped with a power cord having a grounding wire with a grounding plug. The appliance must be grounded using a 3-hole properly grounded outlet. In the event of an electrical short circuit, grounding reduces the risk of electrical shock.
19. If the outlet is a standard 2-prong wall outlet, it is your personal responsibility and obligation to have it replaced with a properly grounded 3-prong wall outlet.
20. Do not, under any circumstances, cut or remove the third (ground) prong from the power cord or use an adapter.
21. Consult a qualified electrician if the grounding instructions are not completely understood, or if doubt exists as to whether the appliance is properly grounded.
22. Do not use the appliance for other than its intended use.

**SAVE THESE
INSTRUCTIONS.**

CAUTION: There are two sharp needles that puncture the K-Cup® portion pack, one above the K-Cup Holder and the other in the bottom of the K-Cup Holder.

To avoid risk of injury, do not put your fingers in the K-Cup Chamber.

CAUTION: There is extremely hot water in the K-Cup Holder during the brew process.

To avoid risk of injury, do not lift the Handle or open the K-Cup Chamber during the brew process.

SHORT CORD INSTRUCTIONS: A short power supply cord is provided to reduce the risk of becoming entangled in or tripping over a longer cord.

If an extension cord is used, (1) the marked electrical rating of the cord set or extension cord should be at least as great as the electrical rating of the appliance, (2) the cord should be arranged so that it will not drape over the countertop or table-top where it can be pulled on by children or tripped over unintentionally and (3) the extension cord must include a 3-prong grounding plug.

THIS PRODUCT IS FOR **HOUSEHOLD USE ONLY**.

WARNING: This product contains chemicals, including lead, known to the State of California to cause cancer, birth defects or other reproductive harm.



WARNING: TO REDUCE THE RISK OF FIRE OR ELECTRIC SHOCK, DO NOT REMOVE THE BOTTOM COVER. NO USER SERVICEABLE PARTS ARE INSIDE. REPAIR SHOULD BE DONE BY AUTHORIZED SERVICE PERSONNEL ONLY.

KEURIG® GOURMET SINGLE CUP HOME BREWING SYSTEM

Platinum B70

Use & Care Guide

TABLE OF CONTENTS

SECTION 1

SET-UP & OPERATION

Helpful Hints	4
Unpacking	4
Features	5
Set-Up & First Brew	6

SECTION 2

CONTROLS & INDICATORS

LCD Control Center	9
--------------------------	---

SECTION 3

CLEANING & MAINTENANCE

Cleaning	12
De-Scaling	13
Storage	14

SECTION 4

TROUBLESHOOTING	15
-----------------------	----

SECTION 5

WARRANTY	16
----------------	----

Pour des directives en français, veuillez vous reporter à la page 17.

Record your Brewer Serial Number here.
The Serial Number is located on the bottom of the Brewer on a white sticker.

SECTION 1

SET-UP & OPERATION

Helpful Hints

1. Keep your Brewer turned 'ON' at all times.

To brew a fresh cup of coffee, tea or hot cocoa anytime you want, we suggest you keep your Brewer turned 'ON' all the time.

However, the Brewer is fully programmable so you can set it to turn on and/or off automatically to match your schedule. Or, if you prefer, set the Brewer to automatically turn off after a period of time.

Follow the simple instructions on page 9 and 10 to make using the Brewer convenient for you.

2. For the best tasting gourmet coffee, tea or hot cocoa, Keurig recommends using bottled or filtered water.

Water quality varies from place to place. If you notice an undesirable taste in your cup of coffee such as chlorine or other mineral taste, we recommend you consider using bottled water or water from a filtration system.

3. Choose from four serving sizes.

The perfect cup of coffee, tea or hot cocoa means something different to each coffee lover. Because your Keurig Brewer has a wide variety of coffees to choose from it's easy to find your favorite taste profile. Your Brewer has five size options: a stronger small cup (5.25 oz. serving), a small mug (7.25 oz. serving), a large mug (9.25 oz. serving), a travel mug (11.25 oz. serving) and an iced beverage setting (3.25 oz. serving). Follow the simple instructions on page 7.

NOTE: If you are searching for a "stronger" tasting cup of coffee, try our Extra Bold K-Cups. They have 30% more ground coffee in each K-Cup® portion pack. See www.keurig.com for over 200 varieties of K-Cups.

4. Plug Brewer into its own grounded outlet.

If the electric circuit is overloaded with other appliances, your Brewer may not

function properly. The Brewer should be operated on its own circuit, separate from other appliances.

5. Brewing into a travel mug.

To brew into a travel mug, simply remove the Drip Tray Assembly and place the travel mug on the Drip Tray Base.

Unpacking Instructions

1. Place Brewer box on a large steady surface (such as a table or countertop) or on the floor. Open the box.
2. Remove the Quick Start Guide, Use & Care Guide and other literature.
3. Remove the package of complimentary K-Cup® portion packs.
4. Turn the box on its side with front of box face down.
5. Reach into the box and grasp the plastic bag that contains the Brewer.
6. Carefully pull the plastic bag (and packaging materials) toward you and out of the box. The Brewer will still be encased in the polyfoam and be on its side.
7. Remove the top polyfoam packaging material.
8. Carefully lift Brewer off the bottom polyfoam and place it upright on a flat, steady surface.
9. Lift plastic bag off Brewer.
10. Carefully turn the Brewer on its side and record on page 3 of this book the Serial Number located on the white sticker on the bottom of the Brewer. The Serial Number is also located on the bottom of the Brewer box.
11. Place the Brewer upright on a flat, steady surface. Remove tape holding Water Reservoir in place.

We recommend you save all packing materials in case future shipping of the product is necessary.

WARNING: Keep all plastic bags away from children.

Features

Model B70 Brewer

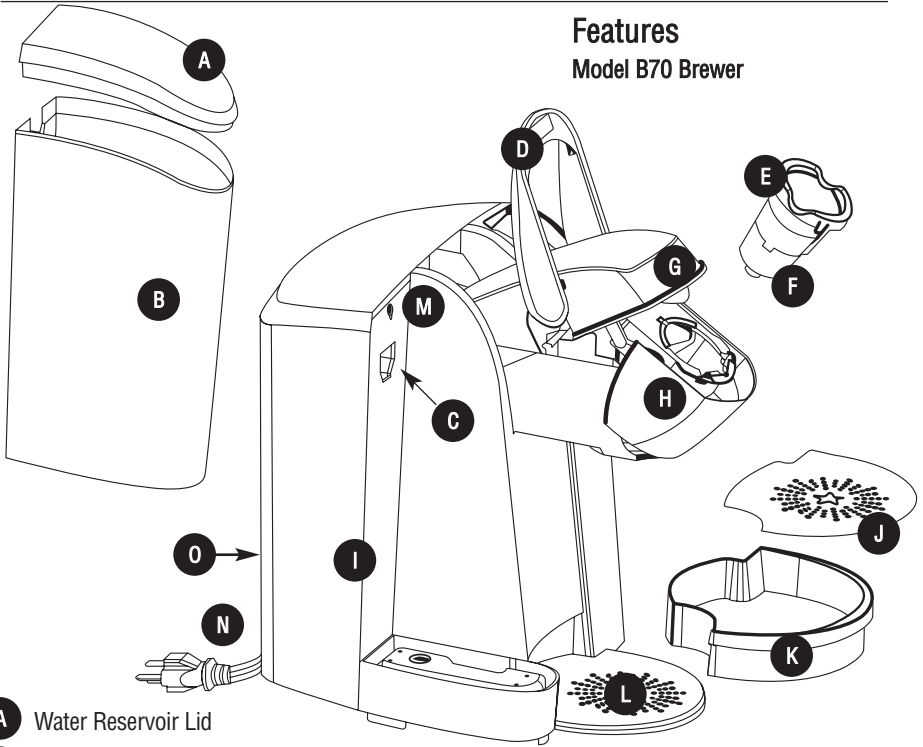

- A** Water Reservoir Lid
- B** Water Reservoir
- C** Water Reservoir Lock Tab Slot
- D** Handle
- E** K-Cup® Portion Pack Holder (E and F are the K-Cup Holder Assembly)
- F** Funnel
- G** K-Cup® Portion Pack Assembly Chamber Housing Lid
- H** K-Cup® Portion Pack Assembly Chamber Housing
- I** Housing
- J** Drip Tray Plate
- K** Drip Tray
- L** Drip Tray Base
- M** Vent
- N** Power Cord
- O** Power Switch (Not shown)
Located Rear Right Side of Brewer

LCD Control Center



Controls and Indicators

- P** LCD Control Center
- Q** LEFT Button
- R** RIGHT Button
- S** MENU Button
- T** BREW Button

Set-Up & First Brew

IMPORTANT: You cannot use your Keurig Brewer until it has been primed for its first use as set forth below.

NOTE: If Brewer has been exposed to temperatures below freezing, allow Brewer at least two hours to reach room temperature before priming. A frozen or extremely cold Brewer will not prime properly and can cause damage.

Priming Your Brewer

1. Unwrap cord and plug the Brewer into a grounded outlet.
2. Place a 12 oz. mug on the Drip Tray Plate.
3. Remove the Water Reservoir from Brewer by first removing Lid from Reservoir, then lifting Reservoir straight up and toward front of Brewer. Rinse with fresh water.
4. Fill Water Reservoir with bottled or filtered water so that the water level is just below the top edge of the reservoir.
5. Place Water Reservoir into the left side of the Brewer and be sure the Water Reservoir Lock Tab engages with the Brewer. Replace Lid on Water Reservoir.

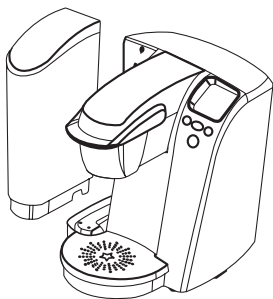

6. Press and release the Power Switch found directly behind the Brewer. Switch is spring loaded and will return to original position.
7. The Blue LCD Control Center will come on and indicate 'PRIME' and the 'BREW' Button will flash. Please note, a K-Cup should NOT be used for the Priming Sequence.

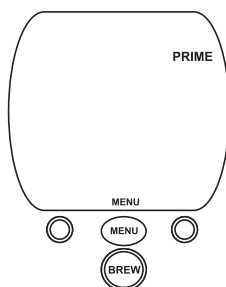

NOTE: If the Water Reservoir is empty or not in place on the Brewer, then the LCD Control Center will indicate 'ADD WATER' and tank LED's will flash. None of the Buttons will be active until water is added to the Water Reservoir.

8. Press the 'BREW' Button.
9. The Brewer will automatically fill with water (priming it) and then the water will be heated. This will take about 4 minutes. During the heating period 'NOT READY' is displayed on the LCD Control Center. Once the water is heated, 'READY TO BREW' will be displayed and the 'BREW' Button will flash.

NOTE: You may see small amounts of water coming from the Vent and dripping into the Water Reservoir during this and subsequent heating – this is normal.

10. Press the 'BREW' Button to start a cleansing brew, during which hot water will flow into your mug. When the flow stops, discard the hot water.
11. The one-time priming process is now complete and you are ready to brew your first cup!

NOTE: The Brewer may take 15-30 seconds to reheat water between brews and then 'READY TO BREW' will be displayed.

Ready to Brew Your First Cup

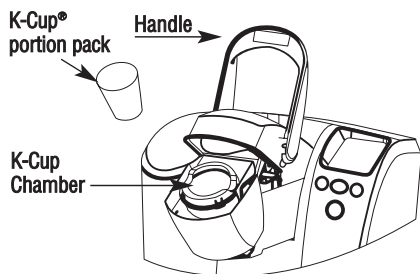

1. LCD Control Center will indicate 'READY TO BREW'.
2. Place a cup or mug on the Drip Tray Plate.
3. Lift the Handle and the K-Cup chamber will open toward you.

CAUTION: There are two sharp needles that puncture the K-Cup® portion pack, one above the K-Cup Holder and the other in the bottom of the K-Cup Holder. To avoid risk of injury, do not put your fingers in the K-Cup Chamber.

4. Select a K-Cup® portion pack.

NOTE: Do not remove the foil lid or puncture the K-Cup® portion pack.



5. Place a K-Cup® portion pack in the K-Cup Holder (as shown in exhibit at top of page).
6. Lower the Handle to close the Lid over the K-Cup Holder. (When it is closed completely, the LCD Control Center will indicate 'READY TO BREW'. The 'LEFT' and 'RIGHT' Buttons will be lit and the 'BREW' Button will flash up to 60 seconds.)



- a. All brew size icons are lit with the default size flashing. To choose a different size, press 'LEFT' Button to go down in size or 'RIGHT' Button to go up in size.

NOTE: The small mug (7.25 oz. serving) is the factory set default brew size. To program your favorite brew size see page 11 "Programming Your Brew Size".

- b. Your choices are a stronger small cup (5.25 oz. serving), a small mug (7.25 oz. serving), a large mug (9.25 oz. serving), a travel mug (11.25 oz. serving) or iced beverage setting (3.25 oz. serving).
- c. To use the iced beverage setting, place a tall glass filled with ice on the drip tray. Use your favorite K-Cup, select the iced beverage brew size and press the brew button. Add more ice once brewing is complete, add cream and sugar if desired.
- d. Once size is chosen, press 'BREW' Button. BREW Button will stop flashing, LEFT and RIGHT Buttons will no longer be lit and icon of brew size will be lit.

NOTE: If you do not push the Brew Button in 60 seconds, the LCD Control Center will return to 'READY TO BREW' and the Brew Buttons will be disabled to prevent accidental activation. Re-activate the Brew sequence by raising and lowering the Handle completely.

7. The LCD Control Center will now display the word 'BREWING' and the serving size you selected will be illuminated on LCD.

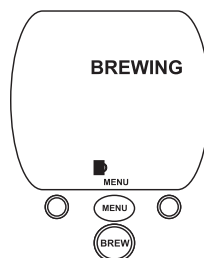

CAUTION: There is extremely hot water in the K-Cup Holder during the brew process. To avoid risk of injury, do not lift the Handle or open the K-Cup Chamber during the brew process.

8. There may be a short pause before the brewing process begins. The process lasts about 60 seconds and ends with a burst of air to remove all liquid from the K-Cup.
9. Lift the Handle and remove and dispose of the used K-Cup. **CAUTION: K-Cup will be hot.**
10. Enjoy your first cup of Keurig Brewed® gourmet coffee, tea or hot cocoa!

11. Your Brewer will display 'NOT READY' as it heats water for the next brew cycle. The 'READY TO BREW' indication will return to the LCD Control Center in about 15-30 sec.

NOTE: Following the brew, your Brewer will fill in preparation for the next brew. The pump will make a vibrating sound. This is normal.

Stopping the Brew Process

If you need to stop the brewing after the process has started, press and release the Power Switch to turn the Brewer 'OFF'. The flow of coffee, tea or hot cocoa will stop, the heating element will shut off and the blue lights illuminating the LCD Control Center and Water Reservoir will disappear.

NOTE: You may get less coffee, tea or hot cocoa in your cup during your next brew. We recommend that you perform a cleansing brew with water only after a terminated brew. Then your NEXT brew will be the volume you have selected.

Adding Water

The LCD Control Center of your Brewer will indicate when the water level in the tank is low or if the Water Reservoir has been removed by displaying the words 'ADD WATER'. The Brewer will not allow you to initiate a brew when 'ADD WATER' is displayed.

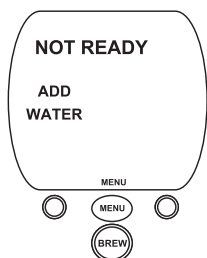

The Water Reservoir can be filled in two ways.

1. Lift off the Water Reservoir Lid and pour water directly into the Water Reservoir while it is still attached to the Brewer, then replace the Lid.
2. Remove the Water Reservoir from Brewer by first removing Lid from the Water

Reservoir, then lifting the Water Reservoir straight up and toward front of Brewer. Fill with water. Place the Water Reservoir back on the Brewer and replace the Lid.

IMPORTANT: Do not remove the Water Reservoir during the brewing process.

Brewing Hot Water

Your Brewer is able to produce a cup of hot water for making hot chocolate in a packet, for use in cooking, for making soups, etc. Simply follow the instructions on page 7 - "Ready To Brew Your First Cup" without adding a K-Cup® Portion Pack.

NOTE: After brewing a hot cocoa K-Cup, we recommend running a hot water brew cycle without a K-Cup.

Purging the Brewer

If your Brewer has not been used for more than one week, you should purge the water from the inner tank.

1. If there is water in the Water Reservoir, remove the Lid, then lift the Water Reservoir straight up and toward front of the Brewer. Discard water, rinse and refill with bottled or filtered water. Place the Water Reservoir back on the Brewer and replace the Lid. (If there is no water in the Water Reservoir, simply refill.)
2. Be sure the Brewer is turned on. Raise and lower the handle on the Brewer without inserting a K-Cup® portion pack.
3. The LCD Control Center will display 'READY TO BREW' and the 'LEFT', 'RIGHT' and 'BREW' Buttons will flash. Be sure to have a 12 oz. mug on the Drip Tray and then select the Travel Mug size brew.
4. Repeat steps 2 and 3 two more times to completely purge water from inner tank.

If you are experiencing any problems with your Brewer, please contact Customer Service at 1-866-901-BREW (2739).

SECTION 2

CONTROLS & INDICATORS

LCD Control Center

Setting the Clock

Setting the clock is optional. When the clock is set, the time will appear on the LCD Control Center. NOTE: You must set the clock if you will be using the Auto On/Off Time programming feature.

- Press the 'MENU' Button.
- The word 'OFF' will appear at the top of the LCD Control Center to indicate that the clock is not set. The programming options will appear on the LCD Control Center with a small arrow pointing to 'SET CLOCK'. H (Hour) will appear above the 'LEFT' Button and M (Minute) will appear above the 'RIGHT' Button. The 'H' and 'M' icons and 'LEFT' and 'RIGHT' Buttons will flash.

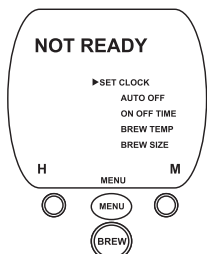

- Press or hold the 'LEFT' Button under the flashing H until you have reached the appropriate hour. If the hour has passed 12, the indicator switches from AM to PM.
- Press or hold the 'RIGHT' Button under the flashing M to set the minutes.
- When you have reached the correct time, press the menu Button six times to scroll through the remaining programming options and exit the programming mode.
- The correct time should now be displayed on the LCD Control Center.

NOTE: If power is interrupted to the Brewer follow the procedure above to reset the time as the clock will not be visible until the time is set. Brew size and brew temperature menu settings are remembered and restored automatically. All other settings will be restored automatically after clock is set.

Programing On/Off Features

The Brewer provides three modes so that you can enjoy gourmet coffee, tea or hot cocoa on your own schedule. By programming your Brewer to turn on each morning, you will never have to wait for the Brewer to warm up. It will take the Brewer approximately 3 1/2 minutes to warm up from room temperate.

1. Leave Brewer ON All the Time (recommended).

The Brewer can be left on all the time so that it is always ready to brew a fresh cup of gourmet coffee, tea or hot cocoa. To turn the Brewer off at any time, simply press and release the Power Switch. (Note: Although the clock remains on, if set, you can not brew a cup of coffee, tea or hot cocoa). Press and release the Power Button again to restore power to the Brewer. You will have to wait for the water to heat up before the Brewer is ready to brew.

2. Set the Brewer to Turn Off at a Specified Period of Time After the Last Brew.

- Press the MENU Button twice to program the AUTO OFF feature. The LCD Control Center will now display the programming options with a small arrow next to 'SET AUTO OFF'.

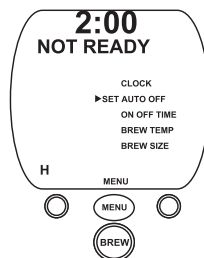

- Press or hold the 'LEFT' Button under the flashing H to advance 1 hour at a time, up to 9 hours.

- c. After setting the desired AUTO-OFF time, press the MENU Button five times to scroll through the remaining programming options and exit the programming mode. 'AUTO OFF SET' will now be displayed to indicate that it has been set.

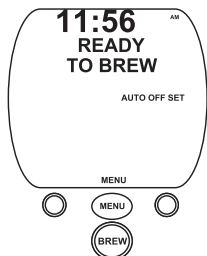

- d. To cancel the AUTO-OFF feature, press the MENU Button twice to reach the AUTO-OFF programming mode. Press and release the Button under the flashing H to advance one hour at a time until 'OFF' is displayed. Press menu 5 times to exit programming.

3. Program Your Brewer to Turn ON and/or OFF at a Specific Time.

NOTE: To use this programming feature, the clock must be set to the correct time. The clock will not be displayed unless the time is set.

EXAMPLE: If you chose to set the On Time at 6:15 AM and the Off Time for 10:00 PM, then the Brewer will be 'ON' and maintain hot water in the tank during that time so that it is always ready for you to brew. If you wanted to brew outside this window, simply press and release the Power Button and you can brew as soon as the water is heated and the 'READY TO BREW' indicator is displayed on the LCD Control Center.

- a. After setting the correct time (required), press the Menu Button three times to program the Auto On time feature. The LCD Control Center will show the programming options with a small arrow next to 'SET ON TIME'.

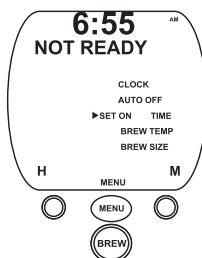

- b. Press or hold the 'LEFT' Button under the H to scroll through the hours to your desired ON time hour.
- c. Press or hold the 'RIGHT' Button under the M to scroll through the minutes to your desired ON time minutes.
- d. After setting the desired time, press the Menu Button to save the On Time and move to the 'SET OFF TIME'.

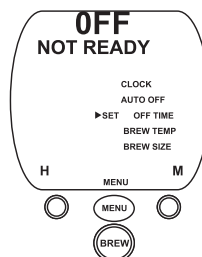

- e. If you want to set an OFF time, repeat the procedure above in steps b & c to set your desired OFF time.
- f. To complete the process, press the Menu Button three more times to exit the programming mode. The Control Center will now indicate the options you have set.

NOTE: The AUTO ON time and AUTO OFF time functions operate independently from one another. To cancel either function, follow the steps above and use the H and M Buttons to advance to 12:00 AM. When you reach 12:00 AM, the Control Center will display 'OFF' and the function will be disabled.

NOTE: The AUTO OFF Timer and the AUTO ON/OFF Time programming options operate independently, but can also be programmed to work together. For example, you can set the AUTO ON Time function to turn on at 7:00 AM and then set the AUTO OFF Timer function to turn off the Brewer two hours after the last brew.

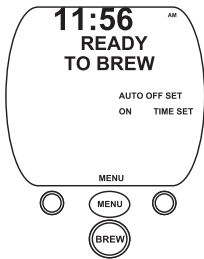

4. Programming Brew Temperature (187° - 192° F)

The Brewer brews coffee at a preset temperature of 192°. You can adjust this temperature down by 5° if you prefer a cooler cup of coffee, tea or hot cocoa. Simply follow the instructions below.

- Press the Menu Button on the LCD Control Center five times to program the Brew Temperature feature.
- The LCD Control Center will now display the programming options with a small arrow next to 'SET BREW TEMP'. Also, the temperature 192° (initial setting) will be displayed at the top of the LCD Control Center to indicate the current temperature setting.
- A minus sign will appear over the 'LEFT' Button and/or a plus sign over the 'RIGHT' Button. Use these Buttons to raise or lower the temperature one degree at a time.

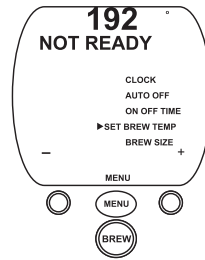

- Once you have reached your desired brew temperature, press the MENU Button twice to exit the programming mode. 'BREW TEMP SET' will be displayed in the LCD Control Center if you have changed it from 192°.
- To change the brew temperature again, repeat steps a through c to change the temperature up and/or down, remembering that the temperature can only be between 187° and 192°.

NOTE: At high altitudes (over 5,000 feet) if boiling occurs use the temperature adjustment (+0 and -5 degrees) to lower the temperature.

5. Programming Your Brew Size

The Brewer is preset with the small mug (7.25 oz.) as the default brew size. The default brew size allows the user to avoid scrolling through brew sizes if a particular size is chosen most often.

To change the default brew size to your desired brew size:

- Press 'MENU' six times.
- Using 'LEFT' and 'RIGHT' Buttons, select your desired default brew size.
- Once the desired default brew size is selected press 'MENU' once to exit. The LCD will display the brew size set.

SECTION 3

CLEANING & MAINTENANCE

Cleaning External Parts

Regular cleaning of the Brewer's external components is recommended.

1. Never immerse the base unit in water or other liquids. The Housing and other external components may be cleaned with a soapy, damp, non-abrasive cloth.
2. The Drip Tray can accumulate up to 12 ounces of overflow. The Drip Tray and Drip Tray Plate should be periodically inspected and rinsed clean. To remove the Drip Tray Assembly, simply slide it toward you, keeping it level at all times to avoid spilling. The Drip Tray and Drip Tray Plate are dishwasher safe.

Cleaning the K-Cup® Portion Pack Holder Assembly

1. Cleaning the Parts

The K-Cup Holder Assembly is dishwasher safe. To remove from the Brewer, open the cover by lifting the Handle. Grasp the top of the K-Cup Holder with one hand while pushing up on the bottom of the K-Cup Holder from underneath with the other until it releases. After cleaning, align the K-Cup Holder with the opening using the two front ribs as a guide and snap into place from the top.

K-Cup Holder Assembly

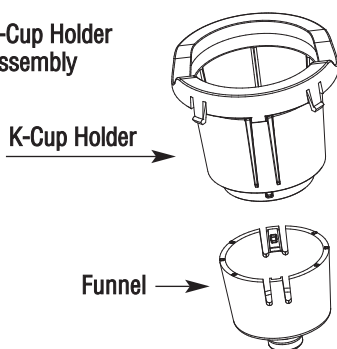

2. Cleaning the Funnel

The Funnel can be removed from the K-Cup Holder by pulling on it until it snaps off. The Funnel is dishwasher safe. To replace it just snap it back onto the K-Cup Holder Assembly.

3. Cleaning the Exit Needle

The Exit Needle is located on the inside bottom of the K-Cup Holder Assembly. Should a clog arise due to coffee grinds, it can be cleaned using a paper clip or similar tool. Remove K-Cup Holder, insert the paper clip into the Needle to loosen the clog and push it out. The K-Cup Holder is dishwasher safe.

CAUTION: There are sharp needles that puncture the K-Cup above the K-Cup Holder and in the bottom of the K-Cup Holder. To avoid risk of injury, do not put your fingers in the K-Cup Chamber.

Cleaning the Water Reservoir and Water Reservoir Lid

The Water Reservoir Lid should be cleaned with a damp soapy non-abrasive cloth. Lid should **not** be put into the dishwasher.

The Water Reservoir can be placed into the dishwasher for cleaning or can be cleaned with soapy water and rinsed thoroughly.

Do not dry the inside of the Water Reservoir with a cloth as lint may remain.

CAUTION: Please rinse the Water Reservoir thoroughly after cleaning to ensure that no cleaners or cleaning solutions remain in this area as they may contaminate the water supply in the Brewer.

De-Scaling Your Brewer

Mineral content in water varies from place to place. Depending on the mineral content of the water in your area, calcium deposits or scale may build up in your Brewer. Scale is non-toxic, but left unattended, it can hinder Brewer performance. De-scaling your Brewer helps maintain the heating element, and other internal parts of the Brewer that come in contact with water.

The Brewer should be de-scaled every 3-6 months to ensure optimal performance. It is possible for calcium deposits to build up faster, making it necessary to de-scale more often.

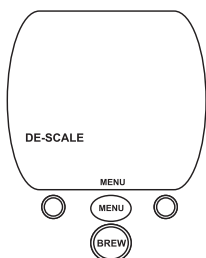

This Brewer is equipped with sensors to detect when scale buildup is interfering with the performance of the Brewer. When this is detected, 'DE-SCALE' will be displayed on the LCD Control Center.

You should promptly de-scale if 'DE-SCALE' is displayed on the LCD Control Center. Properly follow the de-scaling procedure described.

NOTE: The Brewer will continue to function even when 'DE-SCALE' is displayed.

However, if you do not de-scale soon after it is displayed, continued scale build-up could damage the Brewer. If this occurs, 'DE-SCALE' will begin to flash to alert you to the potential damage to the Brewer if you do not de-scale immediately.

De-Scaling Instructions

a. PREPARE

Step 1: Make sure you have at least 60 oz. of undiluted white vinegar on hand. You will also need an empty sink and a ceramic cup (do not use a paper cup.)

Step 2: Empty the Water Reservoir.

b. FILL and CLEAN

Step 1: Pour the vinegar into the Water Reservoir and fill it to the line just below the top edge of the clear viewing area.

Step 2: Place a 12 oz. or larger ceramic cup in the Drip Tray and run a brew cycle.

DO NOT USE A K-CUP® portion pack.

Select the Travel Mug (large) size and press 'BREW'. Pour the contents of the cup into the sink.

Step 3: Repeat the brew process until the Water Reservoir is empty, pouring the contents of the cup into the sink after each cycle. Remember to open and close the lid between each cycle so the Button lights will flash.

Step 4: Now let the Brewer stand for at least 4 hours while still on.

Step 5: Rinse the Water Reservoir thoroughly and fill with fresh water.

c. RINSE

Step 1: Ensure the Water Reservoir is filled with fresh water.

Step 2: Place a ceramic cup on the Drip Tray and run a travel mug brew cycle. Pour the contents of the cup into the sink.

Step 3: Repeat brew process until the Water Reservoir is empty.

Step 4: You may need to perform additional rinse cycles if you notice any residual taste.

NOTE: If 'DE-SCALE' is still displayed on the LCD Control Center after completing the procedure, repeat the de-scaling procedure above.

Storage

Empty the Water Reservoir before storing and take care to ensure that you store your Brewer in a safe and **frost free** environment. Please be sure to store your Brewer in its upright position to avoid water leakage from the inner tank. If you store the Brewer in a cold environment, you run the risk of water freezing inside the Brewer and causing damage. When you prepare to use it after storage, we recommend rinsing the Water Reservoir with fresh water and running three cleansing brews without a K-Cup.

If you plan to move your Brewer to a different location, turn the Brewer off, unplug it and empty the Water Reservoir. If your Brewer has been in an environment below freezing, please be sure to let it warm to room temperature for at least 2 hours before using.

SECTION 4

TROUBLESHOOTING

SITUATION

SOLUTION

Brewer does not have power

- Plug Brewer into an independent outlet.
- Check to be sure that it is plugged in securely.
- Plug into a different outlet.
- Reset circuit breaker if necessary.
- Make sure that the Power Switch has been turned on and LCD lights are illuminated.

Brewer will not brew when used for the first time

- The Brewer must be primed for use by filling the internal hot water tank before the first brew. 'PRIME' will be displayed on the LCD Control Center (refer to page 6).
- If Brewer is cold/frozen, wait for at least two hours for it to reach room temperature.

Brewer will not brew

- After placing the K-Cup® portion pack in the K-Cup Holder, make sure the Handle is pushed down securely and the LCD Control Center reads 'READY TO BREW' with the 'LEFT', 'RIGHT' and 'BREW' Buttons flashing, then press the 'LEFT', 'RIGHT' or 'BREW' Button.
- If the LCD Control Center indicates 'ADD WATER', add water to the Water Reservoir or make sure the Water Reservoir is seated properly in its base.
- If the LCD Control Center indicates 'ADD WATER' even after refilling, contact Customer Service at 1-866-901-BREW (2739).
- The Exit Needle may be clogged (refer to page 12).

Brewing a partial cup

- The Exit Needle may be clogged. (refer to page 12).
- Clean K-Cup Holder if necessary and rinse under faucet. (refer to page 12).
- The Water Reservoir may have been removed during brewing. Replace the Water Reservoir and perform a cleansing brew without a K-Cup.
- If the LCD Control Center indicates 'DE-SCALE', descale the Brewer (refer to page 13).
- If you have repeated the descale procedure on your Brewer two times and the message is still displayed, contact Customer Service at 1-866-901-BREW (2739).

The time is not displayed on the LCD Message Center

- The time will not be displayed on the LCD unless you have set it. To set the clock, follow the procedure on Page 9.
- If power is interrupted to the Brewer, you will need to set the clock again using the procedure on page 9.

My Brewer shuts off or turns on automatically

- Check to make sure that the Auto Off Timer and/or On/Off Time features have not been set. To do this, press the Button below 'MENU' and scroll through the programming options. 'OFF' should be displayed for Auto Off Timer and On/Off. If 'OFF' is not displayed, follow directions on pages 9 & 10 to reset.

The blue light in Water Reservoir is flashing

- The water level is low and a full cup cannot be brewed. Add water to Water Reservoir.

If any problems persist, contact Customer Service at 1-866-901-BREW (2739).

SECTION 5

WARRANTY

Limited One Year Warranty

Keurig warrants that your Brewer will be free of defects in materials or workmanship under **normal home use** for one year from the date of purchase. It is recommended that you fill out and return the warranty card enclosed with your Brewer so that your purchase information will be stored in our system. Keurig will, at its option, repair or replace the Brewer without charge upon its receipt of proof of the date of purchase. If a replacement Brewer is necessary to service this warranty, the replacement Brewer may be new or reconditioned. If a replacement Brewer is sent, a new limited one year warranty will be applied to the replacement Brewer.

This warranty only applies to Brewers operated in the United States and Canada. This warranty gives you specific legal rights, and you may also have other rights that vary from state to state and, in the case of Canada, from Province to Province.

What is not covered by the Limited Warranty?

THIS WARRANTY DOES NOT COVER CONSEQUENTIAL OR INCIDENTAL DAMAGES SUCH AS PROPERTY DAMAGE AND DOES NOT COVER INCIDENTAL COSTS AND EXPENSES RESULTING FROM ANY BREACH OF THIS WARRANTY, EVEN IF FORESEEABLE. Some states or Provinces do not allow the exclusion or limitations of incidental or consequential damages, so the above limitation or exclusion may not apply to you depending on the state or Province of purchase.

Nor does this warranty cover damages caused by services performed by anyone other than Keurig or its authorized service providers, use of parts other than genuine Keurig parts, or external causes such as abuse, misuse, inappropriate power supply or acts of God.

Other Limitations

THIS WARRANTY IS EXCLUSIVE AND IS IN LIEU OF ANY OTHER EXPRESS WARRANTY, WHETHER WRITTEN OR ORAL. IN ADDITION, KEURIG HEREBY SPECIFICALLY DISCLAIMS ALL OTHER WARRANTIES WITH RESPECT TO THE B70 BREWER, INCLUDING ANY IMPLIED WARRANTY OF MERCHANTABILITY OR FITNESS FOR ANY PARTICULAR PURPOSE. Some states or Provinces do not allow disclaimers of such implied warranties or limitations on how long an implied warranty lasts, so the above limitation may not apply to you depending on the state or the Province of purchase.

How do you obtain warranty service?

Keurig Brewers are high quality appliances and, with proper care, are intended to provide years of satisfying performance. However, should the need arise for warranty servicing, simply call Keurig Customer Service at our toll free phone number 1-866-901-BREW (2739). Please do not return your Brewer for servicing without first speaking to Keurig Customer Service to obtain an Authorization to Return number (ATR). Keurig Brewers returned without an ATR number will be returned to the sender without servicing.

Keurig, Incorporated
55 Walkers Brook Drive
Reading, MA 01867
1-866-901-BREW (2739)



**TO CONTACT CUSTOMER SERVICE:
POUR JOINDRE LE SERVICE
À LA CLIENTÈLE :**
www.keurig.com
or/ou
1-866-901-BREW (2739)

Made in China

Keurig, Keurig Brewed, Brewing Excellence One Cup at a Time, and K-Cup are trademarks or registered trademarks of Keurig, Incorporated.

All other trademarks used herein are the property of their respective owners.

Fabriqu  en Chine.

Keurig, Keurig Brewed, sont des marques de commerce ou des marques d pos es de Keurig, Incorporated.

Toutes les autres marques de commerce utilis es dans le pr sent guide sont la propri t  de leur propri taires respectifs.

  2008 Keurig, Incorporated

All rights reserved. Tous droits r serv s.



For Household Use Only
Pour usage domestique seulement.

Covered by U.S. Patent Numbers D544,299;
7,165,488; 7,347,138; 7,398,726; 7,377,162; 7,360,418
and other U.S. and foreign patents pending
Prot g  par les brevets Num ros D544,299;
7,165,488; 7,347,138; 7,398,726; 7,377,162; 7,360,418
et autres brevets des  tats-Unis et  trangers en instance

  KEURIG, INCORPORATED

Part #: 60-200726-000
Revision H, August 2008
N  de pi ce : 60-200726-000
R vision H, Ao t 2008