

PETCO®

Auto Feeder
SKU # 1313061

Thank you for your purchase. For questions & inquiries, please contact our customer relations line at 1-888-824-7257. For online orders, contact us at 1-877-738-6742 or visit us at www.petco.com.



DISTRIBUTED BY:
INTERNATIONAL PET SUPPLIES
AND DISTRIBUTION, INC.
SAN DIEGO, CA 92121

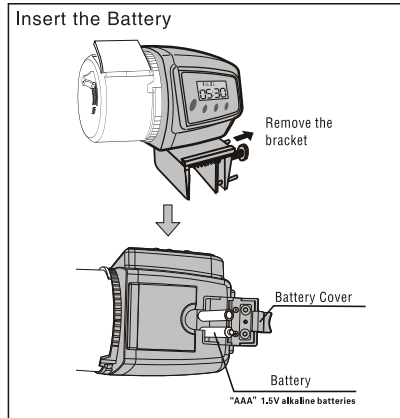
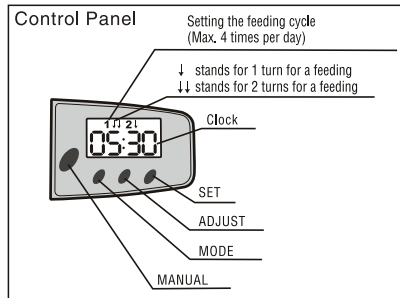
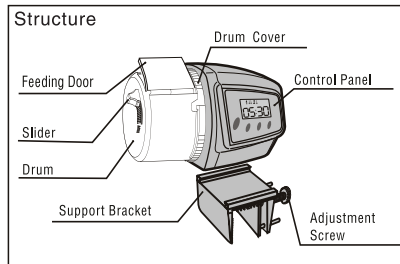

Fill With Food

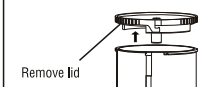
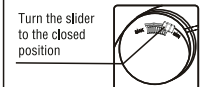

FEATURES

- For everyday use or vacation feeding
- Easy to fill, large capacity food drum
- Programmable for up to 4 feedings per day
- For use with flake or granule food

INSTRUCTIONS

Battery Installation

Remove the battery cover and insert two "AAA" (1.5V alkaline batteries) inside the casing and reattach the cover by applying pressure to the top and bottom clips.

Attention:

Install batteries with proper polarity (+/-). Do not mix old and new batteries. Do not mix alkaline, heavy duty (zinc chloride), standard (carbon zinc), or rechargeable batteries. Do not dispose of batteries in fire as they may explode.

If the LCD displays "Lo", change the battery immediately. If the batteries are not changed within 3 days, all the set programs will be invalid to avoid the feeding port stops at the improper position.

Clock Setting

1. Press the "SET" button and the "HOUR" will flash; Press "ADJUST" to set the "HOUR".
2. To set the "MINUTES", press "MODE", the "MINUTES" will flash; Press "ADJUST" to set the "MINUTES".
3. Once the correct time is displayed, press "SET" to store the current time.

Setting feeding times and rotations

This digital feeder is capable of programming up to four feeding times per day with a maximum of two turns per feeding session. All of these functions can be adjusted independently.

1. Press "MODE" and "00:00" is displayed on the LCD.
2. Press "SET" and the "HOUR" will blink, adjust the "HOUR" using the "ADJUST" button. Once the correct feeding hour is displayed, press "MODE" to set the "MINUTES".
3. Press "ADJUST" to adjust the "MINUTES".
4. Press "MODE" again and the digit "1" blinks in the top portion of the display. This function indicates the first feeding cycle of the day. Press "ADJUST" to display a single arrow pointing downward. Press "ADJUST" once for a single rotation, or twice for two rotations. The number of arrows will show how many rotations are programmed. The rotations are dispensed at a one minute interval.
5. Press "SET" to store the feeding time.

- Repeat procedures 1 through 4 to set the next feeding time and rotation. Press "MODE" to cycle through all four feeding times to return to the current set time.
- Up to four feeding times can be set each day. You may adjust the feeding times after they have been stored by selecting the "SET" button on any of the four feeding sessions.
- If the LCD display is malfunctioning, remove the batteries for one minute to reset the display.

Resetting the feeding time

1. To delete the previous programming, press "MODE" until the screen displays the program you want to delete; Press "SET" to select, then press "MODE" twice, the sequence number will flash; Press "ADJUST" until the arrow disappears, then press "SET" to store.
2. To reset the previous programming, press "MODE" until the screen displays the program you want to reset; Repeat procedures 1 through 4.

Manual Operation

To feed the aquarium in between sessions you may press the manual button. The feeder will make one rotation each time the manual button is pressed. Do not physically turn the container.

Filling the Feeding Drum

Adjust the slider to the closed position. Remove the drum from the feeder by gently pulling it away from the feeder. Fill the drum with the desired amount of food and attach it to the feeder by matching up the two flat edges.

Portion Adjustment

By adjusting the slider, you may increase or decrease the amount of food dispensed per rotation.

Positioning the Feeder onto your Tank

For open tanks:

1. Slide the feeder onto BRACKET 1 by aligning the raised edge located along the bottom of the feeder with the bracket slot and sliding the feeder into the slot until it stops.
2. Attach BRACKET 1 to your tank by sliding it down over the edge of your tank and tightening the adjustment screw until the bracket is firmly attached to tank edge. Once complete, make sure the feeding drum is directly over the water.

Tips:

In case that the feeding door touches the water when the feeder is rotating, use BRACKET 2 to raise the height of the feeder by connecting it with BRACKET 1 in the same way that BRACKET 1 is connected with the feeder. Refer to the picture in the next page.

BRACKET

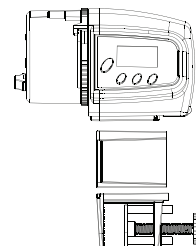
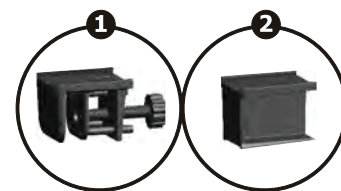

For tanks with a hood:

1. Slide the feeder onto BRACKET 2 by aligning the raised edge located along the bottom of the feeder with the bracket slot, sliding the feeder into the slot until it stops.
2. Separate the two pieces of Velcro tape; Peel off the protection paper; Stick one piece on the proper place close to the opening on the cover, and another piece on the bracket.
3. Stick the two pieces to attach the connected feeder and the bracket with the piece on the tank cover.

Once complete, make sure the sticking is firm and the feeding drum is directly over the water.

DO NOT DROP THE FEEDER IN THE TANK! WATER DAMAGE voids the WARRANTY AND CAUSES THE ELECTRONIC COMPONENTS TO MALFUNCTION.

Cleaning

Do not use any soaps or detergents. Remove the feeding drum and thoroughly clean and rinse with warm water. Make sure drum is completely dry before adding food.