

FCC Information

This device complies with Part 15 of the FCC Rules. Operation is subject to the following two conditions: (1) This device may not cause harmful interference, and (2) this device must accept any interference received, including interference that may cause undesired operation. In accordance with FCC requirements, changes or modifications not expressly approved by Thomson Inc. could void the user's authority to operate this product. This device generates and uses radio frequency (RF) energy, and if not installed and used properly, this equipment may cause interference to radio and television reception. If this equipment does cause interference to radio or television reception (which you can determine by unplugging the unit), try to correct the interference by one or more of the following measures:

- Re-orient the receiving antenna (that is, the antenna for the radio or television that is "receiving" the interference).
Move the unit away from the equipment that is receiving interference.
Plug the unit into a different wall outlet so that the unit and the equipment receiving interference are on different branch circuits.
If these measures do not eliminate the interference, please consult your dealer or an experienced radio/television technician for additional suggestions.

Also, the Federal Communications Commission has prepared a helpful booklet, "How To Identify and Resolve Radio TV Interference Problems." This booklet is available from the U.S. Government Printing Office, Washington, DC 20402. Please specify stock number 004-000-00345-4 when ordering copies. This product complies with DHHS Rules 21 CFR Subchapter J. Applicable at the date of manufacture.



SEE MARKING ON BOTTOM / BACK OF PRODUCT
WARNING: TO PREVENT FIRE OR ELECTRICAL SHOCK HAZARD, DO NOT EXPOSE THIS PRODUCT TO RAIN OR MOISTURE.

Getting Started

Unpacking the Receiver

- You should receive the following items:
One receiver unit
One pair of "AAA" batteries
One pig-tail antenna wire
One external AM loop antenna
One instruction book;
One safety leaflet
One Quick Connection Guide
One Remote Control

Unpacking The Speakers

- One set of speakers including:
1 set of left and right front speakers,
1 centre speaker,
1 subwoofer and
1 set of left and right rear speakers
6 speaker wires including:
1 X green/grey striped wire for centre speaker
1 X red/grey striped wire for front right speaker
1 X white/grey striped wire for front left speaker
1 X purple/grey striped wire for subwoofer
1 X blue/grey striped wire for rear left speaker
1 X gray/grey striped wire for rear right speaker

Inserting Batteries into Remote Control

Insert two "AAA" (R03) batteries according to the + and - signs in the battery compartment. To use the remote control, point it directly at your receiver.

- Install batteries as follows:
1. Remove battery compartment door by applying thumb pressure on battery door and then lift the door out and off the cabinet.
2. Insert 2 AAA batteries in the compartment and replace the compartment door.

Connecting to Audio Components

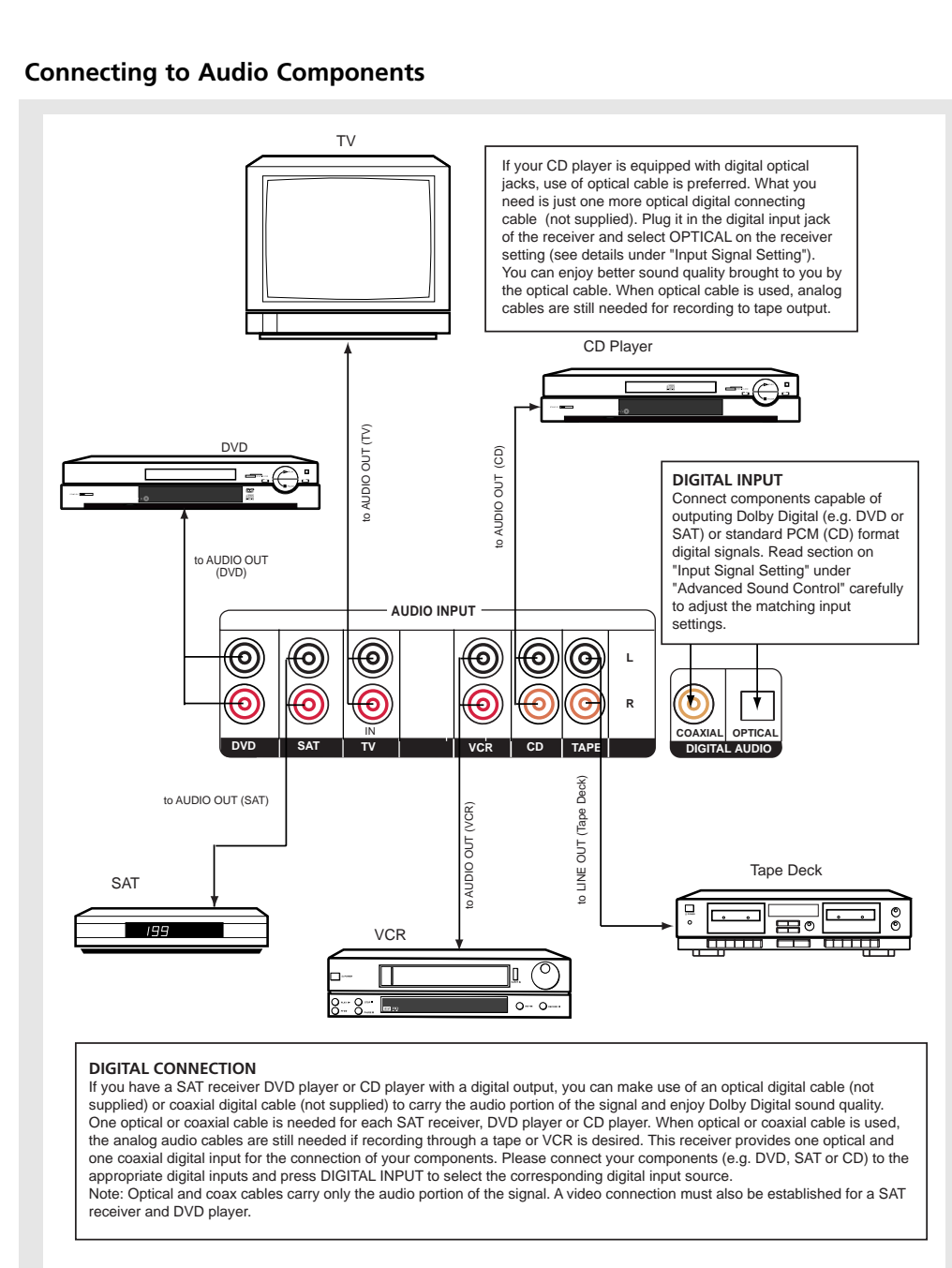

DIGITAL CONNECTION
If you have a SAT receiver DVD player or CD player with a digital output, you can make use of an optical digital cable (not supplied) or coaxial digital cable (not supplied) to carry the audio portion of the signal and enjoy Dolby Digital sound quality.

Getting Started

Digital Connections

Read instructions carefully when connecting components to the receiver. Digital In Jacks can accept Dolby Digital (AC-3) or PCM signals when compatible components are connected.

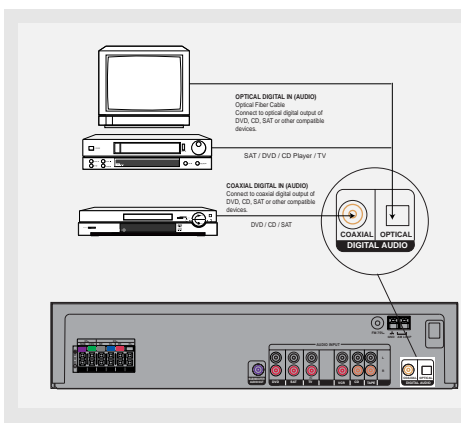

TV Connections

TVs with RF input may need a RF modulator (not included) for inputting audio signals.

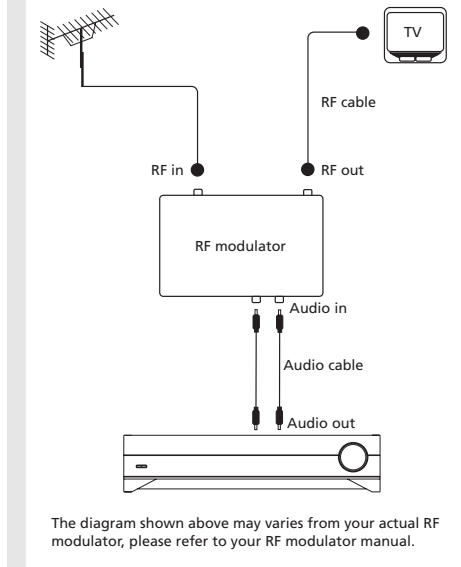

Once headphones are connected, "HEADPHONE DOWN MIX 2 CHANNEL" will scroll on display. This feature automatically converts multi-channel speaker outputs to 2 channel stereo for your listening pleasure.

Connecting the Antennas

The AM and FM antennas connect to the AM and FM terminals on the system's back panel.

They must be hooked up in order to receive clear reception.

AM Loop Antenna and FM Indoor Antenna

- 1. Uncoil the Antenna wire and locate the base end of the AM antenna.
2. Press down on the Antenna tab to the terminal.
3. Insert the antenna wires into the terminal and release the tabs to secure the wires in place.

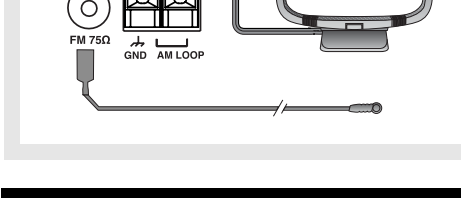

- Do not connect to the AC power cords until all connections are completed.
Do not use your set immediately after transferring it from a cold place to a warm place: there is risk of condensation.
Do not expose your set to water and excessively high temperatures.
After having disconnected your set, clean the case with a soft cloth, or with a slightly damp leather chamois. Never use strong solvents.

HINT

- For FM reception, extend antenna to its full length.
For AM reception, rotate the antenna horizontally to get better reception.

Operating Your Receiver

Receiver Controls

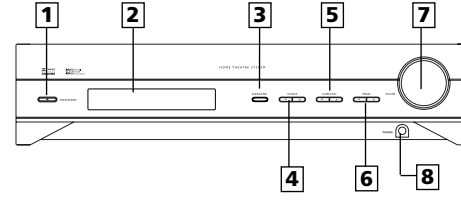

- 1. ON/STANDBY: Turns the unit on and off.
2. Display: Displays current status of the receiver.
3. SUBWOOFER: Selects among subwoofer sound level.
4. SOURCE Buttons: Selects sound source.
5. SURROUND Buttons: Selects digital sound processor.
6. PRESET Buttons: Selects preset station in Tuner mode.
7. VOLUME: Increases and decreases volume level.
8. PHONES: Plug your headphones (not supplied) into it for your private enjoyment.

NOTE

The system is equipped with Dolby Digital, and manufactured under license from Dolby Laboratories.

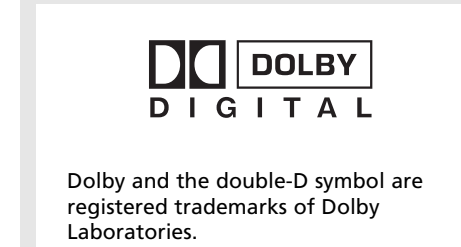

Dolby and the double-D symbol are registered trademarks of Dolby Laboratories.

Connecting for Power

Make sure you connect all your other electronic components and the speakers before plugging your receiver into the outlet. Plug the power cord in the wall outlet, matching the wide blade of the plug with the wide slot in the outlet.

Using Headphones

To listen privately through your audio system, use the PHONES jack on the receiver. However, make sure you turn down the volume before you put on the headphones. Increase the volume to the desired level after headphones are in place.

Once headphones are connected, "HEADPHONE DOWN MIX 2 CHANNEL" will scroll on display. This feature automatically converts multi-channel speaker outputs to 2 channel stereo for your listening pleasure.

Hearing Comfort & Well-Being

- Do not play your headset at a high volume.
Hearing experts advise against continuous extended play.
If you experience a ringing in your ears, reduce volume or discontinue use.

Factory Setting

The unit is preset to the following settings when you first power the receiver up right out of the box. Function = TUNER, Volume setting = 25, Bass & treble = 0 dB, EQ - FLAT, Speaker setting = Center, surr = YES, Subwoofer = STRONG, DRC = OFF.

NOTE

STRONG SUBWOOFER setting makes the output level of subwoofer speaker to be stronger than normal Dolby setting. Adjust the SUBWOOFER setting by pressing the SUBWOOFER key to achieve the best bass performance.

Reset to Factory Settings

All preset radio stations and surround sound setting will be lost after factory setting is restored.

WARNING

All preset radio stations will be lost after factory setting is restored.

You may restore factory setting with the following procedures: 1. Enter SAT mode. 2. Press PRESET UP, PRESET DOWN, SOURCE UP to reset the unit.

Remote Control

Please be sure you have inserted the batteries into the remote control. You can test it by pressing any button.

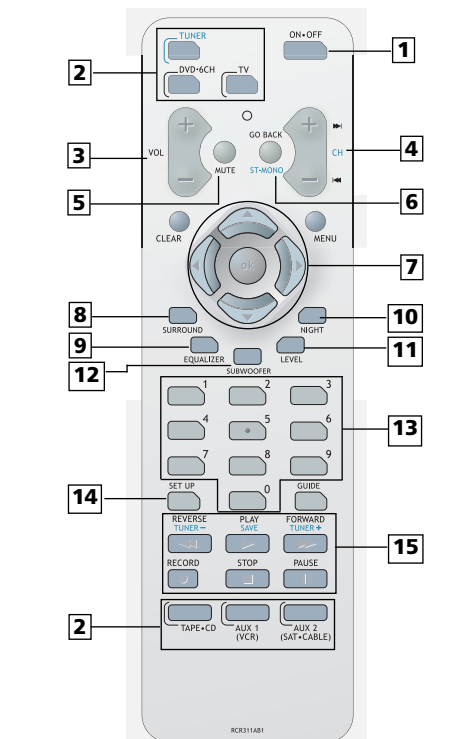

- 1. ON/OFF: Turns the receiver and other auxiliary components on and off.
2. Source Buttons: Selects various audio sources.
3. VOL + / VOL - (Volume Buttons): Adjusts the volume level.
4. CH+ / CH- (Channel Buttons): Selects programmed stations in TUNER mode.
5. MUTE: Mutes all audio output.
6. GO BACK / ST-MONO: Selects between Stereo and Mono sound in Tuner mode.

NOTE

The remote control button CLEAR, MENU and GUIDE do not function for this receiver but can be used to control other RCA and Thomson products.

Display



DVD / VCR / SAT / TUNER / TAPE / CD / TV
An arrow points to the current source mode.

Digital
Dolby Digital audio input for signal format.

Pro Logic II
Dolby Pro Logic II audio output format.

FM / AM
Radio band indicator in Tuner mode.

ST
Tuner stereo signal detected.

OPT12
Optical digital input detected.

COAX
Coaxial digital input detected.

Adjustment Buttons

- Press the Left or Right buttons to select among setting items in setup mode: SLEEP, DIMMER, SPEAKER DISTANCE, SPEAKER SETUP, and audio input source (ANALOG, OPTICAL / COAXIAL).
Press the Up or Down buttons to adjust the values when the display shows the setup you want to change.

SURROUND

Selects among surround sound settings: DOLBY PL II EMULATION, DOLBY PL II MUSIC, DOLBY PL II MOVIE, STEREO, DISCO, STADIUM, THEATER, JAZZ CLUB, ARENA, 3 STEREO.

EQUALIZER

Selects among preset equalizer modes. (only available in stereo mode)

NIGHT

Selects among Night mode options (DRC OFF, SOFT and ON) which compresses the volume difference between normal voices and sounds such as explosions. (Available only during Dolby digital signal playback)

LEVEL

Speaker LEVEL setting and Test tone. Refer to "Advanced Sound Control" for details.

SUBWOOFER

Selects among subwoofer output level (SOFT SUBWOOFER, BALANCED SUBWOOFER, STRONG SUBWOOFER, POWERFUL SUBWOOFER).

Number Buttons

Directly access a preset station in Tuner mode.

SETUP

Enter Setup mode. Use the Left and Right adjustment buttons to select among setup options. (SLEEP, DIMMER, FRONT SPK DISTANCE, CENTER SPK DISTANCE, SURROUND SPK DISTANCE, CENTER SPK ON/OFF, SURROUND SPK ON/OFF, DIGITAL INPUT).

Operation Buttons

- TUNER mode: Press the TUNER - and TUNER + keys to tune down or up the radio frequency.
Press SAVE to activate the preset station saving and press to confirm preset station settings.
PLAY, RECORD, STOP and PAUSE keys are only for easy control of external devices that are connected to your receiver such as CD, VCR, DVD, TAPE, etc. The remote control currently operates most Thomson, RCA and GE products.

NOTE

The remote control button CLEAR, MENU and GUIDE do not function for this receiver but can be used to control other RCA and Thomson products.

Display

DVD / VCR / SAT / TUNER / TAPE / CD / TV
An arrow points to the current source mode.

Digital
Dolby Digital audio input for signal format.

Pro Logic II
Dolby Pro Logic II audio output format.

FM / AM
Radio band indicator in Tuner mode.

ST
Tuner stereo signal detected.

OPT12
Optical digital input detected.

COAX
Coaxial digital input detected.



user manual

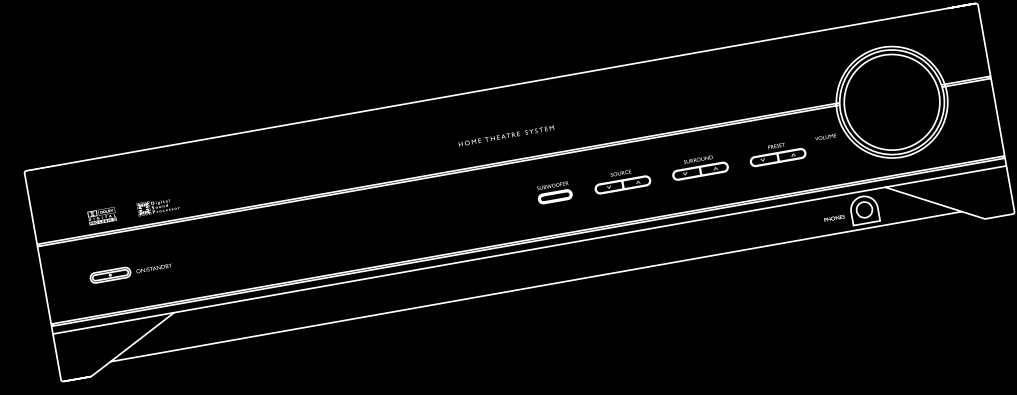

RT2390

It is important to read this instruction book prior to using your new product for the first time. Es importante leer este manual antes de usar por vez primera su equipo.

Operating Your Receiver

7. Adjustment Buttons

- Press the Left or Right buttons to select among setting items in setup mode: SLEEP, DIMMER, SPEAKER DISTANCE, SPEAKER SETUP, and audio input source (ANALOG, OPTICAL / COAXIAL).
Press the Up or Down buttons to adjust the values when the display shows the setup you want to change.

8. SURROUND

Selects among surround sound settings: DOLBY PL II EMULATION, DOLBY PL II MUSIC, DOLBY PL II MOVIE, STEREO, DISCO, STADIUM, THEATER, JAZZ CLUB, ARENA, 3 STEREO.

9. EQUALIZER

Selects among preset equalizer modes. (only available in stereo mode)

10. NIGHT

Selects among Night mode options (DRC OFF, SOFT and ON) which compresses the volume difference between normal voices and sounds such as explosions. (Available only during Dolby digital signal playback)

11. LEVEL

Speaker LEVEL setting and Test tone. Refer to "Advanced Sound Control" for details.

12. SUBWOOFER

Selects among subwoofer output level (SOFT SUBWOOFER, BALANCED SUBWOOFER, STRONG SUBWOOFER, POWERFUL SUBWOOFER).

13. Number Buttons

Directly access a preset station in Tuner mode.

14. SETUP

Enter Setup mode. Use the Left and Right adjustment buttons to select among setup options. (SLEEP, DIMMER, FRONT SPK DISTANCE, CENTER SPK DISTANCE, SURROUND SPK DISTANCE, CENTER SPK ON/OFF, SURROUND SPK ON/OFF, DIGITAL INPUT).

15. Operation Buttons

- TUNER mode: Press the TUNER - and TUNER + keys to tune down or up the radio frequency.
Press SAVE to activate the preset station saving and press to confirm preset station settings.
PLAY, RECORD, STOP and PAUSE keys are only for easy control of external devices that are connected to your receiver such as CD, VCR, DVD, TAPE, etc. The remote control currently operates most Thomson, RCA and GE products.

NOTE

The remote control button CLEAR, MENU and GUIDE do not function for this receiver but can be used to control other RCA and Thomson products.

Display

DVD / VCR / SAT / TUNER / TAPE / CD / TV
An arrow points to the current source mode.

Digital
Dolby Digital audio input for signal format.

Operating Your Receiver

Example 1:

If you have connected a DVD player to the DVD input on the receiver, press the SOURCE buttons on the main unit repeatedly until DVD is selected or press DVD+6CH on the remote control to receive the sounds and images transmitted by the DVD.

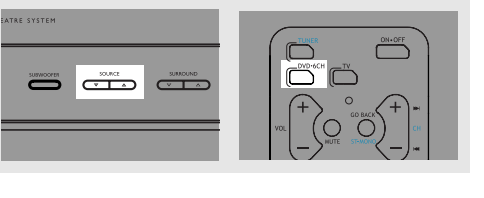

Example 2:

Based on the example 1, the DVD is playing, if a VCR is connected to the VCR input of the receiver, press the SOURCE buttons on the main unit repeatedly until VCR is selected or press AUX 1 (VCR) on the remote control. The sound from the VCR source will replace the DVD.

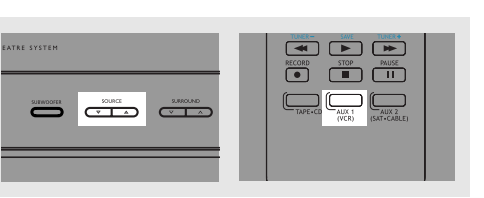

You can connect up to 6 audio sources to this amplifier:

Table with 2 columns: Source button (receiver front panel) and Corresponding connector (receiver back panel). Rows include DVD, SAT, TV, VCR, CD, and FM/AM.

On the remote control, press the ON-OFF button twice within 2 seconds if the receiver is not in Tuner source mode to enter standby mode.

To avoid entering standby mode when powering up the unit, do not press the ON-OFF button twice within 2 seconds.

- The receiver draws a small amount of electricity when in standby mode. Unplugging the unit from the wall socket will stop the draw.

Selection of source

When one of the source button is pressed, the input corresponding to the name will be activated. The receiver acts as a switching device between all the sources that are plugged into it.

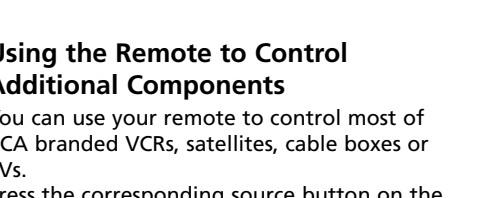

Using the Remote to Control Additional Components

You can use your remote to control most of RCA branded VCRs, satellites, cable boxes or TVs. Press the corresponding source button on the remote control to operate options on other components.

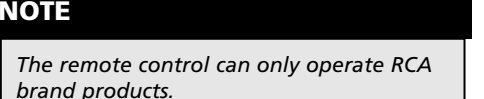

NOTE

The remote control can only operate RCA brand products.

Volume Punchthrough

Volume punchthrough can be done in all non-Tuner modes.

By default, the VOL+ / VOL- and MUTE buttons will only control the receiver, regardless which mode (TV, VCR, etc) the receiver is in. By programming the volume punchthrough function, you can also control the volume of the TV.

NOTE

Controlling the TV volume can be done in any non-Tuner modes.

NOTE

To activate the volume punchthrough function, follow the procedures below: 1. Press and hold the VOL- button. 2. While holding down the VOL- button, press one of the source buttons to select the source where you want to control TV volume at (DVD, TV, VCR or SAT+CABLE). 3. Continue holding down the VOL- button and press the TV button once. 4. Release all buttons. You should now be able to control TV volume and mute at the selected device.

HINT

To return to controlling receiver volume and mute again, follow the steps above but press TUNER instead of TV in step 3.

HINT

If batteries are removed from the battery compartment of the remote control, the volume and mute control in all source modes will be the receiver volume and mute control except in TV mode.

Using the receiver to play a source

After having properly connected a source (DVD, CD, VCR) to the receiver, you can partly control them through the receiver.

Playing a DVD with the receiver

1. Connect a DVD player to the receiver (see connecting your receiver for details).

NOTE

To play Dolby Digital sound, the source must be connected to the receiver via the optical or coaxial terminal

- 2. Press ON/STANDBY on the main unit or press ON/OFF on the remote control to switch on the receiver.
3. Press the SOURCE buttons on the main unit or DVD+6 CH on the remote control to select the DVD source.
4. Switch ON the DVD player and start playback.
5. Switch ON your TV.
6. Select the appropriate AV channel on the TV (refer to your TV manual for details) until the image from the DVD player is displayed.
7. Set the sound mode if needed (see "Advanced sound control" for details).

Example 1:

To play Dolby Prologic II Movie sound, press the SURROUND buttons until "Dolby PL II MOVIE" appears on the Display and all of the speaker's icons light up.

Example 2:

LD: You may need to select a different Audio Channel on your LD (refer to your LD player manual).
8. Adjust the volume knob accordingly.

Operating your Receiver

Operating the Radio

The receiver has a built-in tuner that allows for AM/FM radio function.

Manual tuning

1. Connect the FM and AM antenna accordingly (see "Connecting the Antenna" section for details).
2. Press **ON/STANDBY** on the main unit or **ON/OFF** on the remote control to switch on the receiver.

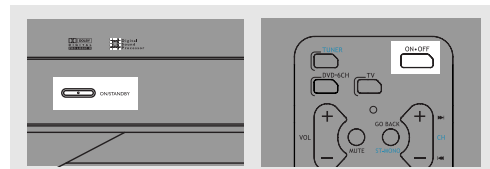

3. Press the **SOURCE** buttons on the main unit until the tuner mode is selected or press **TUNER** on the remote control.

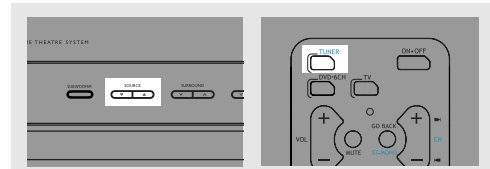

4. To select between FM and AM band, press the **TUNER** button repeatedly.

5. Tune to a station by pressing **TUNER** or **TUNER** + repeatedly until the desired station is found.

Automatic Tuning

Press and hold **TUNER** or **TUNER** + for about one second to activate the automatic SEARCH function. The receiver will automatically tune frequencies until it finds a station.

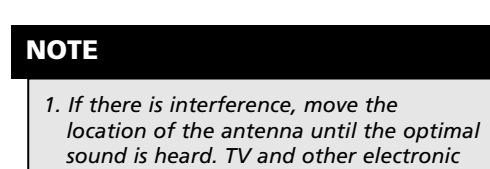

NOTE

1. If there is interference, move the location of the antenna until the optimal sound is heard. TV and other electronic devices could be the cause of interferences so try to position the antenna away from them.
2. Weak signal can affect the "auto Search function". Adjust the antenna for better reception and for a more efficient search.

Select a sound effect if needed by pressing the **SURROUND** button. (see "Advance sound section" for details).

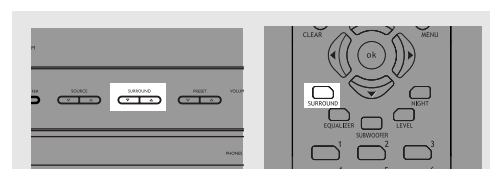

Selecting Mono or Stereo Sound

Press the **ST-MONO** button on the remote control to toggle between mono and stereo sound in FM tuner mode (when available).



Storing radio stations

The receiver can store up to 40 radio stations in memory. You can enter every single radio station yourself or the receiver can store all available radio stations automatically in an ascending order.

Automatic preset storing : (FM only)

1. In Tuner mode, select the FM band by pressing **TUNER** on the remote control.
2. Press and hold the **TUNER** button on the remote control for 3 seconds. "MEMORY" will be displayed in red and will blink during the automatic storing process.

Radio frequencies will be scanned and radio stations will be stored automatically. When all available radio stations are stored or if all 40 memory locations are full, the auto preset will stop.

NOTE

A Weak signal can affect the "Automatic Preset Storing function" efficiency. Adjust the antenna for the best reception, and a more efficient search.

Manual preset

1. Select FM or AM band by pressing **TUNER** repeatedly.
2. Tune to the radio station to be stored. (see "Manual tuning" above for details)
3. Press the **SAVE** button on the remote control. "MEMORY" will flash and a preset number will be shown on the display.
4. While MEMORY is still flashing on the display, press **CH** or **CH** on the remote control to select the desired preset memory location.
5. Press the **SAVE** button on the remote control to store frequency in selected preset location.
6. Repeat steps 1-5 to store other frequencies.

Retrieving preset stations

1. Select the **PRESET** on the remote control to store the preset location.
2. Press the **TUNER** buttons on the main unit or the **CH** or **CH** buttons on the remote control to select the preset station.

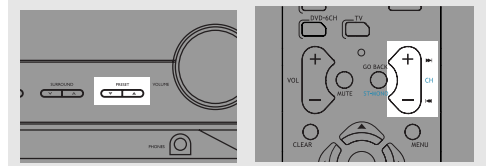

Advanced Sound Control

Dynamic Bass Amplified System (dBAS)

With "Dynamic Bass Amplified System" (dBAS), the discrete amplifier is located in the receiver so the subwoofer keeps the power needed to reproduce powerful effects. 4 settings are available: SOFT, BALANCED, STRONG and POWERFUL. Press the **SUBWOOFER** button to toggle the subwoofer (dBAS) effects level according to your needs.

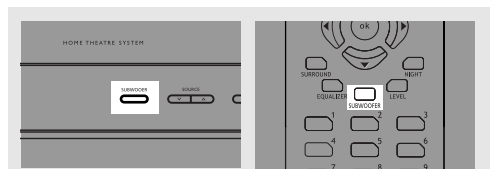

Fine Setting of the Components

The receiver can be directly turned on by pressing the **DVD+6CH / SAT+CABLE / TV / CD+TAPE / VCR / TUNER** buttons on the remote control, which also selects the best surround sound mode. The default surround modes for different components are listed in the table below. If you decide to change the surround mode, you can press the **SURROUND** button repeatedly to toggle among the different surround mode choices and select the one you want.

DOLBY PL II MUSIC => DOLBY PL EMULATION
=> 3 STEREO => ARENA => JAZZ CLUB => THEATER => STADIUM => DISCO => STEREO => DOLBY PL II MOVIE

Source/ Input	If Digital Input (optical or coaxial) is selected
DVD	Dolby Digital
SAT	Dolby Digital
VCR	N/A
TV	Dolby Digital
CD	STEREO
TAPE	N/A
TUNER	N/A

Source / Input	If Analog Input is selected
DVD	PRO LOGIC
SAT	PRO LOGIC
VCR	PRO LOGIC
TV	PRO LOGIC
CD	STEREO
TAPE	STEREO
TUNER	STEREO

The receiver will keep the last selection in memory.

NOTE

If linear PCM source (CD), format will be Dolby Prologic even with Digital Input.

Input Signal Setting

The receiver defaults to the most convenient settings for your easiest use (see table).

- If your connection is different from the default setting.
1. Select the source
 2. Press the **SETUP** button to show setup options.
 3. Press the Left or Right adjustment buttons until ANALOG is displayed.
 4. Press the Up or Down arrow buttons to select among optical/coaxial/analog to match your connection. Your selection will be stored automatically.

The selected source and input source will be displayed on the display as long as they are active, except for some temporary change of display (e.g. adjusting volume).

Digital Input

Select this setting to play digital signals from a DVD, CD, LD player, SAT or TV.

SOURCE	DEFAULT INPUT (as seen on display)
SAT	Analog (SAT/ ANL)
DVD	Analog (DVD/ ANL)
CD	Analog (CD/ ANL)
VCR	Analog (VCR/ ANL)
FM/AM	Built-in Tuner
TAPE	Analog (TAPE/ ANL)
TV	Analog (TV / ANL)

NOTE

Digital input is only available for DVD, SAT, CD and TV.

Analog Input

Select this setting to play analog signals from a cassette deck, VCR or turntable.

SOURCE	AVAILABLE INPUT
SAT	Analog / Optical / Coaxial
DVD	Analog / Optical / Coaxial
CD	Analog / Optical / Coaxial
VCR	Analog / - / -
TAPE	Analog / - / -
TV	Analog / Optical / -

Fine Setting of the Speakers

All the basic settings have already been pre-set for the speakers included in the box.

Also, to make the surround sound more effective and suit the acoustic conditions in your listening room, you may need to delay the signal coming from some of the speakers. Channel delay compensates for center or surround speakers that are closer to the listening position than the front speakers. You can make use of the **SETUP** button to adjust the speakers' relative loudness.

Testing Speaker Loudness

You can listen to the loudness of the individual speakers.

1. Press and hold **LEVEL** on the remote control. A short noise will be heard in the speakers one by one. The speaker having the noise at that moment will be shown in the display.

2. To adjust the volume level of the test tone, turn the **VOLUME** knob or press the **VOL UP** or **DOWN** buttons on the remote control to adjust the master volume (if necessary)

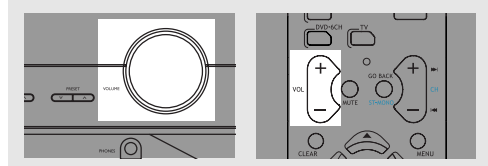

Press **LEVEL** again and press the Up or Down buttons to adjust the individual channel noise level.

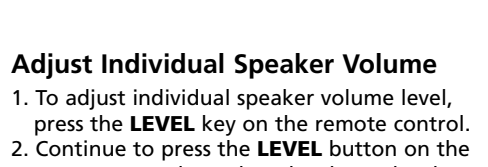

Adjust Individual Speaker Volume

1. To adjust individual speaker volume level, press the **LEVEL** key on the remote control.
2. Continue to press the **LEVEL** button on the remote control to select the channel to be adjusted, then press the Up or Down buttons to adjust the level.

You can adjust the master volume level by turning the **VOLUME** knob or press the **VOL UP** or **DOWN** buttons on the remote control.

Advanced Setting

Factory defaulted Advance setting indication from VFD

The receiver has defaulted the following distances:

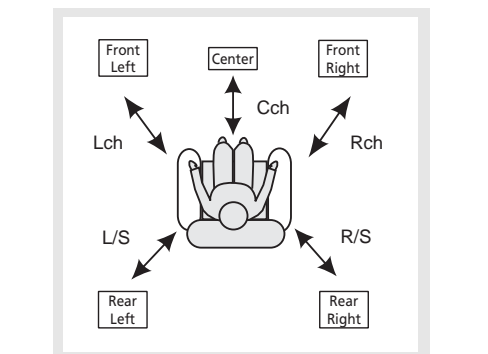

Speaker Configurations

You can also change the setup of the speakers. Use a subwoofer to enjoy optimum sound.

- Speaker distance: For optimum surround experience measure the distance between the speaker and your favorite listening position.

1. Press the **SETUP** button to show setup options.

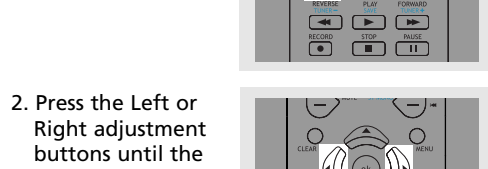

2. Press the Left or Right adjustment buttons until the speaker you want to change is displayed.
3. Press the Up or Down arrow buttons to change the speaker settings. Your selection will be stored automatically.
4. Repeat step 2 and 3 to set up the next speaker

Center Speaker selection (CTR)	YES / NO
Surround Speaker selection (Surr)	YES / NO
Front Speaker distance (FRNT)	3-30 ft
Centre Speaker distance (CNTR)	0-30 ft
Rear Speaker distance (Surr)	0-30 ft

5. When set up is done, wait for 5 seconds to automatically save your settings or press any key to save your selection and set up mode.

NOTE

By default, the Center and Surround Speakers are set to YES. If you decide not to use them, set the ones you do not intend to use to NO so the sound performance is not affected.

Displaying Program Formats

When a digital source starts playing, the receiver automatically switches to the proper surround mode and provides setting information via the speaker icons located on the right-hand side of the display.

It is important to note, however, that not all Dolby Digital sources are encoded with the full complement of five channels plus LFE*. Speaker icons show how many and which speaker you have enabled (See "Fine Setting of the Speakers") and the letters inside the speaker icons show which channel is present in the source information. For example, the diagram shown means you have all five speakers and subwoofer enabled and the digital sources you played have five channels plus LFE complemented.

* LFE stands for Low Frequency Effect. The indication "LFE" appears if the digital source contains LFE information. In this case, the bass signal will be delivered to the subwoofer, offering more dynamic deep bass sound effects. If the letter is flashing, the signal is either too weak or just gone.

Troubleshooting Tips

Receiver/Tuner Operation

ST indicator is off.

- Adjust the antenna.
- Press GO BACK/ST/MONO button to insure you are not outputting in mono.

The signal is too weak. Severe hum or noise.

- The signal is too weak. Connect an external antenna.
- Adjust Antenna
- Reposition Antenna away from any electronics.

There is interference to FM reception.

- Turn off other electrical units (e.g. DVD, CD player) near the receiver.

Remote Control Operation

The remote control does not operate the unit.

- Another source mode is selected on the remote. Press the correct Source Button.
- No batteries installed. (included with your system) install the batteries before attempting to operate the remote. Be sure to match the + and - ends of each battery to the symbols shown in the remote battery compartment.
- The batteries are weak. Replace all batteries.
- The remote is not pointed at the remote control sensor on the main unit or there is an obstacle between the remote and the main unit.
- The remote control is too far from the main unit, move closer.

Remote loses Programmed codes.

- Weak batteries, replace batteries.

Remote forgets what source was selected.

- Weak batteries, replace batteries.

General

No audio.

- Make sure the speakers are connected.
- Check the input connections.
- Check the power cord connections.
- Make sure the MUTE signal on the front panel is off.
- Make sure the digital setting (optical, coaxial or analog) is correct.
- Check that the headphone is not inserted.

No audio from one channel.

- Check the speaker level setting.
- Check the speaker wire or external source cable connections.

Noise occurs when the TV is turned on.

- The TV is too close to the audio system.

Specific instruments sound displaced.

- Check the connections between the receiver and the speakers if the sound does not match the video.
- Check if the video and audio cable are correctly inserted.

Cleaning the Exterior

Disconnect the system from AC power before cleaning the exterior of the system with a soft dust cloth, or with a slightly damp leather chamois. Never use strong solvents.

Care and Maintenance

Disconnect the audio system from the power source before performing any maintenance.

Cleaning

Clean the exterior of the system using a soft dust cloth.

Important battery information

- Remove the batteries to avoid leakage if you do not use your remote control for more than one month.
- Discard leaky batteries immediately as leaking batteries may cause skin burns or other personal injuries.
- Dispose of batteries in the proper manner, according to provincial and local regulations.
- Any battery may leak electrolyte if mixed with a different battery type, if inserted incorrectly, if all batteries are not replaced at the same time, if disposed of in fire, or if an attempt is made to charge a battery not intended to be recharged.

Safety precautions

- Never open the cabinet under any circumstances. Any repairs or internal adjustments should be made only by a trained technician.
- Never operate this product with the cabinet removed.
- Do not touch the player with wet hands. If any liquid enters the player cabinet, take the player to a trained technician for inspection.
- The apparatus shall not be exposed to dripping and splashing.
- No object filled with liquids, such as vases, shall be placed on the apparatus.
- No naked flame sources such as lighted candles shall be placed on the apparatus.

Headset safety

- Do not play your headset at a high volume. Hearing experts warn against extended high-volume play.
- If you experience a ringing in your ears, reduce volume or discontinue use.
- You should use extreme caution or temporarily discontinue use in potentially hazardous situations.
- Even if your headset is an open-air type designed to let you hear outside sounds, don't turn up the volume so high that you are unable to hear what is around you.

Don't infringe

This product should only be used for the purposes for which it is sold, that is, entertainment, violating no copyright law. Any attempts to use this product for which it is not intended is unlawful and therefore not condoned by Thomson.

Limited Warranty (U.S.)

What your warranty covers:

- Defects in materials or workmanship.

For how long after your purchase:

- One year from date of purchase for labor and parts
- The warranty period for rental units begins with the first rental or 45 days from date of shipment to the rental firm, whichever comes first.

What we will do:

- Pay any Authorized RCA Audio Service Center the labor charges to repair your unit.
- Pay any Authorized RCA Audio Service Center for the new or, at our option, refurbished replacement parts required to repair your unit.

How you get service:

- Take your unit to any Authorized RCA Audio Service Center. To identify your nearest Authorized RCA Audio Service Center, ask your dealer, look in the Yellow Pages, or call 1-800-336-1900.
- Show the Authorized Service Center Representative your evidence of purchase date or first rental.
- Pick up your unit when repairs are completed.
- Proof of purchase in the form of a bill of sale or receipted invoice which is evidence that the product is within the warranty period must be presented to obtain warranty service. For rental firms, proof of first rental is also required.

What your warranty does not cover:

- Customer instruction. (Your Owner's Manual describes how to install, adjust, and operate your unit. Any additional information should be obtained from your dealer.)
- Installation and related adjustments.
- Signal reception problems not caused by your unit.
- Damage from misuse or neglect.
- Cleaning of audio heads.
- Batteries.
- A unit that has been modified or incorporated into other products or is used for institutional or other commercial purposes.
- A unit purchased or serviced outside the U.S.A.
- Acts of nature, such as but not limited to lightning damage.

Product Registration:

- Please complete and mail the Product Registration Card packed with your product. It will make it easier to contact you should it ever be necessary. The return of the card is not required for warranty coverage.

Limited Warranty (Canada)

What your warranty covers:

- Defects in materials or workmanship.

For how long after your purchase:

- One year from date of purchase for labor and parts
- The warranty period for rental units begins with the first rental or 45 days from date of shipment to the rental firm, whichever comes first.

What we will do:

- Pay any Authorized RCA Audio Service Center the labor charges to repair your unit.
- Pay any Authorized RCA Audio Service Center for the new or, at our option, refurbished replacement parts required to repair your unit.

How you get service:

- Take your unit to any Authorized RCA Audio Service Center. To identify your nearest Authorized RCA Audio Service Center, ask your dealer, look in the Yellow Pages, or call 1-800-336-1900.
- Show the Authorized Service Center Representative your evidence of purchase date or first rental.
- Pick up your unit when repairs are completed.
- Proof of purchase in the form of a bill of sale or receipted invoice which is evidence that the product is within the warranty period must be presented to obtain warranty service. For rental firms, proof of first rental is also required.

What your warranty does not cover:

- Customer instruction. (Your Owner's Manual describes how to install, adjust, and operate your unit. Any additional information should be obtained from your dealer.)
- Installation and related adjustments.
- Signal reception problems not caused by your unit.
- Damage from misuse or neglect.
- Cleaning of audio heads.
- Batteries.
- A unit that has been modified or incorporated into other products or is used for institutional or other commercial purposes.
- A unit purchased or serviced outside Canada.
- Acts of nature, such as but not limited to lightning damage.

Product Registration:

- Please complete and mail the Product Registration Card packed with your product. It will make it easier to contact you should it ever be necessary. The return of the card is not required for warranty coverage.

Limitation of Warranty:

• THE WARRANTY STATED ABOVE IS THE ONLY WARRANTY APPLICABLE TO THIS PRODUCT. ALL OTHER WARRANTIES, EXPRESS OR IMPLIED (INCLUDING ALL IMPLIED WARRANTIES OF MERCHANTABILITY OR FITNESS FOR A PARTICULAR PURPOSE) ARE HEREBY DISCLAIMED. NO VERBAL OR WRITTEN INFORMATION GIVEN BY THOMSON INC., ITS AGENTS OR EMPLOYEES SHALL CREATE A GUARANTY OR IN ANY WAY INCREASE THE SCOPE OF THIS WARRANTY. • REPAIR OR REPLACEMENT AS PROVIDED UNDER THIS WARRANTY IS THE EXCLUSIVE REMEDY OF THE CONSUMER. THOMSON INC. SHALL NOT BE LIABLE FOR INCIDENTAL OR CONSEQUENTIAL DAMAGES RESULTING FROM THE USE OF THIS PRODUCT OR ARISING OUT OF ANY BREACH OF ANY EXPRESS OR IMPLIED WARRANTY ON THIS PRODUCT. THIS DISCLAIMER OF WARRANTIES AND LIMITED WARRANTY ARE GOVERNED BY THE LAWS OF THE STATE OF INDIANA. EXCEPT TO THE EXTENT PROHIBITED BY APPLICABLE LAW, ANY IMPLIED WARRANTY OF MERCHANTABILITY OR FITNESS FOR A PARTICULAR PURPOSE ON THIS PRODUCT IS LIMITED TO THE APPLICABLE WARRANTY PERIOD SET FORTH ABOVE.

How State Law relates to warranty:

- Some states do not allow the exclusion nor limitation of incidental or consequential damages, or limitations on how long an implied warranty lasts, so the above limitations or exclusions may not apply to you.
- This warranty gives you specific legal rights, and you also may have other rights that vary from state to state.

If you purchased your unit outside the United States:

- This warranty does not apply. Contact your dealer for warranty information.

Service calls which do not involve defective materials or workmanship are covered by this warranty. Costs of such service calls are the sole responsibility of the purchaser.

Limitation of Warranty:

• THE WARRANTY STATED ABOVE IS THE ONLY WARRANTY APPLICABLE TO THIS PRODUCT. NO VERBAL OR WRITTEN INFORMATION GIVEN BY THOMSON MULTIMEDIA LTD., ITS AGENTS OR EMPLOYEES SHALL CREATE A GUARANTY OR IN ANY WAY INCREASE THE SCOPE OF THIS WARRANTY. • REPAIR OR REPLACEMENT AS PROVIDED UNDER THIS WARRANTY IS THE EXCLUSIVE REMEDY OF THE CONSUMER. THOMSON MULTIMEDIA LTD. SHALL NOT BE LIABLE FOR INCIDENTAL OR CONSEQUENTIAL DAMAGES RESULTING FROM THE USE OF THIS PRODUCT. EXCEPT TO THE EXTENT PROHIBITED BY APPLICABLE PROVINCIAL LAW, ANY IMPLIED WARRANTY OF MERCHANTABILITY OR FITNESS FOR A PARTICULAR PURPOSE ON THIS PRODUCT IS LIMITED TO THE APPLICABLE WARRANTY PERIOD SET FORTH ABOVE.

How Provincial Laws relates to warranty:

- This warranty gives you specific legal rights which are in addition to statutory warranties that may vary from Province to Province.

If you purchased your unit outside Canada:

- This warranty does not apply. Contact your dealer for warranty information.

Service calls which do not involve defective materials or workmanship are not covered by this warranty. Costs of such service calls are the sole responsibility of the purchaser.