

# Rio<sup>®</sup> ce2100 Series

Follow steps four and five to install Rio Music Manager on your computer so you can copy tracks from CDs and transfer tracks from your computer to your Rio ce2100 series player.

For detailed instructions and feature descriptions, including copying tracks and transferring them to the Rio ce2100 series player, please see the User's Guide located on the installation CD.

P/N 41000929-001

## 4

When you are ready to add or delete tracks to your Rio ce2100 series player you should install **Rio Music Manager**.

1. Place the installation CD label-side up into your computer's CD-ROM drive. Rio installation software launches automatically.
2. Click Rio Music Manger **INSTALL NOW** and follow the on-screen instructions.
3. Reboot your computer when the installation is complete.

**NOTE:**  
If Rio installation software does not display automatically, follow these steps to begin the installation manually:

4. Double-click the **My Computer** icon on the Windows desktop.
5. Double-click the **CD-ROM** icon.
6. Double-click the **Install** icon.
7. Go to Step 4, instruction 2.



## 5

Before adding new tracks to the Rio ce2100 series player, you must connect it to your computer.

**Note:** When connected to the USB port on your computer, the Rio ce2100 series player cannot play music.

1. Connect the USB cable to the USB port on the top of the Rio ce2100 series player.
2. Connect the other end of the USB cable to the USB port on your computer.

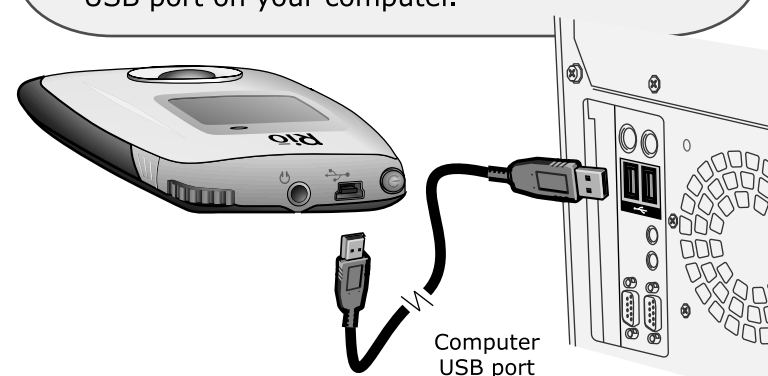

## Update Now

It is highly recommended that you maintain a connection to the Internet when using Rio Music Manager for the first time. Rio Music Manager will automatically detect the most recent version of the software. If prompted, click **Update Now** to download the latest software, including additional features and enhanced capabilities.

## Accessories

Get the latest accessories for all of your Rio players at:

[www.rioaudio.com](http://www.rioaudio.com)

### COPY TRACKS

After installation, you can use Rio Music Manager to copy tracks from Audio CDs into a music library on your computer.

1. Insert an Audio CD into your CD-ROM drive.
2. Launch Rio Music Manager.
3. Click the **CD-ROM** icon, , located in the Device List.

Rio Music Manager will scan the disc for audio files.

4. Use any file selection technique (see right) to **select tracks**.

5. Click  to **copy** tracks to your computer.

## File Selection Techniques

### File Type

Single track, album, or artist.  
Multiple tracks, albums, and/or artists.  
All tracks, albums, and artists.

### Technique

Left-click.  
SHIFT+click or CTRL+click.  
CTRL+A.

### TRANSFER TRACKS

You can transfer tracks from your computer to your Rio ce2100 series player using Rio Music Manager.

1. Launch Rio Music Manager.
2. Confirm your Rio ce2100 series player is connected to your computer. (See Step 5.)

3. Click the **My Music** icon, , located in the Device List.
4. Use the **tabs** to sort tracks based on Albums, Artists, Genres, Songs, or Playlists.
5. Use any file selection technique (see left) to **select tracks**.

6. Click  to **transfer** the selected tracks to the player.

