

Saeco®



V Spresso

OPERATING INSTRUCTIONS



Read these operating instructions carefully before using the machine

TYPE SUP021YTDR

FOR HOUSEHOLD USE ONLY



IMPORTANT SAFEGUARDS

When using electrical appliances, basic safety precautions should always be followed to reduce the risk of fire, electric shock, and/or injury to persons, including the following:

- 1 Read all instructions and information in this instruction book and any other literature included in this carton referring to this product before operating or using this appliance.
- 2 Do not touch hot surfaces. Use handles or knobs.
- 3 To protect against fire, electric shock and personal injury do not immerse cord, plugs or appliance in water or other liquid.
- 4 Close supervision is necessary when any appliance is used by or near children.
- 5 Unplug from outlet when not in use and before cleaning. Allow to cool before putting on or taking off parts, and before cleaning the appliance.
- 6 Do not operate any appliance with a damaged cord or plug or after the appliance malfunctions or has been damaged in any way. Return appliance to the nearest authorized service centre for examination, repair or adjustment.
- 7 The use of accessory attachments not recommended by the appliance manufacturer may result in fire, electric shock or personal injury.
- 8 Do not use outdoors.
- 9 Do not let cord hang over edge of table or counter, or touch hot surfaces.
- 10 Do not place on or near a hot gas or electric burner, or in a heated oven.
- 11 Always turn appliance "OFF", then plug cord into the wall outlet. To disconnect, turn switch to "OFF", then remove plug from wall outlet.
- 12 Do not use appliance for other than intended household use.
- 13 Use extreme caution when using hot steam.

SAVE THESE INSTRUCTIONS

CAUTION

This appliance is for household use. Any servicing, other than cleaning and user maintenance, should be performed by an authorized service centre. Do not immerse base in water. To reduce the risk of fire or electric shock, do not disassemble the base. There are no user serviceable parts inside. Repair should be done by authorized service personnel only.

- 1 Check voltage to be sure that the voltage indicated on the nameplate corresponds with your voltage.
- 2 Never use warm or hot water to fill the water tank. Use cold water only.
- 3 Keep your hands and the cord away from hot parts of the appliance during operation.
- 4 Never clean with scouring powders or hard implements. Simply use a soft cloth dampened with water.
- 5 For optimal taste of your coffee, use purified or bottled water. Periodic descaling is still recommended every 2-3 months.

INSTRUCTIONS FOR THE POWER SUPPLY CORD

- A A short power-supply cord is provided to reduce risks of getting tangled up or tripping over a longer cord.
- B Longer extension cords are available and may be used if care is exercised in their use.
- C If a long extension cord is used:
 - 1 the marked electrical rating of the extension cord should be at least as great as the electrical rating of the appliance.
 - 2 if the appliance is of the grounded type, the extension cord should be a grounding type
 - 3 the cord does not hang from the table to avoid the risk of getting caught up in it.

GENERAL INFORMATION

This coffee machine is ideal for preparing espresso coffee either with coffee beans or pre-ground coffee and also features a device for dispensing steam and hot water.

This elegantly styled machine is designed for household use only. It is not suitable for continuous professional-type use.

Warning. The manufacturer shall accept no liability for damage or injury caused by:

- improper use or use for other than the intended purposes;
- repairs carried out by anyone other than an authorized service center;
- tampering with the power cord;
- tampering with any machine component;
- use of spare parts and accessories other than those supplied by the manufacturer.
- mineral or scale build up and/or freezing damage.

The warranty will be voided in such cases.

TO FACILITATE INTERPRETATION



A warning triangle draws attention to the instructions that are important for user safety. Please carefully abide by these instructions to avoid serious injury!



This symbol is used to highlight information that is especially important for ensuring optimal use of the machine.

HOW TO USE THESE OPERATING INSTRUCTIONS

Keep these operating instructions in a safe place and make them available to anyone else who should use the coffee machine. For further information or an explanation of problems not completely or sufficiently addressed in these instructions, contact an authorized service center.

TECHNICAL SPECIFICATIONS

• Voltage rating	See rating plate on appliance
• Power rating	See rating plate on appliance
• Casing material	Metal
• Size (w x h x d)	10.3 x 14.2 x 17.2 inches - 260 x 360 x 436 mm
• Weight	26.5 pounds - 12 kg
• Cord length	47.2 inches - 1200 mm
• Control panel	Front (Digital)
• Water tank	67.5 oz - 2 lit. (Removable)
• Power supply	See rating plate on appliance
• Coffee container capacity	(2/3 lb) - (300 g) of coffee beans
• Pump pressure	15 bars
• Boiler	Stainless Steel
• Safety devices	Boiler pressure safety valve safety thermostat

Subject to engineering and manufacturing changes as warranted by technological developments.

Machine in conformity with European Directive 89/336/EEC (Italian Legislative Decree 476 of 04/12/92) concerning electromagnetic compatibility.

The machine complies to American regulations (c UL us) FCC Part. 15 relative to electromagnetic compatibility.

IN THE EVENT OF AN EMERGENCY

Immediately unplug the appliance.

THE APPLIANCE MAY ONLY BE USED

- Indoors.
- To prepare coffee, dispense hot water, froth milk or heat beverages using steam.
- For household use.
- By adults in full control of their physical and mental capacities.

NEVER USE THE APPLIANCE

for purposes other than those indicated above to avoid hazards. Never place any substances in the containers other than those specified in the instruction manual. When you fill a container, make sure all nearby containers are closed. Fill the water tank only with fresh water: hot water and/or other liquids may damage the machine. Do not use carbonated water. The coffee grinder may be adjusted only while it is running. Do not introduce your fingers or any material other than coffee beans into the coffee grinder. Before attempting to access the inside of the coffee grinder, switch OFF the machine and remove the plug from the outlet. Do not put coffee beans or instant coffee into the ground coffee container.

POWER SUPPLY

Connect the coffee machine to a suitable outlet. The voltage must match the voltage specified on the appliance rating plate.

INSTALLATION

- Choose a flat, level supporting surface. Do not place on a hot surface!
- Maintain a distance of 4 in / 10 cm from walls and electric or gas burners.
- Do not keep at temperatures below 32° F / 0° C; freezing may damage the appliance.
- The power outlet must be accessible at all times.
- The power cord must not be damaged, secured with clamps, placed on very hot surfaces etc.
- Do not let the power cord hang loosely (Warning: danger of tripping or of causing the appliance to fall).
- Do not use the power cord to carry or pull the coffee machine.

HAZARDS

- The appliance must not be used by children or by individuals unacquainted with the operating instructions.
- The appliance is dangerous for children. If left unattended it must be switched off.
- Do not leave the materials used to pack the appliance within children's reach.
- Do not direct a jet of hot steam and/or hot water toward yourself or others: danger of scalding.
- Do not introduce any objects through the openings in the appliance (Electrical hazard!).
- Do not touch the plug when your hands or feet are wet. Do not unplug the appliance by pulling on the power cord.
- Warning: contact with hot water, steam or and hot water/steam nozzle may cause burns.

FAULTS

- Do not use the appliance if it malfunctions or you suspect damage, e.g. after a fall.
- Repairs must be performed by an authorized service center.
- Do not use an appliance with a defective power cord. The cord may only be replaced by a service center (Electrical hazard!).
- Switch off the appliance before opening the service door. Danger of scalding!

CLEANING

- Before cleaning the appliance, unplug it and allow it to cool down.
- Avoid exposing the appliance to splashes of water. Do not immerse it in water.
- Do not dry machine components in a conventional or microwave oven.

SPARE PARTS

To guarantee safety, you should use only original spare parts and accessories.

DISPOSAL

- The packing materials can be recycled.
- Appliance: unplug the appliance and cut the power cord.
- Deliver the appliance and power cord to a service center or public waste disposal facility.

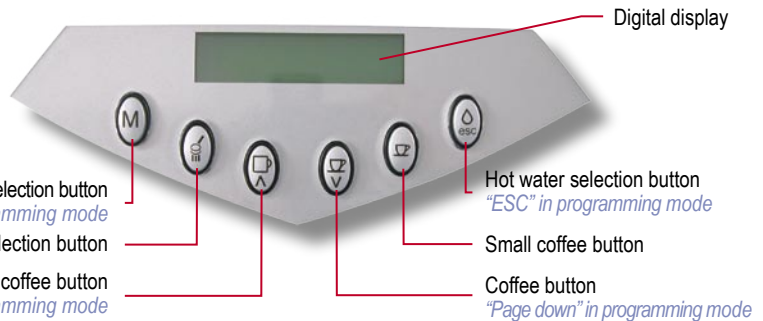
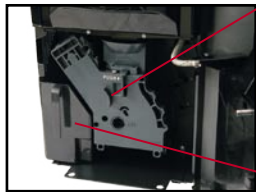
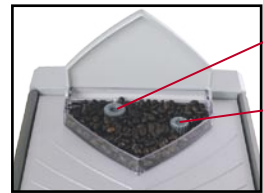

 The messages displayed by the machine during operation are shown on page 18.

 Important warning for using the “Aqua Prima Filter” can be found at page 18.



Remove the drip tray from the box and put in place on the machine.



Fill the coffee bean container with coffee beans.



The “Aqua Prima” filter can be installed (see pg.11). Allow to soak for 30 minutes prior to first use.



Fill the tank with fresh water.

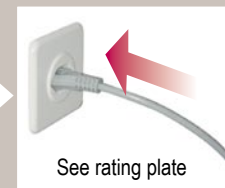

See rating plate

Insert the plug into a suitable outlet.



Move the ON/OFF switch to “I” to turn on the machine.

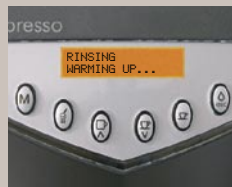

The display will signal that the machine is warming up.

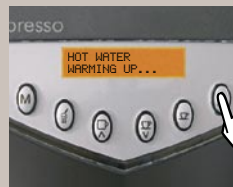

Press the hot water button.



Place a container under the steam wand.



Open the knob to prime the machine.



Wait until a steady stream of water flows out from the wand.



Close the knob to stop the flow of water. Remove the container.

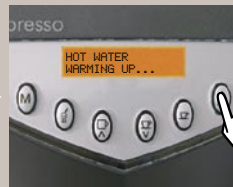

Press the hot water button again to turn off the hot water feature. Wait for machine to reach coffee temperature.



The machine is ready for use.

Note: Prime the machine during initial set up, if the machine has not been used for several days, after refilling the water tank, or any time the display reads “VENTILATE”.

COFFEE GRINDER ADJUSTMENTS



The grinder can be adjusted by means of the knob.



Turn counterclockwise for a finer grind. Coffee flows out more slowly



Turn clockwise for a coarser grind. Coffee flows out more quickly

! Adjustments may be made only while the burr coffee grinder is operating and in increments of 2. Extreme settings not recommended.

Use coffee bean blends for espresso coffee makers. If you do not obtain the desired result, try using a different blend. Store coffee in a cool place, in an air tight container. Do not use frozen beans.

You will see a change after dispensing 3 – 4 cups of coffee.

COFFEE DOSE ADJUSTMENTS



You can adjust the quantity of coffee to be ground per cup from 6 (-) o 9 (+) grams.



Stronger coffee (towards +).

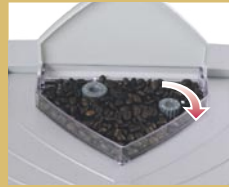

Weaker coffee (towards -).

You must adjust the dose before brewing a cup of coffee.

This adjustment will have an immediate effect on the next cup of coffee brewed.

COFFEE IN CUPS

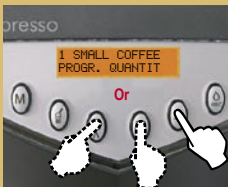

To adjust the quantity of coffee dispensed to the size of your cups, place a cup under the coffee dispenser, press the desired coffee button and **keep it pressed while coffee is being dispensed.**

When the cup has filled to the desired level, release the button; the machine is now programmed to dispense the quantity of coffee you have chosen.

Warning! Hot water and steam may cause burns! Direct the steam wand towards the drip tray.

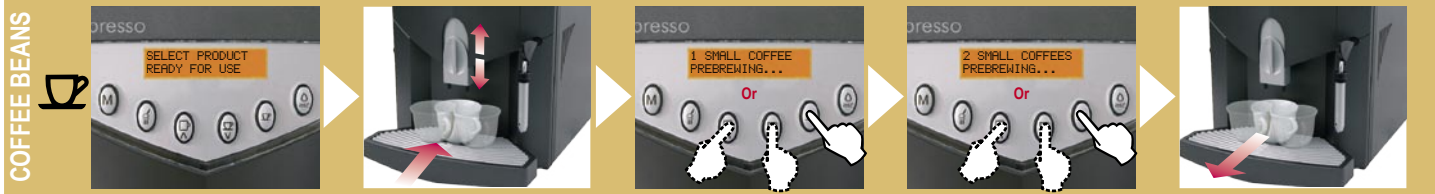

Make sure that the machine is ready.

Position a warm coffee cup or cups under the coffee dispenser.

Press the desired coffee button:
Once for 1 cup.

Twice for 2 cups or a double shot.

When the machine stops making the coffee, remove the cup or cups.



Position a warm coffee cup under the coffee dispenser.

Select the "Pre-ground coffee" button.

Put one **level** scoop of espresso pre-ground coffee.
MAX 1 CUP AT A TIME.

Press the desired coffee button.

When the machine stops brewing the coffee, remove the cup.

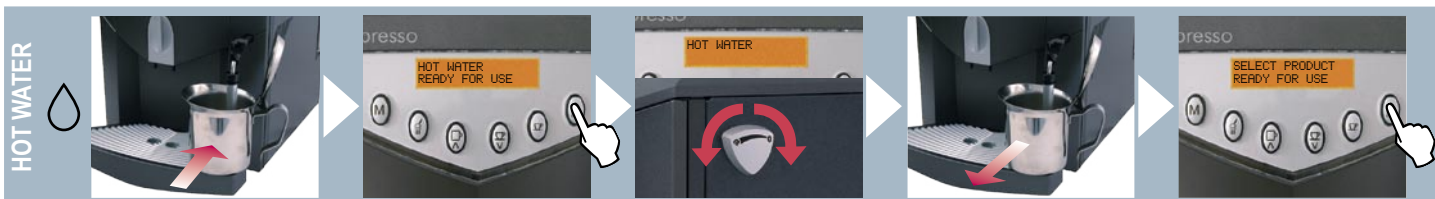

Position the container under the steam wand.

Press the hot water button.

Open the knob to start dispensing. Close the knob to stop.

Take the container.

Press the button for normal operation.

Warning! Hot water and steam may cause burns! Direct the steam wand towards the drip tray.



ENGLISH

Fill a cup to 1/3 with cold milk.

Position a container under the steam wand. Open the knob to discharge any residual water.

When only steam comes out, close the knob. Remove the container.

Position the cup with cold milk under the steam wand.

Open the knob to release steam.



The machine will signal the function.

Move the cup in a circular motion to heat and froth the milk evenly.

After frothing the milk, close the knob.

Remove the cup and place it under the coffee dispenser.

Dispense coffee into the cup to prepare a delicious cappuccino.

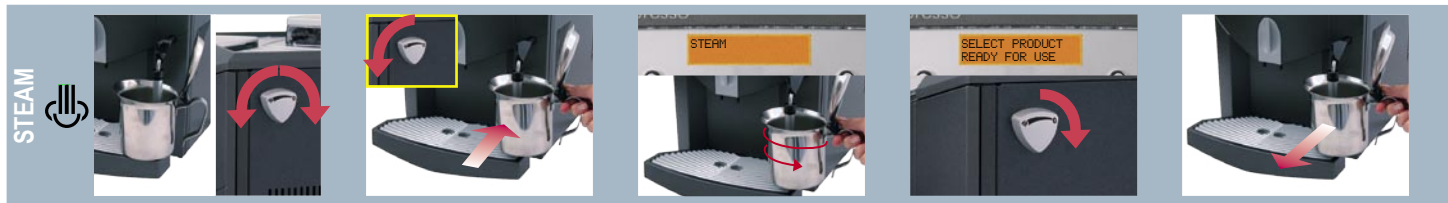

Open the knob to eliminate any residual water.

Place a container with the beverage to heat up under the steam wand. Open the knob.

Heat evenly by making circular movements.

Close the knob when finished.

Remove the container.

Warning! Never use vinegar as a descaling agent. You can use any commercially available non-toxic, non-harmful descaling product for coffee machines. We recommend using a Saeco descaling agent.

The machine must be descaled every 2-3 months, when you observe a diminished flow of water or when the machine signals that descaling is necessary. The machine must be on; it automatically controls the distribution of the descaling solution.



The machine will display a message when it needs descaling.

Press the "M" button.

Scroll up or down until the menu "Descaling" appears on the top of the display.

Press the "M" button to select the function.

Remove the cartridge filter carefully. Fill the tank with the descaling solution.

Place a large container under the steam wand.



Open the steam knob. The machine will start descaling.

When the descaling cycle is completed, close the knob.

Press the "M" button.

Rinse out the tank and fill it with fresh water.

Open the knob to rinse.

On completing the rinse, close the knob.



Press the "M" button.

Use the buttons to view the following menu.

Press the "M" button twice.

Clear the descaling signal.

Press "esc" to exit the descaling function.

Warning! If the descaling cycle is interrupted, the water tank and internal machine circuits must be rinsed.

For further instructions on how to clear the descaling signal, see chapter on programming.

 The filter must be replaced every 3 months.

 Before descaling, remove the filter from the tank.

INSTALLATION



Remove the filter from the package. Adjust the red date indicator to the current month.



Insert the applicator and turn it clockwise to secure it to the filter.



Check where the filter position and reference mark is.



Put the filter into the empty tank.



The reference must be positioned in correspondence with the groove.

ENGLISH

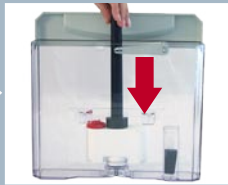

Press down until it is well seated in place



Turn the applicator counter-clockwise and remove it from the tank.



Fill the tank with fresh water and allow filter to soak in the tank for 30 minutes prior to first use.



Position a container under the steam wand and turn the machine on.



Press the hot water button.



Open the knob to dispense water through the steam wand.



Dispense water until the tank is empty.



Fill the tank with fresh water.



Press the hot water button again to turn off the hot water feature.

It is possible to use the machine without the Aqua Prima filter. However, Saeco suggests its use to ensure a better tasting cup of coffee.

You can now use your coffee machine.

! Do not dry the machine and/or its components in a microwave and/or conventional oven.

! Do not immerse the machine in water and do not place any of its components in a dishwasher.

BASIC CLEANING

Turn the machine off. Unplug the machine.

Wash the water tank. Wash the filter inside it.

Use the brush to clean the pre-ground coffee chute.

Remove the drip tray, empty it out and wash it.

Open the service door, remove the dregs drawer/waste box, empty it out and wash it.

! Clean the machine, its components, and the brew group at least once a week.

BREW GROUP

Remove cover on "Pannarello" frothing attachment, wash under tap. Wipe spout left on steam wand with wet cloth. When necessary, unscrew complete assembly and wash under tap with warm soapy water.

Remove drip tray

Open the service door.

Remove the dregs drawer/waste box.

Press the PUSH button to release the brew group.

Unscrew the upper filter screen using the key provided and wash it with warm water. Put it back in place when clean and hand tighten.

Wash the brew group, dry it and slide back in place. **Do not press the "PUSH" button.**

Put all machine components back in position. Close the door.

The following programming features can be changed to suit your needs.

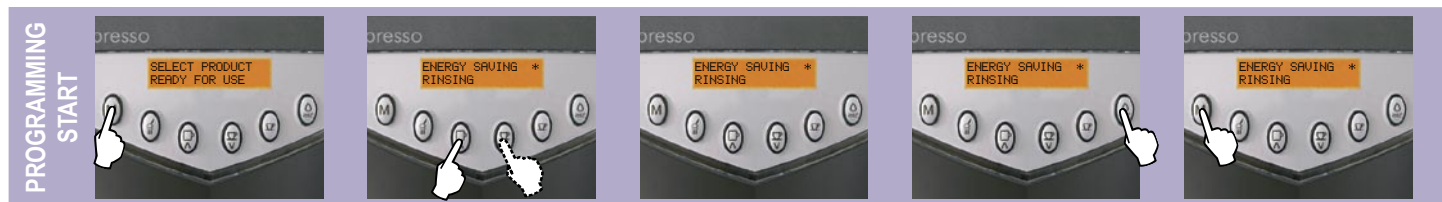

Press the "M" button to access the programming mode.

Use the " \wedge " and " \vee " buttons to display/change the menus.

Using the "M" button you can select the menu item marked with an "*".

Press ESC to exit without making any changes.

Use the "M" button to select a menu or confirm a change.

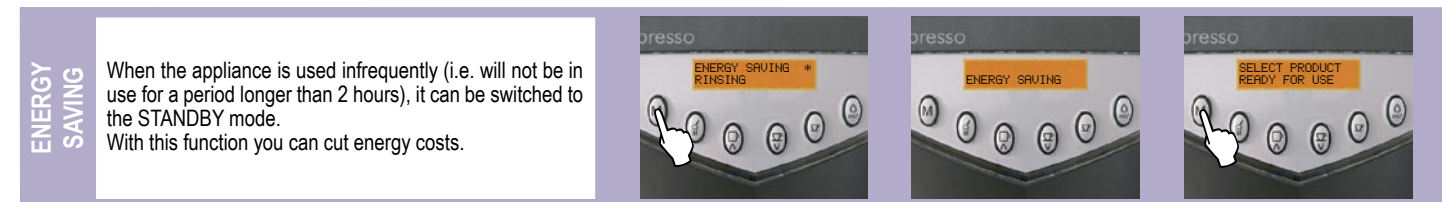

When the appliance is used infrequently (i.e. will not be in use for a period longer than 2 hours), it can be switched to the STANDBY mode. With this function you can cut energy costs.

When the function appears, select it using the "M" button.

The display will show that the machine is in the standby mode.

Press the "M" button to restore the machine to normal operation.

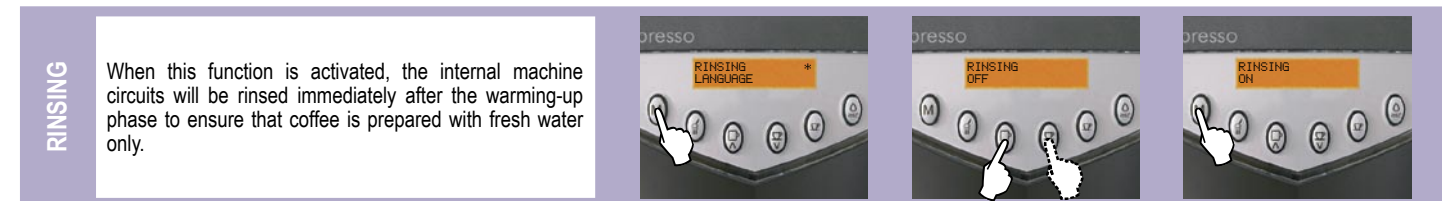

In all new appliances this function has already been activated in the factory.

When the function appears, select it using the "M" button.

From this menu you can deactivate the function.

Press the "M" button to confirm your choice.

LANGUAGE

This function permits to change the language on the display. You can select: Italian, German, Portuguese, Spanish, English, French, Polish, Swedish, and Dutch. The appliance is usually programmed to the language of the country in which it is sold.

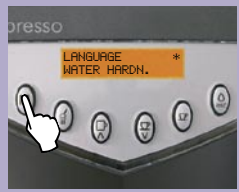

When the function appears, select it using the "M" button.



Select the desired language.



Press the "M" button to confirm your choice.

WATER HARDNESS

The hardness of tap, bottled and filtered water may vary depending on the region, brand and filter used. For this reason, the appliance can be set according to the water hardness to be used, expressed on a scale of 1 to 4 (1 = soft and 4 = hard).



The appliance is factory set on a hardness value of 3. The setting should be adjusted according to the level of water hardness to be used with the machine.

Dip the test strip in water for 1 second. Check how many squares change color.

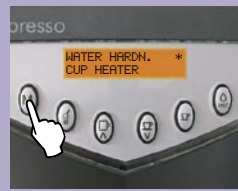

When the function appears, select it using the "M" button.

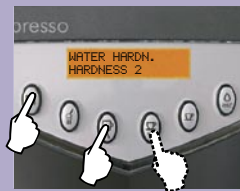

Select the corresponding hardness (e.g. 2 squares = Hardness 2) and memorize the value by pressing the "M" button.

CUP HEATER

This function allows you to turn on the cup warming surface on the machine.



When the function appears, select it using the "M" button.



Choose whether you wish to turn the cup warming surface on or off.



Press the "M" button to confirm your choice.

TEMPERATURE

This menu allows you to change the coffee temperature to suit your needs. It is possible to choose: "low" – "minimum" – "medium" – "high" – "maximum".

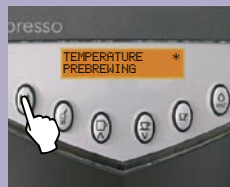

When the function appears, select it using the "M" button.

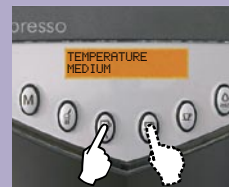

Select the desired temperature.

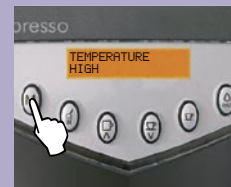

Press the "M" button to confirm your choice.

PREBREWING

With the pre-brewing process the coffee is slightly moistened before actual brewing. This pre-infusion brings out the aroma and flavor of the coffee. It is possible to choose either "ON", or "OFF", or "LONG".

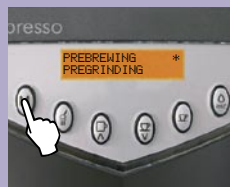

When the function appears, select it using the "M" button.



Choose whether you wish to turn the pre-brewing function on, long or off.

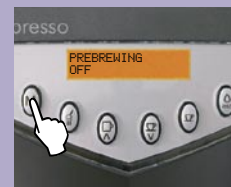

Press the "M" button to confirm your choice.

PREGRINDING

With the pre-grinding process the machine grinds twice: the first time for the cup of coffee selected and the second time for the subsequent coffee (not yet selected). When you brew the next cup of coffee the machine goes straight into brewing as the dose of ground coffee is already ready. This function is useful when you are brewing numerous cups of coffee in sequence (e.g. while entertaining guests or during a party).

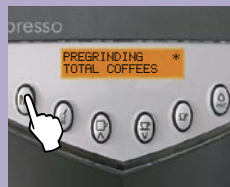

When the function appears, select it using the "M" button.

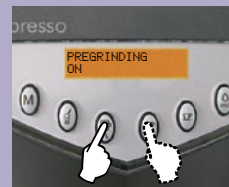

Choose whether you wish to turn the pre-grinding function on or off.

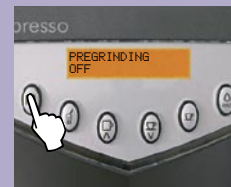

Press the "M" button to confirm your choice.

We do not recommend it for regular daily use if the dose of ground coffee is going to sit inside the machine unused for several hours.

TOTAL COFFEES

This function enables the user to see how many cups of coffee the machine has dispensed. It is not possible to reset or change this value.

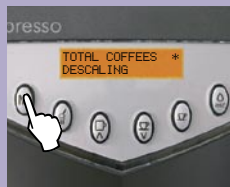

When the function appears, select it using the "M" button.

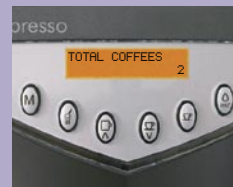

The display will show the total cups of coffee.

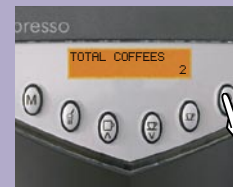

Press "ESC" to exit the menu.

SIGNAL DESCALING

This function enables you to see how much more water the machine can dispense before it needs descaling. The value will depend on the water hardness setting. This function includes a menu for clearing the "DESCALING" message after descaling has been carried out.

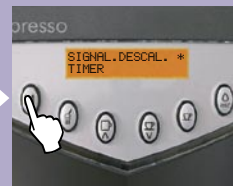

When the function appears, select it using the "M" button.

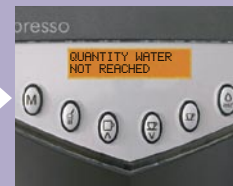

A message will be displayed informing the user that descaling is not necessary.

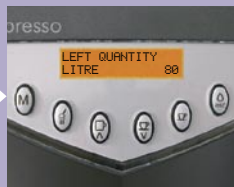

Quantity of water to be dispensed before the machine needs descaling.

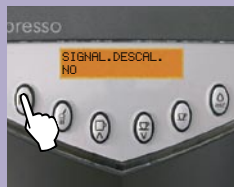

Press the "M" button

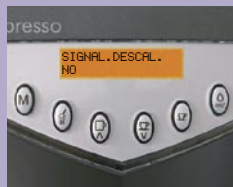

This menu allows you to clear the "DESCALING" message.

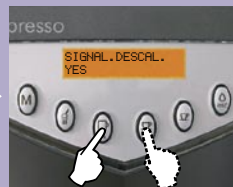

Choose whether to reset the count of water dispensed.

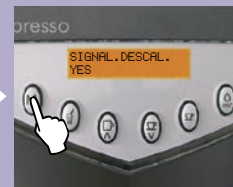

Press the "M" button to confirm your choice.

DESCALING

This function enables you to activate an automatic descaling cycle. See page 10 for step by step descaling instructions.

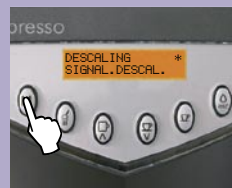

When the function appears, select it using the "M" button.

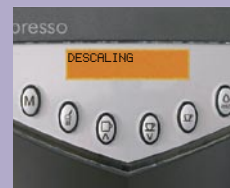

Prepare the machine for descaling.



Carry out an automatic descaling cycle (see page 10) or press "ESC" to exit if descaling is not yet needed.

TIMER

This is a factory-set function that automatically switches the machine into "Standby" after a maximum of 3 hours have elapsed since the last cup of coffee was dispensed.

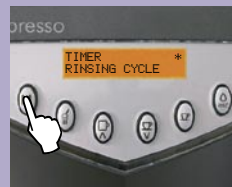

When the function appears, select it using the "M" button.

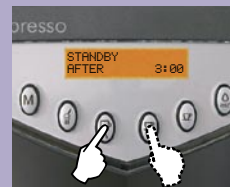

Use the buttons to adjust the timer setting.

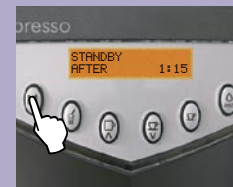

Press the "M" button to confirm your choice.

The switch-off time can be adjusted, in 15-minute intervals, to a minimum of 15 minutes; the function cannot be deactivated.

RINSING CYCLE

This function is used to rinse all the coffee-dispensing parts with water.

The rinsing cycle cannot be interrupted.
A person must be present during this operation.

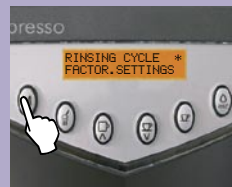

When the function appears, select it using the "M" button.



The machine will carry out a rinsing cycle.



When the cycle is finished the FILL WATER TANK message will be displayed.



Warning: a large quantity of water may be dispensed from the coffee dispenser. Before starting, empty out the drip tray and keep an additional container handy.

FACTORY SETTINGS

With this function you can restore the machine operating parameters to the original settings set by the manufacturer. If you restore all the factory settings, all customized settings will be lost and you will need to reprogram them if so desired.

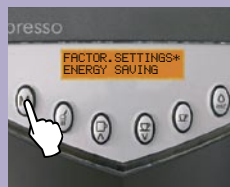

When the function appears, select it using the "M" button.

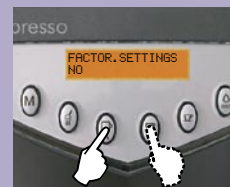

Choose whether to restore the initial factory settings.

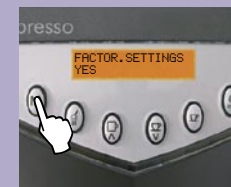

Press the "M" button to confirm your choice:

Messages are displayed to guide users through the usage of the machine correctly.



Press "M" .



Descale the machine.



Fill the water tank with fresh water.



Fill the coffee bean container and press the desired coffee button to start the brewing cycle.



Remove the dregs drawer / waste box and empty out the used coffee grounds.

Important note: the dregs drawer / waste box may be emptied only when the machine is ON. The drawer must be removed for at least 5 seconds for the machine to read that the drawer has been emptied. If you empty the drawer with the machine off, you will not be able to dispense coffee the next time you switch the machine on.



Put the brew group properly in place.



Put the dregs drawer / waste box properly in place.

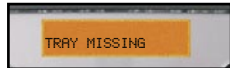

Put the drip tray properly in place.



Close the front door.



Contact an authorized service center.



ADDITIONAL INFORMATION FOR CORRECTLY USING THE "AQUA PRIMA" FILTER.

Please follow these simple instructions to correctly use the "Aqua prima" filter:

1. Keep the "Aqua prima" filter cool and away from sunlight; the room temperature should be between 41°F/+5°C and 104°F/+40°C;
2. Do not use the filter in temperatures over 140°F/60°C.
3. If the coffee machine is not used for 3 days, we recommend washing the "Aqua prima" filter;
4. If the coffee machine is not used for more than 20 days, it is advisable to replace the filter.
5. To store an already opened filter, seal it in a nylon bag and keep in the fridge; do not store it in the freezer to avoid damaging the filter properties.
6. Before using the filter, leave it to soak in the water tank for 30 minutes.
7. Once it is taken out of its packaging, do not keep the filter in the open air.
8. The filter must be replaced 90 days after opening the package or after treating 13 gallons/60 litres of water.

PROBLEMS	CAUSES	REMEDIES
The brewing cycle does not start.	No coffee beans / "Cof Beans Empty".	Refill bean hopper and press desired coffee button.
	No water / "Fill watertank".	Fill water tank. Make sure float is in position and held in place by the cap. Message will clear.
	Dredge drawer / waste box is full / "Dredgedrawer full".	Remove waste box while machine is on. Leave out for 5-10 seconds and put back in machine. Message will clear.
	Brew group missing / "Brew Unit Miss."	Remove drip tray, waste box and brew group. Put brew group back in machine until securely locks in place, put waste box in, shut service door and put drip tray back in place.
Coffee flows too quickly.	Grind is too coarse.	Adjust the grinder to a finer grind, ex. from 5 to 3. Adjust only while grinder is grinding and only a maximum of 2 settings at a time. It will take 3-4 cups to see results.
	Dose needs to be increased.	Turn doser towards + sign.
Coffee flows too slowly.	Grind is too fine.	Adjust the grinder to a coarser grind, ex. from 5 to 7. Adjust only while grinder is grinding and only a maximum of 2 settings at a time. It will take 3-4 cups to see results.
	Dose needs to be decreased.	Turn doser towards - sign.
	Filter screen in brew group is clogged.	Clean the filter screen using the key provided.
The machine does not turn on.	The machine is not connected to the power supply.	Move the main switch to ON ("I" position). Check the plug and the power outlet.
The coffee is not hot enough.	The cups are cold.	Warm up the cups on cup warmer or by dispensing a little hot water into the cup and letting it sit for a few seconds.
	A low temperature has been set.	Set the machine to a higher temperature.

PROBLEMS	CAUSES	REMEDIES
Only water is dispensed when you select "pre-ground coffee".	No pre-ground coffee has been put into the pre-ground chute.	Select Pre-ground coffee button, put pre-ground coffee into the chute and press the desired coffee button.
	Too much pre-ground coffee put in chute.	Put one level scoop of espresso coffee. Max. 1 cup at a time.
No hot water or steam is dispensed.	The steam wand is clogged.	Clear it with a thin needle or pin.  During this operation, the knob must be closed and the machine must be off. Then run water through steam wand to make sure unclogged.
Reduced amount of coffee, water and steam coming out of the machine; the machine takes longer to heat .	Lime scale / mineral build up in machine.	Descale the machine. If not done for a long period of time, we recommend doing 2 cycles (see instructions on page 10).
Unable to clear Descal message.	Need to reset message.	Go into programming mode, "Sign. Decal." and reset message.
The brew group cannot be removed.	The brew group is out of alignment.	Put waste box in position, close door and put drip tray in position. Switch machine on; the brew group will reset into original position.
Ventilate	Machine needs to be primed.	Dispense 3-4 oz of water through the steam wand.
	Steam wand clogged.	Clear steam wand and prime machine.
	Limescale / mineral build up in machine.	Descale the machine. If not done for a long period of time, we recommend doing 2 cycles (see instructions).
Questions?	US Customers Contact Saeco USA Customer Service at 1-800-933-7876 Canada Customers Contact Saeco Canada at 1-514-385-5551	



**Saeco International Group S.p.A. - Via Panigali, 39
40041 Gaggio Montano - Bologna - Italy
Tel. +39 0534.771.111 - Fax. +39 0534.31025 - <http://www.saeco.com>**