

# SHARP SERVICE MANUAL

No. S13A5LC60LE5L

LCD COLOR TELEVISION

LCD Module Edition

**LC-60LE550U**

**MODELS LC-70LE550U**

## CONTENTS

OUTLINE

Parts Guide

Parts marked with "⚠" are important for maintaining the safety of the set. Be sure to replace these parts with specified ones for maintaining the safety and performance of the set.

## OUTLINE

### OUTLINE

- Information of service parts in the LCD Module

Unit

<b>Model Name</b>	<b>Unit Name</b>	<b>Description</b>
LC-60LE550U	R1JE600D3GV2AZ	60" LCD PANEL MODULE Unit (JE600D3GV2AZ)
LC-70LE550U	R1JE695D3GW8CD	70" LCD PANEL MODULE Unit (JE695D3GW8CD)

# SHARP PARTS GUIDE

No. S13A5LC60LE5L

**LCD COLOR TELEVISION****LC-60LE550U**  
**MODELS LC-70LE550U**

## CONTENTS

[1] LCD PANEL MODULE Unit  
(LC-60LE550U)

[2] LCD PANEL MODULE Unit  
(LC-70LE550U)

Parts marked with "△" are important for maintaining the safety of the set. Be sure to replace these parts with specified ones for maintaining the safety and performance of the set.

[1] LCD PANEL MODULE Unit (LC-60LE550U)

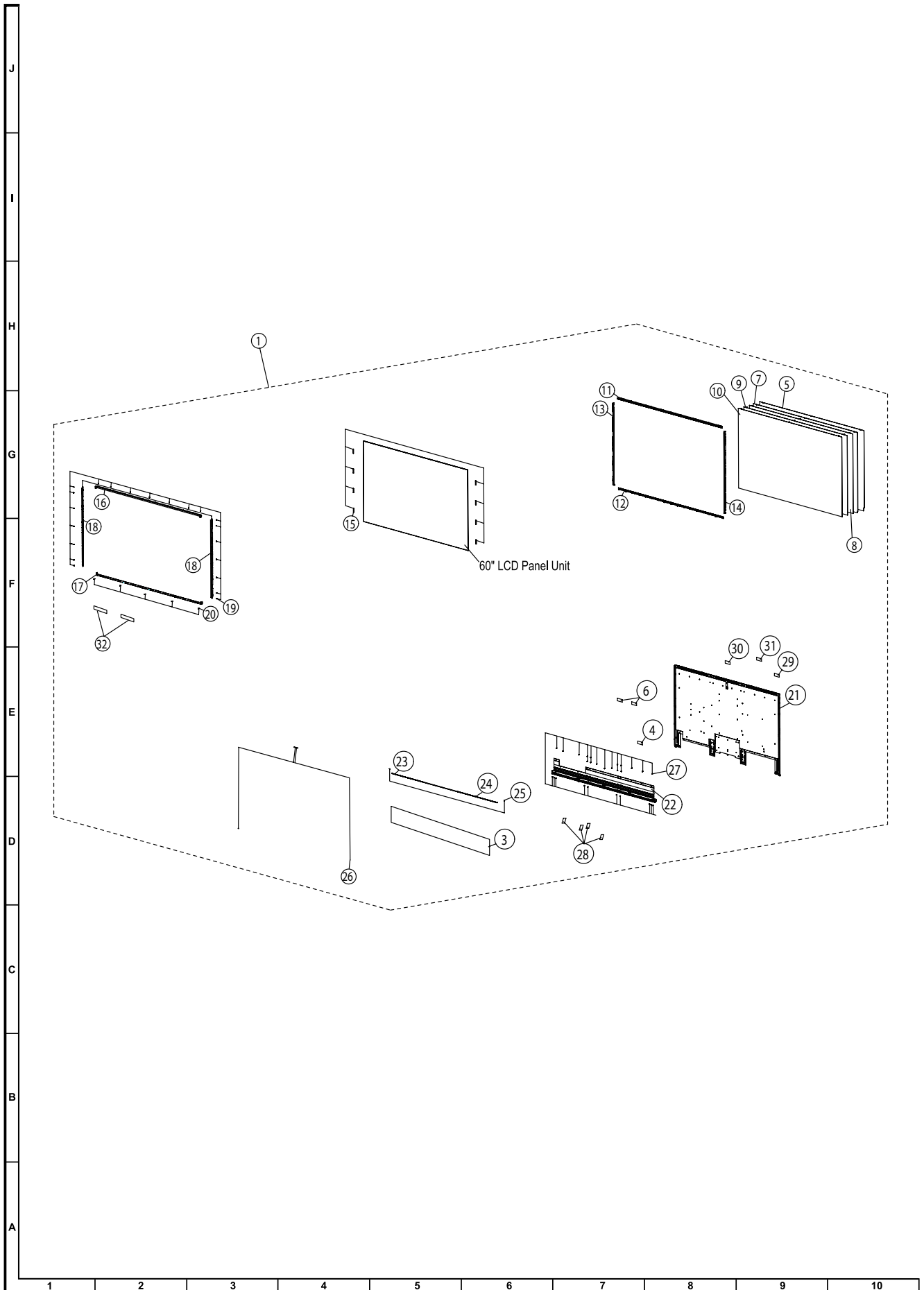

NO.	PARTS CODE	PRICE RANK	NEW MARK	PART DELIVERY	DESCRIPTION
<b>[1] LCD PANEL MODULE Unit (LC-60LE550U)</b>					
1	R1JE600D3GV2AZ	DP		X	60"LCD PANELMODULEUnit(JE600D3GV2AZ)
3	PREFL3457TPZZ	AF		X	ReflectionSheet
4	PTPEH2887TPZZ	AA		X	DoublesideTape
5	PREFL3456TPZZ	AX		X	ReflectionSheet
6	PSPAG1167TPZZ	AA		X	Spacer.x2
7	PLGPA0803TPZZ	BK		X	LightGuidePlate
8	PSLDK3737TPZZ	AT		X	DiffusionSheet
9	POFMA1392TPZZ	AY		X	LensSheet
10	PSLDK3737TPZZ	AT		X	DiffusionSheet
11	CHLDZ5071TP02	AK		X	PChassisUnit(Top)
12	CHLDZ4972TP02	AK		X	PChassisUnit(Bottom)
13	CHLDZ4973TP02	AG		X	PChassisUnit(Left)
14	CHLDZ4974TP02	AG		X	PChassisUnit(Right)
15	PSHEP3394TPZZ	AA		X	StickSheet,x8
16	CANGK5064TP01	AN		X	BezelUnit(Top)
17	CANGK5065TP01	AQ		X	BezelUnit(Bottom)
18	CANGK5066TP01	AG		X	BezelUnit,x2(Left/Right)
19	LX-BZ2568TPZZ	AA		X	Screw,x21
20	LX-BZ2578TPZZ	AA		X	Screw,x5
21	CANGK5061TP01	BG		X	AngleUnit
22	CANGT0361TP03	AZ		X	AttachmentAngleUnit
23	RUNTK5288TPZZ	BB		X	LEDPWBUnit(Left)
24	RUNTK5289TPZZ	BB		X	LEDPWBUnit(Right)
25	LX-HZA077WJZZ	AA		X	Screw,x2
26	QCNWN2828TPZZ	AN		X	LEDHarness
27	LX-HZ2422TPZZ	AA		X	Screw,x21
28	PSHEP3392TPZZ	AA		X	Sheet,x4
29	TLABN3860TPZZ	AA		X	BLLabel
30	PCOVP2989TPZZ	AA		X	Cover(Cap)
31	TLABN2229TPZZ	AA		X	BarCodeLabel
32	QPWBM1447TPZZ	AF		X	SSFPC,x2

[2] LCD PANEL MODULE Unit (LC-70LE550U)

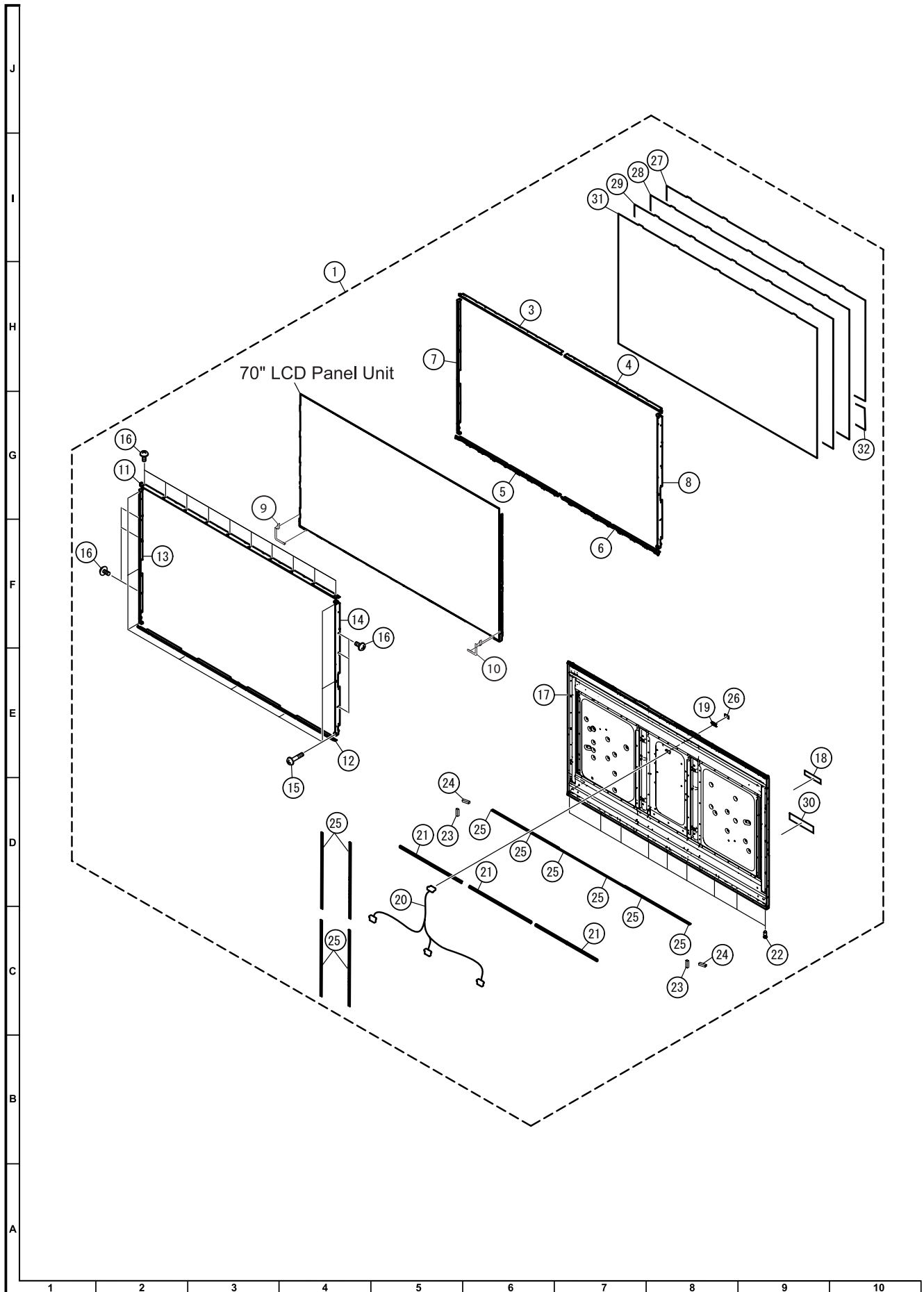

NO.	PARTS CODE	PRICE RANK	NEW MARK	PART DELIVERY	DESCRIPTION
<b>[2] LCD PANEL MODULE Unit (LC-70LE550U)</b>					
1	R1JE695D3GW8CD	EN		X	70" LCD PANEL MODULE Unit (JE695D3GW8CD)
3	CHLDZ4981TP04	AH		X	P Chassis Unit (Left/Up)
4	CHLDZ4982TP04	AH		X	P Chassis Unit (Right/Up)
5	CHLDZ4983TP04	AH		X	P Chassis Unit (Left/Down)
6	CHLDZ4984TP04	AH		X	P Chassis Unit (Right/Down)
7	CHLDZ4985TP04	AH		X	P Chassis Unit (Left)
8	CHLDZ4986TP04	AH		X	P Chassis Unit (Right)
9	QCNWN2842TPZZ	AF		X	SG-FFC (Left)
10	QCNWN2842TPZA	AF		X	SG-FFC (Right)
11	CANGK5081TP01	AR		X	Bezel Unit (Top)
12	CANGK5082TP01	AU		X	Bezel Unit (Bottom)
13	CANGK5083TP01	AQ		X	Bezel Unit (Left)
14	CANGK5084TP01	AQ		X	Bezel Unit (Right)
15	LX-BZ2581TPZZ	AA		X	Screw, x9
16	LX-BZ2582TPZZ	AA		X	Screw, x16
17	CANGK5193TP02	BR		X	Angle Unit
18	TLABN3860TPZZ	AA		X	BL Label
19	PCOVP2986TPZZ	AA		X	Bush Base
20	QCNWN2850TPZZ	AL		X	LED Harness
21	RUNTK5369TPZZ	BE		X	LED PWB, x3
22	LX-LZ0003TPZZ	AA		X	Push Rivet, x9
23	PCUSG3662TPZZ	AA		X	LGP Guide Cushion, x2
24	PSPAG1196TPZZ	AA		X	Spacer, x2
25	LHLDZ5005TPZZ	AE		X	LGP Holder, x10
26	PCOVP2989TPZZ	AA		X	Bush Cap
27	PREFL3475TPZZ	AX		X	Reflection Sheet
28	PLGPA0834TPZZ	BP		X	Light Gude Plate
29	PSLDK3741TPZZ	AX		X	Diffusion Sheet
30	TLABN2229TPZZ	AA		X	Bar Code Label
31	PSLDK3740TPZZ	BC		X	Micro Lens Sheet
32	PREFL3474TPZZ	AM		X	Reflection Sheet

# SHARP

**COPYRIGHT © 2013 BY SHARP CORPORATION**

**ALL RIGHTS RESERVED.**

No Part of this publication may be reproduced, stored in a retrieval system, or transmitted in any form or by any means, electronic, mechanical, photocopying, recording, or otherwise, without prior written permission of the publisher.