

SPALDINGEQUIPMENT.COM

800.435.3865

VOLLEYBALL

GYMNASIUM

BASKETBALL

# SPALDING

TRUE TO THE GAME™



## 2013 EQUIPMENT CATALOG

SPALDING  
TRUE TO THE GAME™



## SPALDING® EQUIPMENT CATALOG



Official Backstop of the National Basketball Association.



Official Backstop of the Women's National Basketball Association.



Official Backstop of the NBA Development League.



Official Supplier of Backstop, Backboard, and Goal Equipment of the 2013 NCAA® Men's & Women's Final Four™.



USA Volleyball®

Official Indoor Net Support System of USA Volleyball®.

### LEVEL OF PLAY ICONS *for basketball*

FOR *Professional* PLAY

FOR *Collegiate* PLAY

FOR *High School* PLAY

FOR *Recreational* PLAY



Icon denotes the product/s on the page are made in the USA.

## SPALDING® EQUIPMENT

True to the Game™

Spalding is constantly developing new products to meet our customers' ever-changing needs. We offer high quality products, superior product designs and integrated product development and distribution.

Spalding manufactures a complete line of portable, ceiling-suspended and wall-braced backstops, backboards, rims, volleyball systems, protective padding and accessories.

Our experienced and dedicated sales and customer service teams, along with our national dealer network, provide second-to-none customer support.

Spalding is the world's largest basketball equipment company, partnering with the best associations in the world. We are the official backstop of the NBA, and the Backstop and backboard supplier to the NCAA® Final Four™.

Our volleyball systems are used extensively for national and international events, from high school to college. Spalding is the Official Net Systems Supplier to USA Volleyball®.

SPALDING® PROVEN ON THE COURT OF PLAY

## TABLE OF CONTENTS

### [ BASKETBALL ]

- 03** | Positive Lock Breakaway Goals
- 04** | Flex Breakaway Goals
- 05** | Fixed Goals
- 06 - 09** | Glass Backboards
- 10** | Nets and Goal & Board Mounting Diagrams
- 11** | Backboard Packages
- 12** | Non-Glass Backboards
- 13 & 14** | Outdoor Basketball Poles
- 15 - 20** | Portable Backstops
- 21** | Scorers Tables
- 22** | Training Aids
- 23** | Ball Racks

### [ GYMNASIUM ]

- 24 & 25** | Protective Wall Padding
- 26** | Wall-Braced Backstops
- 27** | Spalding Helix™ Height Adjuster
- 28-29** | Ceiling-Suspended Backstops
- 30 & 31** | Divider Curtains
- 32** | Batting Cages
- 33** | Gymnasium Components
- 34** | Gymnasium Controllers
- 35** | Gym Pro™

### [ RESIDENTIAL ]

- 36 & 37** | Choose your Residential System
- 38 - 43** | Residential In-Ground Systems
- 44 - 47** | Residential Portable Systems
- 48 & 49** | Combo Systems
- 50** | Residential Accessories
- 51** | Karch Kourt

### [ VOLLEYBALL ]

- 52 - 55** | Elite Aluminum & Steel Systems
- 56 & 57** | Slide Multi-Sport System
- 58 & 59** | Rectangular Slide System
- 60** | Telescoping Multi-Sport Systems
- 61** | Tennis & Badminton Systems
- 62** | Floor Plates and Sleeves
- 63** | T-Bases & Floor Anchors
- 64 & 65** | Volleyball Nets & Accessories
- 66** | Volleyball Upright Padding
- 67** | Volleyball Referee Platforms & Pads
- 68 & 69** | Volleyball Accessories
- 70** | Volleyball Training Aids
- 71** | Volleyball Court Layouts

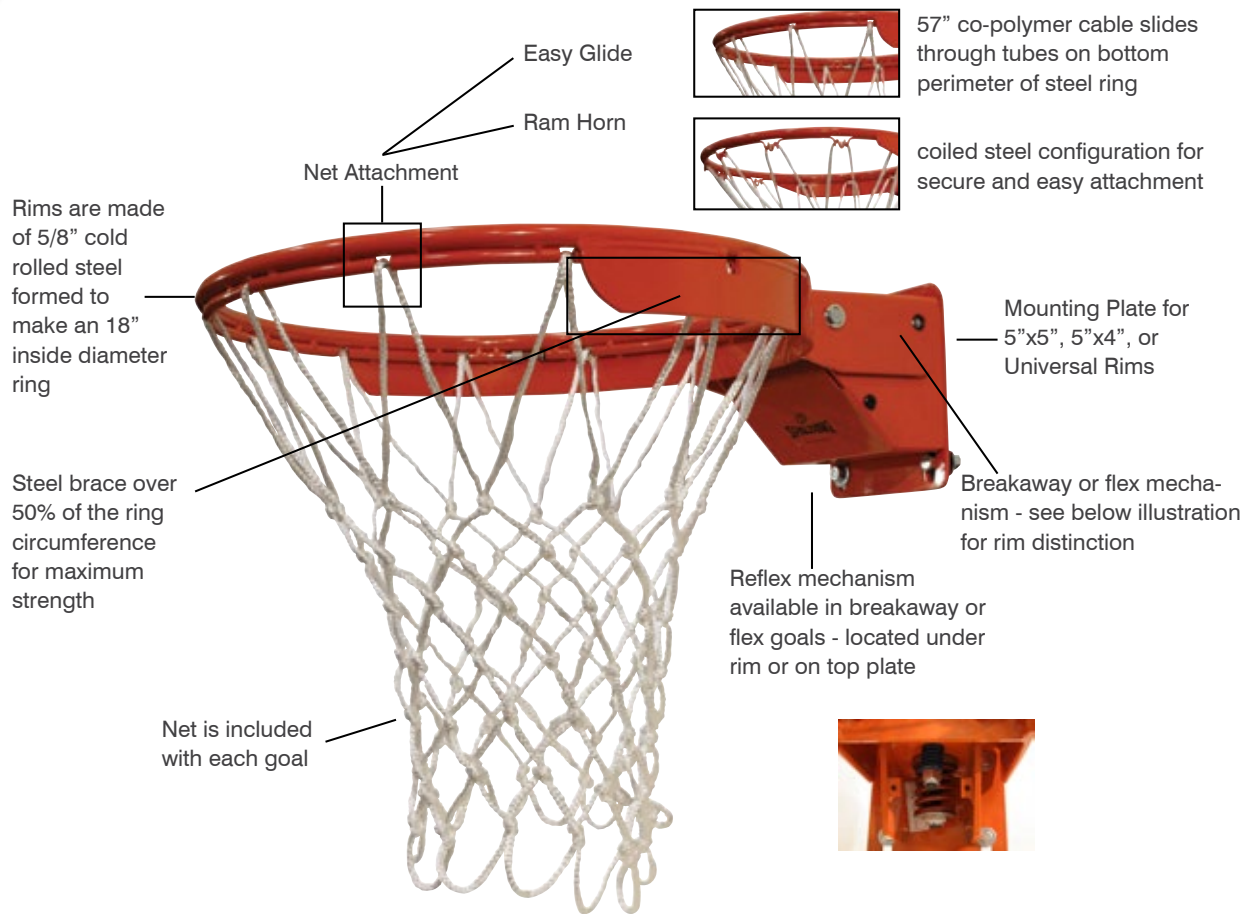

## GOAL DISTINCTION



**POSITIVE LOCK BREAKAWAY GOALS** - Positive Lock goals are spring loaded to withstand a specific amount of force applied to the rim before they automatically release and pivot downward. The amount of force required to release the goal is adjustable. Once the force is removed, the rim will return to play position.



**FLEX BREAKAWAY GOALS** - Flex breakaway goals are spring loaded but do not include the positive lock mechanism, therefore there is no force threshold required to move the rim. Increasing the force load will cause the rim to travel farther away from play position. Once the force is released, the rim will automatically return to play position.



**FIXED GOALS** - Fixed goals are made of a hard-wearing steel that will not flex or breakaway, but stay strong through repetitive use.

## SPALDING® POSITIVE LOCK BREAKAWAY GOALS

### ARENA® 180 GOAL

- High performance goal with 180-degree positive lock break away action for professional and collegiate play
- Factory calibrated breakaway meets NBA® rebound elasticity requirements
- Compatible with main court portables only
- Padded cover plate with upper and lower finger guard made of dense foam & rubber to prevent pinching
- Sound reducing padded cover plate
- Anti-whip net and mounting hardware included
- Seven-year warranty

413-583 Arena® 180 Goal w/5" x 4" Mounting Pattern



OFFICIAL GOAL OF THE NBA®

### SLAM-DUNK® GOAL

- High performance positive lock breakaway goal for collegiate play
- Factory calibrated breakaway meets the highest level of rebound elasticity requirements
- Universal mounting pattern is compatible with 48" and 42" backboards
- Anti-whip net and mounting hardware included
- Seven-year warranty

411-704 Slam-Dunk® Pro Goal w/Universal Mounting Pattern (Easy Glide #2 net system)

411-705 Slam-Dunk® Goal w/Universal Mounting Pattern (Ram Horn net system)



 EASY GLIDE NET SYSTEM



411-705  
RAM HORN NET SYSTEM

### SLAMMER COMPETITOR GOAL &

- Performance positive lock breakaway goal for high school and recreational play
- Universal mounting pattern is compatible with 48" and 42" backboards
- Standard net and mounting hardware included
- Two-year warranty

411-508 Slammer Competitor Goal w/Universal Mounting Pattern (Ram Horn net system)

411-528 Slammer Competitor Goal w/Universal Mounting Pattern (Easy Glide #2 net system)



 RAM HORN NET SYSTEM



411-528  
EASY GLIDE NET SYSTEM

## SPALDING® FLEX BREAKAWAY GOALS



MADE IN  
USA

OFFICIAL GOAL OF THE  
2013 NCAA® MEN'S &  
WOMEN'S FINAL FOUR™

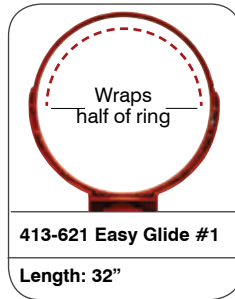

### SLAM-DUNK® PRECISION 180 GOAL

- Official goal of the 2013 Men's and Women's Final Four™
- High performance goal with 180-degree flex breakaway action for collegiate play
- Adjustable reflex mechanism maintains NCAA® rebound elasticity requirements
- Easy Glide #2 is only 32" long and covers the front half of the rim
- Meets NCAA® & NFHS specifications
- Anti-whip net and mounting hardware included
- Seven-year warranty

413-577 Slam-Dunk® Precision 180 Goal w/5" x 5" Mounting Pattern  
413-574 Slam-Dunk® Precision 180sb Goal w/5" x 4" Mounting Pattern



### SLAMMER COMPETITION 180 GOAL

- Performance goal with 180-degree flex breakaway action for recreational play
- Meets NFHS Specifications
- Universal mounting pattern is compatible with 48" and 42" backboards
- Anti-whip net and mounting hardware included
- Two-year warranty

411-723 Slammer Competition 180 Goal Universal Mounting Pattern

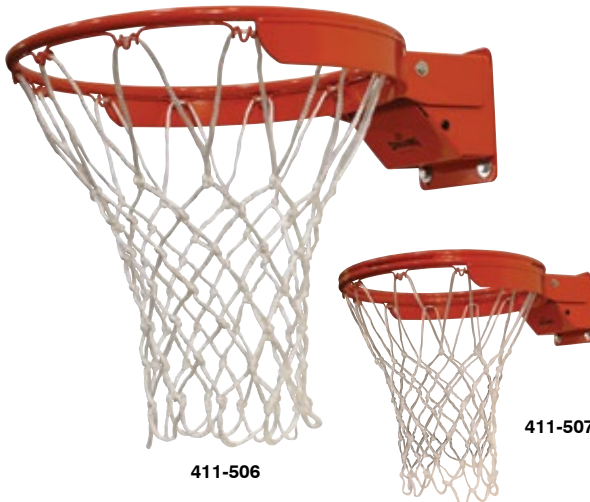

### SLAMMER FLEX GOAL

- Flex breakaway goal for recreational play
- Continuous ram horn net system
- Universal mounting pattern is compatible with 48" and 42" backboards
- Standard net and mounting hardware included
- One-year warranty

411-506 Slammer Flex Goal w/Universal Mounting Pattern

411-507 Slammer Flex Goal w/Universal Mounting Pattern II

- Same features as the Slammer Flex, but with a double ring configuration

## SPALDING® FIXED GOALS

### ROUGHNECK GORILLA GOAL &

- Fixed goal for aggressive play
- 5/8" diameter support arm for superior strength
- T-Tie net attachments for forceful impacts
- Universal mounting pattern is compatible with 48" and 42" backboards
- Nylon net and mounting hardware included
- Unconditional lifetime warranty

**411-556** Roughneck Gorilla Goal w/Universal Mounting Pattern

**411-557** Roughneck Gorilla Goal II w/Universal Mounting Pattern

- Same features as the Roughneck, but with a double ring configuration



**ROUGHNECK GORILLA GOAL II** 

### SUPER GOAL &

- Fixed goal for playground use
- 5/8" diameter support arm for superior strength
- Continuous ram horn net system
- Universal mounting pattern is compatible with 48" and 42" backboards
- Nylon net and mounting hardware included
- One-year warranty

**411-551** Super Goal Universal Mounting Pattern

**411-553** Super Goal II w/Universal Mounting Pattern

- Same features as the Super Goal, but with a double ring configuration



**SUPER GOAL II** 

### HERCULES® &

- Rear mount fixed goal for recreational play
- Fits most rear mount boards
- Continuous ram horn net system
- Universal mounting pattern is compatible with 48" and 42" backboards
- Nylon net and mounting hardware included
- Two-year warranty

**411-554** Hercules® w/Universal Mounting Pattern

**411-552** Hercules® II w/Universal Mounting Pattern

- Same features as the Hercules, but with a double ring configuration



**HERCULES® II** 

Residential nets available on page 50 

## FEATURES

5/16" ALUMINUM FRAME FITTED WITH SHOCK  
ABSORBING MATERIAL TO THE GLASS

FOUR 3/16" THICK KEY HOLE  
BRACKETS IN THE CORNERS  
FOR MOUNTING

1/2" TEMPERED GLASS

2" BORDER AND TARGET ARE  
FIRED INTO THE GLASS FOR  
LIFETIME LASTING FINISH

MOUNTING  
PLATE TO  
ATTACH  
GOAL - See  
board for specific  
mounting pattern

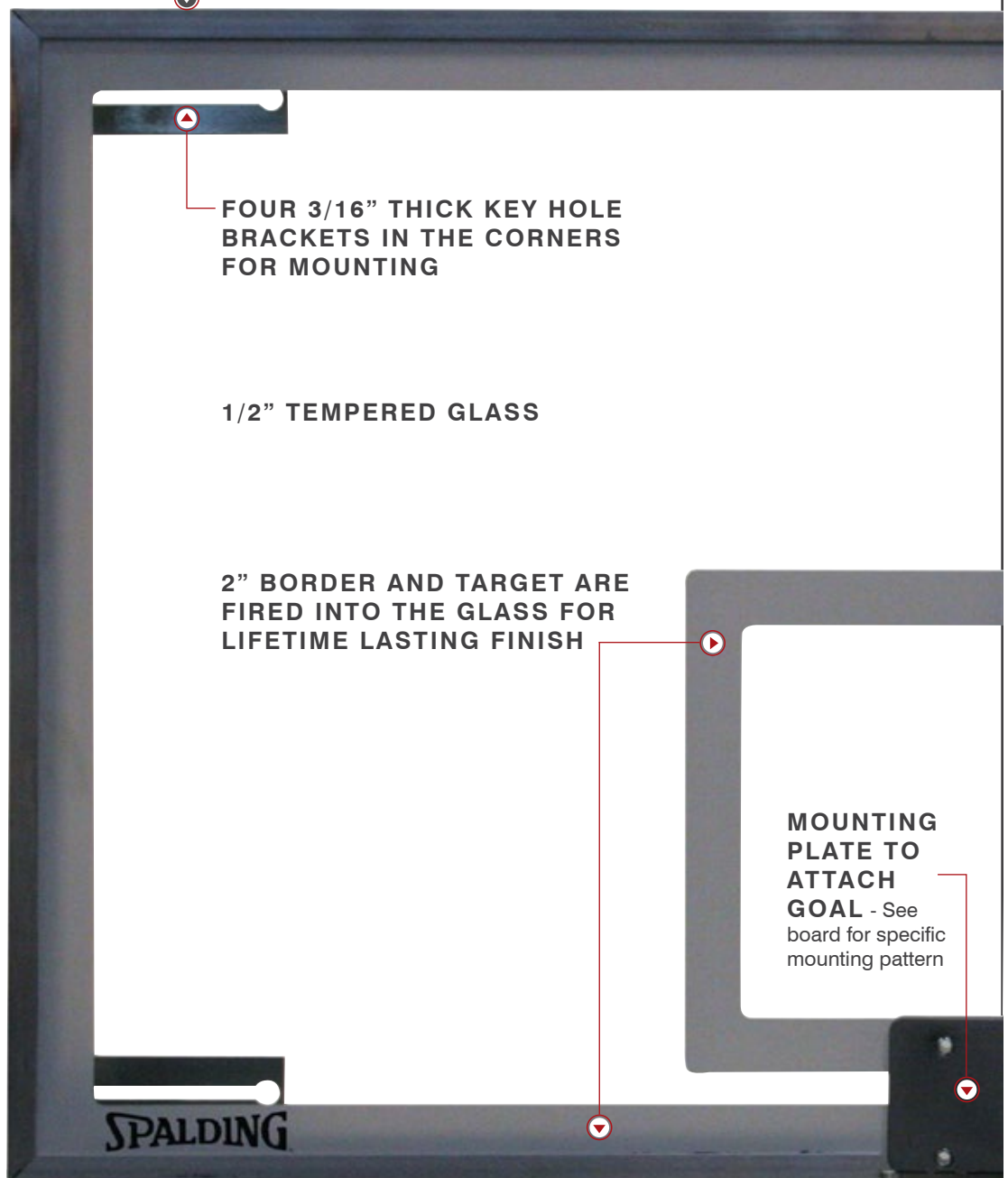



# SPALDING® GLASS BACKBOARDS

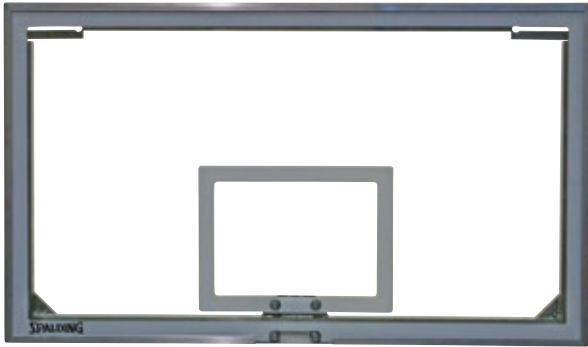

Official Backboard of the NBA®

## ARENA® BACKBOARD

- Direct goal mount designed to prevent the goal from touching the glass
- Compatible with main court portable backstops
- Meets all FIBA, NCAA®, and NFHS specifications
- Unconditional Lifetime warranty (outdoor use is not covered)
- Goal mounting pattern: 5" x 4"
- Backboard mounting pattern: 36" x 63"

**N413-002** Arena® Backboard 72" x 42"



Official Backboard of the 2013 NCAA® Men's and Women's Final Four™

## SUPERGLASS™ PRO BACKBOARD

- Regulation glass backboard for professional, collegiate and international competition
- Direct goal mount designed to prevent the goal from touching the glass
- Compatible with Wall-Braced, Ceiling-Suspended, and Portable units
- Meets all FIBA, NCAA®, and NFHS specifications
- Unconditional Lifetime warranty (outdoor use is not covered)
- Goal mounting pattern: 5" x 4"
- Backboard mounting pattern: 42" x 63"

**413-000** SuperGlass™ Pro Backboard 72" x 48"

**413-001** SuperGlass™ Prosb Backboard 72" x 42"

**413-002** SuperGlass™ Prosb Backboard 72" x 42" for portables



### 3" STRONGBACK

The Arena® Backboard comes standard with a full perimeter strongback. This 3" channel stiffens the backboard.



### 3" STRONGBACK

The SuperGlass™ Pro Backboard comes standard with strongback. This 3" channel stiffens the backboard.

SPALDING® GLASS BACKBOARDS



SuperGlass™ Collegiate Backboard with Center Strut 72" x 42"

### SUPERGLASS™ COLLEGIATESB & BACKBOARD WITH CENTER STRUT

- Regulation glass backboard for collegiate and high school competition
- Compatible with most existing wall mount and ceiling mount structures
- Four corner mount with center strut rim support
- Meets NCAA® and NFHS specifications
- Goal mounting pattern: 5" x 4"
- Backboard mounting pattern: 36" x 63"
- Twenty year warranty; outdoor use is not covered

**413-011** SuperGlass™ Collegiatesb with center strut 72" x 42"



SuperGlass™ Collegiatesb Backboard 72" x 42"

### SUPERGLASS™ COLLEGIATE & BACKBOARD

- Regulation glass backboard for collegiate and high school competition
- Compatible with single mast ceiling suspended units
- Mounting bracket purchase may be required
- Meets NCAA® and NFHS specifications
- Lifetime warranty for direct mount; outdoor use is not covered
- Goal mounting pattern: 411-007 - 5" x 4"  
411-008 - 5" x 5"
- Backboard mounting pattern: 411-007 - 36" x 63"  
411-008 - 42" x 68"

**411-007** SuperGlass™ Collegiatesb Backboard 72" x 42"

**411-008** SuperGlass™ Collegiate Backboard 72" x 48"

### SUPERGLASS™ CONVERSIONSB & BACKBOARD

- High performance glass backboard for collegiate and high school play
- Meets NFHS Specifications
- Built-in adapter frame for upgrading from Fan Shaped to Rectangular Glass Backboard
- Goal mounting pattern: 5" x 4"
- Backboard mounting pattern: 35" x 20"
- Pre-drilled aluminum frame for bolt-on backboard padding
- Twenty-year warranty

**413-019** SuperGlass™ Conversionsb Backboard 72" x 42"



See page 10 for mounting diagrams

# SPALDING® GLASS BACKBOARDS & E-Z BOLT PADDING

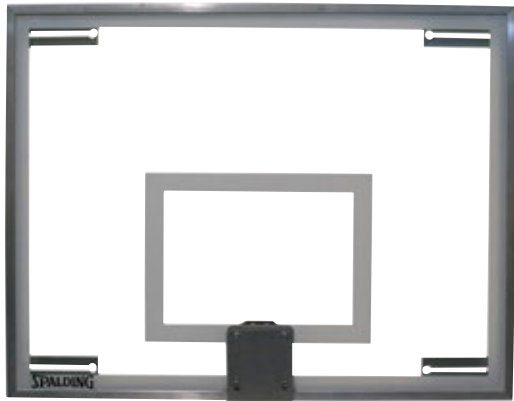

## BANTAM BACKBOARD

- Smaller backboard for practice and recreational play, forcing players to focus on target area
- Includes rim restainer
- Goal mounting pattern: 5" x 5"
- Backboard mounting pattern: 44 1/2" x 36"
- Ten-year warranty

**413-030** Bantam Backboard 54" x 42"

## E-Z BOLT PADDING FOR 72" RECTANGULAR BACKBOARDS



- Bolt-on backboard padding for 72" rectangular backboards
- Constructed of molded urethane with 2 1/4" wide channel
- Meets NBA®, NCAA®, FIBA and NFHS specifications
- Eight bolts for easy attachment to 72" glass backboards
- Sold as a set that will fit on one 72" glass backboard
- Five-year warranty
- 12 color options available



**Note:** Colors shown in catalog and on website may not be an exact match.



<b>COLORS</b>	<b>GOLD</b> 413-413	<b>ORANGE</b> 413-412	<b>RED</b> 413-411	<b>KELLY GREEN</b> 413-415
	<b>FOREST GREEN</b> 413-416	<b>LIGHT BLUE</b> 413-417	<b>ROYAL BLUE</b> 413-418	<b>NAVY BLUE</b> 413-419
	<b>PURPLE</b> 413-420	<b>MAROON</b> 413-410	<b>GRAY</b> 413-414	<b>BLACK</b> 413-421

SPALDING® GLASS BACKBOARDS & E-Z BOLT PADDING

SPALDING®  
NETS



**ARENA® NET**

- One-year warranty
- 413-625** Arena® Net - 7 oz. Heavy-Duty Nylon Net



**PINK ANTI-WHIP NET**

- One-year warranty
- 421-328** Pink Anti-Whip - 7 oz. Heavy-Duty Nylon Net



**SUPER NET**

- One-year warranty
- 413-609** Super Net - 9 oz. Heavy-Duty Nylon Net



**STANDARD NET**

- One-year warranty
- 413-605** Standard Nylon Net - 5.6 oz.

GOAL MOUNTING  
PATTERNS

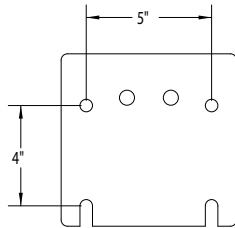

**S411-583** Arena® 180 Goal

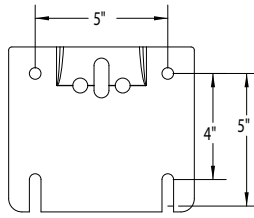

**411-704** Slam-Dunk® Pro Goal  
**411-705** Slam-Dunk® Goal  
**411-723** Slammer Competition 180 Goal

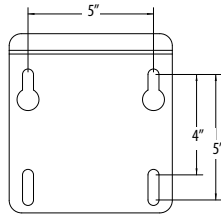

**411-508** Slammer Competitor Goal  
**411-528** Slammer Competitor Goal  
**411-506** Slammer Flex Goal  
**411-507** Slammer Flex Goal II

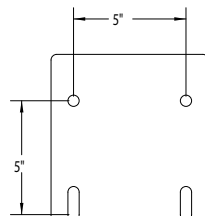

**411-577** Slam-Dunk® Precision 180 Goal

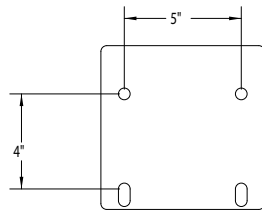

**411-574** Slam-Dunk® Precision 180sb Goal

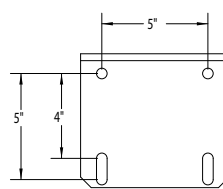

**411-556** Roughneck Gorilla Goal  
**411-557** Roughneck Gorilla Goal II

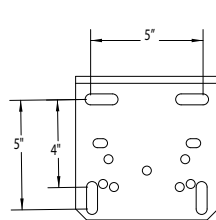

**411-551** Super Goal  
**411-553** Super Goal II

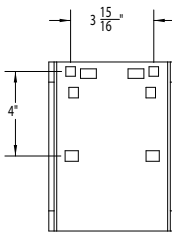

**411-554** Hercules®  
**411-552** Hercules® II

BACKBOARD MOUNTING  
PATTERNS

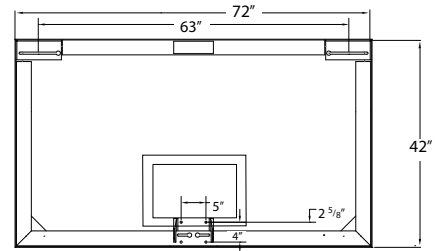

**N413-002** Arena® Backboard 72" x 42"

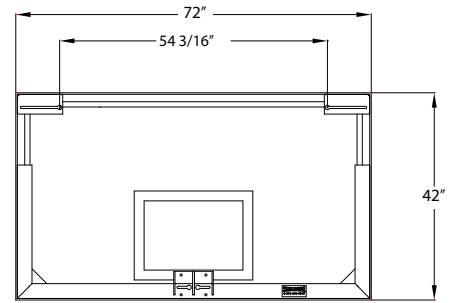

**413-001** SuperGlass™ Prosb Backboard 72" x 42"

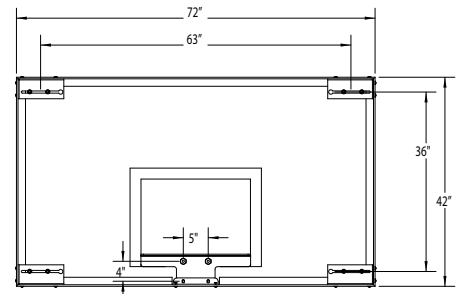

**413-007** SuperGlass™ Collegiatesb Backboard 72" x 42"

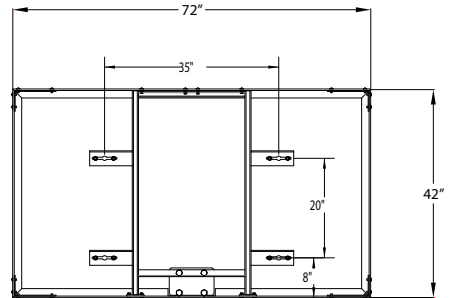

**413-019** SuperGlass™ Conversionsb Backboard 72" x 42"

# SPALDING® CUSTOMIZE YOUR BACKBOARD PACKAGE

**BUILD IT:** CHOOSE YOUR BACKBOARD, GOAL & PADDING

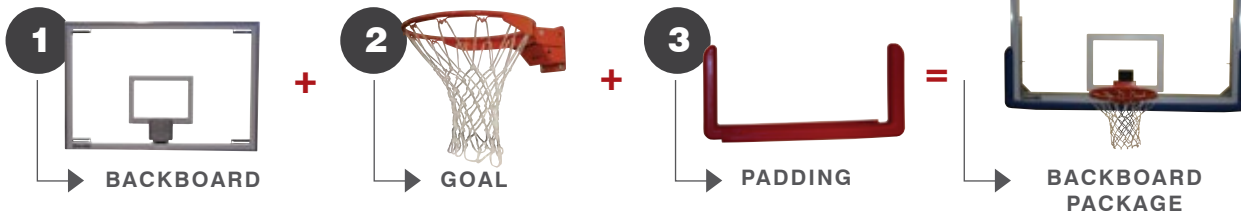

## 1. CHOOSE YOUR BACKBOARD



- **413-000** SuperGlass™ Pro Backboard 72" x 48"
- **413-001** SuperGlass™ Prosb Backboard 72" x 42"



- **413-011** SuperGlass™ Collegiatesb with center strut Backboard 72" x 42"



- **411-008** SuperGlass™ Collegiate Backboard 72" x 48"
- **411-007** SuperGlass™ Collegiatesb Backboard 72" x 42"



- **413-019** SuperGlass™ Conversionsb Backboard 72" x 42"

## 2. CHOOSE YOUR GOAL



- **411-704** Slam-Dunk® Pro Goal w/ Universal Mounting Pattern
- **411-705** Slam-Dunk® Goal w/ Universal Mounting Pattern



- **413-577** Slam-Dunk® Precision 180 Goal - not compatible w/42" boards
- **413-574** Slam-Dunk® Precision 180sb - not compatible w/48" boards



- **411-508** Slammer Competitor - Ram Horn w/ Universal Mounting Pattern
- **411-528** Slammer Competitor Goal - Tube Tie w/ Universal Mounting Pattern



- **411-723** Slammer Competition 180 Goal w/ Universal Mounting Pattern

## 3. CHOOSE YOUR PADDING

- 12 color options available
- Bolt-on backboard padding for 72" rectangular backboards



COLORS	GOLD 413-413	ORANGE 413-412	RED 413-411	KELLY GREEN 413-415
	FOREST GREEN 413-416	LIGHT BLUE 413-417	ROYAL BLUE 413-418	NAVY BLUE 413-419
	PURPLE 413-420	MAROON 413-410	GRAY 413-414	BLACK 413-421

**Note:** Colors shown in catalog and on website may not be an exact match.



**STEELSB BACKBOARD**  
72" x 42"



**STEEL FRONT MOUNT FAN BACKBOARD**  
54" x 39"



**FIBERGLASSSB BACKBOARD**  
72" x 42"



**FIBERGLASSSB FAN BACKBOARD**  
54" x 39"

### STEEL BACKBOARD

- Regulation-size steel backboard for indoor/outdoor play
- White electrostatic powder coated with graffiti resistant finish
- Backboard mounting pattern: 63" x 36"
- Goal mounting pattern: 5" x 4"
- One-year warranty; Lifetime warranty on direct mounts

**413-062** Steelsb Backboard 72" x 42"

### STEEL FRONT MOUNT FAN BACKBOARD

- Regulation-size steel fan backboard for indoor/outdoor play
- Reinforced with horizontal channels designed for vibration-free action
- Vertical strongback that strengthens the critical rim area
- Specially designed bolt keeper system allows for easy installation
- Recommended for direct mount with gooseneck poles
- Backboard mounting pattern: 35" x 20"
- Goal mounting pattern: 5" x 5"
- One-year warranty; Lifetime warranty on direct mounts

**413-208** Steel Front Mount Fan Backboard 54" x 39" w/orange target

### FIBERGLASS BACKBOARD

- Regulation-size fiberglass backboard for indoor/outdoor play
- 1 1/8" thick high density thermally fused panel
- Three layers of fiberglass on the face and two layers on the back
- Hand laminated for added strength
- Gel Coat sealant provides a moisture-resistant barrier
- Backboard mounting pattern: 63" x 36"
- Goal mounting pattern: 5" x 4"
- Ten-year warranty: outdoor; Lifetime warranty on direct mounts for indoor use

**413-051** Fiberglasssb Backboard 72" x 42"

### FIBERGLASS FAN BACKBOARD

- Backboard mounting pattern: 31 1/2" top / 37" bottom x 20"
- Goal mounting pattern: 5" x 5"
- One-year warranty; Lifetime warranty on direct mounts

**413-230** Fiberglasssb Fan Backboard 54" x 39"

# SPALDING® OUTDOOR BASKETBALL POLES

## GOOSENECK POLE

- Galvanized gooseneck poles available in 3 1/2", 4 1/2", or 5 9/16" O.D.
- Available in 3', 4', 5', and 6' extensions
- Lifetime warranty
- Sleeve not included - order separately for non-permanent installation

### 402-801 3 1/2" O.D. Pole with 3' extension

- 402-815 sleeve for 402-801

### 402-800 4 1/2" O.D. Pole with 4' extension

- 402-816 sleeve for 402-800

### 402-822 4 1/2" O.D. Pole with 5' extension

- 402-816 sleeve for 402-822

### 402-835 5 9/16" O.D. Pole with 6' extension



BOARD AND RIM NOT INCLUDED

SPALDING® OUTDOOR BASKETBALL POLES

	402-801 Outdoor Pole 3 1/2" O.D. 3' Ext.	402-800 Outdoor Pole 4 1/2" O.D. 4' Ext.	402-822 Outdoor Pole 4 1/2" O.D. 5' Ext.	402-835 Outdoor Pole 5 9/16" O.D. 6' Ext.
<b>BACKBOARDS</b>				
413-051 - Fiberglass Backboard	No	No	No	No
413-062 - Steel Backboard	No	No	No	No
413-208 - Steel Front Mount Fan w/ Target	Yes	Yes	Yes	Yes
413-230 - Fiberglass Fan	Yes	Yes	Yes	Yes
413-041 - Fiberglass Backboard	No	No	No	No
413-222 - Aluminum Fan Powder Coated w/ Target	Yes	Yes	Yes	Yes
<b>GOALS</b>				
411-556 - Roughneck Gorilla Goal	Yes	Yes	Yes	Yes
411-557 - Roughneck Gorilla Goal II	Yes	Yes	Yes	Yes
411-551 - Super Goal	Yes	Yes	Yes	Yes
411-553 - Super Goal II	Yes	Yes	Yes	Yes
<b>SLEEVES</b>				
402-815 - In-Ground Sleeve (3 1/2" O.D.)	Yes	No	No	No
402-816 - In-Ground Sleeve (4 1/2" O.D.)	No	Yes	No	No
402-837 - In-Ground Sleeve (5 9/16" O.D.)	No	No	No	Yes

\* Galvanized gooseneck pole  
\* Unconditional lifetime warranty

\* Systems are listed in price list



Board & Rim Not Included

**DOMINATOR POLE**

- Pole is 6" square
- 4' of run-out room from backboard to pole
- Black powder coated finish
- Unconditional lifetime warranty
- Sleeve not included - Order separately for non-permanent installation

**402-797** Dominator Pole  
**402-820** Sleeve for Dominator Pole



Board & Rim Not Included

**ENFORCER POLE**

- 6 5/8" O.D. galvanized steel pole
- 6' of run-out room from backboard to pole
- Unconditional lifetime warranty
- Sleeve not included - Order separately for non-permanent installation

**402-807** Enforcer Pole  
**402-824** Sleeve for Enforcer Pole

SPALDING® OUTDOOR BASKETBALL POLES

	402-797 Dominator Outdoor Pole	402-807 Enforcer Outdoor Pole
<b>BACKBOARDS</b>	6" Square Tube. - 4' Ext.	6 5/8" O.D. - 6' Ext.
413-051 - Fiberglass <b>sb</b> Backboard	Yes	Yes
413-062 - Steels <b>sb</b> Backboard	Yes	Yes
413-230 - Fiberglass Fan	No	No
413-041 - Fiberesins <b>sb</b> Backboard	Yes	Yes
413-222 - Aluminum Fan Powder Coated w/ Target	No	No
<b>GOALS</b>		
411-556 - Roughneck Gorilla Goal	Yes	Yes
411-557 - Roughneck Gorilla Goal II	Yes	Yes
411-551 - Super Goal	Yes	Yes
411-553 - Super Goal II	Yes	Yes
<b>SLEEVES</b>		
402-820 - In-Ground Sleeve (Dominator)	Yes	No
402-824 - In-Ground Sleeve (Enforcer)	No	Yes



## SPALDING® PORTABLE BACKSTOPS



### ARENA® BACKSTOP FEATURES: & &

- Available in 10' 8" and 8' extensions to meet all professional, collegiate, high school and international specifications
- Auto Lift Mechanism (ALM) system for one step set-up without tools
- SuperGlass™ Prosb Backboard (42" x 72") with unconditional lifetime warranty
- Slam-Dunk® Precision 180sb Goal with unconditional 7-year warranty
- 4" thick protective padding covered in 30 oz. vinyl
- Electrostatic powder coated finish available in custom colors
- Rolls on six - 6" x 2" casters for maximum load dispersion
- Counterweight of 1500 to 2000 lbs. for superior stability
- Floor anchor system compatible with all surfaces
- Shot clock holder with wiring and logo pads sold separately
- E-Z Bolt Backboard padding available in 12 color options (see pg 9)

### ARENA® BACKSTOP – SPRING ASSIST

- Spring assisted lifting mechanism
- Positive lock at 8', 9' and 10' playing heights

**401-990** Arena® Backstop–Spring Assist with 10' 8" extension

**401-980** Arena® Backstop–Spring Assist with 8' extension

**401-946** Arena® Backstop–Spring Assist with Jack for 10' 8" extension

**401-944** Arena® Backstop–Spring Assist with Jack 8' extension

- **See page 17 for technical drawings**

### ARENA® BACKSTOP – ELECTRIC

- Quickly raise and lower the unit with custom high-torque DC electric motor, coupled with a massive 1 1/2" diameter lead screw
- System uses a standard, dedicated 110V 20 amp circuit
- Infinite height adjustment from 8' to 10' with visual height indicator

**401-890** Arena® Backstop with 10' 8" extension

**401-880** Arena® Backstop with 8' extension



**SPALDING**  
TRUE TO THE GAME™

SPALDING is the official supplier to:



OFFICIAL BACKSTOP of the National Basketball Association.



OFFICIAL BACKSTOP of the Women's National Basketball Association.



OFFICIAL BACKSTOP of the NBA Development League.



OFFICIAL BACKSTOP of the 2013 NBA® All-Star Game™.



OFFICIAL SUPPLIER OF BACKSTOP, BACKBOARD, AND GOAL EQUIPMENT of the 2013 NCAA® Men's & Women's Final Fours™.

The NCAA and Final Four are registered trademarks of the National Collegiate Athletic Association.



### G8 PORTABLE BACKSTOP

- Main court backstop for high school and intramural competition
- 8' distance from backboard to front pad at standard height  
Height adjustable: 6' - 10'
- Spring assisted lifting mechanism
- 3" thick padding covered in 30oz. vinyl
- White powder coated finish (custom colors available)
- 1,000 lbs. of ballast
- Rolls on eight - 6" x 2" urethane wheels for maximum load dispersion
- Shot clock holder with wiring, and logo pads sold separately
- System includes: SuperGlass™ Collegiatesb Backboard (42" x 72"); E-Z Bolt and base padding; floor anchor
- **Warranty:** Backstop and lifting mechanism, 10-year; SuperGlass™ Collegiatesb Backboard, twenty year or lifetime on direct mounts; Slam-Dunk® Precision 180sb Goal, 7-year; Backboard padding, 5-year

401-975 G8 Portable Backstop

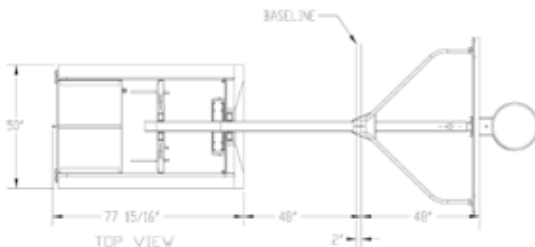

G8 PORTABLE - 8' EXTENSION FOOTPRINT



### G5 PORTABLE BACKSTOP

- Side court backstop for college and professional practice
- 5' distance from backboard to front pad at standard height  
Height adjustable: 6' - 10'
- Spring assisted lifting mechanism
- 3" thick padding covered in 30oz. vinyl
- White powder coated finish (custom colors available)
- 960 lbs. of ballast
- Rolls on eight - 6" x 2" urethane wheels for maximum load dispersion
- Shot clock holder with wiring, and logo pads sold separately
- System includes: SuperGlass™ Collegiatesb Backboard (42" x 72"); backboard and base padding; floor anchor
- **Warranty:** Backstop and lifting mechanism, 10-year; SuperGlass™ Collegiatesb Backboard, twenty year or lifetime on direct mounts; Slam-Dunk® Precision 180sb Goal, 7-year; Backboard padding, 5-year

401-970 G5 Portable Backstop

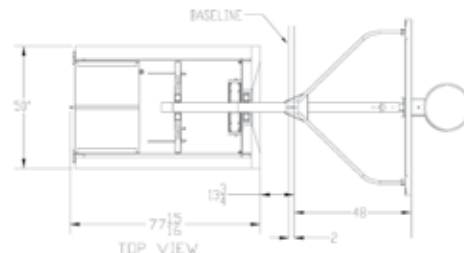

G5 PORTABLE - 5' EXTENSION FOOTPRINT

- See page 17 for technical drawings

# SPALDING® PORTABLE BACKSTOP SPECS

SPALDING® PORTABLE BACKSTOPS SPECS

## ARENA® BACKSTOP – SPRING ASSIST

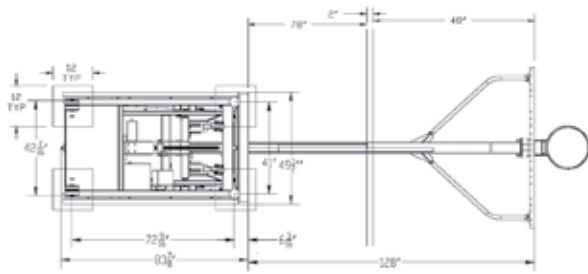

**ARENA® BACKSTOP - 10' 8" EXTENSION FOOTPRINT**

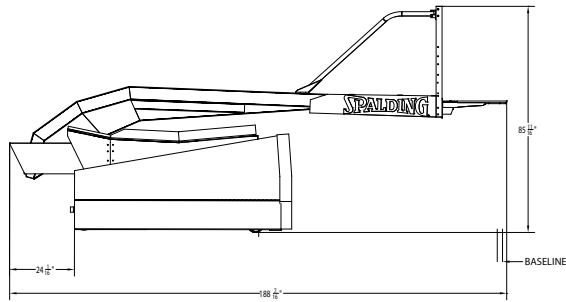

**ARENA® BACKSTOP - SPRING ASSIST**  
storage dimensions: 188 7/16" long x 85 11/16" high x 76" wide

## ARENA® BACKSTOP – ELECTRIC

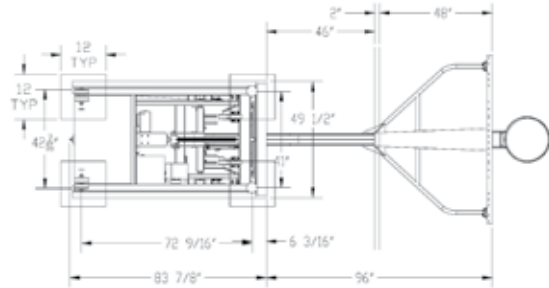

**ARENA® BACKSTOP - 8' EXTENSION FOOTPRINT**

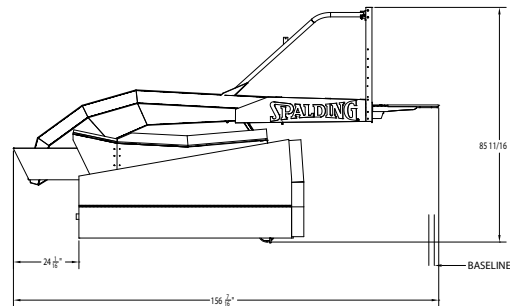

**ARENA® BACKSTOP - ELECTRIC**  
storage dimensions: 156 7/16" long x 85 11/16" high x 76" wide

## G8 PORTABLE BACKSTOP

**G8 Backstop**  
401-975

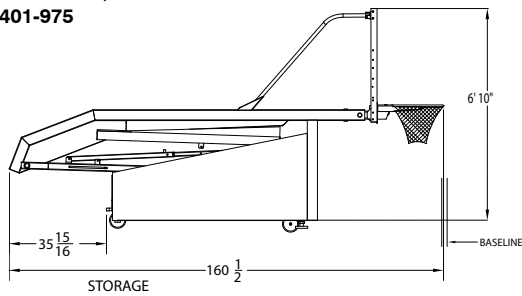

**G8 PORTABLE BACKSTOP**  
storage dimensions: 160 1/2" long x 6' 10" high x 76" wide

## G5 PORTABLE BACKSTOP

**G5 Backstop**  
401-970

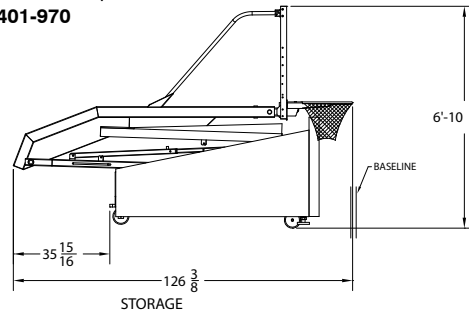

**G5 PORTABLE BACKSTOP**  
storage dimensions: 126 3/8" long x 6' 10" high x 76" wide

### 2500 PORTABLE BACKSTOP

- New portable backstop designed with a smaller base to hold a full-size glass backboard for use at colleges, schools and churches
- 72" x 42" high performance, aluminum framed glass backboard (413-012)
- Backboard is made of ½" tempered glass
- Slammer Competitor Goal (411-528)
- Extension arm provides 5' of offset at 10' goal height
- Spring assisted one lever height adjustment (no tools needed)
- Goal height is adjustable from 8' to 10'
- White powder coat finish
- Will fit through standard double door with backboard lowered
- Rolls on four - 4" wheels rated for 600 lbs. each
- Multi-piece base padding included (black only)
- Backstop contains 1,000 lbs. of ballast
- Indoor anchor kit
- **Warranty:** Backstop frame, 10-year; Telescoping brace, 2-year; Floor pedestals, 2-year; Backboard, twenty year or lifetime on direct mounts; Slammer Competitor Goal, 2-year

401-879 2500 Portable Backstop



**SPALDING 2500**  
Portable Backstop

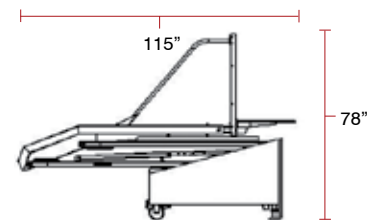

**SPALDING 2500 PORTABLE**  
storage dimensions: 115" long x 78"  
high x 72" wide

### 2000 PORTABLE BACKSTOP

- Versatile glass backboard portable basketball system for colleges, schools and churches
- 54" x 42" high performance, aluminum framed glass backboard (411-798)
- Backboard is made of ½" tempered glass
- Slammer Competitor Goal (411-528)
- Extension arm provides 5' of offset at 10' goal height
- Spring assisted one lever height adjustment (no tools needed)
- Goal height is adjustable from 7' 6" to 10'
- Will fit through standard double door with backboard lowered
- Rolls on four - 4" wheels rated for 600 lbs. each
- Multi-piece base padding included (black only)
- Backstop contains 725 lbs. of ballast
- **Warranty:** Backstop frame, 10-year; Telescoping brace, 2-year; Floor pedestals, 2-year; Backboard, 10-year; Slammer Competitor Goal, 2-year

411-800 2000 Portable Backstop



**SPALDING 2000**  
Portable Backstop

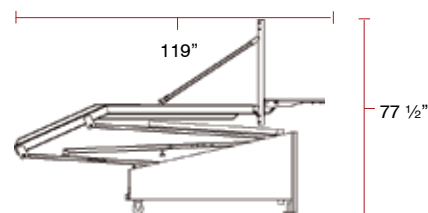

**SPALDING 2000 PORTABLE**  
storage dimensions: 119" long x 77  
½" high x 54" wide

## SPALDING® PORTABLE BACKSTOPS

411-790

**SPALDING STREET TOURNAMENT**  
Portable Backstop



### STREET TOURNAMENT PORTABLE BACKSTOP

- Designed for street tournament play
- Extension arm provides 3' of offset at 10' goal height
- 54" x 38" acrylic backboard with steel back framework
- Slammer Flex Goal included (411-506)
- Goal height is adjustable from 8' to 10'
- Backboard folds down for storage
- Base padding included (black)
- **Additional ballast weight required**—500 recommended lbs. (not included)
- One-year limited warranty

411-790 Street Tournament Portable Backstop

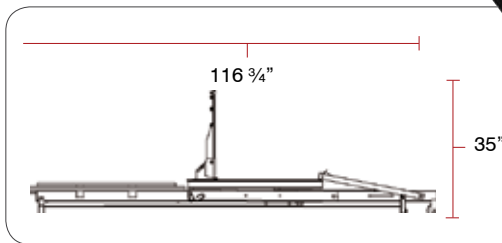

**SPALDING STREET TOURNAMENT**  
Portable storage dimensions:  
116 3/4" long x 35" high x 54" wide

**BALLAST PLATE**



411-870

**FASTBREAK 960**  
Portable Backstop



### FASTBREAK 960 PORTABLE BACKSTOP

- Designed for institutional use at high schools, camps, churches or health clubs
- 60" x 36" high performance, aluminum framed acrylic backboard
- Backboard is 3/8" thick acrylic for superior rebound
- Extension arm provides 6' of offset at 10' goal height
- Pro Image™ Breakaway Goal (411-511)
- Goal height is adjustable from 7' to 10'
- Easily folded by two people
- Multi-piece base padding included (black)
- **Additional ballast weight required**—refer to owners manual for recommended lbs.
- Two-year limited warranty

411-870 Fastbreak 960 Portable Backstop

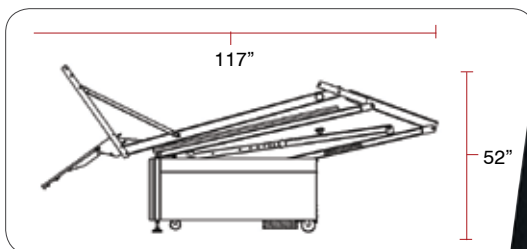

**FASTBREAK 960** Portable storage dimensions: 117" long x 52" high x 60" wide



**BALLAST STORAGE COMPARTMENT**

## SPALDING® PORTABLE BACKSTOPS

### FASTBREAK 940 PORTABLE BACKSTOP

- Designed for elementary schools, recreation centers, or as a superior home unit
- 54" x 32" high performance, aluminum framed acrylic backboard
- Backboard is  $\frac{3}{8}$ " thick acrylic for superior rebound
- Extension arm provides 6' of offset at 10' goal height
- Pro Image™ Breakaway Goal (411-511)
- Goal height is adjustable from 7' to 10'
- Backboard folds down for storage
- Multi-piece base padding included (black)
- **Additional ballast weight required**—refer to owners manual for recommended lbs.
- Two-year limited warranty

411-860 Fastbreak 940 Portable Backstop

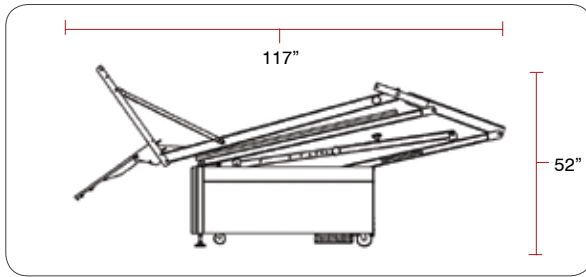

411-860

**FASTBREAK 940** Portable  
storage dimensions: 117"  
long x 49" high x 54" wide



**FASTBREAK 940**  
Portable Backstop

**BALLAST  
STORAGE  
COMPARTMENT**



### FASTBREAK 930 PORTABLE BACKSTOP

- Pole system and backboard tip back for easy movement on built-in wheels
- Quick set up and take down
- Arena Slam® Breakaway Goal
- Acrylic Backboard is 48" x 32"
- Telescoping poles easily adjust goal height from 7' to 10'
- All steel, welded construction
- Base has vinyl trim to avoid marring floors
- Includes full front padding (black)
- **Additional ballast required**—200 recommended lbs. (not included)
- Two-year limited warranty
- Base dimensions: 35  $\frac{1}{4}$ " x 19  $\frac{3}{4}$ " x 13  $\frac{1}{4}$ "

411-835 Fastbreak 930 Portable Backstop w/Acrylic Backboard

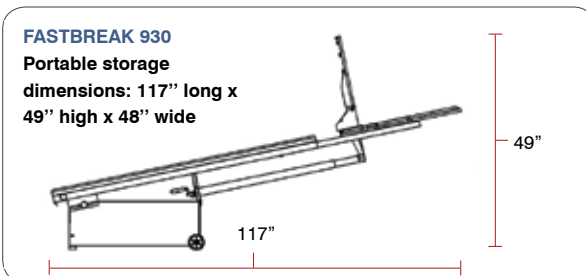

**FASTBREAK 930**

Portable storage  
dimensions: 117" long x  
49" high x 48" wide

**BALLAST STORAGE  
COMPARTMENT**



**FASTBREAK 930**  
Acrylic Backboard

411-835

## SPALDING® SCORER'S TABLES



### PORTABLE SCORER'S TABLE

- Heavy-duty folding table for courtside use
- Accommodates four chairs
- Solid steel welded construction
- Folds quickly for mobility and storage
- Built-in non-marking casters for easy transportation
- Access holes for routing cables
- UL electrical duplex outlet and extension
- Logo and/or school name - one color only for additional fee
- 18 oz. vinyl padding on visible sides (specify color)
- 8'4" x 36" x 34" unfolded for game use, 52" x 21 1/2" x 34" folded for storage
- 245 lbs. shipping weight on pallet, 52" x 36" x 24" shipping size

<b>COLORS</b>	<b>Red</b> 411-691	<b>Burgandy</b> 411-696	<b>Green</b> 411-694
	<b>Navy Blue</b> 411-693	<b>Royal Blue</b> 411-692	<b>AVAILABLE PADDING COLORS</b> - CONTACT THE FACTORY FOR DETAILS. <b>NOTE:</b> Colors shown in catalog and on website may not be an exact match. Please request a color swatch.
	<b>Purple</b> 411-695	<b>Black</b> 411-690	

### DIGITAL GRAPHIC SCORER'S TABLE

- Spalding's durable and convenient scorer's tables are now available with custom printed, full color padding
- All digital graphics are done using state-of-the-art, six-color large format printers
- Durable, vivid inks are designed to be long-lasting relative to the silk-screens and vinyl applications of the past
- Our lamination process decreases the likelihood of scratching as well as regular wear-and-tear from daily use
- 8'4" x 36" x 34" unfolded for game use, 52" x 21 1/2" x 34" folded for storage
- 245 lbs. shipping weight on pallet, 52" x 36" x 24" shipping size

**Please contact factory for additional information.**





### McCALL'S REBOUNDER

- Known as one of the best rebound skill builders on the market
- Sharpens players' rebounding skills
- Ideal tool for increasing grip strength and vertical leap
- Helps improve balance, timing and perception under the goal
- Adjustable from 7' to 12'
- Transports easily on built-in smooth rolling casters

411-621 McCall's Rebounder



### WHEELED BOUNCE BACK

- Net frame angles up or down for all types of return passes
- Skid-resistant wheels
- Heavy-duty net and bands
- $\frac{3}{16}$ " steel, rolling base with easy operating brake
- Net frame is removable in seconds without tools
- Single clamp height adjustment

411-624 Wheeled Bounce Back



### FOLDING BOUNCE BACK

- Net frame angles up or down for all types of return passes
- Heavy-duty net and bands
- Folds for compact storage
- Self standing
- Built-in weight tubes eliminate the need for weight bags

411-627 Folding Bounce Back



### PRACTICE SHOOTING RING

- Trains shooter to be more accurate on their shots
- Intended to improve athletes concentration and confidence when shooting
- Durable urethane mounts easily attach the shooting ring to the rim without harming it
- Attaches easily to regulation goals reducing target size from 18" to 16"
- Orange powder coat finish
- Three lb. shipping weight

411-610 Practice Shooting Ring



Rim not included



### REBOUND RING

- Develops rebounding skills
- Durable urethane mounts easily attach the ring to the rim without harming it
- 11" diameter ring installs easily over regulation goal
- Ball can go through ring, but helps teach position and rebounding
- Orange powder coat finish
- Three lb. shipping weight

411-611 Rebound Ring



Rim not included



## SPALDING® BALL RACKS



### NBA® BALL TRUCK

- Holds 18 full size basketballs
- Constructed of steel tubing with grey powder coat finish
- Includes swivel wheels
- Non-topple base
- Angled rails for easy ball removal

411-603 NBA Ball Truck



### REPLICA BALL TRUCK

- Holds 15 full size basketballs
- Constructed of durable chrome steel tubing
- Swivel casters
- Non-topple base
- Angled rails for easy ball removal

411-602 Replica Ball Truck



### ECONOMY BALL TRUCK

- Constructed of chrome steel tubing
- Swivel casters
- Non-topple base
- Holds up to 12 balls

411-600 Economy Ball Truck



### BALL LOCKER

- Constructed of welded steel
- Non-marring swivel casters
- Lockable
- Holds up to 30 balls

411-605 Ball Locker



### PUB TABLE

- 30" diameter commercial grade acrylic top with complete beveled edge
- 44" high, powder coated black, steel structure
- Regulation size goal
- Heavy duty white net
- Assembled dimensions 43" x 30" x 30"

421-354 Pub Table



### SPORT TABLE

- 24"L x 24"W x 24"H
- 24" Diameter acrylic table top
- Steel post and rim with net set on top of a wood base platform

411-355 Sport Table

**DIGITAL GRAPHIC WALL PADS** - All digital graphics are printed using state-of-the-art, six-color large format printers. Durable, vivid inks are designed to be long-lasting relative to the silk-screens and vinyl applications of the past. High resolution printing provides sharp image quality from any distance.

**CUSTOMIZATION MADE EASY**

- Any Spalding Wall Pad can be custom printed to match your logo and color scheme specifications
- Full color printing allows unlimited color options
- Artwork is printed directly onto vinyl covers and attached to backing material

Please contact the factory for ordering information and specifications on custom digital graphics.



**DIGITAL GRAPHIC WALL PADS**

**WALL MOUNTING ILLUSTRATIONS**

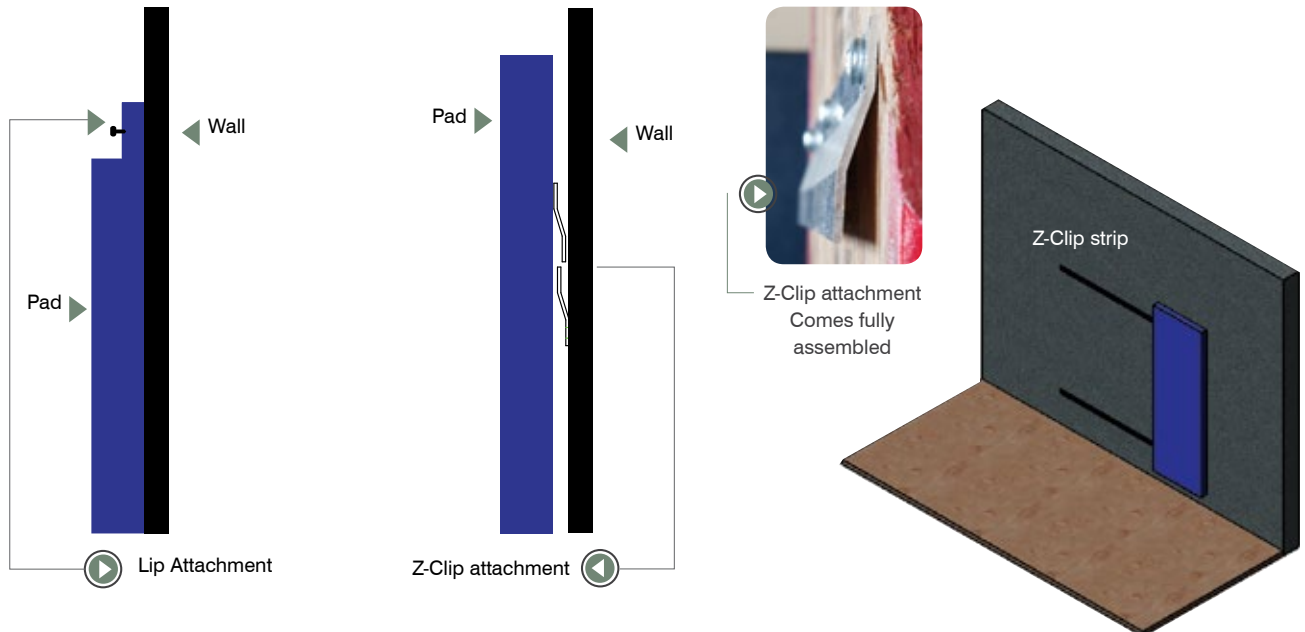

## SPALDING® PROTECTIVE WALL PADDING

### CLASS A FIRE WALL PADS

- 2 7/16" (62mm) thick protective wall padding that can be permanently installed or removable
- Constructed of 7/16" (11mm) O.S.B backing, 2" polychloroprene foam and 18 oz. vinyl cover
- Class A Fire Rating (meets ASTM E84 testing procedures)
- Standard wall pad size is 2' x 6'
- Choose from a variety of standard colors
- Vinyl cover meets National Fire Protection Standard 701, ASTM E-84 and CAL 117

Please contact Spalding for ordering information: 800.435.3865



Class A Fire Wall Pads

### 2" POLYURETHANE WALL PADS

- 2 7/16" (62mm) thick protective wall padding that can be permanently installed or removable
- Constructed of 7/16" (11mm) O.S.B backing, 2" 100 ILD polyurethane foam and 18 oz. vinyl cover
- Standard wall pad size is 2' x 6'
- Choose from a variety of standard colors
- Vinyl cover meets National Fire Protection Standard 701, ASTM E-84 and CAL 117

Please contact Spalding for ordering information: 800.435.3865



2" 100 ILD Polyurethane Wall Pads

### 2" LAMINATE

- 2 7/16" (62mm) thick protective wall padding that can be permanently installed or removable
- Constructed of 7/16" (11mm) O.S.B backing, 2" laminated polyethylene foam and 18 oz. vinyl cover
- Standard wall pad size is 2' x 6'
- Choose from a variety of standard colors
- Vinyl cover meets National Fire Protection Standard 701, ASTM E-84 and CAL 117

Please contact Spalding for ordering information: 800.435.3865



2" Laminate Wall Pads



#### SAFETY TIP:

Wall pads should be a minimum of 6" high and installed at a maximum of 6" above the finished floor.

## SPALDING® WALL-BRACED BACKSTOPS



WALL-BRACED STATIONARY BACKSTOP

### WALL-BRACED STATIONARY &

- Available in lengths of 8" to 13' from the wall (extensions more than 1'-6" require 1/4" steel cable – cable included)
- Structure is supported by 1/4" steel cable extending diagonally from the wall to the upper tubing using two cable clamps per attachment
- Four 2" square, steel tube cross braces and extension tubes construct the framework
- Pipe ends have 1/4" heavy-duty flange for attaching to 2" x 6" wall boards and the backboard
- Compatible with all backboards and height adjusters
- Black powder coated finish (custom colors available)
- Five-year warranty

Please see price list for part numbers.



WALL-BRACED SIDE FOLD BACKSTOP

### WALL-BRACED SIDE FOLD &

- Available in lengths of 3' to 13' from the wall (all extension lengths require 1/4" steel cable – cable included)
- Structure is supported by 1/4" steel cable extending diagonally from the wall to the upper tubing using two cable clamps per attachment
- Four 2" square, steel tube cross braces and extension tubes construct the framework
- Telescoping diagonal brace includes locking mechanism and adjustable collar allowing the structure to be precisely placed in playing position from the floor utilizing a factory furnished crank handle
- Off-set steel hinges with 1/4" heavy-duty flanges connect to 2" x 6" wall board and backboard locations to allow the unit to fold flat against the wall
- Compatible with all backboards and height adjusters
- Black powder coated finish (custom colors available)
- Five-year warranty

Please see price list for part numbers.



WALL-BRACED FOLD-UP BACKSTOP  
SHOWN WITH HEIGHT ADJUSTER

### WALL-BRACED FOLD-UP BACKSTOP &

- Available in lengths of 3' to 13' from the wall (all extension lengths require 1/4" steel cable – cable included)
- Four 2" square, steel tube braces and saddle-welded braces construct the framework
- Steel hinges with 1/4" heavy-duty flanges connect to 2" x 8" wall board and backboard locations
- Structure is supported by 1/4" steel cable extending diagonally from the wall to the upper piping using two cable clamps per attachment
- Backstop is raised by a 1,000lb manual winch (optional electric winch)
- Backstop lifts by a 1/4" steel cable running through a 3-1/2" diameter deep groove cable pulley that is on the upper wallboard
- Compatible with all backboards and height adjusters
- Black powder coated finish (custom colors available)
- Five-year warranty

Please see price list for part numbers.

## SPALDING® HEIGHT ADJUSTER

**SPALDING'S HELIX™ HEIGHT ADJUSTER HAS SPRING-LOADED TECHNOLOGY WHICH MAKES CHANGING YOUR PLAY HEIGHT A SLAM-DUNK!**

### SPALDING HELIX™ HEIGHT ADJUSTER

- Spring-loaded technology for easy height adjustment
- Infinite backboard adjustments between 8-10 feet on Wall-Braced and Ceiling-Suspended Backstops
- Compatible with 72" Rectangular Backboards on Single or Double Mast Backstops
- Constructed of 1-1/2" x 3" structural steel tubing
- Nylon Bushing help provides smooth movement with the same rigidity of a system without a height adjuster
- Heavy duty spring with PVC coating reduces noise
- Gray powder coated finish
- Includes Crank Handle with Hook
- One-year warranty

**313-382** Spalding Helix™ Height Adjuster



### SPALDING HELIX™ FAN HEIGHT ADJUSTER

- Spring-loaded technology for easy height adjustment
- Infinite backboard adjustment between 8-10 feet on Wall-Braced and Ceiling-Suspended Backstops
- Compatible with 20" x 35" mounting pattern for Fan or Conversion Backboards
- Constructed of 1-1/2" x 3" structural steel tubing
- Nylon Bushing help provides smooth movement with the same rigidity of a system without a height adjuster
- Heavy duty spring with PVC coating reduces noise
- Gray powder coated finish
- Includes Crank Handle with Hook
- One-year warranty

**313-384** Spalding Helix™ Fan Height Adjuster



**SPALDING® CEILING-SUSPENDED BACKSTOPS**

SPALDING® CEILING-SUSPENDED BACKSTOPS



**CEILING-SUSPENDED BACKSTOP**

- Vertical main mast consist of 6-5/8" O.D. x 10 gauge pipe sized tubing with 2" x 14 gauge square tubing sway braces to construct a solid frame work
- Our 4" top channel helps support the adjustable backstop hinge hangers which allow precise frame placement, leveling and alignment during installation
- Laboratory tested safety cables are placed at every connection point to help protect against personal injury and/or property damage
- Meets official NCAA® and NFHS Specifications
- Framework is adaptable to any configuration of Spalding backboard
- Five-year limited warranty on materials and workmanship

42" x 72" GLASS BACKBOARD

BREAKAWAY GOAL WITH DIRECT ATTACHMENT

E-2" BOLT BACKBOARD PADDING

## SPALDING® CEILING-SUSPENDED BACKSTOPS

Spalding offers numerous custom configurations of ceiling-suspended backstops to fit your needs. We use only the finest manufactured products to ensure you are getting the best product for your facility. Now all Spalding mechanized ceiling-suspended backstops shall be supplied with a LynRus Aut-O-Loc 2 safety strap.

All custom painted parts at Spalding are electrostatically powder coated. The powder coat process provides an extremely durable finish and is an environmentally friendly process. Spalding ceiling-suspended products are all made in the U.S.A and delivered to your facility fully packaged.

Our expert design team can deliver finished products to your facility in as little as two weeks and effectively coordinate all adjacent work including electrical, mechanical and court striping coordination. To complete your project, Spalding certified installers are available and offer a turn-key complete product. To find the right backstop for your facility or for more information on Spalding products, please visit our website [www.spaldingequipment.com](http://www.spaldingequipment.com) or email us at [Inquire@spaldingequipment.com](mailto:Inquire@spaldingequipment.com).

SPALDING® CEILING-SUSPENDED BACKSTOPS

### GLIDING REAR-BRACED CEILING MAST

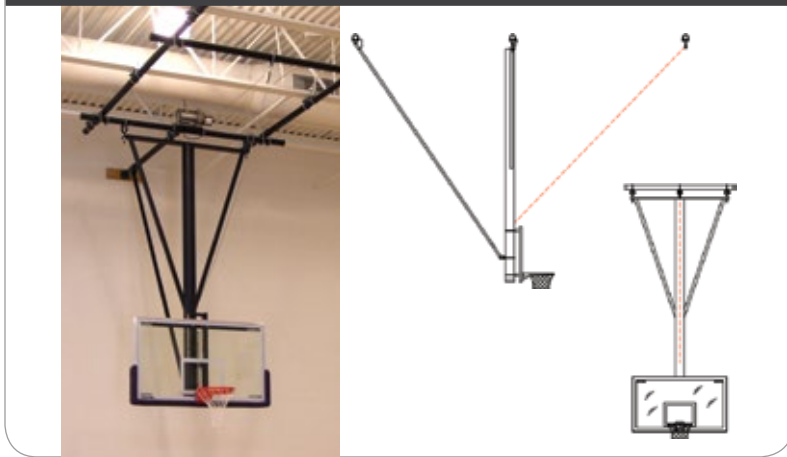

### GLIDING REAR-BRACED CEILING MAST

- All bracing hardware is on the rear of the mast for clean game play
- Best ceiling mast for maximum retraction height
- Unit is most stable from 16' attachment height to 40' attachment height
- Can easily be installed as a stationary mount unit
- Smooth forward fold unit

### ALL-PURPOSE CEILING MAST

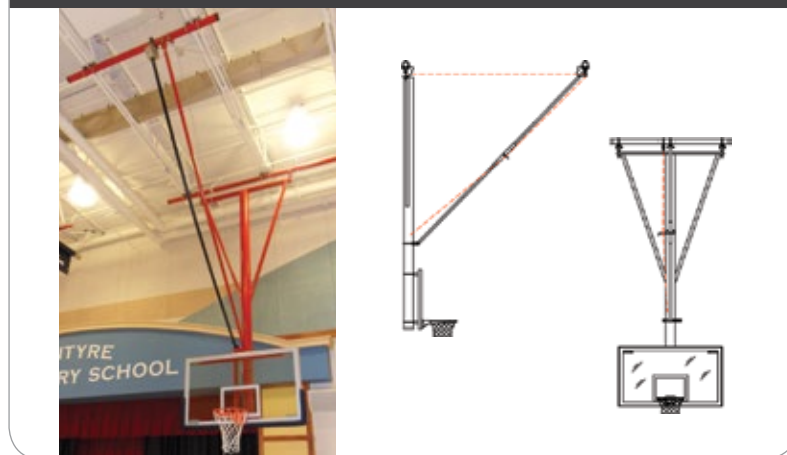

### ALL-PURPOSE CEILING MAST

- Unit has a minimal ceiling connection footprint
- Unit with best available space in front, back and side folding options
- Self-locking braces stores in itself in the same direction as the fold

### POWDER COAT COLORS



STANDARD POWDER COAT COLORS AT NO ADDITIONAL CHARGE - CONTACT THE FACTORY FOR CUSTOM OPTIONS.

**Note:** Colors shown in catalog and on website may not be an exact match.



### SAFETY

AT SPALDING, WE ENGINEER EACH CEILING-SUSPENDED BACKSTOP WITH SAFETY AS OUR NUMBER ONE PRIORITY. SAFETY CABLES PROVIDE

A COMFORTING BACK-UP TO THE HIGH QUALITY HARDWARE THAT WE PROVIDE.

## SPALDING® DIVIDER CURTAINS

Spalding divider curtains offer facilities a reliable and effective means of maximizing space. They are hand-crafted out of 18oz. reinforced vinyl for privacy and mesh to help with airflow. Our 18oz. vinyl comes in a variety of colors which meet the NFPA 701, ASTM E-84, CAL117, CA Prop 65 and CPSIA compliance. Spalding divider curtains are custom made for each installation so it is essential to consult your Spalding dealer in order to provide proper dimensions, fabric selections and other features to ensure all the components are included for an appropriate installation.

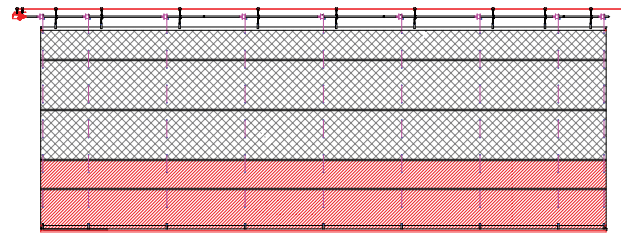
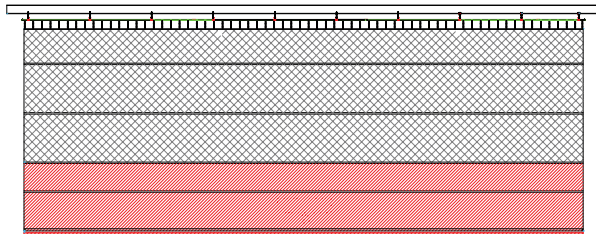
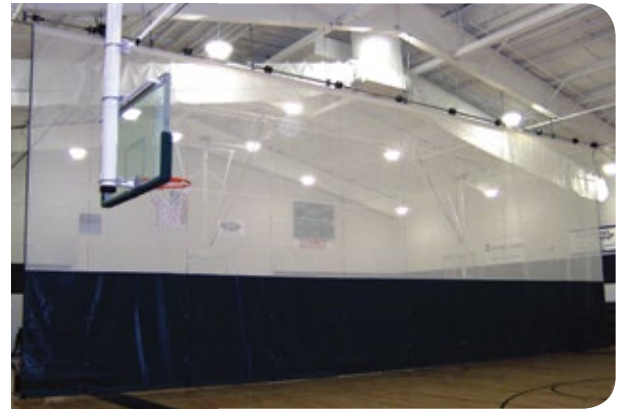

### WALK-DRAW

- The most cost effective way to divide your gym
- Best curtain option for maximum clearance on ceiling heights below 28'
- A 3" pocket lines the bottom edge of the curtain to accommodate the coil-proof chain as a weighted base
- Track is made from 16 gauge galvanized steel which holds trolley wheels for easy mobility
- Vinyl fabric lines the top edge of the curtain with grommets every 12" which attach to the carriers and s-hooks
- Storage space is 1/8" per foot of the curtain
- Curtain has 1" outer edges that are doubled to eliminate fraying
- Lower section of the curtain is constructed of a solid 18 oz. vinyl and the upper section made of a 9 oz. mesh with 2" welded seams while meeting the California State Fire Code
- One- year limited warranty on materials and workmanship

### FOLD UP

- Offers a clean way to divide your gymnasium into two useful areas
- Accordion folds are powered by 1/8" steel cables running through grommets vertically to a clean pocket at the bottom of the curtain with a weighted pipe
- Curtain has 1" outer edges that are doubled to eliminate fraying
- Cables wrap neatly on a 5" spool rotated by a 3/4 hp electric winch
- Lower section of the curtain is constructed of a solid 18 oz. vinyl and the upper section made of a 9 oz. mesh with 2" welded seams while meeting the California State Fire Code
- Strap connection to bottom batten tube to prevent sharp edges
- One- year limited warranty on materials and workmanship



# SPALDING® DIVIDER CURTAINS

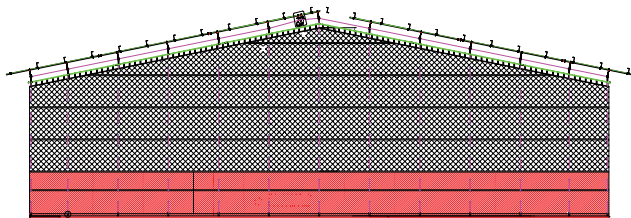

## SLOPE FOLD

- These custom curtains contour to the slope of your facility's roof line for maximum ceiling coverage
- Accordion folds are powered by 1/8" steel cables spaced every 9' running through grommets vertically and pass through overhead pulleys to a 3/4 hp electric winch
- Vinyl fabric lines the top edge of the curtain with grommets every 12". S-hooks attach to these grommets on the top of the curtain by a chain and carrier rollers that sit in a 16 gauge steel channel track for maximum clearance
- Lower section of the curtain is constructed of a solid 18 oz. vinyl and the upper section made of a 9 oz. mesh with 2" welded seams while meeting the California State Fire Code
- One- year limited warranty on materials and workmanship

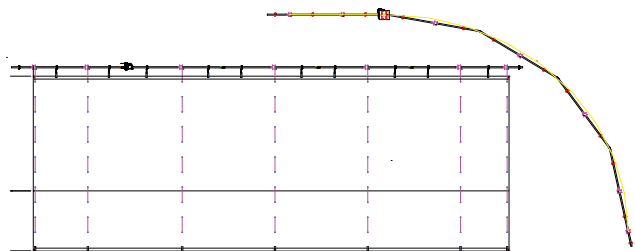

## RADIUS FOLD

- Separates an outer running track from the playing courts inside a multi-purpose facility
- Accordion folds are powered by 1/8" steel cables spaced every 12' running through grommets which are spaced 1' 6" vertically to a clean pocket at the bottom of the curtain with a weighted pipe
- Cables are attached to an angled drive pipe that rotates on roller brackets ran by a 3/4 hp electric winch to fold up the curtain
- The curtain radius should be greater than 20'
- Curtain has 1" outer edges that are doubled to eliminate fraying
- Strap connection to bottom batten tube to prevent sharp edges
- Lower section of the curtain is constructed of a solid 18 oz. vinyl and the upper section made of a 9 oz. mesh with 2" welded seams while meeting the California State Fire Code
- One- year limited warranty on materials and workmanship

SPALDING® DIVIDER CURTAINS

### AVAILABLE VINYL COLORS

CONTACT THE FACTORY FOR DETAILS.



\* ALL COLORS ARE CAL 117 NFPA 701 ASTM E84

### AVAILABLE MESH COLORS

CONTACT THE FACTORY FOR DETAILS.

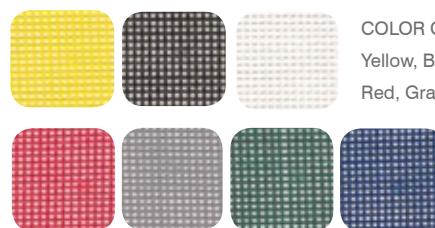

COLOR CHOICES:  
Yellow, Black, White  
Red, Gray, Green & Blue

**Note:** Colors shown in catalog and on website may not be an exact match.

### BATTING CAGE

- Designed for indoor use only
- Minimum ceiling height requirement of 17'
- Frame is constructed of 1 3/4" square x 14 gauge steel tubing
- Cage easily raises and lowers from the ceiling with a 3/4 hp electric motor
- Netting attaches easily to the frame with breech snaps
- Black net is made of a high strength polyethylene material
- Standard mesh size is 1 3/4" with 3/4" mesh available for golf
- Black powder coat finish

**417-278** Motorized Retractable 70' Cage (net not included)

**417-279** Motorized Retractable 55' Cage (net not included)

**417-386** 12' wide x 14' tall x 70' long Batting Cage Net Package

**417-387** 12' wide x 12' tall x 70' long Batting Cage net Package

**417-388** 12' wide x 14' tall x 55' long Batting Cage net Package

**417-389** 12' wide x 12' tall x 55' long Batting Cage net Package

**417-395** 12' wide x 14' tall x 70' long Golf Mesh Cage net Package

**Custom sizes, colors and nets available**

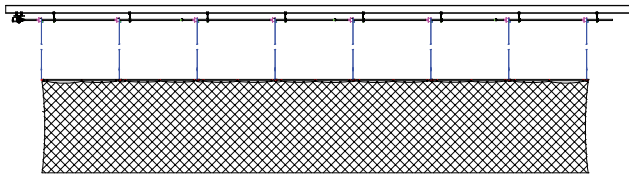



**LYNRUS AUT-O-LOC SAFETY BELT**

- Designed specifically for today's moving and folding backstops
- Lightweight - only 14 lbs. / 6.43kg
- Rated for a maximum of 1,000 lbs. / 453.51kg
- Fully automatic
- Spring loaded to retract up to 35 feet. Optional 45 foot / 13.7 meter lead belt is also available
- The inertia plate activates three separate pawls to minimize the shock and instantly stop the load before it gains momentum
- Five-year manufacturers warranty applies

**402-865** LynRus Aut-O-Loc Safety Belt for Backstops  
**401-875** Retractor Reel (not shown)



**LYNRUS QR4000 ELECTRIC WINCH**

- 115 volt, single phase, instantly reversing 3/4 HP motor
- Over 1,250 lbs. of vertical line pull at 9 feet per minute
- Large grooved drum with a 4 1/2" diameter

- High speed worm gear supported for both radial and thrust loads
- Positive locking - double reduction worm gear drive provides a 200:1 reduction rate
- Sealed gear case provides a lifetime of maintenance-free operation
- Includes Deluxe Key Switch
- Five-year manufacturers warranty applies

**402-742** LynRus QR4000 Electric Winch  
**042-489** Winch Retrofit/Refurb Kit (not shown)



**DELUXE KEY SWITCH FOR ELECTRIC WINCH**

- Two-year warranty

**402-980** Deluxe Key Switch for Electric Winch



**LYNRUS REMOTE CONTROL TRANSMITTER FOR ELECTRIC WINCH**

- Works in conjunction with 402-754

**402-753** LynRus Remote Control Transmitter for Electric Winch



**LYNRUS REMOTE CONTROL RECEIVER FOR ELECTRIC WINCH**

- Two-year manufacturers warranty applies
- Works in conjunction with 402-753

**402-754** LynRus Remote Control Receiver for Electric Winch



**LYNRUS MANUAL WINCH**

- Heavy-duty 1,000 lb. capacity
- Ample, oversized flanges prevent the cable from climbing drum ends
- Efficient 40:1 worm gear ratio
- Long-lasting, ball-bearing type thrust bearing
- Maintenance-free lifetime sealed gear case
- Five-year manufacturers warranty applies

**402-760** LynRus Manual Winch 1,000 lb. Capacity with Crank Handle

**014-815** Replacement Handle

### GYMNASIUM CONTROLLER

This control system is a major improvement over a conventional key switch used for each of your backstop winches, divider curtains, scoreboards, etc. With the Spalding® gymnasium controller, you can control up to 42 devices easily from one location with just the touch of a screen.

- Controls your gymnasium with easy-to-operate computer screens – 2 styles available
- One motor will run at a time, allowing for optimal observation of the equipment while in use
- Each relay panel can control up to 7 different motors with net working capabilities to run up to 42 devices from one location
- All low voltage displays are username and password protected to maintain equipment security
- Controller can operate: Ceiling-Suspended Backstops, Divider Curtains, Retractable Batting Cages, Height Adjusters, and Activate scoreboards, lights and sound systems
- Note: All wiring should be completed by a licensed electrician. All wiring, conduit, components and installation techniques must meet all applicable local, state and national codes
- Programmable to store various operations such as basketball practice, volleyball or basketball games, gym mode, etc. Can store up to 10 scenarios
- 10" x 10" electrical enclosure for controller is not included



401-953 ENHANCED TOUCH SCREEN



401-952 SIMPLE TOUCHSCREEN



401-950 OPERATES UP TO 7 MOTORS OR 2 AUXILIARY DEVICES



IS YOUR GYMNASIUM EQUIPMENT UP-TO-DATE?  
CONTACT YOUR LOCAL CERTIFIED GYMPRO™ DEALER TO SCHEDULE AN INSPECTION.

www.spaldingequipment.com  
800.435.3865



**SPALDING**  
TRUE TO THE GAME™

The Spalding GymPro™ Inspection program provides a floor to ceiling assessment performed by trained and experienced professionals. The inspection will verify all equipment is good working order.

THE INSPECTION INCLUDES EVALUATION OF THE FOLLOWING EQUIPMENT:

- Basketball Rims and Backboards
- Retractable Equipment
- Volleyball Equipment
- Accessories
- Wall Padding
- And more...
- Divider Curtains

To set up a FREE EVALUATION, find a Spalding GymPro™ Dealer nearest you on our website at [www.spaldingequipment.com/dealerlocator.cfm](http://www.spaldingequipment.com/dealerlocator.cfm) or email us at [SpaldingGymPro@fotlinc.com](mailto:SpaldingGymPro@fotlinc.com).

SPALDING® GYMPRO™

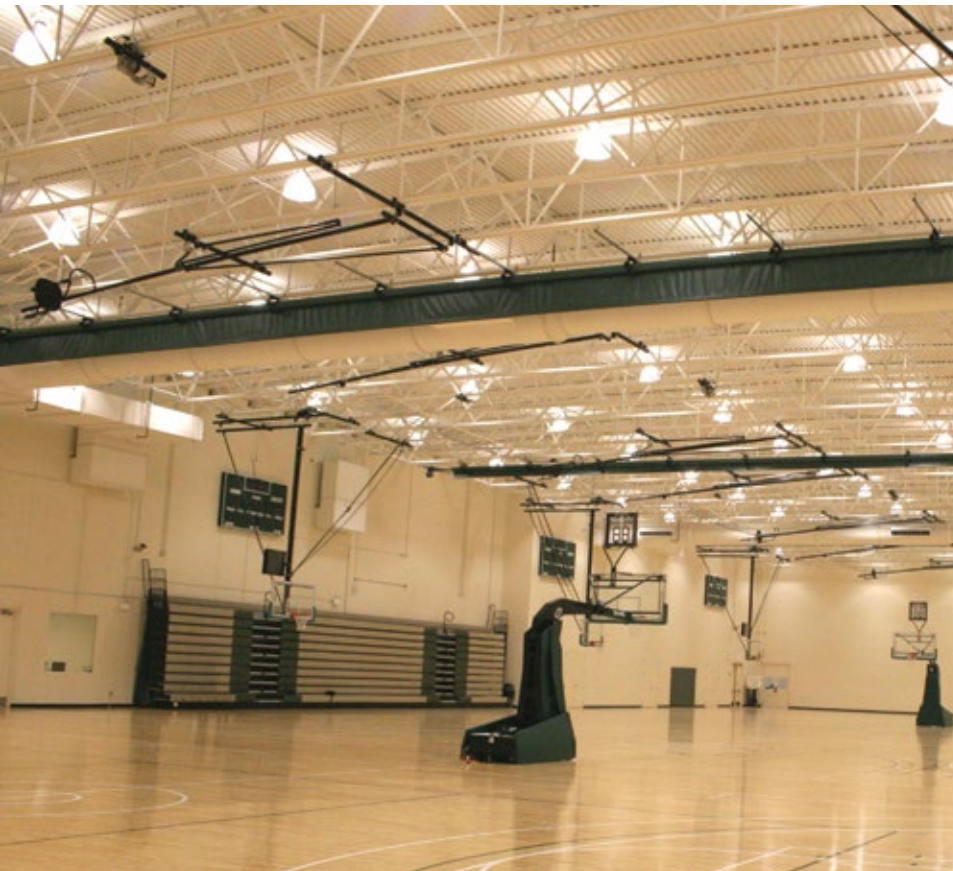

SYSTEM TYPE

**IN-GROUND**

In-ground systems remain stationary for maximum stability.



**PORTABLE**

Portable systems can be moved for convenience or storage.



**COMBOS**

Combo systems consist of a backboard and rim. They can be mounted to either an existing basketball system, or to a pole or roof via mounting hardware (sold separately).

BACKBOARD PERFORMANCE

**GLASS**

Glass backboards feature the best rebound performance and are ideal for highly competitive play.



**ACRYLIC**

Acrylic backboards feature better rebound performance and are ideal for competitive play.

**POLYCARBONATE**

Polycarbonate backboards feature good rebound performance and are ideal for recreational play.



REBOUND FACTOR

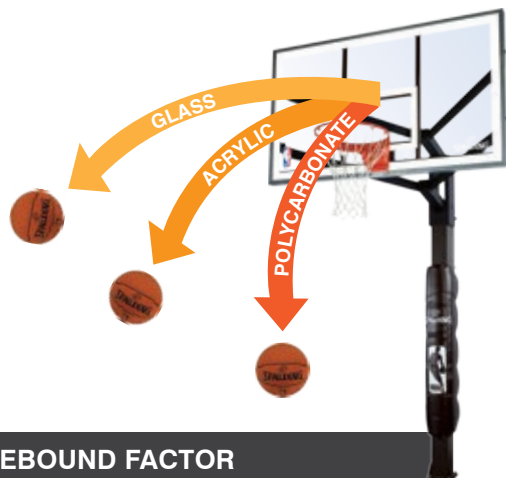

HEIGHT ADJUSTMENT

**INFINITE ADJUST**

Infinite Adjustment lifts can be set to any height between 7.5 ft. to 10 ft.



U-TURN™ PRO



SCREW JACK



U-TURN™

**ADJUSTABLE**

Preset Adjustment lifts can be set to predetermined heights in 4 or 6 inch increments.

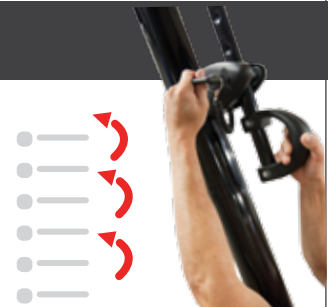

EXACTAHEIGHT™



PRO GLIDE™ ADVANCED



RATCHET



PRO GLIDE™

**NETS**



**NEEDLES**



**PUMPS**



SPALDING® CHOOSE YOUR RESIDENTIAL SYSTEM



Get the free mobile app at <http://gettag.mobi>

FIND US ONLINE @ [WWW.SPALDING.COM](http://WWW.SPALDING.COM)



### ARENA VIEW® SERIES

#### 72" GLASS ARENA VIEW® SERIES

- Board Size - 72" x 42"
  - Board - 1/2" Tempered Glass
  - Board Frame - Steel
  - Board Offset - 4'
  - Lift System - U-Turn™ Pro
  - Lift Handle - Removable
  - Pole Size - 1 Pc, 8" Square
  - Pole Material - Steel
  - Rim Style - 180° Breakaway
  - Board Pad - Arena
  - Pole Pad - Stadium Style
- Item# 88724AGP**  
**Spalding Equip.# 421-000**

#### 72" ACRYLIC ARENA VIEW® SERIES

- Board Size - 72" x 42"
  - Board - 1/2" Acrylic
  - Board Frame - Steel
  - Board Offset - 4'
  - Lift System - U-Turn™ Pro
  - Lift Handle - Removable
  - Pole Size - 1 Pc, 8" Square
  - Pole Material - Steel
  - Rim Style - 180° Breakaway
  - Board Pad - Arena
  - Pole Pad - Stadium Style
- Item# 88724AAP**  
**Spalding Equip.# 421-001**

#### 60" GLASS ARENA VIEW® SERIES

- Board Size - 60" x 38"
  - Board - 1/2" Tempered Glass
  - Board Frame - Steel
  - Board Offset - 3'
  - Lift System - U-Turn™ Pro
  - Lift Handle - Removable
  - Pole Size - 1 Pc, 6" Square
  - Pole Material - Steel
  - Rim Style - 180° Breakaway
  - Board Pad - Arena
  - Pole Pad - Stadium Style
- Item# 86604AGP**  
**Spalding Equip.# 421-002**

#### 72" ACRYLIC FIXED HEIGHT ARENA VIEW® SERIES

- Board Size - 72" x 42"
  - Board - 1/2" Acrylic
  - Board Frame - Steel
  - Pole Size - 1 Pc, 6" Square
  - Pole Material - Steel
  - Rim Style - 180° Breakaway
- Item# 886724FS**  
**Spalding Equip.# 421-006**



**HINGING BASE PLATE**  
Enables ground level assembly of backboard and rim



**SPALDING® RESIDENTIAL IN-GROUND SYSTEMS**



**ARENA VIEW®  
H-SERIES**

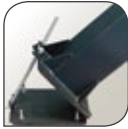

**HINGING BASE PLATE**  
Enables ground level assembly of backboard and rim



**“888” SERIES**



**J-BOLT**  
J-Bolt anchoring system allows for leveling adjustment

**72” GLASS ARENA VIEW® H-SERIES**

- Board Size - 72” x 42”
  - Board - 3/8” Tempered Glass
  - Board Frame - Steel
  - Board Offset - 4’
  - Lift System - U-Turn™ Pro
  - Lift Handle - Removable
  - Pole Size - 1 Pc, 6” Square
  - Pole Material - Steel
  - Rim Style - Positive Lock Breakaway
  - Pole Pad - Heavy Duty
- Item# 86724HGP**  
**Spalding Equip.# 421-060**

**60” GLASS ARENA VIEW® H-SERIES**

- Board Size - 60” x 38”
  - Board - 3/8” Tempered Glass
  - Board Frame - Steel
  - Board Offset - 3’
  - Lift System - U-Turn™ Pro
  - Lift Handle - Removable
  - Pole Size - 1 Pc, 6” Square
  - Pole Material - Steel
  - Rim Style - Positive Lock Breakaway
  - Pole Pad - Heavy Duty
- Item# 86604HGP**  
**Spalding Equip.# 421-062**

**72” GLASS IN-GROUND SYSTEMS**

- Board Size - 72” x 42”
  - Board - 3/8” Tempered Glass
  - Board Frame - Steel
  - Board Offset - 4’
  - Lift System - U-Turn™ Pro
  - Lift Handle - Removable
  - Pole Size - 1 Pc, 6” Square
  - Rim Style - Flex Breakaway
  - Pole Pad - Heavy Duty
- Item# 88880G**  
**Spalding Equip.# 421-123**

**60” GLASS IN-GROUND SYSTEMS**

- Board Size - 60” x 38”
  - Board - 3/8” Tempered Glass
  - Board Frame - Steel
  - Board Offset - 3’
  - Lift System - U-Turn™ Pro
  - Lift Handle - Removable
  - Pole Size - 1 Pc, 6” Square
  - Rim Style - Flex Breakaway
  - Pole Pad - Heavy Duty
- Item# 88830G**  
**Spalding Equip.# 421-120**

**54” GLASS IN-GROUND SYSTEMS**

- Board Size - 54” x 36”
  - Board - 3/8” Tempered Glass
  - Board Frame - Steel
  - Board Offset - 3’
  - Lift System - U-Turn™ Pro
  - Lift Handle - Removable
  - Pole Size - 1 Pc, 5” Square
  - Rim Style - Flex Breakaway
  - Pole Pad - Heavy Duty
- Item# 88825G**  
**Spalding Equip.# 421-121**

**60" GLASS IN-GROUND SYSTEMS**

- Board Size - 60" x 34"
- Board - 1/4" Tempered Glass
- Board Frame - Steel
- Board Offset - 2'
- Lift System - U-Turn™
- Lift Handle - Removable
- Pole Size - 2 Pc, 4" Square
- Pole Material - Steel
- Rim Style - Pro Image™

**Item#** 88461G

**Spalding Equip.#** 421-118

**54" GLASS IN-GROUND SYSTEMS**

- Board Size - 54" x 32"
- Board - 1/4" Tempered Glass
- Board Frame - Steel
- Board Offset - 2'
- Lift System - U-Turn™
- Lift Handle - Removable
- Pole Size - 2 Pc, 4" Square
- Pole Material - Steel
- Rim Style - Pro Image™

**Item#** 88454G

**Spalding Equip.#** 421-117





### 54" ACRYLIC IN-GROUND SYSTEMS

- Board Size - 54" x 32"
- Board - Acrylic
- Board Frame - Steel
- Board Offset - 18"
- Lift System - U-Turn™
- Board Pad - Authentic
- Pole Size - 3 Pc, 4" Square
- Pole Material - Steel
- Rim Style - Arena Slam®

**Item# 88365**  
**Spalding Equip.# 421-116**



### 52" ACRYLIC IN-GROUND SYSTEMS

- Board Size - 52"
- Board - Acrylic
- Board Frame - Steel
- Board Offset - 16"
- Lift System - Pro Glide™
- Pole Size - 3 Pc, 3.5" Round
- Pole Material - Steel
- Board Pad - Authentic Style
- Rim Style - Pro Slam®

**Item# 88307PR**  
**Spalding Equip.# 421-124**

**50" ACRYLIC IN-GROUND SYSTEMS**

- Board Size - 50"
- Board - Acrylic
- Board Frame - Steel
- Board Offset - 16"
- Lift System - Exactaheight™
- Pole Size - 3 Pc, 3.5" Square
- Pole Material - Steel
- Board Pad - Authentic Style
- Rim Style - Pro Slam®

Item# 88355

Spalding Equip.# 421-115

**50" POLYCARBONATE IN-GROUND SYSTEMS**

- Board Size - 50"
- Board - Polycarbonate
- Board Frame - 1" x 1" Steel Frame
- Board Offset - 16"
- Lift System - Exacta-height™
- Pole Size - 3 Pc, 3.5" Round
- Pole Material - Steel
- Board Pad - Authentic Style
- Rim Style - Pro Slam®

Item# 88349

Spalding Equip.# 421-242



**SPALDING® RESIDENTIAL IN-GROUND SYSTEMS**

**48" POLYCARBONATE IN-GROUND SYSTEMS**

- Board Size - 48"
- Board - Polycarbonate
- Board Frame - Steel
- Board Offset - 16"
- Lift System - Pro Glide™
- Lift Handle - Removable
- Pole Size - 3 Pc, 3.5" Round
- Pole Material - Steel
- Board Pad - Authentic Style
- Rim Style - Pro Slam®

**Item#** 88354PR

**Spalding Equip.#** 421-125



**44" POLYCARBONATE IN-GROUND SYSTEMS**

- Board Size - 44"
- Board - Polycarbonate
- Board Frame - Steel
- Board Offset - 16"
- Lift System - Ratchet
- Pole Size - 3 Pc, 3.5" Round
- Pole Material - Steel
- Rim Style - Slam Jam®

**Item#** 88351

**Spalding Equip.#** 421-106



## THE BEAST®

First and only 60" glass portable.

### 60" GLASS PORTABLE SYSTEM

- Board Size - 60"
  - Board - 1/4" Tempered Glass
  - Board Frame - Steel
  - Board Offset - 2'
  - Lift System - Screw Jack
  - Lift Handle - Removable
  - Pole Size - 2 Pc, 5" Square
  - Pole Material - Steel
  - Pole Angle: 20°
  - Wheels: 4
  - Rim Style - Pro Image™
  - Base: 55 Gallon Power Move™
  - Front Cover: Pre-Play Movement & During Play Rebounder
- Item# 74560**  
**Spalding Equip.# 421-232**

### 54" GLASS PORTABLE SYSTEM

- Board Size - 54"
  - Board - 1/4" Tempered Glass
  - Board Frame - Steel
  - Board Offset - 2'
  - Lift System - Screw Jack
  - Lift Handle - Removable
  - Pole Size - 3 Pc, 4" Square
  - Pole Material - Steel
  - Rim Style - Arena Slam®
  - Base: 40 Gallon Ballast
  - Front Cover: Rebounder During Play
  - Board Pad - Foam
  - Wheels: 2
- Item# 68454**  
**Spalding Equip.# 421-214**





**54" ACRYLIC PORTABLE SYSTEM  
60" ACRYLIC PORTABLE SYSTEM**

- Board - Acrylic
  - Board Frame - Steel
  - Board Offset - 16"
  - Lift System - Screw Jack
  - Lift Handle - Removable
  - Pole Size - 3 Pc, 3 1/2" Round
  - Pole Material - Steel
  - Pole Angle: 20°
  - Rim Style - Arena Slam®
  - Base: 40 Gallon Ballast
  - Front Cover: Rebounder During Play
  - Board Pad - Authentic Style
  - Wheels - 2
- 54" Item# 68564  
54" Spalding Equip.# 421-197**
- 60" Item# 68562  
60" Spalding Equip.# 421-198**

**54" ACRYLIC PORTABLE SYSTEM**

- Board - Acrylic
- Board Frame - Steel
- Board Offset - 14"
- Lift System - Exactaheight™
- Pole Size - 3 Pc, 3 1/2" Round
- Pole Material - Steel
- Pole Angel - 20 Deg.
- Rim Style - Pro Slam™
- Base - 34 Gallon Ballast
- Front Cover - Rebounder During Play
- Wheels -2

**Item# 66291  
Spalding Equip.# 421-230**





### 52" ACRYLIC PORTABLE SYSTEM

- Board - Acrylic
- Board Frame - Steel
- Board Offset - 14"
- Lift System - Pro Glide™
- Pole Size - 3 Pc, 3 1/2" Round
- Pole Material - Steel
- Pole Pad - Heavy Duty
- Rim Style - Pro Slam™
- Base - 37 Gallon Ballast
- Board Pad - Authentic Style
- Wheels -2

Item # 72307PR  
Spalding Equip.# 421-249

### 50" ACRYLIC PORTABLE SYSTEM

- Board - Acrylic
- Board Frame - Steel
- Board Offset - 14"
- Lift System - Exactaheight™
- Pole Size - 3 Pc, 3 1/2" Round
- Pole Material - Steel
- Pole Angle - 20 Deg.
- Rim Style - Pro Slam™
- Base - 34 Gallon Ballast
- Front Cover - Rebounder During Play
- Wheels -2

Item # 66355  
Spalding Equip.# 421-260







**50" POLYCARBONATE PORTABLE SYSTEM**

- Board - Polycarbonate
- Board Frame - Steel
- Board Offset - 14"
- Lift System - Exactaheight™
- Pole Size - 3 Pc, 3.5" Round
- Pole Material - Steel
- Board Pad - Authentic Style
- Rim Style - Pro Slam®
- Base - 34 Gallon Ballast
- Front Cover - Rebounder During Play
- Pole Angle - 20°
- Wheels - 2

**Item # 66349**  
**Spalding Equip.# 421-248**

**48" POLYCARBONATE PORTABLE SYSTEM**

- Board - Polycarbonate
- Board Frame - Steel
- Lift System - Pro Glide™
- Pole Size - 3 Pc, 3" Round
- Pole Material - Steel
- Rim Style - Slam Jam®
- Base - 37 Gallon Ballast
- Board Pad - Authentic Style
- Wheels -2
- Board Pad - Foam

**Item # 72354**  
**Spalding Equip.# 421-204**



**44" POLYCARBONATE PORTABLE SYSTEM**

- Board - Polycarbonate
- Board Frame - Steel
- Board Offset - 14"
- Lift System - Pro Glide™
- Pole Size - 3 Pc, 3" Round
- Pole Material - Steel
- Rim Style - Slam Jam®
- Base - 37 Gallon Ballast
- Wheels -2

**Item # 72351**  
**Spalding Equip.# 421-205**

**54" ACRYLIC COMBO**

- Board Size - 54"
- Board Material - Acrylic
- Rim Style - Arena Slam®
- Board Pad- Authentic Style

Item# 79564

Spalding Equip.# 421-263

**52" ACRYLIC COMBO**

- Board Size - 52"
- Board Material - Acrylic
- Rim Style- Pro Slam™
- Board Pad- Authentic Style

Item# 79307

Spalding Equip.# 421-256

**50" ACRYLIC COMBO**

- Board Size- 50"
- Board Material-Acrylic
- Rim Style- Pro Slam®
- Board Pad- Authentic Style

Item# 79355

Spalding Equip.# 421-241





**50" POLYCARBONATE COMBO**

- Board Size- 50"
- Board Material-Polycarbonate
- Rim Style-Pro Slam®
- Board Pad-Authentic Style

**Item# 79349**  
**Spalding Equip.# 421-240**



**48" POLYCARBONATE COMBO**

- Board Size - 48"
- Board Material - Polycarbonate
- Rim Style - Slam Jam®
- Board Pad- Authentic Style

**Item# 79354**  
**Spalding Equip.# 421-253**



**44" POLYCARBONATE COMBO**

- Board Size- 44"
- Board Material- Polycarbonate
- Rim Style- Slam Jam®

**Item# 79351**  
**Spalding Equip.# 421-257**



### ALL WEATHER WHITE NET

Item # 8284S  
Spalding Equip.# 421-317



### HEAVY DUTY WHITE NET

Item # 8235S  
Spalding Equip.# 421-315



### ALL WEATHER RED, WHITE & BLUE NET

Item # 8279S  
Spalding Equip.# 421-318



### HEAVY DUTY R/W/B NET WITH NBA PATCH

Item # 8219S  
Spalding Equip.# 421-316



### 12" DUAL ACTION PUMP WITH EXTENSION HOSE

Item # 8324S  
Spalding Equip.# 421-045



### 12" DUAL ACTION PUMP

Item # 8306S  
Spalding Equip.# 421-313



### TUNE-UP KIT

- 6" Pump
- All Weather Net R/W/B
- Metal Whistle
- 3 Metal Inflation Needles

Item # 8300S  
Spalding Equip.# 421-320



### MESH BAG

- Mesh Equipment Bag
- Holds Up To 7 Balls

Item # 8361S  
Spalding Equip.# 411-608



### INFLATING NEEDLES

Item # 8312S  
Spalding Equip.# 421-322



### METAL WHISTLE

Item # 8309S  
Spalding Equip.# 421-325

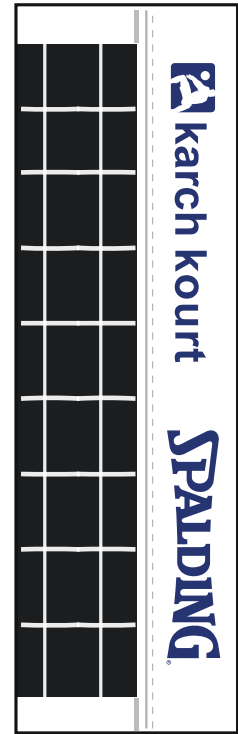
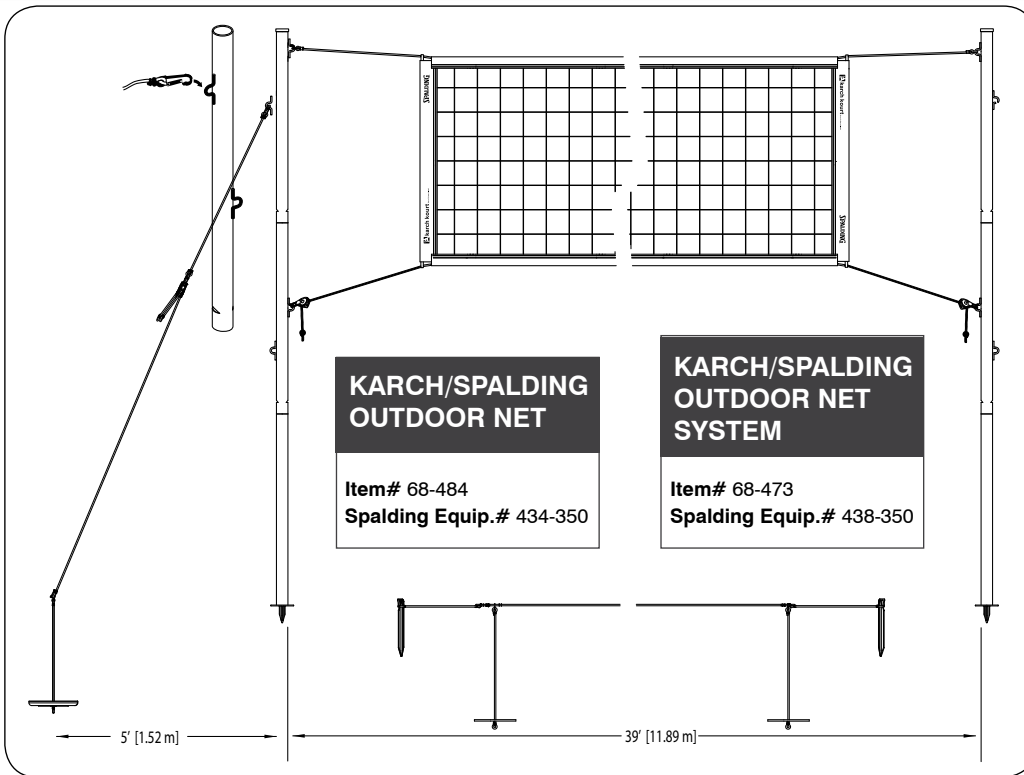

Kiraly approached his longstanding partner, Spalding, the maker of the original “18 Panel” beach volleyball and current industry leader with the King of the Beach/US Open of Beach Volleyball Series, to create a net and net system of a quality to match Spalding’s volleyball products. Karch and Spalding agreed to develop two new volleyball offerings: A stand-alone “High End” net that would deliver the same performance Karch was accustomed to on the pro tour; and a “Tournament Quality” portable net system that wouldn’t compromise the integrity of play, that could perform as well as permanent post systems, that would be simple to set up and take down, and that could be used on both Sand or Grass surfaces.

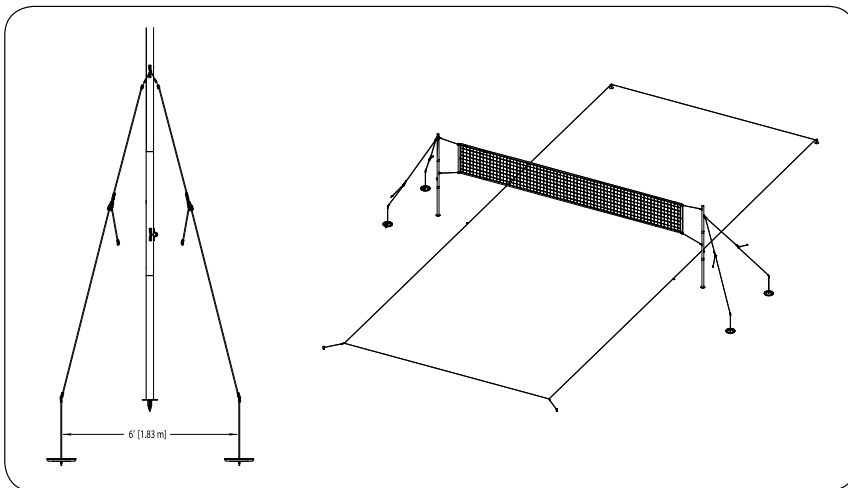

Karch Kiraly 3-time Olympic Gold Medalist '84 and '88 (indoor) '96 (beach)

**KING OF THE BEACH/  
USA BEACH REPLICA  
TOUR BALL**

- Exclusive Textured EVA Composite Material
- Ideal for Recreational Outdoor Play

Item# 72-126



**karch kourt** [karchkourt.net](http://karchkourt.net)



OUR FOCUS WHEN MANUFACTURING SPALDING VOLLEYBALL EQUIPMENT IS DURABILITY, PERFORMANCE AND EASE-OF-USE. OUR ELITE ALUMINUM SYSTEMS INCLUDE THE FOLLOWING FEATURES:

- Lightweight and easy to set up
- High strength uprights made of 3" (76mm) O.D. extruded aluminum
- Improved pulley guard is designed to prevent cable misalignment
- Navy blue powder coated uprights with silver powder coated pistons
- Spring-loaded, telescoping pistons for easy adjustment regardless of competitive height
- Adjust to meet junior's, women's, and men's height
- Adjustable height worm gear winch designed to eliminate backlash and keep net tight during intense play
- Nylon leader strap for easy net attachment
- Requires 3" floor sleeves - sold separately (see pages 62 for details)
- **Warranty:** poles and piston, ten-year; parts and winch, one-year
- Meets NCAA®, NFHS, and FIVB specifications
- Official supplier to USAV and NFHS



**ELITE Aluminum System with SV210 Pads**

**ELITE ALUMINUM UPRIGHTS**



**A**  
438-296  
Winch End

**B**  
438-297  
Center

**C**  
438-298  
Multi-Court

**ONE-COURT ELITE ALUMINUM SYSTEM**



**Includes:**

- 438-296 Elite Aluminum Winch End Upright (includes 408-048 Antenna Package)
- 438-297 Elite Aluminum Center Upright
- 434-214 Aramid Fiber 1M Net Package
- SV210-E Upright End Pads - Pair

**SEA110** One-Court Elite Aluminum System

**TWO-COURT ELITE ALUMINUM SYSTEM**



**Includes:**

- (2) 438-296 Elite Aluminum Winch End Upright (includes 408-048 Antenna Package)
- (1) 438-297 Elite Aluminum Center Upright
- (2) 434-214 Aramid Fiber 1M Net Package
- SV210-E Upright End Pads - Pair
- SV210-C Upright Center Pad - Each

**SEA210** Two-Court Elite Aluminum System

**ELITE ALUMINUM MULTI-COURT UPRIGHT**



**Includes:**

- 408-048 Antenna Package

**438-298** Elite Aluminum Multi-Court Upright

\* Use with 438-295 and 438-296 to make three-court (or more) continuous set-up

SPALDING is the official supplier to:



OFFICIAL NET SYSTEMS  
SUPPLIER to USA Volleyball®.

\*Uprights also sold as package or individual pieces. See price list for part #'s and prices.

SPALDING® ELITE ALUMINUM SYSTEM



OUR FOCUS WHEN MANUFACTURING SPALDING VOLLEYBALL EQUIPMENT IS DURABILITY, PERFORMANCE AND EASE-OF-USE. OUR ELITE STEEL SYSTEMS INCLUDE THE FOLLOWING FEATURES:

- High strength uprights made of 3" (76mm) O.D. steel for the highest level of competitive play
- Navy blue powder coated uprights with chrome plated pistons
- Improved pulley guard is designed to prevent cable misalignments
- Spring-loaded, telescoping pistons for easy adjustment regardless of competitive height
- Adjusts from junior's, women's, and men's height
- Adjustable height worm gear winch designed to eliminate backlash and keep net tight during intense play



**ELITE Steel System with SV110 Pads**

- Nylon leader strap for easy net attachment
- Requires 3" floor sleeves - sold separately (see pages 62 for details)
- **Warranty:** poles and piston, ten-year; parts and winch, one-year
- Meets all USAV, NCAA®, NFHS, and FIVB specifications
- Official supplier to USAV and NFHS



ELITE STEEL UPRIGHTS



A

438-291  
Winch End

B

438-292  
Center

C

438-293  
Multi-Court

ONE-COURT ELITE STEEL SYSTEM

A & B

Includes:

- 438-291 Elite Steel Winch End Upright (includes 408-048 Antenna Package)
- 438-292 Elite Steel Center Upright
- 434-214 Aramid Fiber 1M Net Package
- SV210-E Upright End Pads - Pair

SES110 One-Court Elite Steel System

TWO-COURT ELITE STEEL SYSTEM

A & B & A

Includes:

- (2) 438-291 Elite Steel Winch End Upright (includes 408-048 Antenna Package)
- (1) 438-292 Elite Steel Center Upright
- (2) 434-214 Aramid Fiber 1M Net Package
- SV210-E Upright End Pads - Pair
- SV210-C Upright Center Pad - Each

SES210 Two-Court Elite Steel System

ELITE STEEL MULTI-COURT UPRIGHT

C

Includes:

- 408-048 Antenna Package

438-293 Elite Steel Multi-Court Upright

\* Use with 438-290 and 438-291 to make three-court (or more) continuous set-up



SPALDING is the official supplier to:



OFFICIAL NET SYSTEMS  
SUPPLIER to USA Volleyball®.

SPALDING® ELITE STEEL SYSTEM



### SPALDING® SLIDE MULTI-SPORT SYSTEMS

include the following features:

- Lightweight and easy to set up
- High strength uprights made of 3" (76mm) O.D. extruded aluminum
- Navy blue powder coated uprights with silver powder coated sliders
- Easy infinite adjustment regardless of competitive height
- Use at all levels of volleyball, tennis, and badminton
- Nylon leader strap for easy net attachment
- Requires 3" floor sleeves - sold separately (see pages 62 for details)
- **Warranty:** poles and slide, five-year; parts and winch, one-year



SLIDE SYSTEM AT  
BADMINTON HEIGHT

SLIDE MULTI-SPORT UPRIGHTS



**A**  
Winch End

**B**  
Center

**C**  
Multi-Court

ONE-COURT SLIDE MULTI-SPORT SYSTEM



**Includes:**

- 438-465 Slide Multi-Sport Upright Package (includes 408-048 Antenna Package)
- 434-203 36" Net Package
- SV210-E Upright End Pads - Pair

**SS110** One-Court Slide Multi-Sport System

TWO-COURT SLIDE MULTI-SPORT SYSTEM



**Includes:**

- 438-465 Slide Multi-Sport Upright Package (includes 408-048 Antenna Package)
- 438-466 Slide Multi-Court Winch End Upright
- (2) 434-203 36" Net Package
- SV210-E Upright End Pads - Pair
- SV210-C Upright Center Pad - Each

**SS210** Two-Court Slide Multi-Sport System

SLIDE MULTI-COURT UPRIGHT



- Use to make two, three or four-court continuous set-up
- Uprights comes with 408-048 Antenna Package

**438-466** Slide Multi-Court Upright



SLIDE SYSTEM WITH SV210 PADS

SPALDING® SLIDE MULTI-SPORT SYSTEM

SPALDING'S RECTANGULAR SLIDE MULTI-SPORT SYSTEMS INCLUDE THE FOLLOWING FEATURES:

- Rectangular profile reduces the weight and deflection under tension
- High strength aluminum uprights made of 4 1/2" x 3" (114 X 76mm) cross section profile
- Spalding uprights painted with a blue powder coated finish
- Easy continuous adjustment to ensure correct net height for any situation
- Uprights are clearly marked at all levels of volleyball, tennis, and badminton height
- Plugs are placed at the top and bottom of the uprights to prevent floor damage
- Internal slide bar allows for easy infinite adjustments regardless of competitive height
- New smaller winch includes a nylon leader strap for safety and easy net attachment
- Requires 3" floor sleeves - sold separately (see pages 62 for details)
- **Warranty:** poles and slide bars, five-year; parts and winch, one-year



Height Indicators

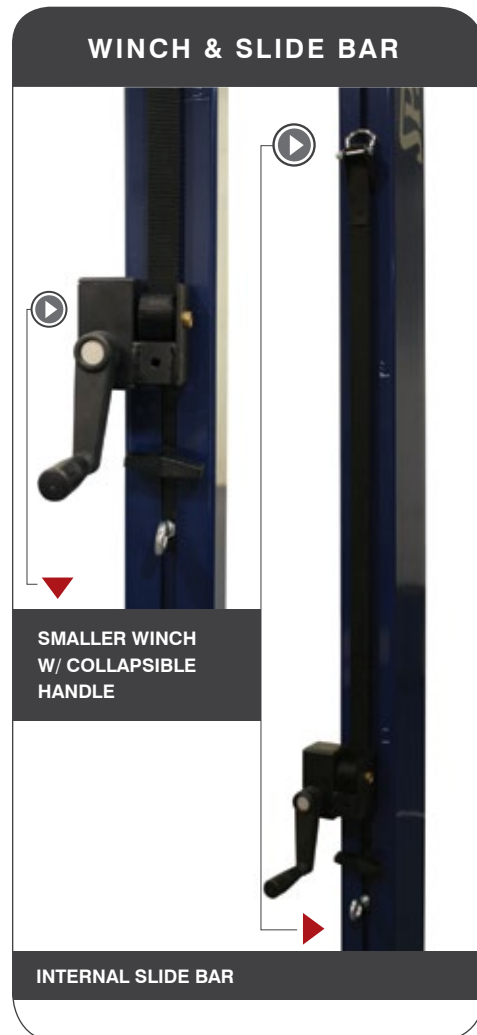

RECTANGULAR SLIDE



A

438-400

B

438-401

C

438-403

ONE-COURT RECTANGULAR SLIDE MULTI-SPORT SYSTEM

A & B

Includes:

- 438-402 Rectangular Slide Multi-Sport Upright Package (includes 408-048 Antenna Package)
- 434-203 36" Net Package
- SV510 Rectangular Upright End Pads - Pair

SRS110 One-Court Rectangular Slide Multi-Sport System

TWO-COURT RECTANGULAR SLIDE MULTI-SPORT SYSTEM

A & B & C

Includes:

- 438-402 Rectangular Slide Multi-Sport Upright Package (includes 408-048 Antenna Package)
- 438-403 Rectangular Slide Multi-Court Winch End Upright (includes 408-048 Antenna Package)
- (2) 434-203 36" Net Package
- SV510 Rectangular Upright End Pads - Pair
- SV510 Rectangular Upright Center Pad - Each

SRS210 Two-Court Rectangular Slide Multi-Sport System

RECTANGULAR SLIDE MULTI-COURT UPRIGHT

C

Includes:

- Use to make two, three or four-court continuous set-up
- 408-048 Antenna & Holder Set

438-403 Rectangular Slide Multi-Court Upright

**TELESCOPING MULTI-SPORT UPRIGHTS** include the following features:

- Uprights made of 3" (76mm) O.D. aluminum or 3" (76mm) O.D. chrome-plated steel
- Worm Gear Winch eliminates backlash
- Nylon leader strap for easy net attachment
- Used for all levels of volleyball, paralympic volleyball, badminton, and tennis
- Floor plate/sleeve not included (see pages 62 for floor plate/sleeve options)
- **Warranty:** poles and piston, five-year; parts and winch, one-year

**TELESCOPING MULTI-SPORT ALUMINUM SYSTEMS** includes:

- 438-060 Telescoping Multi-Sport Aluminum Upright Package (includes 408-046 Antenna)
- 434-100 Telescoping Multi-Sport Quick Set Net
- Pair SV210 Upright End Pads (see page 66 for color options)

**SMA110** One-Court Telescoping Multi-Sport Aluminum System

**SMA210** Two-Court Telescoping Multi-Sport Aluminum System

\*Add 438-061 Telescoping Multi-Sport Winch End Upright to make a two, three or four-court setup.

ALUMINUM UPRIGHTS



**TELESCOPING MULTI-SPORT STEEL SYSTEMS** includes:

- 438-025 Telescoping Multi-Sport Steel Upright Package (includes 408-046 Antenna)
- 434-100 Telescoping Multi-Sport Quick Set Net
- Pair SV210 Upright End Pads (see page 66 for color options)

**SMS110** One-Court Telescoping Multi-Sport Steel System

**SMS210** Two-Court Telescoping Multi-Sport Steel System

\*Add 438-026 Telescoping Multi-Sport Winch End Upright to make a two, three or four-court setup.

STEEL UPRIGHTS



### TELESCOPING MULTI-SPORT NETS

- Telescoping Multi-Sport nets sold separately
- Designed for use with Telescoping Multi-Sport Systems
- 1" square mesh net

**434-060** Badminton/Tennis Net

**434-120** Quick Set Combo Net - 1 3/4" mesh



### TENNIS SYSTEM

- System includes two uprights—one with a worm gear winch and one for net tensioning
- Uprights are made of 3" (76mm) O.D. steel with a fixed height of 3' 6" (103cm)
- Floor plate/sleeve not included (see page 62 for floor plate/sleeve options)
- Net not included, sold separately

**438-370** Tennis System

**438-371** Winch End Upright for two-court play

**434-039** Official 42' (12.8m) Tennis Net

**434-040** 36' (1m) Tennis Net for use on a volleyball court setup



### BADMINTON SYSTEM

- System includes two uprights with adjusting height collars and badminton net
- 434-050 Badminton Net - 20' (6.1m) mesh net with 26' (7.9m) long top rope
- Uprights are made of 2" (51mm) O.D. steel tubing
- Floor sleeves sold separately
- **408-704** Locking Chrome Floor Plate/Sleeve - Pair
- **408-705** Locking Chrome Floor Plate/Sleeve - Each
- **408-721** Locking Brass Floor Plate/Sleeve - Pair
- **408-722** Locking Brass Floor Plate/Sleeve - Each

**438-240** Badminton System

### MULTI-COURT BADMINTON SYSTEM

- System includes one badminton upright and 434-050 Badminton Net
- Use with a 438-240 to make a two-court continuous set-up

**438-241** Multi-Court Badminton System (not shown)

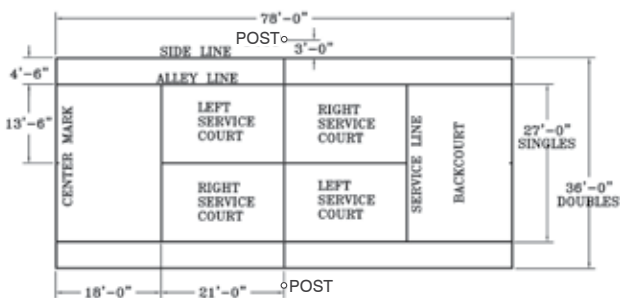

TENNIS COURT LAYOUT

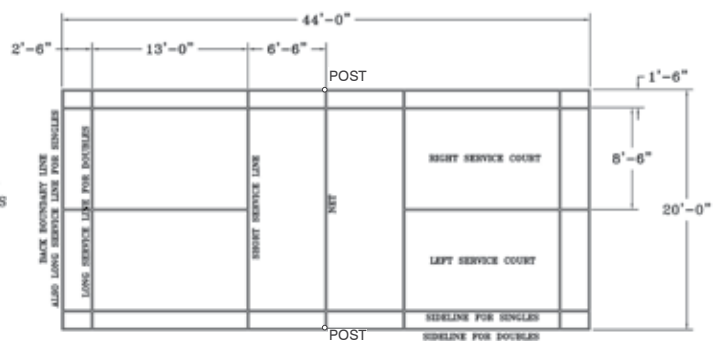

BADMINTON COURT LAYOUT

## CHROME



## BRASS



## LOCKING SUPER FLOAT



## CHROME FLOOR PLATE/SLEEVE

- Chrome-plated cover plate includes slotted locking mechanism
- Opens with simple turn of a flathead screwdriver or coin
- Cover plate consists of 7" (18cm) O.D. chrome outer ring and hinged chrome cap
- Heavy-duty steel sleeve receives 3" to 3 1/2" (7.6 to 8.9cm) upright and is 8" (23cm) deep
- 1" (2.5cm) clearance required between top of floor and sleeve

**408-785** Chrome Floor Plate/ 3" Sleeve - Pair

**408-786** Chrome Floor Plate/ 3" Sleeve - Each

**19885** Chrome Cover Plate assembly only

**408-700** Locking Chrome Floor Plate/ 3" Sleeve - Pair

**408-701** Locking Chrome Floor Plate/ 3" Sleeve - Each

**408-702** Locking Chrome Floor Plate/ 3.5" Sleeve - Pair

**408-703** Locking Chrome Floor Plate/ 3.5" Sleeve - Each

**19875** Chrome Locking Cover Plate assembly only

## BRASS FLOOR PLATE/SLEEVE

- Brass-plated cover plate includes slotted locking mechanism
- Opens with simple turn of a flathead screwdriver or coin
- Cover plate consists of 7" (18cm) O.D. brass outer ring and hinged brass cap
- Heavy-duty steel sleeve receives 3" to 3 1/2" (7.6 to 8.9cm) upright and is 8" (23cm) deep
- 1" (2.5cm) clearance required between top of floor and sleeve

**408-725** Locking Brass Floor Plate/ 3" Sleeve - Pair

**408-726** Locking Brass Floor Plate/ 3" Sleeve - Each

**408-727** Locking Brass Floor Plate/ 3.5" Sleeve - Pair

**408-728** Locking Brass Floor Plate/ 3.5" Sleeve - Each

**19870** Locking Brass Cover Plate assembly only

## LOCKING SUPER FLOAT FLOOR PLATE/SLEEVE

- Recommended for retrofits only, not for new construction
- 8" (20cm) O.D. wide cover plate allows for 1 1/2" (38mm) of float
- Cover plate is lockable with hex key (included)

**408-035** Locking Super Float Floor Plate/Sleeve - Pair

**408-036** Locking Super Float Floor Plate/Sleeve - Each

**71886** Cover Plate assembly only



Spalding can provide adaptors for existing sleeves over 3" diameter to accommodate any Spalding system. Call customer service at 800.435.3865 for more information.



# SPALDING® T-BASES & FLOOR ANCHORS

SPALDING® T-BASES & FLOOR ANCHORS



438-318



438-319

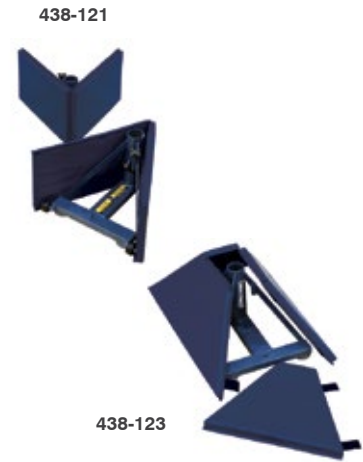

438-121

438-123

## T-BASE END BASE features:

- Designed for use in facilities where sleeve installation isn't feasible
- Recommend use with steel uprights only & requires only one floor anchor per end
- Each base has two rubber wheels for easy transporting
- Floor anchors, pads and uprights must be ordered separately

**438-318** T-Base End Bases - Pair  
**87870** - Replacement knob

## T-BASE CENTER BASE features:

- Use only with the following uprights for multiple court setups:
  - **438-290** Elite Steel Upright Package
  - **438-291** Elite Steel Winch End Upright
  - **438-293** Elite Steel Multi-Court Upright
- Requires two floor anchors per unit
- Floor anchors, pads and uprights must be ordered separately

**438-319** T-Base Center Base - Each  
**87870** - Replacement knob

## T-BASE PADS features:

- Easily attached with hook and loop fasteners
- Made with 18 oz. vinyl

**438-121** T-Base End Base, Navy Pad - Pair

**438-123** T-Base Center Base, Navy Pad - Each

\* Other color options available — contact factory for details.



### STYLE B FLOOR ANCHOR

- Installed in securely anchored wood floors
- Replaceable spring-loaded, pop-up cap
- Includes anchoring cement

**422-111** Style B Floor Anchor

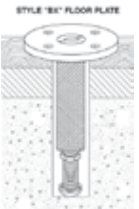

### STYLE BX FLOOR ANCHOR

- Same features as model 422-111, with longer knurled anchor - 3<sup>1</sup>/<sub>4</sub>" (81mm)

**422-211** Style BX Floor Anchor



### STYLE C FLOOR ANCHOR

- Installed in concrete and vinyl covered concrete floors
- Replaceable spring-loaded pop-up cap
- Includes anchoring cement

**422-112** Style C Floor Anchor

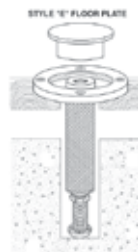

### STYLE E FLOOR ANCHOR

- Installed in floating wood floors resting on sleepers or metal clip fasteners
- Features removable cap and anchoring cement
- Measure distance from top of floor to top of concrete to determine model

**422-014** Style E Floor Anchor (less than 2<sup>7</sup>/<sub>8</sub>" )

**422-029** Style E Floor Anchor (2<sup>7</sup>/<sub>8</sub>" to 4")

**422-030** Style E Floor Anchor (2<sup>7</sup>/<sub>8</sub>" to 5")

**422-031** Style E Floor Anchor (2<sup>7</sup>/<sub>8</sub>" to 6")

**422-032** Style E Floor Anchor (2<sup>7</sup>/<sub>8</sub>" to 7")

**422-034** Style E Floor Anchor (2<sup>7</sup>/<sub>8</sub>" to 9")

## NET ORDERING INFORMATION

- Measure the distance between the center of the floor sleeves
- If the measurement is within 35' 5" to 36' 6" a custom net is NOT needed
- If the measurement is above or below 35' 5" to 36' 6", call customer service to order a custom net
- Spalding nets are only guaranteed to fit Spalding systems



### 36" QUICK SET NET PACKAGE INCLUDES:

- 36" (91cm) wide net is 32' (9.75m) long, with a 34' (10.4m) top pvc-coated steel cable and a 39' (12.2m) bottom polypropylene rope
- 2" (51mm) vinyl coated nylon binding on top and bottom
- Includes steel dowels, rope ratchets and net tension straps
- Use with Spalding models 438-290, 438-295, 438-302

**434-203** 36" Quick Set Net Package

**434-200** 36" Quick Set Net with Graphic Banner

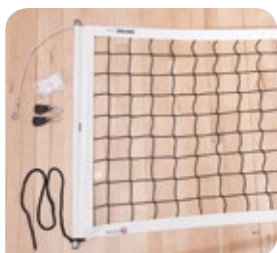

### 1M NET PACKAGE INCLUDES:

- Net is similar to model 434-203, except it is 1m (39") wide
- Use with Spalding models 438-302, 438-290, 438-295

**434-204** 1M Net Package

**434-201** 1M Net Package with Graphic Banner

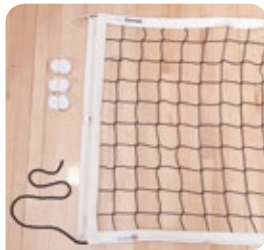

### ARAMID FIBER 1M NET PACKAGE INCLUDES:

- 1M (39") wide net is 32' (9.75m) long, with a 33' (10m) top cable of Aramid Fiber core rope and a 39' (12.2m) bottom polypropylene rope
- Includes steel dowels, rope ratchets and net tension straps
- Use with Spalding models 438-290, 438-295

**434-214** Aramid Fiber 1M Net Package

**434-113** Aramid Fiber Net Package — 40' Variable Length Top Cable



### ROPE RATCHET PACKAGE INCLUDES:

- Locking mechanism permits quick tightening of bottom ropes on net
- Package includes two rope ratchets

**434-020** Rope Ratchet Package

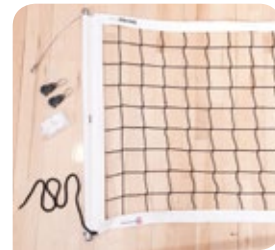

### MULTI-SPORT QUICK SET NET

- Net for use with Multi-Sport system
- Use with Spalding models 438-465, 438-060, 438-025 and 438-026

**434-100** Multi-Sport Quick Set Net  
Custom nets available - call factory for additional information.

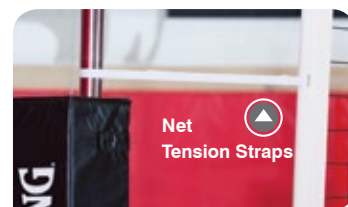

### NET TENSION STRAPS

- Provides proper tension on net dowels, keeping net ends straight
- Set of six 1" (25mm) wide straps with hook and loop fasteners and high impact retainer ring

**434-030** Net Tension Straps

**SPALDING ANTENNA PACKAGE** 

- This package includes two red and white striped antenna assemblies
- Attachment adjustments are made easily and quickly from floor
- Improved clamping mechanism prevents loosening during play
- Adjusts to fit 36" and 1M nets
- Tested to withstand over 60 MPH serves
- Sold as pairs

**408-048** Antenna Package

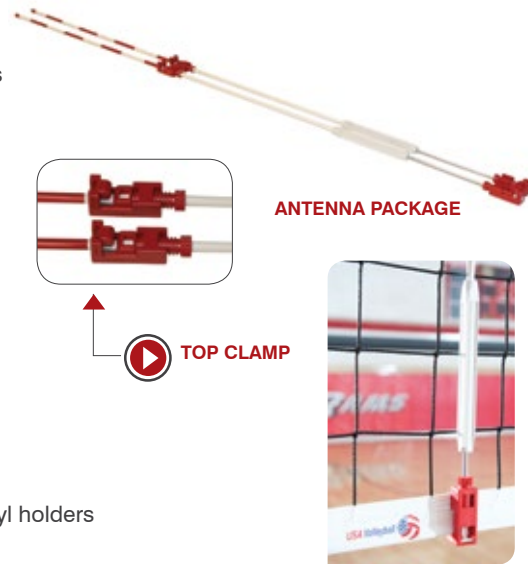

**ANTENNA/HOLDER SET** 

- One pair of regular fiberglass antenna and 2" (51mm) wide white vinyl holders with hook and loop fasteners

**408-046** Antenna/Holder Set

**ANTENNA CLAMPS** 

- Set of four durable plastic clamps that fasten to the top and bottom of net
- Includes two antenna

**408-167** Plastic Clamps & Antenna (Includes 4 clamps and 2 antenna)

**408-168** Set of Four Plastic Clamps (clamps only)



**ROPE COVERS** 

- Set of four vinyl volleyball rope covers that attach to the upper and lower ropes or cables of net
- Available in black only

**438-072** Rope Covers



**NET HEIGHT CHAIN**

- Net Height Chain hooks to top of net
- Red indicators on chain show proper net height for men, women, co-ed and various age groups

**408-031** Net Height Chain





### SV110 UPRIGHT END PADS

- Made in one piece for end pads
- Can select a pair of single wrap end pads or a 2-piece center
- Pads are 70" high and 1" thick
- Made of 18 oz. vinyl
- Fifteen colors available

**SV110-E** End Pads  
**SV110-C** Center Pads



### SV210 UPRIGHT CENTER & END PADS

- Made in four-sided (two-piece) end pads and center pads
- Can be ordered a each or pair
- Pads are 6' high and 1" thick
- Made of 18 oz. vinyl
- Fifteen colors available

**SV210-E** End Pads  
**SV210-C** Center Pads



### DIGITAL GRAPHIC UPRIGHT PADS

- All digital graphics are done using state-of-the-art, six-color large format printers
- Pads are 6' high and 1" thick
- Made of 14 oz. vinyl
- Durable, vivid inks ensure that your padding will outlast the silk-screens and vinyl applications of the past
- Our lamination process decreases the likelihood of scratching as well as regular wear-and-tear from daily use
- Available in the SV210 style only
- 1 year warranty against manf. defects

**438-075** Digital Upright Pads - Pair  
**438-076** Digital Upright Pads - Each

#### SV110 UPRIGHT PAD SPECIFICATIONS:

**END UPRIGHTS:** 1 PACKAGE - 16 LB. (7 KG), 17" X 18" X 35" (432 MM X 686 MM X 889 MM), 6.19 CF

**CENTER UPRIGHT:** 1 PACKAGE - 10 LB. (4.5 KG), 17" X 18" X 35" (432 MM X 686 MM X 889 MM), 6.19 CF

#### SV210 UPRIGHT PAD SPECIFICATIONS:

**END UPRIGHTS:** 1 PACKAGE - 14 LB. (6 KG), 10" X 68" X 10" (254 MM X 1727 MM X 254 MM), 3.9 CF

**CENTER UPRIGHT:** 1 PACKAGE - 9 LB. (4 KG), 10" X 68" X 10" (254 MM X 1727 MM X 254 MM), 3.9 CF

#### DIGITAL GRAPHIC PADS SPECIFICATIONS:

**END UPRIGHTS:** 1 PACKAGE - 14 LB. (6 KG), 10" X 68" X 10" (254 MM X 1727 MM X 254 MM), 3.9 CF

**CENTER UPRIGHT:** 1 PACKAGE - 9 LB. (4 KG), 10" X 68" X 10" (254 MM X 1727 MM X 254 MM), 3.9 CF

**18 oz. AVAILABLE PADDING COLORS - CONTACT THE FACTORY FOR DETAILS.**



**Note:** Colors shown in catalog and on website may not be an exact match.

**Multiple Adjustment Areas**



3 Levels of adjustment

**Folds for Convenient Storage**



**Includes Vinyl Padding**



**ADJUSTABLE HEIGHT REFEREE PLATFORM**

- Meets the NEW USAV 2.6 d Rule: "The platform must be on a support and adjustable in height."
- Four point emphasis: adjustable, collapsible, movable, and comfortable
- Platform has THREE levels of adjustment at each men's and women's heights (six total heights)
- Slip resistant material on steps to improve footing
- Comfort padding on platform for extended periods of standing
- Includes wheels for easy transport on and off the court.
- Unit folds for easy and convenient storage

**438-216** Adjustable Height Referee Platform  
**FS310** Adjustable Referee Platform Pads - Six Piece Set

**FREESTANDING REFEREE PLATFORM**

- Meets NFHS Specifications
- Portable unit can be used with any volleyball system
- Base has wheels for easy transporting
- Unit folds for storage
- Platform height is 44" (112cm) high, 29" (74cm) wide
- Unit has protective rubber-tipped legs
- Pads not included

**438-116** Freestanding Referee Platform

**SUPPORTED REFEREE PLATFORM**

- Fits on 438-295 and 438-290 systems with SV210 pads only
- Attaches to upright with collar and locking pin
- Platform includes formfitting padding, which meets all specification requirements
- Padding cover material is 18 oz. vinyl

**438-050** Supported Referee Platform

**FREESTANDING REFEREE PLATFORM PADS**

- Meets NFHS Specifications
- Padding comes in six-piece or one-piece configurations
- Custom colors and custom digital graphic pads available - contact factory for details

**FS110** Freestanding Referee Platform Pads  
 Navy Blue, Six-Piece Set

**FS210** Freestanding Referee Platform Pad  
 One-Piece Pad

**438-065** Digital Referee Platform Pads  
 \* see padding colors on opposite page



438-065

FS210



MADE IN USA

### VOLLEYBALL EQUIPMENT CART

- Holds and transports up to four uprights, padding, nets and one referee platform
- Four swivel casters permit travel through a 36" (91cm) doorway

438-127 Volleyball Equipment Cart



MADE IN USA

### VOLLEYBALL EQUIPMENT CARRIER

- Holds and transports up to six uprights, one referee platform, all padding and nets
- Four swivel casters permit travel through a 36" (91cm) doorway

438-057 Volleyball Equipment Carrier



MADE IN USA

### VOLLEYBALL UPRIGHT TRANSPORTER

- Fits on all 3" uprights for easy transport
- Sold individually

438-145 Volleyball Upright Transporter



MADE IN USA

### UPRIGHT STORAGE RACK

- Holds all styles of Spalding uprights
- Attaches to wall to hold uprights in a vertical position
- Lockable for security purposes (padlock not included)
- Removable locking pin allows for easy access to individual uprights

438-413 Upright Storage Rack

— Holds 3 Uprights

438-414 Upright Storage Rack

— Holds 4 Uprights



Shown with net

MADE IN USA

### VOLLEYBALL NET STORAGE RACK

- Neatly holds and transports one volleyball net of any size
- Four swivel casters allow for easy maneuverability
- Non-marking casters

408-055 Volleyball Net Storage Rack



### VOLLEYBALL SCOREBOARD

- Lightweight frame sits on any flat surface
- Numerals are 5" tall in red and green lettering
- Unit is 20" wide x 12" high x 7" deep

408-030 Volleyball Scoreboard

**COACHES' choice!**



**VOLLEYBALL TRUCK**

- Base is made of aluminum 1" x 1" anodized square tubing
- Dimensions: 25" L x 25" W x 18 1/2" deep
- Includes nylon carry bag with shoulder strap (not shown)
- Holds approximately 20 volleyballs
- Navy blue nylon material

**438-056** Volleyball Truck



**SPALDING VOLLEYCADDY**

- Innovative cart and carry system
- On-court ball cart reconfigures for easy transportation
- Kit includes nylon bag with carry strap
- Holds up to 8 volleyballs
- Navy blue color only

**438-055** Spalding VolleyCaddy



WORM GEAR WINCH

**WORM GEAR WINCH WITH SLIDE COLLAR**



- Adjustable height worm gear winch is designed to eliminate backlash and keeps net tight during intense play
- Nylon leader strap allows for safety and easy net attachment
- For use on Elite Aluminum & Elite Steel Systems
- Fits on 3" (76mm) O.D. uprights
- One-year warranty

**438-383** Worm Gear Winch with Slide Collar

**438-380** Worm Gear Winch (not shown)

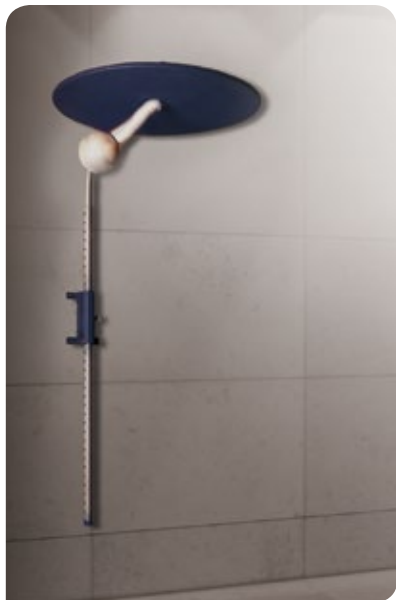

### PRO SPIKE™ TRAINER

- Designed to improve spiking technique, power, approach, arm swing and endurance
- Designed to teach players to hit on top of ball correctly (ball not included)
- Height adjusts from 6 1/2' (2m) to 11 1/2' (3.5m) in 2" (51 mm) increments
- Locking pin secures upright to wall mounting bracket
- Unit can be easily moved from one location to another

**438-010** PRO SPIKE™ Trainer

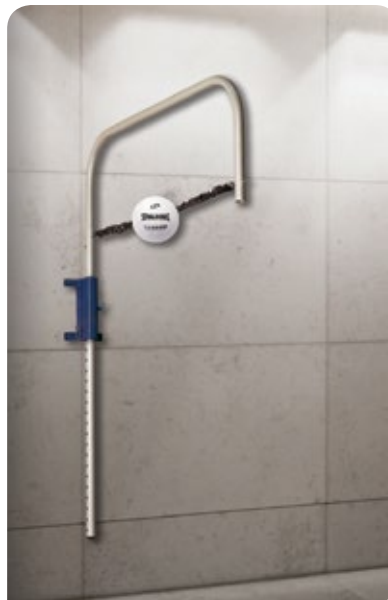

### SPIKE MASTER

- Incorporates all features of the PRO SPIKE™ Trainer
- Allows players to hit on top of ball correctly
- Includes upright and wall mounting bracket
- Ball and floor mounted adapter are not included

**438-560** Spike Master

### ALTERNATE MOUNTING OPTIONS

- Allows attachment of PRO SPIKE™ Trainer or Spike Master to Style B, C, BX or E Floor Anchors (floor anchors sold separately, see page 63)

**438-017** Floor Mounted Adapter

- Clamp-on adapter mounts PRO SPIKE™ Trainer or Spike Master to 2 1/2" to 3" (63-76mm) O.D. uprights

**438-016** PRO SPIKE™ Trainer Adapter Kit (not shown)

- Wall-mounting bracket for mounting PRO SPIKE™ Trainer or Spike Master in alternate locations

**438-015** PRO SPIKE™ Trainer Bracket Kit (not shown)



FLOOR MOUNTED ADAPTER



VOLLEYBALL SINGLE COURT LAYOUT

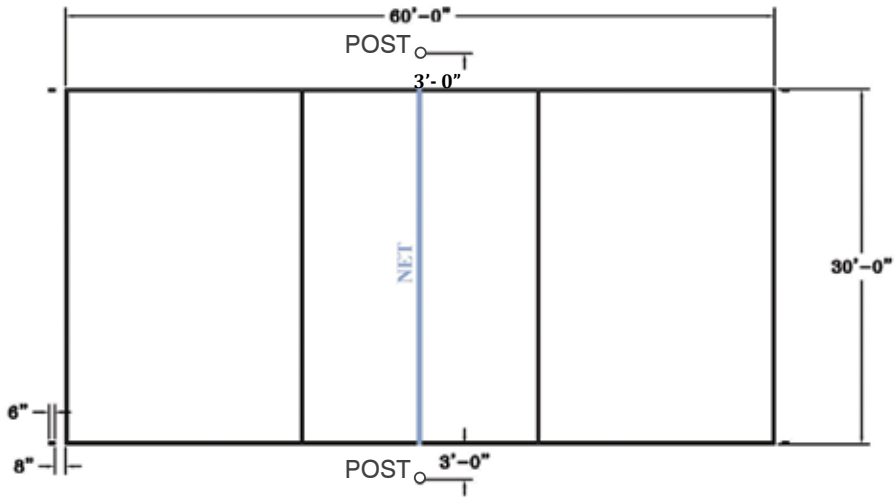

VOLLEYBALL MULTI COURT FIVE HOLE LAYOUT

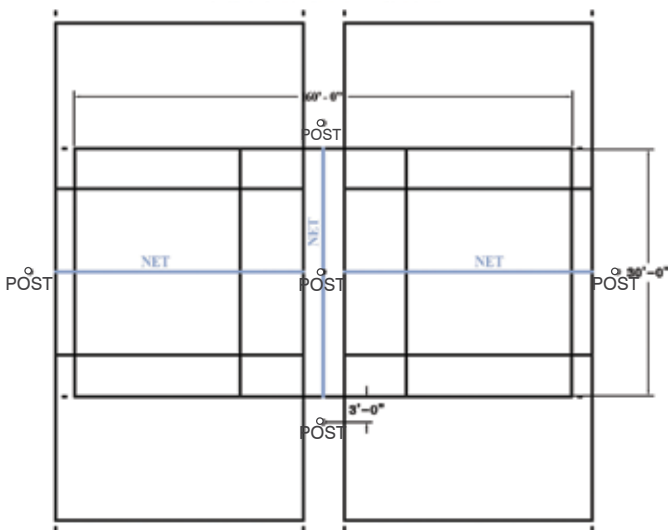

VOLLEYBALL MULTI COURT SIX HOLE LAYOUT

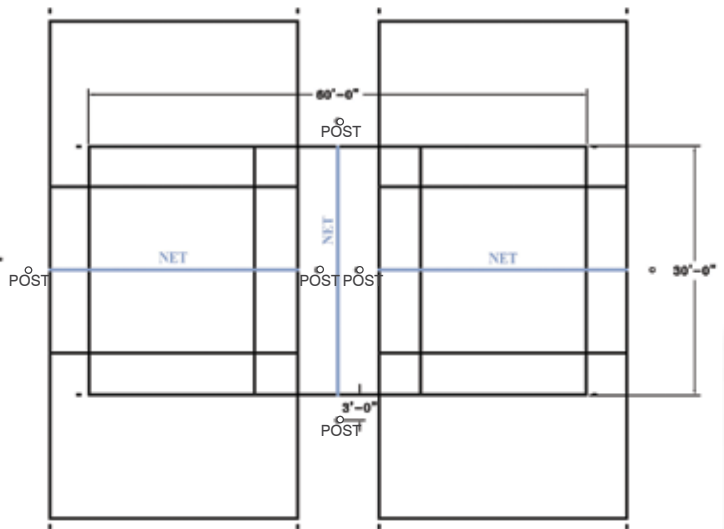





**NBA**

The NBA and individual NBA member team identifications are the intellectual property of NBA Properties, Inc. and the respective NBA member teams. (c) 2013 NBA Properties, Inc. All rights reserved.

**WNBA**

The WNBA and WNBA team identifications are trademarks and copyrighted designs, and/or other forms of intellectual property of WNBA Enterprises, LLC and may not be used, in whole or in part, without the prior written consent of WNBA Enterprises, LLC. © 2012 WNBA Enterprises, LLC. All rights reserved. All photos courtesy of WNBA Photos.

**D-League**

The NBA DL and NBA DL team identifications are the trademarks and copyrighted designs, and/or other forms of intellectual property of NBA Development League, LLC. and may not be used, in whole or in part, without the prior written consent of NBA Development League, LLC, © 2012 NBA Development League, LLC. All Rights Reserved. All photos courtesy of NBA DL photos.

**NCAA® and FINAL FOUR™**

The NCAA® and FINAL FOUR™ are registered trademarks of The National Collegiate Athletic Association.

**Spalding (Russell)**

The Spalding® trademark is owned by Russell Brands, LLC or its affiliate. © 2013 Russell Brands, LLC. All rights reserved.

---

**GENERAL WARRANTY INFORMATION**

Spalding warrants its products against defects in material and workmanship. Without charge, Spalding will, at its option, either repair or replace any products shown to our satisfaction to be defective within the designated warranty timeframe, provided it is returned to the factory (after authorization), transportation prepaid. This warranty covers only products manufactured by Spalding and does not extend to transportation, installation or replacement charges incurred by customer; nor does it apply to products or components of another manufacturer used in conjunction with Spalding products according to the terms hereof and standards acceptable in Spalding's industry. This warranty is exclusive and in lieu of any other express or implied warranties, including, but not limited to, any implied warranty of merchantability or fitness for particular purpose. Modification of Spalding products renders the warranty void and could create a risk of severe personal injury. Abuse, misuse, abnormal usage, faulty installation, vandalism, acts of nature, improper maintenance or unauthorized repairs are not covered under warranty. No obligations or liabilities exist on the part of Spalding for consequential damages arising out of or in connection with the use or performance of the products.