

**HELPLINE : FOR ANY PROBLEMS OR QUERIES, PLEASE TELEPHONE 0845 602 1454 (UK - calls charged at local rate) or (01) 412 3000 (Ireland)**

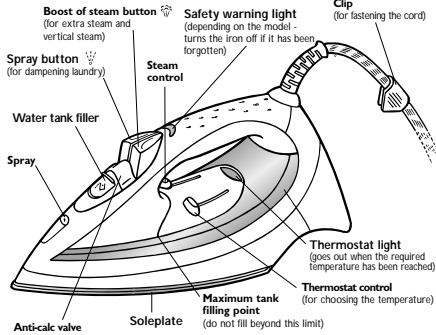

Your iron is equipped with an integrated system that protects against the effects of lime-scale (depending on the model).

Your new Avantis iron represents the latest in ironing technology : **AUTOSTEAM** : All Avantis irons now feature autosteam. This ensures that you get the correct level of steam whatever the temperature you have set, preventing watermarks and drips. **ULTRAGLIDE DIFFUSION SOLEPLATE** : The new Avantis uses Tefal's patented technology with its unique Ultraglide Diffusion soleplate. This gives the iron unrivalled glideability and steam diffusion, reducing your ironing time and making your ironing easier. **ANTI-CALC VALVE** : Tefal have introduced the Anti-calc Valve to ensure easy cleaning and improve resistance to scale.

**Be careful ! (depending on the model).** Take off the soleplate protection before heating the iron. When the appliance is used for the first time, a harmless odour and smoke may be given off. This has no effect on the use of the appliance and will disappear quickly.

**Water to use in your iron ?**

Your iron has been designed to be used with tap water. However, the self-cleaning feature has to be used regularly to eliminate any mineral build-up in the steam chamber. If your water is very hard (check with your Local Environmental Services or water company), you can use a mix of half tap water and half distilled water. **Do not use any other types of water**

**3- CARING FOR YOUR IRON**

**■ CLEANING THE SOLEPLATE**

• When the soleplate is cool, clean with a damp, non-metal washing up pad.

*We recommend that: when using starch, it should be sprayed onto the reverse side of the fabric and the soleplate cleaned more frequently.*

**Be careful!**  
- Unplug your iron and let it cool down before cleaning.  
- Do not use detergent or descaling products.  
- Never put the iron under the tap.

**■ CLEAN THE ANTI-CALC VALVE (at least once every 2 months)**

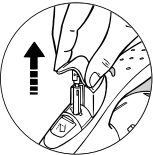

- Empty the iron and put the ironing control onto DRY (☹️)
- To remove the anti-calc valve, pull upwards by means of the grips located on either side.
- Leave to soak in white vinegar or pure lemon juice for around 2 hours.
- Rinse under the tap
- Replace and slot down into the housing.

**Be careful! the iron only works if the anti-calc valve is in place**

**■ SELF-CLEANING (twice a month)**

- Fill the tank to the MAX mark (see our recommendations on the type of water to use).
- Put the thermostat control on MAX and the steam control on DRY (☹️) and switch on. ①
- Place the iron on its heel and wait around 5 minutes.
- Unplug the iron and place over the sink horizontally.
- Completely remove the anti-calc valve.
- Shake the iron gently until all the water (and any impurities) has drained from the soleplate. ②
- Replace the anti-calc valve.
- When the soleplate is just warm, wipe the iron with a soft cloth.

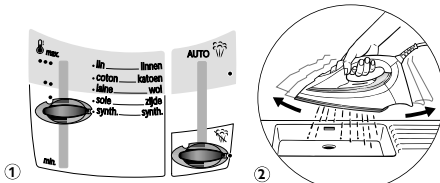

**1- STEAM IRONING**

**■ FILL THE TANK**

- Place the steam control on DRY (☹️).
- Open the flap of the water tank filler, place the iron on a table (not when iron is hot), as shown in the diagram below, and then fill it.



**Be careful !**  
You should not fill the tank beyond the MAX level (iron standing vertically on the heel).

**■ SETTING THE TEMPERATURE AND STEAM LEVEL**

- Place the thermostat control to match the type of fabric to be ironed.

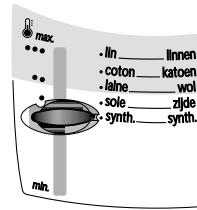

- Linen
- Cotton
- Wool
- Silk, Viscose
- Synthetics  
Polyester, Acetate, Acrylic, Polyamide

The light comes on. Wait for the light to go off and come on again before you start ironing

**We recommend that you:**

- Start with the fabrics to be ironed on a low temperature (☺️) and finish with those which respond best to higher temperatures (☹️ or MAX)
- If you lower the thermostat, wait until the light comes on again before ironing.
- If you iron a fabric made of a blend of fibres: set the temperature for the most fragile fibre.

**Be careful! Your iron will only produce steam when the thermostat control is in the coloured zone.**

**■ AUTOMATIC STEAM**

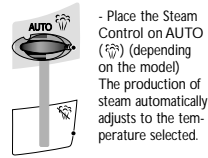

- Place the Steam Control on AUTO (☺️) (depending on the model)  
The production of steam automatically adjusts to the temperature selected.

**■ VARIABLE STEAM (depending on the model)**

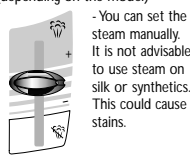

- You can set the steam manually. It is not advisable to use steam on silk or synthetics. This could cause stains.

**■ ANTI-DRIP FUNCTION (depending on the model)**

- The supply of water is cut off automatically to avoid any drips from the soleplate when the temperature of the iron is insufficient to produce steam.

When first using the iron, wait for 5 minutes for steam to be produced.

**■ VERTICAL STEAM (depending on the model)**

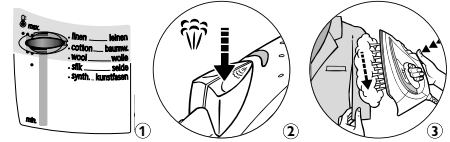

- Hang the garment up and hold the fabric taut.
- Place the thermostat control on MAX (☹️), press repeatedly on the Burst of Steam button (☺️) and move the iron from top to bottom. ③
- Hold the iron a few centimetres from the garment to avoid burning delicate fabrics.

**■ REMOVING STUBBORN CREASES**

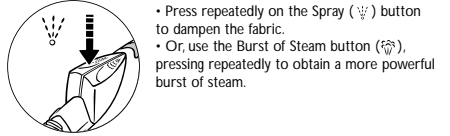

- Press repeatedly on the Spray (☺️) button to dampen the fabric.
- Or, use the Burst of Steam button (☺️), pressing repeatedly to obtain a more powerful burst of steam.

**■ AUTO-STOP SAFETY FEATURE (depending on the model)**

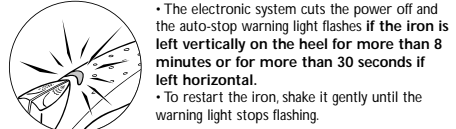

- The electronic system cuts the power off and the auto-stop warning light flashes if the iron is left vertically on the heel for more than 8 minutes or for more than 30 seconds if left horizontal.
- To restart the iron, shake it gently until the warning light stops flashing.

**Warning:** The auto-stop features will only operate 2 minutes after the iron is switched on.

**N.B.** When the auto-stop safety feature cuts in, it is normal for the thermostat light to be off.

**2- IRONING WITHOUT STEAM**

- Place the Steam control on DRY (☹️).
- You can start ironing when the indicator light comes on for the second time.



**3- CARING FOR YOUR IRON**

**■ CLEANING THE SOLEPLATE**

• When the soleplate is cool, clean with a damp, non-metal washing up pad.

*We recommend that: when using starch, it should be sprayed onto the reverse side of the fabric and the soleplate cleaned more frequently.*

**Be careful!**  
- Unplug your iron and let it cool down before cleaning.  
- Do not use detergent or descaling products.  
- Never put the iron under the tap.

**■ CLEAN THE ANTI-CALC VALVE (at least once every 2 months)**

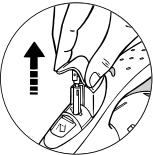

- Empty the iron and put the ironing control onto DRY (☹️)
- To remove the anti-calc valve, pull upwards by means of the grips located on either side.
- Leave to soak in white vinegar or pure lemon juice for around 2 hours.
- Rinse under the tap
- Replace and slot down into the housing.

**Be careful! the iron only works if the anti-calc valve is in place**

**■ SELF-CLEANING (twice a month)**

- Fill the tank to the MAX mark (see our recommendations on the type of water to use).
- Put the thermostat control on MAX and the steam control on DRY (☹️) and switch on. ①
- Place the iron on its heel and wait around 5 minutes.
- Unplug the iron and place over the sink horizontally.
- Completely remove the anti-calc valve.
- Shake the iron gently until all the water (and any impurities) has drained from the soleplate. ②
- Replace the anti-calc valve.
- When the soleplate is just warm, wipe the iron with a soft cloth.

**4- PUTTING YOUR IRON AWAY**

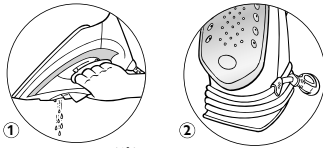

- Place the cursor on DRY (☹️)
- Unplug the iron and wait until the soleplate has cooled.
- Empty the tank. ①
- Wind the cord loosely around the heel and fix the clip onto the cord. ②
- Store the iron upright on its heel.

**SAFETY PRECAUTIONS**

- **Be careful!** Your electrical installation must correspond to that of your iron (220-240V). Connecting to the wrong voltage may cause irreparable damage to the iron and this will invalidate the guarantee.
- This iron must be plugged into an earthed socket. If you are using an extension lead, ensure that it is bipolar (10A- or 13A for UK only) with an earth.
- If the cord is damaged, it must be replaced immediately by an Approved Service Centre as this is dangerous.
- Never immerse the iron in water!
- The appliance must be unplugged before filling or emptying the tank
- If the iron is dropped, have it checked by a professional before reuse: invisible damage may be dangerous.
- Your appliance gives off steam which can cause burns.
- The soleplate of the iron may be very hot:
  - never touch it
  - always leave it to cool before you put it away
  - never leave your iron unattended when plugged in or when the soleplate is still hot.
  - keep your iron away from children.
- NEVER TAKE YOUR IRON APART: CONSULT YOUR APPROVED SERVICE CENTRE (SEE SEPARATE LEAFLET).

**WIRING INSTRUCTIONS (FOR U.K. ONLY).**

**Warning :** this appliance must be earthed.

**Important :** the wires in this lead are coloured in accordance with the following codes :

- Green and yellow : earth
- Brown : live
- Blue : neutral.

- Connect the green/yellow wire to the terminal in the plug marked "E" or by the earth symbol or coloured green and yellow.
- Connect the brown wire to the terminal in the plug marked "L" or coloured red.
- Connect the blue wire to the terminal in the plug marked "N" or coloured black. A 13 amp fuse should be fitted when the appliance is connected to a BS 1363A plug.

Seek professional advice if unsure of the correct procedure for the above. Important : If the electrical cord of this appliance is damaged or shows signs of wear, it must only be replaced by an authorised Tefal Service Centre (see section After Sales Service - see separate leaflet).

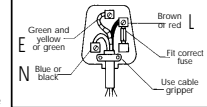

**5- TROUBLESHOOTING**

**Problems and possible causes Solutions**

**YOUR IRON PRODUCES LITTLE OR NO STEAM**

- Your iron is new.....  
• When you first use, wait 2 minutes until steam is produced.
- The temperature selected is too low ..  
• Place the cursor of the thermostat on ☹️ or MAX and the steam setting cursor on the coloured zone (☺️)
- The steam control is on DRY.....  
• Put the Steam control on AUTO

- Your iron is clogged with scale or has been used dry for too long .....
- Clean the anti-calc valve and set the self-clean feature in motion.

**WATER IS DRIPPING FROM THE HOLES IN THE SOLEPLATE**

- You have been using the Burst of Steam control too often .....
- Wait a few seconds before each use.
- The thermostat is not functioning correctly.....
- Take the iron to an approved service centre.

- Steam used before the iron is hot .....
- Wait until the thermostat indicator light goes out before using the steam

**BROWNISH WATER IS DRIPPING FROM THE SOLEPLATE AND IS STAINING THE LAUNDRY**

- You are using chemical descaler products or pure demineralised water .....
- Operate the self-clean feature and follow our recommendations (see the paragraph: "The water to use")
- Fabric fibres have accumulated in the soleplate holes or between the iron body and the soleplate and are singeing .....
- Clean the soleplate with a non-metal, washing up pad. Vacuum the soleplate holes from time to time. Operate the self-clean feature.

**THE SOLEPLATE IS DIRTY OR BROWN AND IS SOILING THE LAUNDRY**

- You are using a temperature that is too high .....
- Clean the soleplate. See the paragraph "Setting the temperature".
- Your laundry has not been sufficiently rinsed or you are using starch .....
- Clean the soleplate. Spray starch on the other side of the fabric to the side being ironed.

**THE SOLEPLATE IS SCRATCHED OR DAMAGED**

- You have placed your iron horizontally on a metal support .....
- Always place your iron on its heel.

**This appliance is designed for domestic use only. In the case of professional use, inappropriate use or failure to comply with the instructions, the manufacturer accepts no responsibility and the guarantee does not apply.**