

Rear brake pads, removing and installing

NOTE —

If re-using brake pads, mark pad position before removing. Reinstall brake pads in their original position to prevent uneven braking.

- Raise car and support with jack stands or lift. See **0 Maintenance** for proper lifting procedure.

WARNING —

Observe all warnings and cautions associated with lifting vehicle in **0 Maintenance**.

- Remove rear wheels.

- Remove retaining clip (1) for parking brake cable. Press brake lever (2) downward and unhook parking brake cable (3) from lever (2).

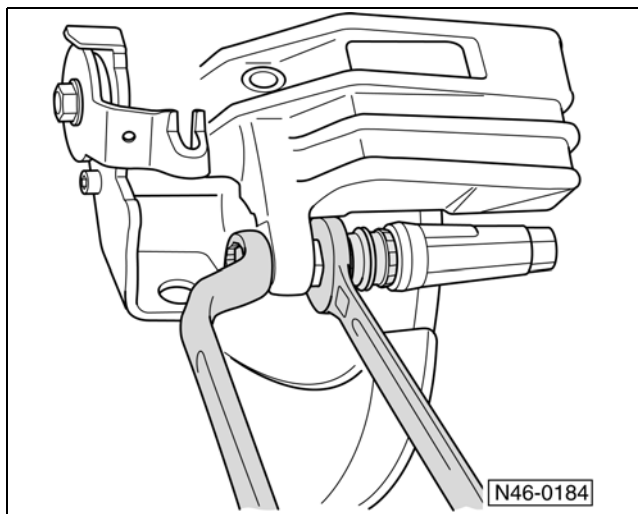
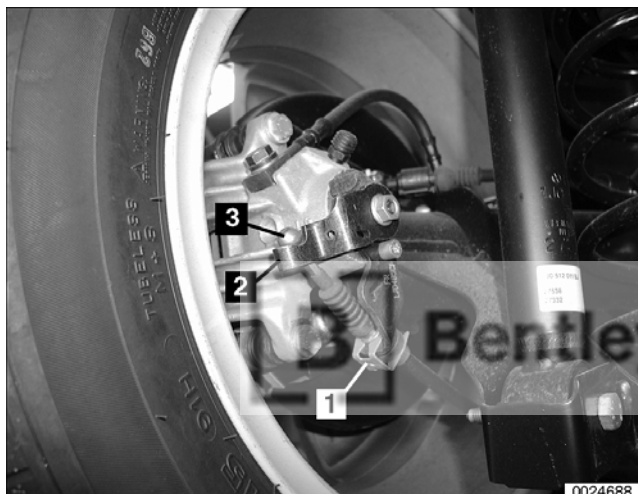

- Remove bolts from brake caliper housing while counter-holding guide pins. Remove brake caliper and hang up with wire.

WARNING —

- Do not allow caliper to hang by the brake hose. The unsupported weight can stretch and damage the hose.
- Do not disconnect the brake hose from the caliper when removing brake pads.

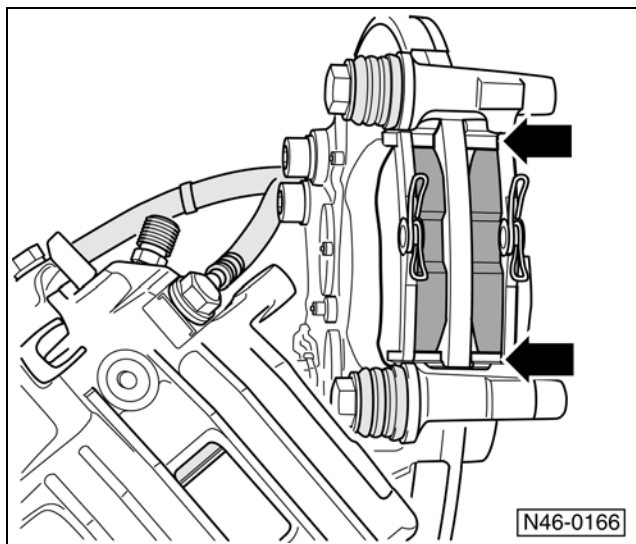

- ◀ Remove brake pads and pad retaining springs (**arrows**).
- Clean brake caliper housing, especially bonding surface for brake pad. Bonding surfaces must be free of adhesive and grease residues.
- Before installing new pads:
 - Remove protective foil from adhesive on pad backing plate if equipped.
 - Extract some of the brake fluid from the brake fluid reservoir.

WARNING —

Brake fluid is poisonous. Never siphon brake fluid by mouth.

NOTE —

- A full brake fluid reservoir may allow brake fluid to flow out and cause damage when pistons are pushed back.
- Use a bleeder bottle or plastic bottle which is used only for brake fluid.

- ◀ Rear brake caliper piston *must* be pushed in while simultaneously being turned. Use of a dual purpose tool such as Volkswagen special tool **3272** is highly recommended. Some larger calipers will require an adapter plate **3272/1**, to bridge the span of the caliper frame.

NOTE —

A newer version of tool 3272 has been released under the number T10165. This new tool supersedes 3272 and can be used on vehicles covered by this manual.

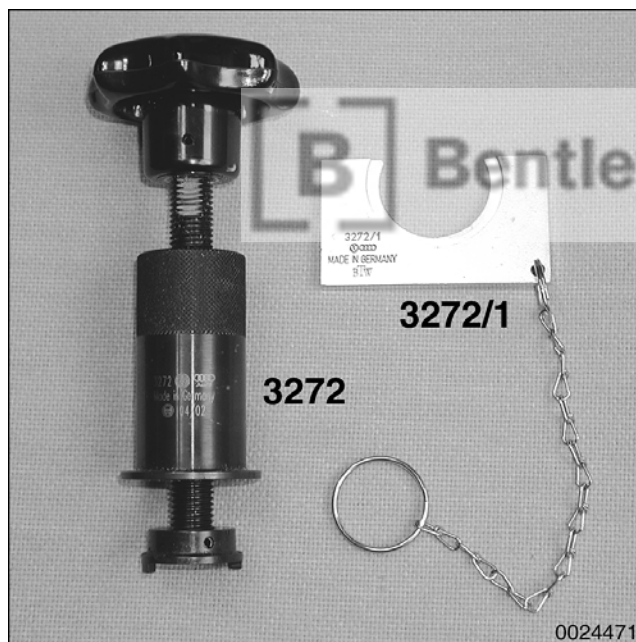

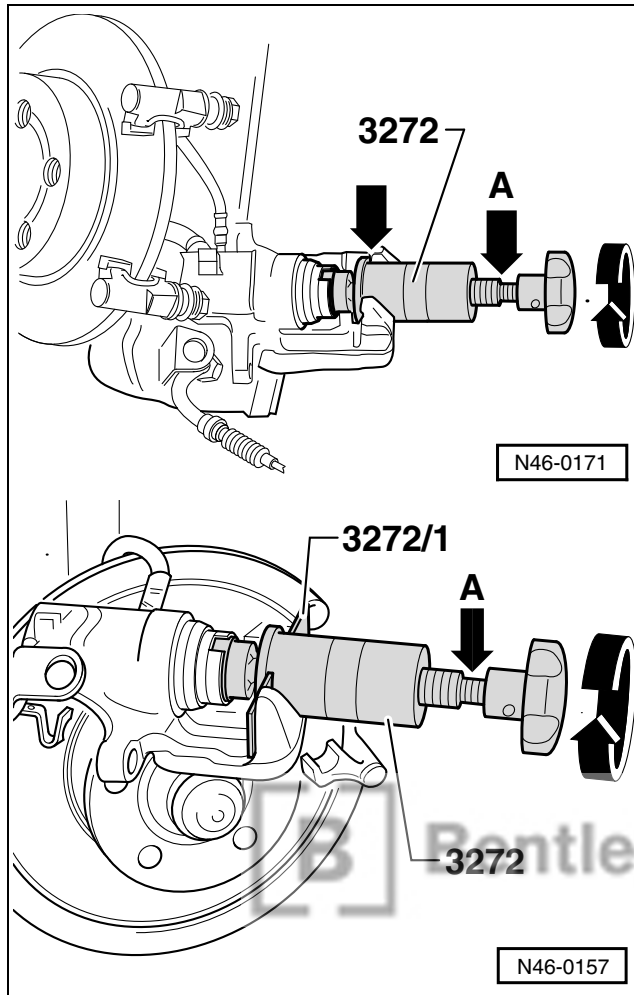

- Reset caliper's automatic adjustment mechanism using Volkswagen special tool 3272 or equivalent by turning piston clockwise (**rotational arrow**) while pushing in. An open-ended 13 mm wrench can be used on flats (**A**) if necessary. It may also be necessary to use adapter plate 3272/1 if caliper frame is too large (see lower illustration at left).

WARNING —

- If the piston is not reset correctly, or if the brake pedal is operated with the caliper removed, the automatic adjustment mechanism will be destroyed.
- Always remove some brake fluid from the reservoir before resetting and pushing the caliper piston in. When the piston is pushed in, fluid is forced up into the reservoir.

- Insert brake pads and brake pad retaining springs into brake carrier.
- Install brake caliper housing with new self-locking bolts.

WARNING —

Always replace the self-locking caliper mounting bolts with the ones in the repair kit.

Tightening torque

- Brake caliper to brake carrier 35 Nm (26 ft-lb)

- Connect parking brake cable to lever on caliper and install retaining clip.
- Adjust parking brake if necessary, see **Parking brake, adjusting** given later.

NOTE —

Operate the foot brake first after adjusting the parking brake.

- Install rear wheels and lower vehicle.
- Depress brake pedal firmly several times to seat brake pads to brake disc. Check brake fluid level and add as necessary.
- Repeat for the brakes on the other side of the vehicle as required.



BentleyPublishers
 .com

Volkswagen Jetta, Golf, GTI Service Manual: 1999-2005 1.8L turbo, 1.9L TDI diesel, PD diesel, 2.0L gasoline, 2.8L VR6

Price: \$119.95
 Bentley Stock No: VG05
 Publication Date: 2005.apr.1
 ISBN: 978-0-8376-1678-0
 2 volume hardcover set, 8 3/8 in. x 11 in.
 Case quantity: 1
 1976 pages
 4140 technical photos and illustrations
**Includes 24 page full color
 Volkswagen A4 platform familiarization section**

Bentley Publishers is proud to announce the publication of the Volkswagen Jetta, Golf, GTI Service Manual: 1999-2005. This repair manual covers the late 1999 through 2005 model year Jetta, Golf, and GTI built on the Volkswagen "A4" platform. Bentley repair manuals provide the highest level of clarity and comprehensiveness for all service and repair procedures. If you're looking for better understanding of your Volkswagen, look no further than Bentley.

Technical Features

- Covers Volkswagen Jetta, Golf, GTI models built on the "A4" platform with "9M" or "1J" at position number 7 and 8 of 17-digit Vehicle ID number (VIN), including Jetta wagon, GTI 337 and 20th anniversary editions.
- Maintenance procedures: from oil changes to belt replacement.
- Engine and cylinder head service and reconditioning, including timing belt (4-cylinder) and timing chain (6-cylinder) repair.
- Explanation of Motronic M5.9, ME 7.1/7.5 and Diesel Turbo Direct Injection (TDI) engine management systems and ODB II.
- Emission control tests, repairs and adjustments, including Exhaust Gas Recirculation and Secondary Air Injection system.
- Drivetrain maintenance, troubleshooting, adjustment and repair, including hydraulic clutch, gearshift linkage, and axles.
- Suspension component replacement, including front struts, rear shocks, rear coil springs, and wheel bearing/hub units.
- Heating and air conditioning repair, including A/C component replacement and the Climatronic system.
- Body adjustment and repairs, including front and rear doors, fenders, front radiator support and sunroof.
- Wiring schematics, including fuse/relay locations and a general explanation of electrical circuitry. Includes R32 wiring.
- Volkswagen OBD II diagnostic trouble codes, SAE-defined OBD II P-codes, as well as basic scan tool operation.
- Comprehensive Volkswagen factory tolerances, wear limits, adjustments, and tightening torques.



1.9L PD engine bay
 (code: BEW)
 0 Maintenance

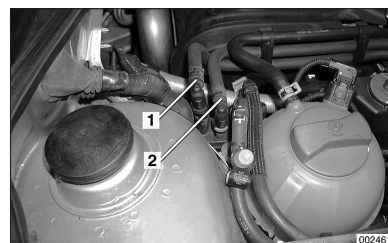

1.9L fuel supply and
 return hose
 10 Engine —
 Removing and
 installing

Engines covered

- 1.8L turbo gasoline (engine codes: AWD, AWW, AWP)
- 1.9L TDI diesel (engine code: ALH)
- 1.9L Turbo diesel Pumpe Düse (PD) (engine code: BEW)
- 2.0L gasoline (engine codes: AEG, AVH, AZG, BBW, BEV)
- 2.8L gasoline (engine code: AFP, BDF)

Transmissions covered

- 02J 5-speed manual
- 02M 6-speed manual
- 01M 4-speed automatic
- 09A 5-speed automatic